

Latitude 38° 15'

Longitude 82° 10'

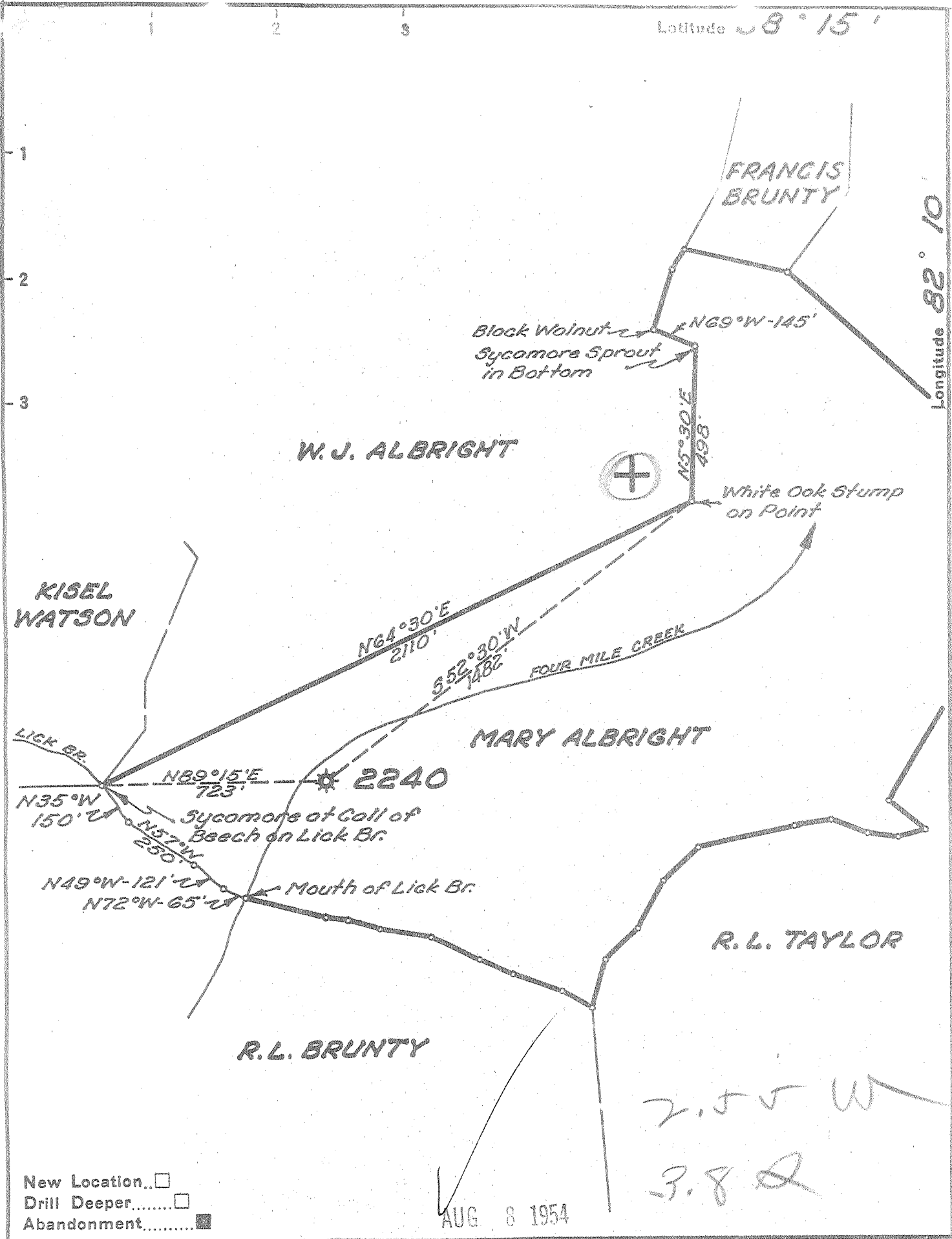

New Location...
 Drill Deeper.....
 Abandonment.....

AUG 8 1954

2.55 W
 3.8 Q

Company UNITED FUEL GAS CO.
 Address CHARLESTON, W. VA.
 Farm MARY ALBRIGHT
 Tract _____ Acres 30 Lease No. 24689
 Well (Farm) No. _____ Serial No. 2240
 Elevation (Spirit Level) 620.0'
 Quadrangle MIDKIFF
 County LINCOLN District SHERIDAN
 Engineer Paul E. Joachims
 Engineer's Registration No. 669
 File No. 28-47 Drawing No. _____
 Date 6-28-54 Scale 1"=400'

STATE OF WEST VIRGINIA
 DEPARTMENT OF MINES
 OIL AND GAS DIVISION
 CHARLESTON

WELL LOCATION MAP
 FILE NO. LIN-1105-R

+ Denotes location of well on United States Topographic Maps, scale 1 to 62,500, latitude and longitude lines being represented by border lines as shown.
 - Denotes one inch spaces on border line of original tracing.



STATE OF WEST VIRGINIA
DEPARTMENT OF MINES
OIL AND GAS DIVISION

1389

Quadrangle Midkiff
Permit No. 1105-A

WELL RECORD

Oil or Gas Well Gas
(KIND)

Company UNITED FUEL GAS COMPANY
Address P.O. Box 1273, Charleston 25, W. Va.
Farm Mary E. Albright Acres 11,923.69
Location (waters) Four Mile Creek
Well No. 2240 Elev. 620'
District Sheridan County Lincoln
The surface of tract is owned in fee by _____
Address _____
Mineral rights are owned by United Fuel Gas Co.
Address _____
Drilling commenced _____
Drilling completed 11-28-14
Date Shot 12-1-14 From _____ To _____
With 60 qts.
Open Flow /10ths Water in _____ Inch
/10ths Merc. in _____ Inch
Volume 360,000 Cu. Ft.
Rock Pressure _____ lbs. _____ hrs.
Oil _____ bbls., 1st 24 hrs.
Fresh water _____ feet _____ feet
Salt water 560' feet _____ feet

| Casing and Tubing | Used in Drilling | Left in Well | Packers |
|---------------------|------------------|--------------|----------------|
| Size | | | Kind of Packer |
| 16 | | | |
| 18 | | | |
| 10 | | 35' | Size of |
| 3 1/2 7" | | 1073' | |
| 6 3/8 | | | Depth set |
| 5 3/16 | | | |
| 3 | | | Perf. top |
| 2 | | 1351' | Perf. bottom |
| Liners Used | | | Perf. top |
| | | | Perf. bottom |

CASING CEMENTED _____ SIZE _____ No. Ft. _____ Date _____

COAL WAS ENCOUNTERED AT 260 FEET 48 INCHES
____ FEET _____ INCHES _____ FEET _____ INCHES
____ FEET _____ INCHES _____ FEET _____ INCHES

| Formation | Color | Hard or Soft | Top | Bottom | Oil, Gas or Water | Depth Found | Remarks |
|-------------|-------|--------------|-------|--------|--|-------------|---------|
| Coal | | | 260 | 264 | Hole full water 560' Gas 1272-1287' Est. 500 M Shot 12-1-14 with 60 qts. Glys. <u>FINAL OPEN FLOW - 360 M</u> | | |
| Salt Sand | | | 532 | 840 | | | |
| Little Lime | | | 995 | 1000 | | | |
| Pencil Cave | | | 1000 | 1020 | | | |
| Big Lime | | | 1020 | 1243 | | | |
| Big Injun | | | 1272 | 1314 | | | |
| Slate | | | 1314 | 1339 | | | |
| Total depth | | | 1339' | | | | |

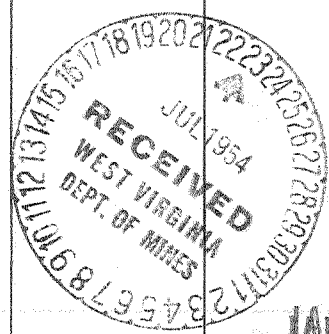

JAN 1955

