

8,379' to Top Hole

2,582' to Bottom Hole

TOP LATITUDE 39 - 07 - 30
BTM LATITUDE 39 - 10 - 00

TOP LONGITUDE 80 - 27 - 30
BTM LONGITUDE 80 - 30 - 00

1,848' to Bottom Hole



I, the undersigned, hereby certify that this plat is correct to the best of my knowledge and belief and shows all the information required by law and the rules issued and prescribed by the Department of Environmental Protection.

Kevin S. James
Kevin S. James, P.S. 2305

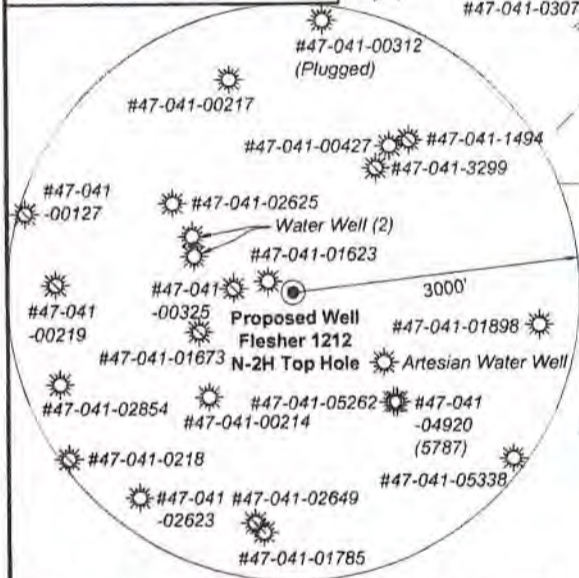

Note: 2 water wells and 1 artesian well was found within 1500' of proposed well. No occupied dwellings or buildings 2,500 square feet or larger used to house or shelter dairy cattle or poultry husbandry are located within 625' of the center of the well pad.

FILE NO: 156-36-12-U-F-19
DRAWING NO: Flesher 1212 N-2H Well Plat
SCALE: 1" = 2000'
MINIMUM DEGREE OF ACCURACY: Submeter
PROVEN SOURCE OF ELEVATION: CORS, Bridgeport, WV

STATE OF WEST VIRGINIA
DEPARTMENT OF ENVIRONMENTAL PROTECTION
OIL AND GAS DIVISION

DATE: May 13 2021
OPERATOR'S WELL NO. Flesher 1212 N-2H
API WELL NO MOD
47 - 041 - 05711
STATE COUNTY PERMIT

WELL TYPE: OIL GAS LIQUID INJECTION WASTE DISPOSAL
(IF GAS) PRODUCTION: STORAGE DEEP SHALLOW

LOCATION: ELEVATION: 1,332.2' WATERSHED: Middle West Fork Creek
DISTRICT: Freemans Creek
SURFACE OWNER: H.G. Energy II Appalachia, LLC
ROYALTY OWNER: W.D. Hitt, et al, et al LEASE NO: ACREAGE: 210.00

PROPOSED WORK: DRILL CONVERT DRILL DEEPER FRACTURE OR STIMULATE PLUG OFF OLD FORMATION
 PERFORATE NEW FORMATION OTHER PHYSICAL CHANGE IN WELL (SPECIFY) BH-MOD 6,925' TVD
 PLUG AND ABANDON CLEAN OUT AND REPLUG TARGET FORMATION: Marcellus Shale ESTIMATED DEPTH: 23,855' MD

WELL OPERATOR: HG Energy II Appalachia, LLC DESIGNATED AGENT: Diane C. White
ADDRESS: 5260 Dupont Road ADDRESS: 5260 Dupont Road
Parkersburg, WV 26101 Parkersburg, WV 26101

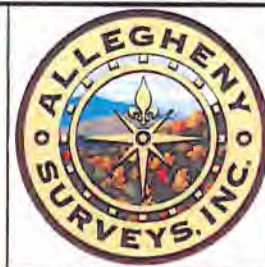

Notes: Well No. Flesher 1212 N-2H
West Virginia Coordinate System of 1927, North Zone
based upon Differential GPS Measurements.
Top Hole coordinates Latitude: 39°07'05.77" Longitude: 80°29'16.33"
Bottom Hole coordinates Latitude: 39°09'41.73" Longitude: 80°30'32.80"
UTM Zone 17, NAD 1983
Top Hole Coordinates N: 4,330,036.173m E: 544,288.559m
Bottom Hole Coordinates N: 4,334,833.697m E: 542,426.109m
Plat orientation and corner and well references are based upon the grid north meridian. Well location references are based upon the magnetic meridian.

Notes:
Well No. Flesher 1212 N-2H
UTM NAD 1983 (USSF)
Top Hole Coordinates N: 14,206,127.01' E: 1,785,720.05'
Landing Point Coordinates N: 14,206,352.07' E: 1,785,092.01'
Bottom Hole Coordinates N: 14,221,866.87' E: 1,779,609.66'

Tag	Bearing	Dist.	Description
L1	N 42°34' W	1,564.9'	#47-041-05262
L2	N 21°02' E	689.3'	1/2" Rebar
L3	N 66°57' E	1,601.4'	1" Iron pipe
L4	S 34°37' E	1,979.3'	5/8" Rebar
L5	N 70°17' W	667.2'	Landing point

Wellhead Layout (NTS)

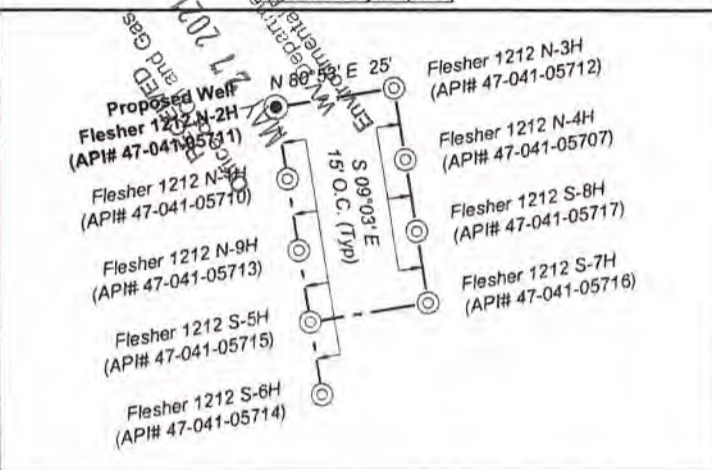

Well Location References
Not to Scale

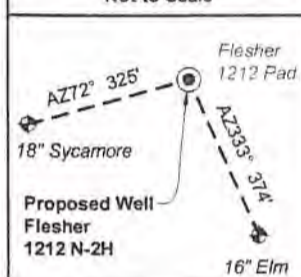

Legend

- Proposed gas well
- Well Reference, as noted
- Monument, as noted
- Existing Well, as noted
- Digitized Well, as noted
- Creek or Drain
- Existing Road
- Surface boundary (approx.)
- Interior surface tracts (approx.)

Detail 1 (Scale 1"=500')



Detail 2 (Scale 1"=500')



FILE NO: 156-36-12-U-F-19
DRAWING NO: Flesher 1212 N-2H Well Plat
SCALE: 1" = 2000'
MINIMUM DEGREE OF ACCURACY: Submeter
PROVEN SOURCE OF ELEVATION: CORS, Bridgeport, WV

STATE OF WEST VIRGINIA
DEPARTMENT OF ENVIRONMENTAL PROTECTION
OIL AND GAS DIVISION

DATE: May 13 2021
OPERATOR'S WELL NO. Flesher 1212 N-2H
API WELL NO. 47-041-05711
STATE COUNTY PERMIT

WELL TYPE: OIL GAS LIQUID INJECTION WASTE DISPOSAL
(IF GAS) PRODUCTION: STORAGE DEEP SHALLOW

LOCATION: ELEVATION: 1,332.2' WATERSHED: Middle West Fork Creek

DISTRICT: Freemans Creek

SURFACE OWNER: H.G. Energy II Appalachia, LLC

ROYALTY OWNER: W.D. Hitt, et al, et al

LEASE NO: _____ ACREAGE: 210.00

PROPOSED WORK: DRILL CONVERT DRILL DEEPER FRACTURE OR STIMULATE PLUG OFF OLD FORMATION
 PERFORATE NEW FORMATION OTHER PHYSICAL CHANGE IN WELL (SPECIFY) BH-MOD

PLUG AND ABANDON CLEAN OUT AND REPLUG TARGET FORMATION: Marcellus Shale ESTIMATED DEPTH: 23,855' MD

Btm: Big Isaac
Top: Weston
QUADRANGLE: _____
COUNTY: _____
ACREAGE: 70.00

WELL OPERATOR: HG Energy II Appalachia, LLC
ADDRESS: 5260 Dupont Road
Parkersburg, WV 26101

DESIGNATED AGENT: Diane C. White
ADDRESS: 5260 Dupont Road
Parkersburg, WV 26101

06/11/2021



RECEIVED
 Office of Oil and Gas
 MAY 27 2021
 WV Department of Environmental Protection

Lewis Co. - Freeman Creek Dist.

No.	TM / Par	Owner	Bk / Pg	Ac.
1	6C / 47	HG Energy II Appalachia, LLC	753 / 453	70.00
2	6C / 43	Gary Allen Sias	646 / 688	50.59
3	6C / 25.1	William Radtka & Helen Burton	655 / 681	5.85
4	6C / 25	Robert M. Painter	629 / 411	27.48
5	6C / 23.8	Richard G. & Loretta E. Hayhurst	673 / 69	1.19
6	6C / 23.11	Richard G. & Loretta E. Hayhurst	718 / 245	2.53
7	6C / 23.3	Richard G. Hayhurst, et ux	566 / 470	19.37
8	6C / 23	Richard G. Hayhurst	566 / 357	34.80
9	6C / 61	Mann Family Trust	617 / 608	49.91
10	6C / 58	Mann Family Trust	617 / 608	7.62
11	6C / 22	Mann Family Trust	617 / 608	265.19
12	6C / 61.1	Susanne Mann & Theodore W. Lanouette	702 / 38	5.00
13	6B / 30.1	Theodore & Mary C. Eldridge	561 / 257	11.75
14	6B / 31	Mann Family Trust	617 / 608	17.00
15	6B / 32	Mann Family Trust	617 / 608	23.00
16	6B / 33	Robert E. Brincefield Jr. & Terri Lynne Trust, et al	578 / 630	50.05
17	6B / 33.1	Robert E. Brincefield Jr. & Terri Lynne Trust, et al	578 / 630	2.20
18	6B / 13	Mann Family Trust	617 / 608	38.55
19	6B / 28	Robert E. Brincefield Jr. & Terri Lynne Trust, et al	578 / 630	31.00
20	6B / 27	Robert E. Brincefield Jr. & Terri Lynne Trust, et al	578 / 630	14.00
21	6B / 26	Robert E. Brincefield Jr. & Terri Lynne Trust, et al	578 / 630	14.00
22	6B / 36	Robert E. Brincefield Jr. & Terri Lynne Trust, et al	578 / 630	28.00
23	6B / 19.1	Robert E. Brincefield Jr. & Terri Lynne Trust, et al	578 / 630	52.00
24	6B / 25	Robert E. Brincefield Jr. & Terri Lynne Trust, et al	578 / 630	45.00
25	6B / 24	Robert E. Brincefield Jr. & Terri Lynne Trust, et al	578 / 630	11.15
26	6B / 22	Robert E. Brincefield Jr. & Terri Lynne Trust, et al	578 / 630	99.46
27	6B / 21.1	Robert E. Brincefield Jr. & Terri Lynne Trust, et al	578 / 630	44.00
28	6B / 21	Mark D. Roles	W50 / 769	195.91
29	6B / 50	Jackie & Barbara Caplinger	623 / 445	10.49
30	6B / 21.2	Mark D. & Betty Roles	557 / 627	25.47
31	6B / 21.3	Margaret E. Roles	W50 / 769	6.63

ID	Lease
12	Mary Post Davis, et al
14	Fannie M. Hughes, et al
15	Alvadore Hughes, et al
16	Henry Frashuer, et al
19	A.R. Frashuer, et al
23	A.C. Thrash, et al
32	W.H. Coffindaffer, et al
33	J.M. Beeghley, et ux
35	Daisy Lynch, et al
39	Robert Max McDonald, Trustee
40	Loxie V. McClung, et al
45	Edwin Gaston, et al
52	W.D. Hitt, et al
55	J.S. Norris, et al
60	Agnes J. Coffindaffer, et al

Harrison Co. - Union-Outside Dist.

No.	TM / Par	Owner	Bk / Pg	Ac.
32	443 / 8.2	Estella Breise	W197 / 1310	10.00
33	443 / 18	Glennville N. Potts, et ux	677 / 212	0.10
34	443 / 8.1	Estella Breise	W197 / 1310	0.70
35	443 / 8	Amanda Braimantyer	W197 / 1310	53.40
36	443 / 3	Kyle & Luann Baker	1369 / 45	1.00
37	443 / 2.1	Bernard & Darlene Baird	1200 / 919	1.62
38	443 / 2	Lou Ann Baker	1307 / 1155	26.54
39	443 / 6	Amanda Braimantyer	W197 / 1310	0.60
40	443 / 7	Amanda Braimantyer	W197 / 1310	0.57
41	443 / 1	Lou Ann Baker	1323 / 1089	25.14
42	422 / 38	Jody Ross & Dawn Price	1283 / 546	36.77
43	423 / 23	Jeffery & Anessa Griffith	1313 / 1245	25.10
44	423 / 13	Jeffery & Anessa Griffith	1313 / 1245	45.10
45	422 / 37	Jody Ross & Dawn Price	1283 / 546	34.70
46	422 / 35	Jody Ross & Dawn Price	1283 / 546	31.16
47	422 / 36	Sherry D. Baldwin, et al	1531 / 944	2.20
48	423 / 12	Sherry D. Baldwin	1531 / 944	65.39
49	422 / 21	Jeffery & Anessa Griffith	1314 / 173	15.76
50	443 / 5	Amanda Braimantyer	W197 / 1310	0.47
51	443 / 4	Glennville N. Potts, et ux	677 / 212	0.48
52	423 / 11	William L. & Sandra L. Coffindaffer	1157 / 151	94.00
53	422 / 19	William L. & Sandra L. Coffindaffer	1335 / 1091	1.00
54	422 / 18	Stephen J. & Freda P. Perkins	1258 / 66	61.60

FILE NO: 156-36-12-U-F-19
 DRAWING NO: Flesher 1212 N-2H Well Plat
 SCALE: 1" = 2000'
 MINIMUM DEGREE OF ACCURACY:
 Submeter
 PROVEN SOURCE OF ELEVATION:
 CORS, Bridgeport, WV

STATE OF WEST VIRGINIA
 DEPARTMENT OF ENVIRONMENTAL PROTECTION
OIL AND GAS DIVISION

DATE: May 13 2021
 OPERATOR'S WELL NO. Flesher 1212 N-2H
 API WELL NO **MOD**
 47 - 041 - 05711
 STATE COUNTY PERMIT

WELL TYPE: OIL GAS LIQUID INJECTION WASTE DISPOSAL
 (IF GAS) PRODUCTION: STORAGE DEEP SHALLOW

LOCATION: ELEVATION: 1,332.2' WATERSHED: Middle West Fork Creek

Btm: Big Isaac
 QUADRANGLE: Top: Weston

DISTRICT: Freemans Creek

COUNTY: Lewis **06/11/2021**

SURFACE OWNER: H.G. Energy II Appalachia, LLC

ACREAGE: 70.00

ROYALTY OWNER: W.D. Hitt, et al, et al

LEASE NO: _____ ACREAGE: 210.00

PROPOSED WORK: DRILL CONVERT DRILL DEEPER FRACTURE OR STIMULATE PLUG OFF OLD FORMATION
 PERFORATE NEW FORMATION OTHER PHYSICAL CHANGE IN WELL (SPECIFY) BH-MOD

PLUG AND ABANDON CLEAN OUT AND REPLUG TARGET FORMATION: Marcellus Shale ESTIMATED DEPTH: 23,855' MD 6,925' TVD

WELL OPERATOR: HG Energy II Appalachia, LLC

DESIGNATED AGENT: Diane C. White

ADDRESS: 5260 Dupont Road
 Parkersburg, WV 26101

ADDRESS: 5260 Dupont Road
 Parkersburg, WV 26101