

205' to Bottom Hole

6,568' to Top Hole

TOP LATITUDE 39 - 07 - 30
BTM LATITUDE 39 - 10 - 00

Bottom Hole 7.5' Spot
2,215' to Top Hole
1,359' to Bottom Hole
BTM LONGITUDE 80 - 32 - 30
TOP LONGITUDE 80 - 30 - 00

HG Energy II Appalachia, LLC
Well No. Burnside 1214 N-3H MOD

Page 1 of 2



Notes:
Well No. Burnside 1214 N-3H
UTM NAD 1983 (USSF)
Top Hole Coordinates
N: 14,206,309.10'
E: 1,775,709.49'
Landing Point Coordinates
N: 14,206,776.69'
E: 1,775,661.74'
Bottom Hole Coordinates
N: 14,222,306.11'
E: 1,770,174.23'

Tag	Bearing	Dist.	Description
L1	S 42°57' W	1,630.2'	Threaded Pipe
L2	N 69°11' W	2,191.5'	Gate Post
L3	N 55°42' W	1,237.2'	#47-041-01847
L4	N 00°21' E	673.3'	#47-041-02620
L5	N 05°50' W	470.0'	Landing point

Notes: Well No. Burnside 1214 N-3H
West Virginia Coordinate System of 1927, North Zone
based upon Differential GPS Measurements.
Top Hole coordinates Bottom Hole coordinates
Latitude: 39°07'08.11" Latitude: 39°09'46.58"
Longitude: 80°31'23.37" Longitude: 80°32'32.60"
UTM Zone 17, NAD 1983
Top Hole Coordinates Bottom Hole Coordinates
N: 4,330,091.673m N: 4,334,967.572m
E: 541,237.334m E: 539,550.184m
Plat orientation and corner and well references are
based upon the grid north meridian. Well location
references are based upon the magnetic meridian.

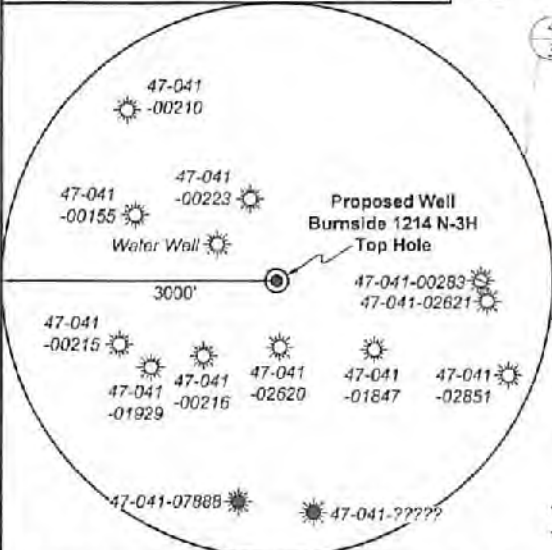

GRID NORTH

RECEIVED
Office of Oil and Gas
APR 21 2022
WV Department of
Environmental Protection



I, the undersigned, hereby certify that this plat is correct to the best of my knowledge and belief and shows all the information required by law and the rules issued and prescribed by the Department of Environmental Protection.
Kevin S. James
Kevin S. James, P.S. 2305

FILE NO: 236-36-12-19
DRAWING NO: Burnside 1214 N-3H Well Plat
SCALE: 1" = 2000'
MINIMUM DEGREE OF ACCURACY: Submeter
PROVEN SOURCE OF ELEVATION: CORS, Bridgeport, WV

STATE OF WEST VIRGINIA
DEPARTMENT OF ENVIRONMENTAL PROTECTION
OIL AND GAS DIVISION

DATE: April 6, 2022
OPERATOR'S WELL NO. Burnside 1214 N-3H
API WELL NO
47 - 041 - 05709
STATE COUNTY PERMIT

WELL TYPE: OIL GAS LIQUID INJECTION WASTE DISPOSAL
(IF GAS) PRODUCTION: STORAGE DEEP SHALLOW
LOCATION: ELEVATION: 1159.2' WATERSHED: Middle West Fork Creek
DISTRICT: Freemans Creek
SURFACE OWNER: John K. Burnside, et al
ROYALTY OWNER: J.S. Hall, et ux, et al LEASE NO: ACREAGE: 214.08
PROPOSED WORK: DRILL CONVERT DRILL DEEPER FRACTURE OR STIMULATE PLUG OFF OLD FORMATION
 PERFORATE NEW FORMATION OTHER PHYSICAL CHANGE IN WELL (SPECIFY) BH-MOD
 PLUG AND ABANDON CLEAN OUT AND REPLUG TARGET FORMATION: Marcellus Shale ESTIMATED DEPTH: 7,289' TVD 23,698' MD

WELL OPERATOR: HG Energy II Appalachia, LLC
ADDRESS: 5260 Dupont Road Parkersburg, WV 26101
DESIGNATED AGENT: Diane C. White
ADDRESS: 5260 Dupont Road Parkersburg, WV 26101

05/13/2022



**Well Location References
Not to Scale**

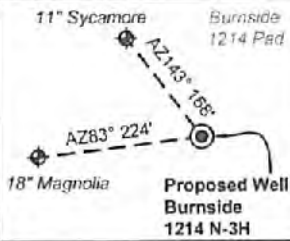

ID	Lease
1	J.S. Hall, et ux
2	W.J. Grant, et ux
7	Hudson Bailey, et ux
11	Ruby L. Klinger, et al
12	Ira L. Queen, et al
14	John L. Burnside, et ux
16	W.G. Bailey
18	Ruth N. Bailey
24	Orna G. Hall, et al
25	Fern M. White, et al
26	J.A. White, et ux
30	Clarence P. McKinley, et ux
49	James K. Coffindaffer, et al

Wellhead Layout (NTS)

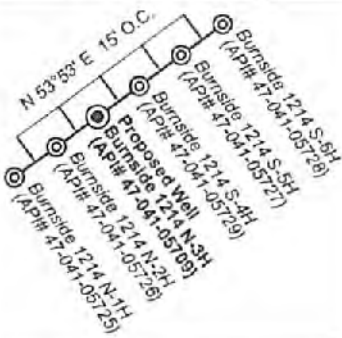

RECEIVED
Office of Oil and Gas
APR 21 2022
WV Department of
Environmental Protection

Lewis Co. - Freeman Creek Dist.

No.	TM / Par	Owner	Bk / Pg	Ac.
1	6C / 3.2	John K. Burnside, et al	666 / 44	115.00
2	5C / 41	Phillip E. Burnside	766 / 831	23.90
3	5C / 34	Kanna K. Rowe	572 / 209	42.00
4	5C / 49	James C. Garrett, et al	621 / 578	28.50
5	5B / 18	Mike Ross Inc.	659 / 215	279.97
6	5C / 33	John W. & Joyce M. Hall	567 / 82	12.30
7	6B / 8	James C. Garrett, et al	621 / 578	47.00
8	6B / 6	James C. Garrett, et al	621 / 578	30.00
9	5B / 39	Edward E. Garrett, et al	429 / 245	55.00
10	6B / 5	Edward E. Garrett, et al	429 / 245	136.00
11	5B / 38	Phillip E. Burnside, et al	666 / 503	75.00
12	5B / 37	Phillip E. Burnside, et al	666 / 503	36.00
13	5B / 32	John & Rhonda Myers	652 / 73	76.64
14	5B / 35	Ruth U. Theofield Living Trust Agreement October 24, 2018	740 / 840	96.69
15	5B / 34	Mannie R. & Doris A. Griffith (LE), et al	652 / 69	20.49
16	5B / 33	Kelly Joanne Burrows Bowie	622 / 463	33.49
17	5A / 44	Charles D. & Samantha L. Brosius	710 / 356	49.90

Harrison Co. - Union-Outside Dist.

No.	TM / Par	Owner	Bk / Pg	Ac.
18	442 / 8.3	William Coffindaffer, et ux (LE)	1585 / 819	114.79
19	442 / 7.1	Stephanie Stalnaker	1674 / 1254	43.24
20	442 / 6	Karen L. & J.C. Hayhurst	1592 / 1194	97.01
21	422 / 29	Karen L. Hayhurst, et al	W198 / 657	48.47
22	422 / 30	Dewain Titus, Jr.	1173 / 1045	89.47
23	422 / 22	Dewain Titus, Jr.	1173 / 1045	43.00
24	422 / 12	Mary Jo Short & Lou Ann Baker	1323 / 663	105.44

Legend

- Proposed gas well
- Well Reference, as noted
- Monument, as noted
- Existing Well, as noted
- Existing Plugged Well, as noted
- Digitized Well, as noted
- Creek or Drain
- Existing Road
- Surface boundary (approx.)
- Adjoinder surface tracts (approx.)

FILE NO: 236-36-12-19
DRAWING NO: Burnside 1214 N-3H Well Plat
SCALE: 1" = 2000'
MINIMUM DEGREE OF ACCURACY:
Submeter
PROVEN SOURCE OF ELEVATION:
CORS, Bridgeport, WV

STATE OF WEST VIRGINIA
DEPARTMENT OF ENVIRONMENTAL PROTECTION
OIL AND GAS DIVISION

DATE: April 6 2022
OPERATOR'S WELL NO. Burnside 1214 N-3H
API WELL NO
47 - 041 - 05709
STATE COUNTY PERMIT

WELL TYPE: OIL GAS LIQUID INJECTION WASTE DISPOSAL
(IF GAS) PRODUCTION: STORAGE DEEP SHALLOW

LOCATION: ELEVATION: 1159.2' WATERSHED: Middle West Fork Creek

QUADRANGLE: Top: Camden
COUNTY: Lewis

DISTRICT: Freemans Creek
SURFACE OWNER: John K. Burnside, et al

ACREAGE: 115.00 05/13/2022

ROYALTY OWNER: J.S. Hall, et ux, et al

LEASE NO: _____ ACREAGE: 214.08

PROPOSED WORK: DRILL CONVERT DRILL DEEPER FRACTURE OR STIMULATE PLUG OFF OLD FORMATION
 PERFORATE NEW FORMATION OTHER PHYSICAL CHANGE IN WELL (SPECIFY) _____ BH-MOD _____

PLUG AND ABANDON CLEAN OUT AND REPLUG TARGET FORMATION: Marcellus Shale ESTIMATED DEPTH: 7,289' TVD 23,698' MD

WELL OPERATOR: HG Energy II Appalachia, LLC
ADDRESS: 5260 Dupont Road
Parkersburg, WV 26101

DESIGNATED AGENT: Diane C. White
ADDRESS: 5260 Dupont Road
Parkersburg, WV 26101