

State of West Virginia  
Department of Environmental Protection - Office of Oil and Gas  
Well Operator's Report of Well Work

API 47 - 041 - 05708 County Lewis District Freemans Creek  
Quad Camden Pad Name Evans 1213 Field/Pool Name Kennedy  
Farm name Evans Well Number Evans 1213 N1HST01  
Operator (as registered with the OOG) HG Energy II Appalachia, LLC  
Address 5260 Dupont Rd. City Parkersburg State WV Zip 26101

As Drilled location NAD 83/UTM Attach an as-drilled plat, profile view, and deviation survey  
Top hole Northing 4329720.786 Easting 541928.470  
Landing Point of Curve Northing 4329864 Easting 542161  
Bottom Hole Northing 4334733.976 Easting 540433.088

Elevation (ft) 1228 GL Type of Well  New  Existing Type of Report  Interim  Final  
Permit Type  Deviated  Horizontal  Horizontal 6A  Vertical Depth Type  Deep  Shallow  
Type of Operation  Convert  Deepen  Drill  Plug Back  Redrilling  Rework  Stimulate  
Well Type  Brine Disposal  CBM  Gas  Oil  Secondary Recovery  Solution Mining  Storage  Other \_\_\_\_\_  
Type of Completion  Single  Multiple Fluids Produced  Brine  Gas  NGL  Oil  Other \_\_\_\_\_  
Drilled with  Cable  Rotary

Drilling Media Surface hole  Air  Mud  Fresh Water Intermediate hole  Air  Mud  Fresh Water  Brine  
Production hole  Air  Mud  Fresh Water  Brine  
Mud Type(s) and Additive(s)  
Air/WBM (gas storage)/OBM  
Barite, Lime, CaCL, base oil, Gilsonite, Asphalt, clay, Emulsifier, sulfatone, safevert FLG, safevert WA

Date permit issued 12/09/2020 Date drilling commenced 5/15/2021 Date drilling ceased 4/13/2022  
Date completion activities began 6/3/2022 Date completion activities ceased 7/16/2022  
Verbal plugging (Y/N) \_\_\_\_\_ Date permission granted \_\_\_\_\_ Granted by \_\_\_\_\_

Please note: Operator is required to submit a plugging application within 5 days of verbal permission to plug

Freshwater depth(s) ft Not observed Open mine(s) (Y/N) depths N  
Salt water depth(s) ft Not observed Void(s) encountered (Y/N) depths N  
Coal depth(s) ft 452,468,530,600,900,1025,1107 Cavern(s) encountered (Y/N) depths N  
Is coal being mined in area (Y/N) No

**APPROVED**

Reviewed by:  
*Thomas A. Luyck*  
5-9-24

06/28/2024

API 47-041 - 05708

Farm name Evans

Well number Evans 1213 N1HST01

CASING STRINGS	Hole Size	Casing Size	Depth	New or Used	Grade wt/ft	Basket Depth(s)	Did cement circulate (Y/N) * Provide details below*
Conductor	30"	30"	120	New	157 lb/ft LS		Drilled in
Surface	26"	20"	824	New	94 lbs/ft J-55		Yes, 64 bbl to surface
Coal							
Intermediate 1	17.5"	13.375"	2068	New	68 lbs/ft J55		Yes, 150 bbl to surface
Intermediate 2	12.25	9.625"	4704	New	40 lbs/ft N80		Yes, 13 bbl to surface
Intermediate 3							
Production	8.5	5.5	24055	New	23 lbs/ft P-110HP		Yes, 120 bbl to surface
Tubing							
Packer type and depth set							

Comment Details \_\_\_\_\_

CEMENT DATA	Class/Type of Cement	Number of Sacks	Slurry wt (ppg)	Yield (ft <sup>3</sup> /sks)	Volume (ft <sup>3</sup> )	Cement Top (MD)	WOC (hrs)
Conductor							
Surface	Class A	1679	15.6	1.18	1981	Surface	8
Coal							
Intermediate 1	Class A	1776/437	16.0/16.4	1.16/1.12	2060/489	Surface	24
Intermediate 2	Class A	523/331	10.5/15.2	2.2/1.25	1150/413.7	Surface	8
Intermediate 3							
Production	Class A	308/538/3520	13.5/13.5/14.8	1.82/1.67/1.34	560/898/4717	Surface	8
Tubing							

Drillers TD (ft) <sup>24080</sup> \_\_\_\_\_ Loggers TD (ft) \_\_\_\_\_  
 Deepest formation penetrated Marcellus Plug back to (ft) \_\_\_\_\_  
 Plug back procedure \_\_\_\_\_

Kick off depth (ft) <sup>5996</sup> \_\_\_\_\_

Check all wireline logs run  caliper  density  deviated/directional  induction  
 neutron  resistivity  gamma ray  temperature  sonic

Well cored  Yes  No Conventional Sidewall Were cuttings collected  Yes  No

DESCRIBE THE CENTRALIZER PLACEMENT USED FOR EACH CASING STRING \_\_\_\_\_  
 20" casing: centralizer every 3 joints to surface  
 13.375" casing: Bow spring centralizer on every joint  
 9.625" casing: Bow spring on first 2 joints then every 3rd joint to 100' from surface  
 5.5" casing: Centralizer run every 3 joints to top of curve (KOP) then centralizers placed every 5 joints to surface

RECEIVED  
Office of Oil and Gas  
FEB 26 2024  
WV Department of Environmental Protection

WAS WELL COMPLETED AS SHOT HOLE  Yes  No DETAILS \_\_\_\_\_

WAS WELL COMPLETED OPEN HOLE?  Yes  No DETAILS \_\_\_\_\_

WERE TRACERS USED  Yes  No TYPE OF TRACER(S) USED \_\_\_\_\_

06/28/2024

API 47- 041 - 05708 Farm name Evans Well number Evans 1213 N1HST01

PERFORATION RECORD

Stage No.	Perforation date	Perforated from MD ft.	Perforated to MD ft.	Number of Perforations	Formation(s)
		See Attached			

Please insert additional pages as applicable.

STIMULATION INFORMATION PER STAGE

Complete a separate record for each stimulation stage.

Stage No.	Stimulations Date	Ave Pump Rate (BPM)	Ave Treatment Pressure (PSI)	Max Breakdown Pressure (PSI)	ISIP (PSI)	Amount of Proppant (lbs)	Amount of Water (bbls)	Amount of Nitrogen/other (units)
			See Attached					

RECEIVED  
Office of Oil and Gas  
FEB 26 2024  
WV Department of  
Environmental Protection

Please insert additional pages as applicable.

06/28/2024

API 47- 041 - 05708 Farm name Evans Well number Evans 1213 N1HST01

<u>PRODUCING FORMATION(S)</u>	<u>DEPTHS</u>	
<u>Marcellus</u>	<u>6760-7175</u> TVD	<u>8453-24080</u> MD
_____	_____	_____
_____	_____	_____
_____	_____	_____

Please insert additional pages as applicable.

GAS TEST  Build up  Drawdown  Open Flow OIL TEST  Flow  Pump  
 SHUT-IN PRESSURE Surface 2899 psi Bottom Hole \_\_\_\_\_ psi DURATION OF TEST 1484 hrs  
 OPEN FLOW Gas 27456 mcfpd Oil \_\_\_\_\_ bpd NGL \_\_\_\_\_ bpd Water 456 bpd GAS MEASURED BY  Estimated  Orifice  Pilot

LITHOLOGY/ FORMATION	TOP	BOTTOM	TOP	BOTTOM	DESCRIBE ROCK TYPE AND RECORD QUANTITY AND TYPE OF FLUID (FRESHWATER, BRINE, OIL, GAS, H <sub>2</sub> S, ETC)
	DEPTH IN FT NAME TVD	DEPTH IN FT TVD	DEPTH IN FT MD	DEPTH IN FT MD	
	0		0		
					See Attached
					RECEIVED Office of Oil and Gas
					FEB 26 2024
					WV Department of Environmental Protection

Please insert additional pages as applicable.

Drilling Contractor Precision Drilling  
 Address 10350 Richmond Ave. City Houston State TX Zip 77042  
 Logging Company Renegade Wireline Services  
 Address 191 Earnhardt Rd. City Hunker State PA Zip 15639  
 Cementing Company Schlumberger  
 Address 300 Schlumberger Dr. City Sugar Land State TX Zip 77478  
 Stimulating Company Nextier  
 Address 8300 Route 119 North City Black Lick State PA Zip 15716  
 Please insert additional pages as applicable.

Completed by Diane White Telephone 304-420-1119  
 Signature \_\_\_\_\_ Title \_\_\_\_\_ Date 2/21/2014

Submittal of Hydraulic Fracturing Chemical Disclosure Information Attach copy of FRACFOCUS Registry

06/28/2024

**HG Energy II Appalachia, LLC**

**Evans 1213 N-1H**

**Perforation Record**

Stage #	Date	Perforation From Depth	Perforation to Depth	Number of Perforations	Formation
Sleeve/1	6/5/2022	24007	23984	2	Marcellus
2	6/5/2022	23950	23782	32	Marcellus
3	6/5/2022	23754	23586	32	Marcellus
4	6/5/2022	23558	23390	32	Marcellus
5	6/6/2022	23362	23194	32	Marcellus
6	6/6/2022	23166	22998	32	Marcellus
7	6/6/2022	22970	22802	32	Marcellus
8	6/7/2022	22774	22606	32	Marcellus
9	6/7/2022	22578	22410	32	Marcellus
10	6/7/2022	22382	22214	32	Marcellus
11	6/7/2022	22186	22018	32	Marcellus
12	6/7/2022	21990	21822	32	Marcellus
13	6/8/2022	21794	21626	32	Marcellus
14	6/8/2022	21598	21430	32	Marcellus
15	6/9/2022	21402	21234	32	Marcellus
16	6/9/2022	21206	21038	32	Marcellus
17	6/9/2022	21010	20842	32	Marcellus
18	6/10/2022	20814	20646	32	Marcellus
19	6/10/2022	20618	20450	32	Marcellus
20	6/10/2022	20422	20254	32	Marcellus
21	6/11/2022	20226	20058	32	Marcellus
22	6/11/2022	20030	19862	32	Marcellus
23	6/11/2022	19834	19666	32	Marcellus
24	6/11/2022	19638	19470	32	Marcellus
25	6/12/2022	19442	19274	32	Marcellus
26	6/12/2022	19246	19078	32	Marcellus
27	6/12/2022	19050	18882	32	Marcellus
28	6/12/2022	18854	18686	32	Marcellus
29A	6/12/2022	18658	18490	32	Marcellus
29B	6/13/2022	18658	18467	60	Marcellus
30	6/13/2022	18437	18283	32	Marcellus
31	6/13/2022	18253	18098	32	Marcellus
32	6/13/2022	18070	17902	32	Marcellus
33	6/14/2022	17874	17706	32	Marcellus
34	6/14/2022	17678	17510	32	Marcellus
35	6/14/2022	17482	17314	32	Marcellus
36	6/15/2022	17286	17118	32	Marcellus
37	6/15/2022	17090	16922	32	Marcellus
38	6/15/2022	16894	16726	32	Marcellus
39	6/15/2022	16698	16530	32	Marcellus
40	6/16/2022	16502	16334	32	Marcellus
41	6/16/2022	16306	16138	32	Marcellus
42	6/16/2022	16110	15942	32	Marcellus
43	6/30/2022	15914	15746	32	Marcellus
44	7/1/2022	15718	15550	32	Marcellus
45	7/1/2022	15522	15354	32	Marcellus
46	7/1/2022	15326	15158	32	Marcellus
47	7/2/2022	15130	14962	32	Marcellus
48	7/2/2022	14934	14766	32	Marcellus
49	7/2/2022	14738	14570	32	Marcellus
50	7/2/2022	14542	14374	32	Marcellus
51	7/3/2022	14346	14178	32	Marcellus
52	7/3/2022	14150	13982	32	Marcellus

06/28/2024

53	7/3/2022	13954	13786	32	Marcellus
54	7/3/2022	13758	13590	32	Marcellus
55	7/4/2022	13562	13394	32	Marcellus
56	7/4/2022	13366	13198	32	Marcellus
57	7/4/2022	13170	13002	32	Marcellus
58	7/5/2022	12974	12806	32	Marcellus
59	7/5/2022	12778	12610	32	Marcellus
60	7/5/2022	12582	12414	32	Marcellus
61	7/6/2022	12386	12218	32	Marcellus
62	7/6/2022	12190	12022	32	Marcellus
63	7/7/2022	11994	11826	32	Marcellus
64	7/7/2022	11798	11630	32	Marcellus
65	7/7/2022	11602	11434	32	Marcellus
66	7/8/2022	11406	11238	32	Marcellus
67	7/8/2022	11210	11042	32	Marcellus
68	7/9/2022	11014	10846	32	Marcellus
69	7/9/2022	10818	10650	32	Marcellus
70	7/10/2022	10622	10454	32	Marcellus
71	7/10/2022	10426	10258	32	Marcellus
72	7/10/2022	10230	10062	32	Marcellus
73	7/10/2022	10034	9866	32	Marcellus
74	7/11/2022	9838	9670	32	Marcellus
75	7/11/2022	9642	9474	32	Marcellus
76	7/11/2022	9446	9278	32	Marcellus
77	7/11/2022	9250	9082	32	Marcellus
78	7/12/2022	9054	8886	32	Marcellus
79	7/12/2022	8859	8691	32	Marcellus
80	7/12/2022	8665	8497	32	Marcellus
81	7/12/2022	8471	8303	32	Marcellus
82	7/13/2022	8277	8109	32	Marcellus
83	7/13/2022	8083	7915	32	Marcellus
84	7/13/2022	7889	7721	32	Marcellus
85	7/13/2022	7695	7527	32	Marcellus
86	7/14/2022	7501	7333	32	Marcellus
87	7/14/2022	7307	7163	28	Marcellus

RECEIVED  
Office of Oil and Gas  
FEB 26 2024  
WV Department of  
Environmental Protection

06/28/2024

**HG Energy II Appalachia, LLC**

**Evans 1213 N-1H**

**Stimulation Summary**

Stage #	Date	Ave Pump Rate (BPM)	Ave Treatment Press (PSI)	Max Breakdown Pressure (PSI)	ISIP (PSI)	Proppant (LBS)	Water (BBLs)
Sleeve/1	6/5/2022	69.0	8870	12110	4114	270000	7,618
2	6/5/2022	85.5	9,958	5,880	5,250	700200	15,163
3	6/5/2022	87.1	9,999	6,001	5,551	700200	14,795
4	6/5/2022	90.0	10,080	5,968	5,421	702500	12,681
5	6/6/2022	89.0	10,244	6,650	5,130	702500	13,096
6	6/6/2022	93.5	10,185	5,946	5,701	705000	11,754
7	6/6/2022	89.9	10,033	5,781	5,553	705000	11,744
8	6/7/2022	92.0	10,238	6,779	5,567	705000	10,205
9	6/7/2022	94.0	10,312	5,843	5,486	705000	10,106
10	6/7/2022	92.0	10,181	5,846	5,485	705000	10,086
11	6/7/2022	99.2	10,459	5,770	5,354	705000	9,927
12	6/7/2022	91.0	10,317	6,460	5,439	705000	9,934
13	6/8/2022	84.9	9,595	5,748	5,127	705000	10,188
14	6/8/2022	85.0	9,696	6,315	5,602	705100	9,775
15	6/9/2022	84.0	9,778	7,194	5,453	705000	9,830
16	6/9/2022	82.0	9,866	7,170	6,061	705000	10,963
17	6/9/2022	82.0	9,598	6,624	5,475	705000	9,975
18	6/10/2022	84.0	9,778	6,416	5,453	705000	9,830
19	6/10/2022	87.0	10,397	6,078	5,557	705000	9,963
20	6/10/2022	88.5	10,435	7,511	5,695	705000	9,852
21	6/11/2022	83.0	10,224	6,280	5,636	705100	9,824
22	6/11/2022	82.0	10,007	6,834	5,328	517000	11,489
23	6/11/2022	91.8	10,483	6,335	5,031	705000	9,672
24	6/11/2022	88.7	10,290	6,600	5,613	705000	9,393
25	6/12/2022	87.0	10,356	5,712	5,738	705000	9,772
26	6/12/2022	96.0	10,252	5,793	5,222	704900	9,927
27	6/12/2022	95.0	10,185	6,136	5,547	705000	9,735
28	6/12/2022	91.2	10,453	5,949	5,122	705060	9,835
29A	6/12/2022	69.5	10,545	5,486	N/A	19300	4,219
29B	6/13/2022	91.0	10,031	5,486	4,953	705000	9,849
30	6/13/2022	87.0	10,077	6,160	5,178	675000	9,868
31	6/13/2022	88.0	9,857	6,329	5,132	685000	9,669
32	6/13/2022	86.0	9,733	6,248	5,924	705000	9,830
33	6/14/2022	87.0	10,033	6,549	5,467	679900	10,446
34	6/14/2022	88.6	9,850	6,020	6,152	679900	9,615
35	6/14/2022	91.0	10,149	6,213	5,305	680040	9,705
36	6/15/2022	88.0	9,761	6,289	4,127	427000	7,267
37	6/15/2022	94.2	10,125	5,766	5,217	680000	9,665
38	6/15/2022	90.4	9,643	6,433	5,391	680000	9,682
39	6/15/2022	95.6	10,147	6,700	5,539	680000	9,519
40	6/16/2022	92.0	10,092	6,600	5,697	680000	9,578
41	6/16/2022	92.0	10,087	6,206	5,215	680100	9,583
42	6/16/2022	94.3	10,181	5,236	5,529	680040	9,713
43	6/30/2022	96.0	10,285	5,779	5,820	680000	9,212
44	7/1/2022	97.0	10,229	5,324	5,101	680000	9,568
45	7/1/2022	94.9	10,112	6,074	5,356	680000	10,989
46	7/1/2022	98.3	10,254	5,893	4,952	680000	9,863
47	7/2/2022	95.0	10,132	5,962	5,227	680000	9,124
48	7/2/2022	92.6	10,083	5,951	4,615	680000	06/28/2024
49	7/2/2022	95.5	9,668	5,486	5,654	680000	8,971
50	7/2/2022	88.0	9,194	6,358	4,689	680000	10,627
51	7/3/2022	87.0	9,670	5,043	5,700	680000	9,599
52	7/3/2022	90.0	9,525	5,956	5,253	680000	9,642
53	7/3/2022	89.0	9,354	5,957	5,220	664644	10,693

54	7/3/2022	96.2	9,687	5,840	4,944	680000	10,023
55	7/4/2022	93.0	9,667	5,741	5,070	605600	9,936
56	7/4/2022	91.7	10,124	5,492	4,570	680000	9,280
57	7/4/2022	89.9	9,820	5,958	443	680000	9,230
58	7/5/2022	89.5	9,738	5,218	4,524	680000	9,329
59	7/5/2022	94.0	10,149	5,950	5,293	680000	9,368
60	7/5/2022	105.2	9,900	6,000	5,287	680000	9,054
61	7/6/2022	93.0	8,896	5,468	5,000	680000	9,229
62	7/6/2022	102.6	10,048	6,625	4,710	680000	9,136
63	7/7/2022	104.0	9,874	6,152	4,935	652800	8,899
64	7/7/2022	97.0	9,081	5,800	5,272	680000	9,336
65	7/7/2022	97.8	9,343	6,618	5,388	680000	10,866
66	7/8/2022	103.3	10,135	6,142	5,256	680000	9,250
67	7/8/2022	104.0	9,907	4,852	4,296	620000	10,491
68	7/9/2022	102.5	9,852	6,336	5,198	532927	9,993
69	7/9/2022	100.0	9,310	5,712	5,201	680000	9,633
70	7/10/2022	99.0	8,631	6,119	5,672	680000	9,373
71	7/10/2022	99.0	8,779	6,130	5,600	680000	9,655
72	7/10/2022	99.0	8,999	6,055	5,371	680000	11,353
73	7/10/2022	102.1	8,996	5,851	5,051	680000	10,618
74	7/11/2022	98.0	8,419	5,880	5,571	680300	10,542
75	7/11/2022	104.8	9,636	5,012	4,841	680050	9,294
76	7/11/2022	109.0	9,602	5,177	4,955	680010	8,883
77	7/11/2022	107.0	9,429	6,031	4,787	684100	10,436
78	7/12/2022	104.0	8,608	5,224	4,654	680000	9,134
79	7/12/2022	103.8	8,583	5,532	4,885	680000	9,061
80	7/12/2022	108.4	9,147	5,648	5,130	680000	9,254
81	7/12/2022	98.0	9,198	5,340	5,148	680000	9,990
82	7/13/2022	108.2	9,156	5,648	4,320	680000	9,202
83	7/13/2022	105.6	8,439	6,148	5,081	680000	10,414
84	7/13/2022	108.5	8,710	5,562	6,180	680000	8,950
85	7/13/2022	104.0	8,761	5,566	4,990	680000	9,735
86	7/14/2022	93.8	8,108	5,189	4,609	680580	9,363
87	7/14/2022	97.3	8100	6805	4931	680700	10728

RECEIVED  
Office of Oil and Gas  
FEB 26 2024  
WV Department of  
Environmental Protection

06/28/2024



**HG Energy II Appalachia, LLC**

**Lithology Record**

**Evans 1213 N-1H**

Formation	Top MD	Top TVD	Base MD	Base TVD	
Coal	452	452	455	455	
Coal	468	468	471	471	
Coal	530	530	533	533	
Coal	600	600	603	603	
Gas Sand	680	680	840	840	
1st salt sand	888	888	933	933	
Coal	900	900	902	902	
Coal	1025	1025	1028	1028	
2nd salt sand	1086	1086	1139	1139	
Coal	1107	1107	1109	1109	
Surface Casing	842		824		set
3rd salt sand	1233	1233	1286	1286	
Little Lime	1501	1501	1521	1521	
Greenbrier Big Lime	1551	1551	1621	1621	
T - Pocono Big Injun	1622	1621	1719	1719	
Gantz	1892	1892	1953	1952	
Fifty foot Sand	2004	2003	2021	2020	
Casing depth	2090		2068		set
Thirty foot Sand	2098	2097	2131	2130	
Gordon Stray sand	2147	2146	2185	2184	
Gordon sand	2185	2184	2259	2257	
5th sand	2392	2390	2428	2427	
Bayard sand	2476	2474	2498	2496	
Warren	2797	2795	2826	2824	
Speechley	3102	3099	3120	3118	
Balltown	3319	3316	3414	3411	
Benson	4432	4408	4463	4438	
9 5-/8" casing depth	4734		4704		set
Rhinestreet	6036	5950	6405	6298	
Cashaqua	6280	6181	6508	6392	
Middlesex	6508	6392	6593	6467	
West River	6593	6467	6728	6573	
Burket	6728	6573	6761	6596	
Tully	6761	6596	6931	6697	
Hamilton	6931	6697	7087	6760	
Marcellus shale	7087	6760	24080	7175	

RECEIVED  
Office of Oil and Gas  
FEB 26 2024  
WV Department of  
Environmental Protection

06/28/2024

HG Energy II Appalachia, LLC  
Well No. Evans 1213 N-1H  
As-Drilled  
Page 1 of 2

9,123' to Bottom Hole

4,308' to Top Hole

TOP LATITUDE 39 - 07 - 30  
BTM LATITUDE 39 - 10 - 00

LONGITUDE 80 - 30 - 00  
3,444' to Top Hole

2,141' to Bottom Hole

Tag	Bearing	Dist.	Description
L1	N 88°37' W	1,089.6'	#47-041-02619
L2	S 67°22' E	1,349.5'	#47-041-01847
L3	S 26°33' E	489.9'	Gate Post
L4	S 10°59' E	2,462.2'	5/8" Rebar w/cap



I, the undersigned, hereby certify that this plat is correct to the best of my knowledge and belief and shows all the information required by law and the rules issued and prescribed by the Department of Environmental Protection.

*Kevin S. James*  
Kevin S. James, P.S. 2305

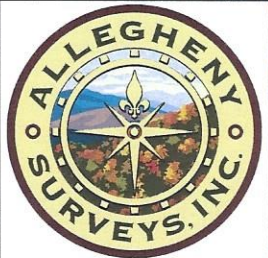

Notes:  
Well No. Evans 1213 N-1H  
UTM NAD 1983 (USSF)  
Top Hole Coordinates  
N: 14,205,092.28'  
E: 1,777,976.99'  
Landing Point Coordinates  
N: 14,205,561.73'  
E: 1,778,739.18'  
Bottom Hole Coordinates  
N: 14,221,539.72'  
E: 1,773,070.89'

Notes: Well No. Evans 1213 N-1H  
West Virginia Coordinate System of 1927, North Zone  
based upon Differential GPS Measurements.  
Top Hole coordinates    Bottom Hole coordinates  
Latitude: 39°06'55.95"    Latitude: 39°09'38.84"  
Longitude: 80°30'54.67"    Longitude: 80°31'55.86"  
UTM Zone 17, NAD 1983  
Top Hole Coordinates    Bottom Hole Coordinates  
N: 4,329,720.786m    N: 4,334,733.976m  
E: 541,928.470m    E: 540,433.088m  
Plat orientation and corner and well references are based upon the grid north meridian. Well location references are based upon the magnetic meridian.

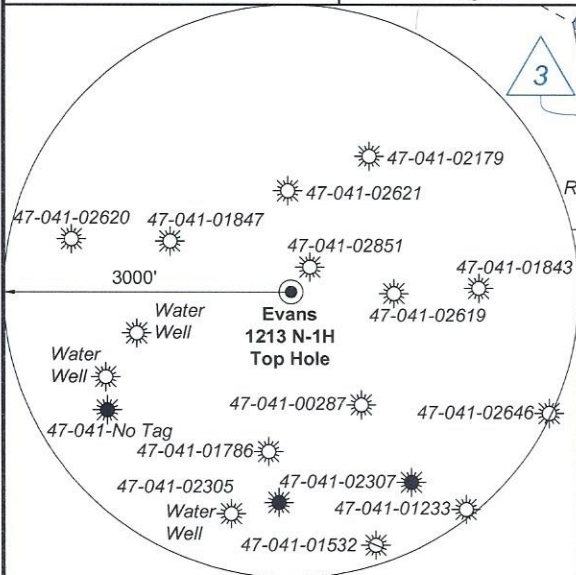

Note: 1 water wells was found within 2000' of proposed well. No occupied dwellings or buildings 2,500 square feet or larger used to house or shelter dairy cattle or poultry husbandry are located within 625' of the center of the well pad.

FILE NO: 235-36-12-19  
DRAWING NO: Evans 1213 N-1H Well Plat  
SCALE: 1" = 2000'  
MINIMUM DEGREE OF ACCURACY: Submeter  
PROVEN SOURCE OF ELEVATION: CORS, Bridgeport, WV

**STATE OF WEST VIRGINIA**  
DEPARTMENT OF ENVIRONMENTAL PROTECTION  
**OIL AND GAS DIVISION**

DATE: November 8 2022  
OPERATOR'S WELL NO. Evans 1213 N-1H  
API WELL NO  
47 - 041 - 05708  
STATE COUNTY PERMIT

WELL TYPE:  OIL  GAS  LIQUID INJECTION  WASTE DISPOSAL  
(IF GAS) PRODUCTION:  STORAGE  DEEP  SHALLOW

LOCATION: ELEVATION: 1,227.6' WATERSHED: Middle West Fork Creek  
DISTRICT: Freemans Creek  
SURFACE OWNER: James M. & Suzanne L. Evans  
ROYALTY OWNER: Mary C. Burnside, et al, et al LEASE NO: ACREAGE: 294.00

PROPOSED WORK:  DRILL  CONVERT  DRILL DEEPER  FRACTURE OR STIMULATE  PLUG OFF OLD FORMATION  
 PERFORATE NEW FORMATION  OTHER PHYSICAL CHANGE IN WELL (SPECIFY) As-Drilled 7,175' TVD  
 PLUG AND ABANDON  CLEAN OUT AND REPLUG TARGET FORMATION: Marcellus Shale ESTIMATED DEPTH: 24,080' MD

WELL OPERATOR: HG Energy II Appalachia, LLC DESIGNATED AGENT: Diane C. White  
ADDRESS: 5260 Dupont Road ADDRESS: 5260 Dupont Road  
Parkersburg, WV 26101 Parkersburg, WV 26101

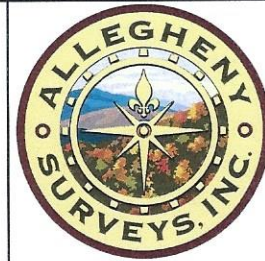

Well Location References  
Not to Scale

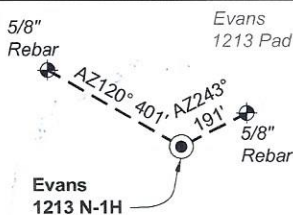

ID	Lease
3	C.M. Garrett, et al
4	Ira L. Queen, et al
5	Will E. Morris, et al
6	Clara Queen, et vir, et al
14	Oma G. Hall, et al
16	Flodia B. Smith, et al
18	Lizzie B. Conley
20	W.T. Highland, et al
26	J.S. Norris
27	Stephen Queen, et al
28	Silas E. Gochenour, et ux, et al
29	Lowman E. Garrett, et al
30	J.S. Hall, et ux
31	Mary C. Burnside, et al

Wellhead Layout (NTS)

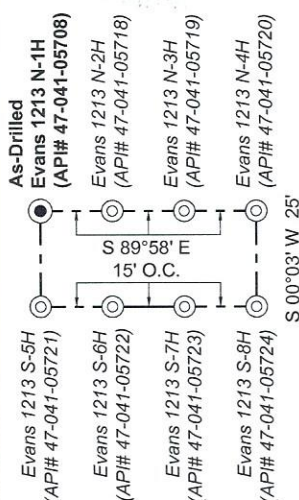

Legend

- Proposed gas well
- Well Reference, as noted
- Monument, as noted
- Existing Well, as noted
- Existing Plugged Well, as noted
- Digitized Well, as noted
- Creek or Drain
- Existing Road
- Surface boundary (approx.)
- Adjoiner surface tracts (approx.)

Lewis Co. - Freeman Creek Dist.

No.	TM / Par	Owner	Bk / Pg	Ac.
1	6C / 4	Suzanne L. & James M. Evans, III	657 / 228	294.00
2	6C / 21	Clarence C. Thacker, et al	445 / 493	166.25
3	6C / 3.2	John K. Burnside & Bertha F. Benedum	666 / 44	115.00
4	6C / 3	Phillip E. Burnside, et al	666 / 38	87.20
5	6C / 1	Brenda A. Stout, et al	W33 / 607	25.50
6	6C / 2	Phillip E. Burnside, et al	666 / 38	17.00
7	6B / 10	Michael Terrel Moss, et al	340 / 693	112.00
8	6B / 8	James C. Garrett, et al	621 / 578	47.00
9	6B / 7	Michael Terrel Moss, et al	340 / 693	10.00
10	6B / 6	James C. Garrett, et al	621 / 578	30.00
11	5B / 39	Edward E. Garrett, et al	429 / 245	55.00
12	6B / 5	Edward E. Garrett, et al	429 / 245	136.00
13	5B / 41	Michael J. Kirwan, III	720 / 812	51.00
14	5B / 36	James C. Garrett, et al	621 / 578	64.00
15	6B / 4	James C. Garrett, et al	621 / 578	92.50
16	5B / 35	Ruth U. Theofield Living Trust	740 / 840	96.69
17	6B / 2	Edward & Theresa M. Paugh (L/E)	746 / 831	78.25
18	5C / 47	James C. Garrett, et al	621 / 578	1.50

Harrison Co. - Union-Outside Dist.

No.	TM / Par	Owner	Bk / Pg	Ac.
19	442 / 8.3	William Coffindaffer, et ux (LE)	1585 / 819	114.79
20	442 / 8	Mark J. Coffindaffer, et al	W160 / 415	119.78
21	442 / 8.1	Barbara Dawson & Misha McDonnie	W175 / 240	1.11
22	442 / 9.2	John R. & Jennifer L. Paugh	1365 / 585	5.59
23	442 / 7	Michael A. & Sarah G. Weaver	1592 / 1189	61.10
24	422 / 33	Mark J. Coffindaffer, et al	W160 / 415	125.70
25	422 / 32	Mike Ross, Inc.	1483 / 698	101.00
26	422 / 15.3	Carol Ann Nay, et al	1560 / 362	83.83
27	442 / 8.2	Pleasant Hill M.E. Church Trustees	188 / 197	0.40

FILE NO: 235-36-12-19  
DRAWING NO: Evans 1213 N-1H Well Plat  
SCALE: 1" = 2000'  
MINIMUM DEGREE OF ACCURACY:  
Submeter  
PROVEN SOURCE OF ELEVATION:  
CORS, Bridgeport, WV

STATE OF WEST VIRGINIA  
DEPARTMENT OF ENVIRONMENTAL PROTECTION  
OIL AND GAS DIVISION

DATE: November 8 2022  
OPERATOR'S WELL NO. Evans 1213 N-1H  
API WELL NO  
47 - 041 - 05708  
STATE COUNTY PERMIT

WELL TYPE:  OIL  GAS  LIQUID INJECTION  WASTE DISPOSAL  
(IF GAS) PRODUCTION:  STORAGE  DEEP  SHALLOW

LOCATION: ELEVATION: 1,227.6' WATERSHED: Middle West Fork Creek

DISTRICT: Freemans Creek

SURFACE OWNER: James M. & Suzanne L. Evans

ROYALTY OWNER: Mary C. Burnside, et al, et al

LEASE NO: \_\_\_\_\_ ACREAGE: 294.00

PROPOSED WORK:  DRILL  CONVERT  DRILL DEEPER  FRACTURE OR STIMULATE  PLUG OFF OLD FORMATION  
 PERFORATE NEW FORMATION  OTHER PHYSICAL CHANGE IN WELL (SPECIFY) As-Drilled

PLUG AND ABANDON  CLEAN OUT AND REPLUG TARGET FORMATION: Marcellus Shale ESTIMATED DEPTH: 24,080' MD

WELL OPERATOR: HG Energy II Appalachia, LLC

DESIGNATED AGENT: Diane C. White

ADDRESS: 5260 Dupont Road

ADDRESS: 5260 Dupont Road

Parkersburg, WV 26101

Parkersburg, WV 26101

QUADRANGLE: Top: Camden  
Bottom: Big Isaac

COUNTY: Lewis  
ACREAGE: 294.00  
06/28/2024

7,175' TVD

Fracture Start Date/Time:	6/5/22 7:24
Fracture End Date/Time:	7/14/22 13:50
State:	West Virginia
County:	Lewis
API Number:	47-041-05708-0000
Operator Number:	1213 NHH
Well Name:	No
Federal Well:	No
Tribal Well:	No
Longitude:	-80.5149959
Latitude:	39.115628
Long/Lat Projection:	NAD83
True Vertical Depth (TVD):	7,176'
Total Clean Fluid Volume* (gal):	37,828,006

Additive	Specific Gravity	Additive Quantity	Mass (lbs)
Water	1.00	37,828,006	315,674,710
Proppant (Sand)	2.65	58,676,738	58,676,738
15% HCl	1.08	87,662	790,063
NCl-25	0.95	2,894	22,953
3rd Party RR		47,901	
3rd Party Bioocde		9,058	
3rd Party Sealant		515	
3rd Party Corrosion Inhibitor		10,248	
3rd Party Clay Control		131	
Total Slurry Mass (lbs)			375,164,454

**Ingredients Section:**

Trade Name	Supplier	Purpose	Ingredients	Chemical Abstract Service Number (CAS #)	Maximum Ingredient Concentration in Additive (% by mass)**	Mass per Component (LBS)	Maximum Ingredient Concentration in HF Fluid (% by mass)**	Comments
15% HCl	NexTier	Acid	Hydrochloric Acid	7647-01-0	15.00%	118,509	0.031509%	15% HCl
15% HCl	NexTier	Acid	Water	7732-18-5	85.00%	671,553	0.170009%	15% HCl
Proppant (Sand)	Nextier	Proppant	Crystalline silica; Quartz (SiO2)	14808-60-7	100.00%	58,676,738	15.64027%	Proppant (Sand)
Water	Operator	Carrier/Base Fluid	Water	7732-18-5	100.00%	315,674,710	84.14302%	Water
NCl-25	NexTier	Corrosion Inhibitor	Methanol	67-56-1	60.00%	13,766	0.00362%	NCl-25
NCl-25	NexTier	Corrosion Inhibitor	Ammonium bisulfate	10192-30-0	5.00%	1,147	0.00031%	NCl-25
NCl-25	NexTier	Corrosion Inhibitor	Chitic Acid	77-92-9	5.00%	1,147	0.00031%	NCl-25
NCl-25	NexTier	Corrosion Inhibitor	3-aminopropyl-dimethylamine	109-55-7	1.00%	229	0.00006%	NCl-25
NCl-25	NexTier	Corrosion Inhibitor	Sodium nitrite	7632-00-0	1.00%	229	0.00006%	NCl-25
NCl-25	NexTier	Corrosion Inhibitor	Benzyl Chloride	100-44-7	1.00%	229	0.00006%	NCl-25
NCl-25	NexTier	Corrosion Inhibitor	Cocamidopropyl Dimethylamine	68140-01-2	1.00%	229	0.00006%	NCl-25

**06/28/2024**  
Office of Oil and Gas  
**FEB 26 2024**  
WV Department of Environmental Protection