



1) Date: October 18, 1985
2) Operator's Well No. Fury #1 325-S
3) API Well No. 47 - 041 - 3665
State County Permit

RECEIVED
OCT 28 1985

STATE OF WEST VIRGINIA

DEPARTMENT OF ENERGY, OIL AND GAS DIVISION

DIVISION OF OIL & GAS
DEPARTMENT OF ENERGY

APPLICATION FOR A WELL WORK PERMIT

- 4) WELL TYPE: A Oil / Gas / B (If "Gas", Production / Underground storage / Deep / Shallow /
- 5) LOCATION: Elevation: 1053 Watershed: West Fork River
District: Courthouse 2 County: Lewis Quadrangle: Weston 669
- 6) WELL OPERATOR Stonewall Gas CO CODE: 47850 7) DESIGNATED AGENT Charles W. Canfield
Address P.O. Drawer R Address P.O. Drawer R
Jane Lew, WV 26378 Jane Lew, WV 26378
- 8) OIL & GAS INSPECTOR TO BE NOTIFIED Name Steve Casey (884-7470) 9) DRILLING CONTRACTOR: Name S.W. Jack
Address Rt. 2, Box 232-D Address _____
Jane Lew, WV 26378 Buckhannon, WV 26201
- 10) PROPOSED WELL WORK: Drill / Drill deeper / Redrill / Stimulate /
Plug off old formation / Perforate new formation /
Other physical change in well (specify) _____
- 11) GEOLOGICAL TARGET FORMATION, Elk
- 12) Estimated depth of completed well, 5995 feet
- 13) Approximate trata depths: Fresh, 105 feet; salt, _____ feet.
- 14) Approximate coal seam depths: N/A Is coal being mined in the area? Yes / No /

15) CASING AND TUBING PROGRAM

CASING OR TUBING TYPE	SPECIFICATIONS					FOOTAGE INTERVALS		CEMENT FILL-UP OR SACKS (Cubic feet)	PACKERS	
	Size	Grade	Weight per ft.	New	Used	For drilling	Left in well		Kinds	Sizes
Conductor	11 3/4		42	X		140	140	To surface	NEAT	
Fresh water										
Coal										
Intermediate	8 5/8		23	X		1300	1300	Rule 15.05		
Production	4 1/2		11.5	X		5995	5995	Rule 15.05		
Tubing										
Lin...										

OFFICE USE ONLY
DRILLING PERMIT

Permit number 47-041-3665 Date October 28 1985

This permit covering the well operator and well location shown below is evidence of permission granted to drill in accordance with the pertinent legal requirements subject to the conditions contained herein and on the reverse hereof. Notification must be given to the District Oil and Gas Inspector. (Refer to No. 8) Prior to the construction of roads, locations and pits for any permitted work. In addition, the well operator or his contractor shall notify the proper district oil and gas inspector 24 hours before actual permitted work has commenced.)

The permitted work is as described in the Notice and Application, plat, and reclamation plan, subject to any modifications and conditions specified on the reverse hereof. Permit expires October 28, 1987 unless well work is commenced prior to that date and prosecuted with due diligence.

Bond: <input checked="" type="checkbox"/>	Agent: <input checked="" type="checkbox"/>	Plat: <u>MD</u>	Casing: <u>MD</u>	Fee: <u>2533</u>	WPCP: <u>MD</u>	S&E: <u>MD</u>	Other: <u>MD</u>
---	--	-----------------	-------------------	------------------	-----------------	----------------	------------------

Margaret J. Lasse
Director, Division of Oil and Gas

NOTE: Keep one copy of this permit posted at the drilling location.

See the reverse side of the APPLICANT'S COPY for instructions to the well operator.

12/08/2023 File

OFFICE USE ONLY

PERMIT MODIFICATIONS AND CONDITIONS (IF ANY) TO THE PROPOSED WELL WORK

Name: _____
 Address: _____
 City: _____ State: _____ Zip: _____
 Name: _____
 Address: _____
 City: _____ State: _____ Zip: _____
 Name: _____
 Address: _____
 City: _____ State: _____ Zip: _____

OFFICE USE ONLY

This part of Form WW-2(B) is to record the dates of certain occurrences and any follow-up inspections.

	<u>Date</u>	<u>Date(s)</u>
Application received		Follow-up inspection(s)
Well work started		" "
Completion of the drilling process	October	" "
Well Record received		" "
Reclamation completed		" "

OTHER INSPECTIONS

Reason: _____

Reason: _____

RECEIVED
OCT 28 1985

WW-9 DIVISION OF OIL & GAS
DEPARTMENT OF ENERGY
Recd. (WFSCD)
OCT 17 1985



State of West Virginia
Department of ENERGY
Oil and Gas Division

DATE October 17, 1985
WELL NO. Fury No. 1
API NO. 047 - 041 - 3665

CONSTRUCTION AND RECLAMATION PLAN

COMPANY NAME Stonewall Gas Company

DESIGNATED AGENT Charles Canfield

Address P. O. Drawer R. Jane Lew, WV
Telephone 304-884-7881 26378-0080

Address P. O. Drawer R. Jane Lew, WV
Telephone 304-884-7881 26378-0080

LANDOWNER Elizabeth Aspinal Fury

SOIL CONS. DISTRICT West Fork

Revegetation to be carried out by Stonewall Gas Co., Charles Canfield (Agent)

This plan has been reviewed by West Fork SCD. All corrections and additions become a part of this plan:

10/25/85
(Date)
Kenneth E Knight
(SCD Agent)

ACCESS ROAD

LOCATION

Structure Cross Drain (A)
From 2% grade (every 250')
Spacing to 15% grade (every 60')
with riprapped outlet
Page Ref. Manual 2-1

Structure Diversion Ditch (1)
Material Earthen
Page Ref. Manual 2-12

Structure Culvert (15" min. I.D.) (B)
As illustrated at
Spacing natural drains & accord. to 04 G
with riprapped outlet Manual
Page Ref. Manual 2-7

Structure Hay Bale Dike (2)
Material Staked Hay Bales
Page Ref. Manual 2-18

Structure Broad Based Dip (C)
As illustrated with
Spacing stone or timber (accord. to 04 G
with riprapped outlet Manual)
Page Ref. Manual 2-3

Structure Drainage Ditch (D)
Spacing As illustrated on
Material upper road cuts
Page Ref. Manual 2-12

All structures should be inspected regularly and repaired if necessary. All commercial timber is to be cut and stacked and all brush and small timber to be cut and removed from the site before dirt work begins.

REVEGETATION

Treatment Area I

Lime As determined by pH test Tons/acre
or correct to pH 6.5
Fertilizer 600 lbs/acre
(10-20-20 or equivalent)
Mulch Hay or Straw 2 Tons/acre
Seed* Kentucky 31 Fescue 35 lbs/acre
Birdsfoot Trefoil 10 lbs/acre
Domestic Rye 10 lbs/acre

Treatment Area II

Lime As determined by pH test Tons/acre
or correct to pH 6.5
Fertilizer 600 lbs/acre
(10-20-20 or equivalent)
Mulch Hay or Straw 2 Tons/acre
Seed* Kentucky 31 Fescue 35 lbs/acre
Birdsfoot Trefoil 10 lbs/acre
Domestic Rye 10 lbs/acre

*Inoculate all legumes such as vetch, trefoil and clovers with the proper bacterium. Inoculate with 3X recommended amount.

PLAN PREPARED BY LAND SURVEYING 12/08/2023

ADDRESS 1412 N. 18th Street
Clarksburg, WV 26301

PHONE NO. 304-623-1214

NOTES: Please request landowner's cooperation to protect new seeding for one growing season. Attach separate sheets as necessary for comments.

ATTACH OR PHOTOCOPY SECTION OF INVOLVED TOPOGRAPHIC MAP. QUADRANGLE Weston 7.5 Minute

LEGEND

Well Site 



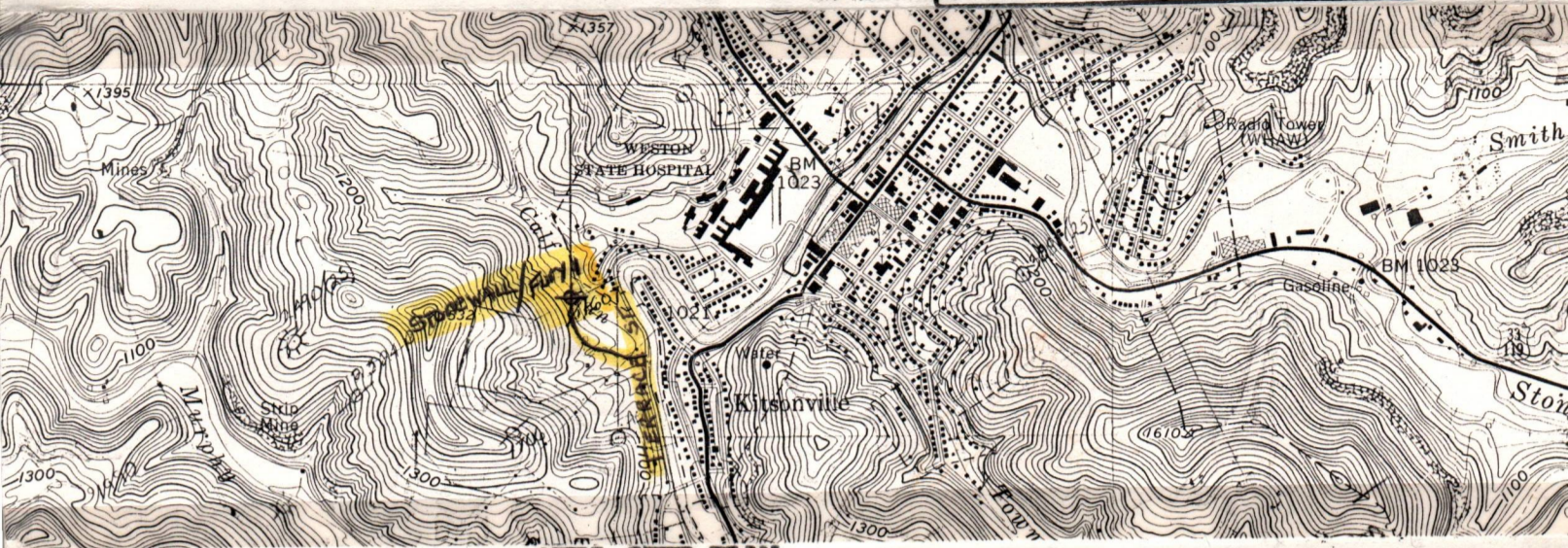





Access Road 

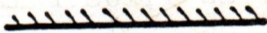

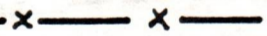
WELL SITE PLAN

Sketch to include well location, existing access road, roads to be constructed, well site, drilling pits and necessary structures numbered or lettered to correspond with the first part of this plan. Include all natural drainage.

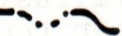
LEGEND

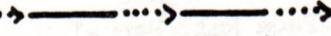
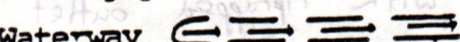
Property boundary 	Diversion 
Road 	Spring 
Existing fence 	Wet spot 
Planned fence 	Building 
Stream 	Drain pipe 
Open ditch 	Waterway 

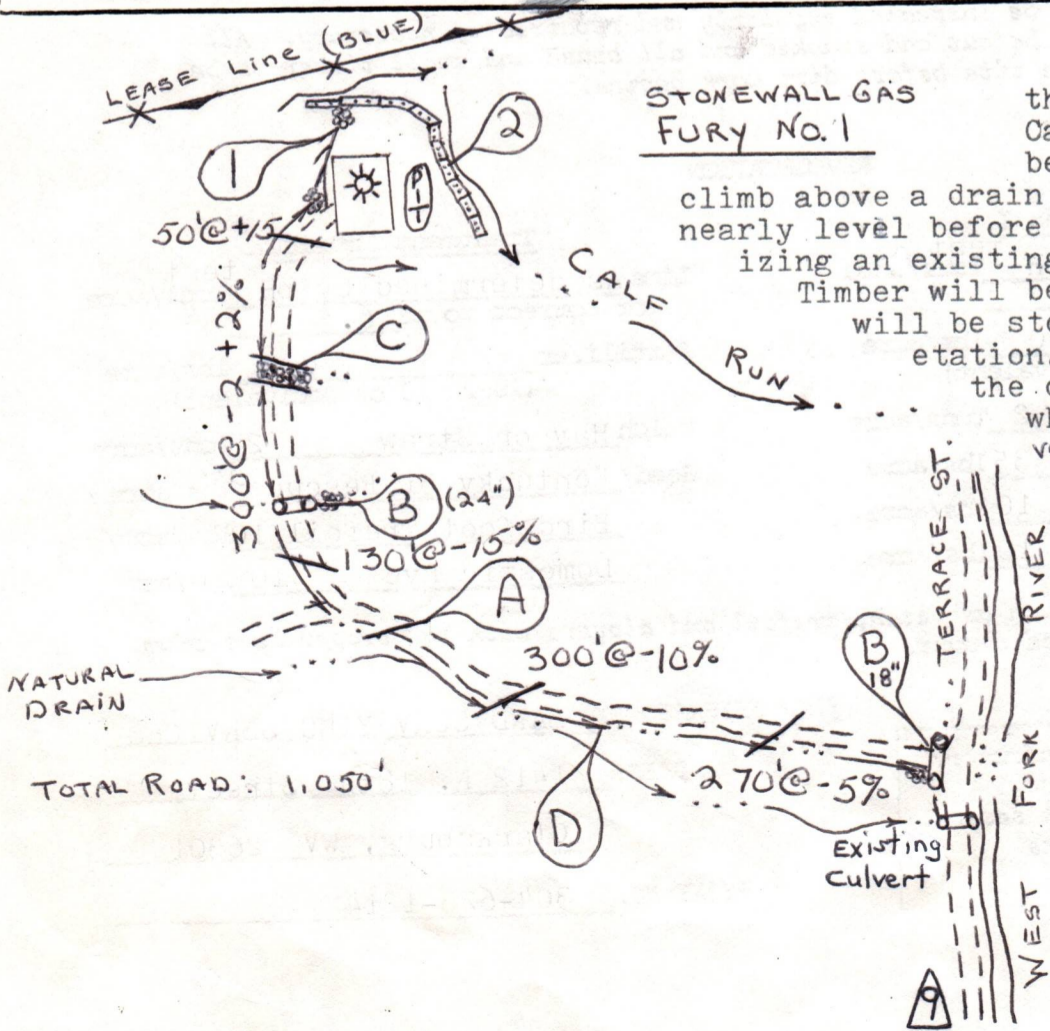

This location is on a thinly wooded bank above Calf Run with th pit just below. The access road will climb above a drain and run out the hillside nearly level before angling down to and utilizing an existing farm access road. Timber will be cut and stacked. Topsoil will be stockpiled for use in revegetation. Place staked hay bales in the ditch lines. Place rock where necessary. Allow natural vegetation to serve as a filter strip.

12/08/2023

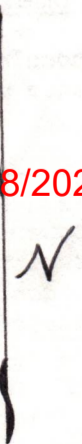

1) Date: October 18, 1985
Operator's
2) Well No. Fury #1 325-S
3) API Well No. 47 - 041 - 3665
State County Perm

STATE OF WEST VIRGINIA
DEPARTMENT OF ENERGY, DIVISION OF OIL & GAS

NOTICE OF APPLICATION FOR A WELL WORK PERMIT

4) SURFACE OWNER(S) OF RECORD TO BE SERVED

- (i) Name Elizabeth Aspinall Fury
Address 120 West Second Street
Weston, WV 26452
- (ii) Name _____
Address _____
- (iii) Name _____
Address _____

5 (i) COAL OPERATOR N/A
Address _____

5 (ii) COAL OWNER(S) WITH DECLARATION ON RECORD:
Name Elizabeth Aspinall Fury et vir
Address 120 West Second Street
Weston, WV 26452

Name _____
Address _____

5 (iii) COAL LESSEE WITH DECLARATION ON RECORD:
Name N/A
Address _____

TO THE PERSON(S) NAMED ABOVE: You should have received this Form and the following documents:

- (1) The Application for a Well Work Permit on Form WW-2(B) which sets out the parties involved in the drilling or other work, and describes the well and its location and, if applicable, the proposed casing and cementing program;
- (2) The plat (surveyor's map) showing the well location on Form WW-6, and
- (3) The Construction and Reclamation Plan on Form WW-9 (unless the well work is only to plug a well), which sets out the plan for erosion and sediment control and for reclamation for the site and access road.

THE REASON YOU RECEIVED THESE DOCUMENTS IS THAT YOU HAVE RIGHTS REGARDING THE APPLICATION WHICH ARE SUMMARIZED IN THE "INSTRUCTIONS" ON THE REVERSE SIDE OF THE COPY OF THE APPLICATION WW-2(B) DESIGNATED FOR YOU. HOWEVER, YOU ARE NOT REQUIRED TO TAKE ANY ACTION AT ALL.

Take notice that under Chapter 22B of the West Virginia Code, the undersigned well operator proposes to file or has filed this Notice and Application and accompanying documents for a Well Work Permit with the Director of the Division of Oil and Gas, with respect to a well at the location described on attached Application and depicted on attached Form WW-6. Copies of this Notice, the Application, the plat, and the Construction and Reclamation Plan have been mailed by registered or certified mail or delivered by hand to the person(s) named above (or by publication in certain circumstances) on or before the day of mailing or delivery to the Director of the Division of Oil and Gas.

6) EXTRACTION RIGHTS

Check and provide one of the following:

- Included is the lease or leases or other continuing contract or contracts by which I hold the right to extract oil or gas.
- The requirement of Code 22B-1-8(c)(1) through (4). (see reverse side for specifics.)

7) ROYALTY PROVISIONS

Is the right to extract, produce or market the oil or gas based upon a lease or leases or other contract or contracts providing for flat well royalty or any similar provision for compensation to the owner of the oil or gas in place which is not inherently related to the volume of oil or gas so extracted, produced or marketed? Yes No

If the answer above is No, nothing additional is needed. If the answer is Yes, you may use Affidavit Form WW-60.

See the reverse side for line item instructions, and for instructions concerning the required copies of the Notice and Application, plat, and Construction and Reclamation Plan.

The truth of the information on the Notice and Application is verified and sworn to and the Notice is signed on behalf of the Well Operator in my County and State by

Benjamin A. Hardesty, Vice President,
this 18th day of October, 19 85
My commission expires JAN. 16, 1991.

[Signature]
Notary Public, Lewis County,
State of West Virginia

WELL OPERATOR Stonewall Gas Company

By Benjamin A. Hardesty
Its Vice President
Address P.O. Drawer R
Jane Lew, WV 26378
Telephone 304-884-7881

RECEIVED
OCT 28 1985
DIVISION OF OIL & GAS
DEPARTMENT OF ENERGY

I N S T R U C T I O N S T O A P P L I C A N T

CONCERNING THE LINE ITEMS:

- 1) Date of Notice.
- 2) Your well name and number.
- 3) To be filled out by the Division of Oil & gas.
- 4) & 5) Use separate sheet if necessary.
- 4) Surface owner(s) of record to be served with Notice and Application. However, see also Code §22B-1-9(b) if "more than three tenants in common or other co-owners of interest described in subsection (a) of this section hold interests in such lands".
- 5(i) "Coal Operator" means any person, firm, partnership, partnership association or corporation that proposes to or does operate a coal mine.
- 5(ii, iii) See Code §22B-1-36.
- 6) See Code §22-4-11(c). However, in lieu of filing the lease(s) or other continuing contract(s), the Applicant may fill out the information in the space provided below.
- 7) See Code § § 22-4-11 (d, e).

CONCERNING THE REQUIRED COPIES FOR FILING AND SERVICE:

Filing. Code §22B-1-6 and Regulation 7.02 provide that the original and required copies of the Notice and Application must be filed with the Administrator, accompanied by (i) a plat in the form prescribed by Regulation 11, (ii) a bond in one of the forms prescribed by Regulation 12, or in lieu thereof the other security allowed by Code §22B-1-2C and the reclamation required by Code §22B-1-30 and Regulation 23, (iv) unless previously paid on the same well, the fees required by Code §22B-1-2(c) and 22B-1-29, and (v) if applicable, the consent required by Code §22B-1-21 from the owner of any water well on dwelling within 200 feet of the proposed well.

Service. In addition, service must be made on the surface owner(s) and the person(s) with an interest in the coal. See Code § § 22B-1-9, 22-B-1-13 and 22B-1-14.

INFORMATION SUPPLIED UNDER CODE §22B-1-8(d)
IN LIEU OF FILING LEASE(S) AND OTHER CONTINUING CONTRACT(S)

Under the oath required to make the verification on the obverse side of this Notice, I depose and say that I am the person who signed the Notice for the Applicant, and that--

- (1) the tract of land is the same tract described in the Application to which this Notice applies, partly or wholly depicted in the accompanying plat, and described in the Construction and Reclamation Plan;
- (2) the parties and recordation data (if recorded) for lease(s) or other continuing contract(s) by which the Applicant claims the right to extract, produce or market the oil or gas are as follows:

<u>Grantor, lessor, etc.</u>	<u>Grantee, lessee, etc.</u>	<u>Royalty</u>	<u>Book page</u>
Elizabeth Aspinall Fury & William L. Fury	Stonewall Gas Co.	1/8	441/468

12/08/2023

7/85



1) Date: October 10, 1985
 2) Operator's Well No. Fury #1 325-S
 3) API Well No. 47 State 041 County Permit

RECEIVED
OCT 28 1985

STATE OF WEST VIRGINIA
DEPARTMENT OF ENERGY, OIL AND GAS DIVISION

APPLICATION FOR A WELL WORK PERMIT

- 4) DEPARTMENT: A Oil / Gas X /
 B (If "Gas", Production X / Underground storage / Deep / Shallow X /)
- 5) LOCATION: Elevation: 1053 Watershed: West Fork River
 District: Courthouse County: Lewis Quadrangle: Weston
- 6) WELL OPERATOR Stonewall Gas Co. CODE: 7) DESIGNATED AGENT Charles W. Canfield
 Address P.O. Drawer R Address P.O. Drawer R
Jane Lew, WV 26378 Jane Lew, WV 26378
- 8) OIL & GAS INSPECTOR TO BE NOTIFIED 9) DRILLING CONTRACTOR:
 Name Steve Casey (884-7470) Name S.W. Jack
 Address Rt. 2, Box 232-D Address Buckhannon, WV 26201
Jane Lew, WV 26378
- 10) PROPOSED WELL WORK: Drill X / Drill deeper / Redrill / Stimulate /
 Plug off old formation / Perforate new formation /
 Other physical change in well (specify)
- 11) GEOLOGICAL TARGET FORMATION, Blk
 12) Estimated depth of completed well, 5995 feet
 13) Approximate strata depths: Fresh, 105 feet; salt, feet.
 14) Approximate coal seam depths: N/A Is coal being mined in the area? Yes / No X /

15) CASING AND TUBING PROGRAM

CASING OR TUBING TYPE	SPECIFICATIONS					FOOTAGE INTERVALS		CEMENT FILL-UP OR SACKS (Cubic feet)	PACKERS
	Size	Grade	Weight per ft.	New	Used	For drilling	Left in well		
Conductor	11 3/4		42	X		140	140	To surface	Kinds
Fresh water									
Coal									Sizes
Intermediate	8 5/8		23	X		1300	1300	Rule 15.05	
Production	4 1/2		11.5	X		5995	5995	Rule 15.05	Depths set
Tubing									
Liners									Perforations
									Top Bottom

INSTRUCTIONS TO COAL OPERATOR, OWNER, OR LESSEE

The named coal operator, coal owner(s), and coal lessee are hereby notified that any objection they wish to make or are required to make by Code 22B-1-15,16, or 17 must be filed with the Department of Energy within fifteen (15) days after the receipt of this Application by the Department.

The following waiver must be completed by the coal operator and by any coal owner or coal lessee who has recorded a declaration under Code 22B-1-36 if the permit is to be issued within fifteen (15) days of the filing of the Application.

WAIVER

The undersigned coal operator / owner / lessee of the coal under this well location has examined this proposed well location. If a mine map exists which covers the area of the well location, the well location has been added to the mine map. The undersigned has no objection to the work proposed to be done at this location, provided, the well operator has complied with all applicable requirements of the West Virginia Code and the governing regulations.

William L. Long
Elizabeth C. Fury

Date: , 19

Its **12/08/2023**



1) Date: October 18, 19 85
 2) Operator's Well No. Fury #1 325-S
 3) API Well No. 47 041
 State _____ County _____ Permit _____

STATE OF WEST VIRGINIA
 DEPARTMENT OF ENERGY, OIL AND GAS DIVISION
APPLICATION FOR A WELL WORK PERMIT

- 4) WELL TYPE: A Oil _____ / Gas X /
 B (If "Gas", Production X / Underground storage _____ / Deep _____ / Shallow X /)
- 5) LOCATION: Elevation: 1053 Watershed: West Fork River
 District: Courthouse County: Lewis Quadrangle: Weston
- 6) WELL OPERATOR Stonewall Gas Co CODE: _____ 7) DESIGNATED AGENT Charles W. Canfield
 Address P.O. Drawer R Address P.O. Drawer R
Jane Lew, WV 26378 Jane Lew, WV 26378
- 8) OIL & GAS INSPECTOR TO BE NOTIFIED 9) DRILLING CONTRACTOR:
 Name Steve Casey (884-7470) Name S.W. Jack
 Address Rt. 2, Box 232-D Address _____
Jane Lew, WV 26378 Buckhannon, WV 26201
- 10) PROPOSED WELL WORK: Drill X / Drill deeper _____ / Redrill _____ / Stimulate _____
 Plug off old formation _____ / Perforate new formation _____
 Other physical change in well (specify) _____
- 11) GEOLOGICAL TARGET FORMATION, Blk
 12) Estimated depth of completed well, 5995 feet
 13) Approximate strata depths: Fresh, 105 feet; salt, _____ feet.
 14) Approximate coal seam depths: N/A Is coal being mined in the area? Yes _____ / No X /

15) CASING AND TUBING PROGRAM

CASING OR TUBING TYPE	SPECIFICATIONS					FOOTAGE INTERVALS		CEMENT FILL-UP OR SACKS (Cubic feet)	PACKERS	
	Size	Grade	Weight per ft.	New	Used	For drilling	Left in well			
Conductor	<u>11 3/4</u>		<u>42</u>	<u>X</u>		<u>140</u>	<u>140</u>	<u>To surface</u>		Kinds
Fresh water										
Coal										Sizes
Intermediate	<u>8 5/8</u>		<u>23</u>	<u>X</u>		<u>1300</u>	<u>1300</u>	<u>Rule 15.05</u>		
Production	<u>4 1/2</u>		<u>11.5</u>	<u>X</u>		<u>5995</u>	<u>5995</u>	<u>Rule 15.05</u>		Depths set
Tubing										
Liners										Perforations:
										Top Bottom

The law requires a comment period for surface owners. However, the permit can be issued in less than 15 days from the filing of the Application if the surface owner(s) of record sign(s) the following "Voluntary Statement of No Objection" on a facsimile of this surface owner's copy of the Application.

VOLUNTARY STATEMENT OF NO OBJECTION

I hereby state that I have read the instructions to surface owners on the reverse side of this Application, and that I have received copies of (1) a Notice of Application for a Well Work Permit on Form WW-2(A), (2) an Application for a Well Work Permit on Form WW-2(B), (3) a survey plat on Form WW-6, and (4) a Construction and Reclamation Plan on Form WW-9, all for proposed well work on my surface land as described therein.

I further state that I have no objection to the planned work described in these materials, and I have no objection to a permit being issued based on those materials.

(For execution by corporation, partnership, etc.) (For execution by natural persons)

NAME: _____
 By _____
 Its _____ Date _____

William L. Fury
 (Signature) Date _____
Elizabeth A. Fury
 (Signature) 12/08/2023
 Date _____

INSTRUCTIONS TO SURFACE OWNERS
AND
EXPLANATION OF METHODS AND TIME LIMITS TO COMMENT
ON OIL AND GAS WELL WORK PERMIT

The well operator named in the Notice and this Application and the attached materials is applying for a permit from the State to do oil or gas well drilling or other well work. You are being served with these materials because surface owners have the right to file comments before the permit is issued. (NOTE: If the surface tract is owned by more than three persons, in multiple heirship for example, then these materials were served on you because your name appeared on the Sheriff's tax ticket on the land or because you actually occupy the surface tract. In either case, you may be the only owner who will actually receive these materials.) See Chapter 22B, Article 1 of the W. Va. Code. Permits are valid for 24 months.

If you do not own any interest in the surface tract, please forward these materials to the true owner immediately if you know who it is. Also, please notify the well operator named in the materials and the Director of the Division of Oil and Gas in the West Virginia Department of Energy immediately.

NOTE : YOU ARE NOT REQUIRED TO FILE ANY COMMENT AT ALL.

WHERE TO FILE COMMENTS AND OBTAIN ADDITIONAL INFORMATION :

Director, Division of Oil and Gas
West Virginia Department of Energy
1615 Washington Street, East
Charleston, West Virginia 25311-2192
(304) - 348 - 3500

Who may file comments? If you wish to file comments, you must be an owner of record of (1) and interest in the surface tract on which the well already is or is about to be located, or (2) an interest in any other surface tract over the same oil or gas lease which will be utilized for roads or other land disturbances.

Time limits for comments. The law requires these materials to be delivered on or before the date the operator files his Application. You have FIFTEEN (15) DAYS after the filing date to file your comments as provided in METHODS FOR FILING COMMENTS below. You may call the Director's office at the above telephone number to be sure of the date. However, if you have been contacted by the well operator, and if you have signed a "voluntary statement of no objection" to any of the planned work described in these materials, then the permit may be issued at any time.

Comments must be in writing. Your comments must include your name, address and telephone number, the well operator's name and well number, and the approximate location of the proposed well site including district and county from the application. You may add other documents, such as sketches, maps or photographs to support your comments.

Methods for filing comments. Comments must be filed in person or received in the mail at the Director's office by the time stated above. Check with your postmaster to ensure adequate delivery time or to arrange special expedited handling.

The Director for Oil and Gas has the power to deny or condition a well work permit based on your comments on the following grounds:

- "(1) The proposed well work will constitute a hazard to the safety of persons; or
- "(2) The plan for soil erosion and sediment control is not adequate or effective; or
- "(3) Damage would occur to publicly owned lands or resources; or
- "(4) The proposed well work fails to protect fresh water sources or supplies."

If you want a copy of the permit as it is finally issued, or a copy of the order denying the permit, you should request a copy from the Director.

List of Water Testing Laboratories. The Director maintains a list of water testing laboratories which you can hire to test your water to establish water quality prior to and after drilling. Contact the Director's office or an Oil and Gas Inspector to obtain a copy of the list.

12/08/2023



WR-35 RECEIVED DEC 26 1985

DIVISION OF OIL & GAS DEPARTMENT OF ENERGY

State of West Virginia DEPARTMENT OF ENERGY Oil and Gas Division

Date November 26, 1985 Operator's Well No. Fury #1 325-S Farm Fury API No. 047 - 041 - 3665

WELL OPERATOR'S REPORT OF DRILLING, FRACTURING AND/OR STIMULATING, OR PHYSICAL CHANGE

WELL TYPE: Oil / Gas X/ Liquid Injection / Waste Disposal / (If "Gas," Production X/ Underground Storage / Deep / Shallow X/)

LOCATION: Elevation: 1053 Watershed WEST FORK RIVER District: COURTHOUSE County LEWIS Quadrangle WESTON

COMPANY STONEWALL GAS COMPANY ADDRESS PO DRAWER R, JANE LEW, WV 26378 DESIGNATED AGENT CHARLES W. CANFIELD ADDRESS PO DRAWER R, JANE LEW, WV 26378 SURFACE OWNER ELIZABETH ASPINALL FURY ADDRESS 120 W. SECOND ST, WESTON, WV 26452 MINERAL RIGHTS OWNER ELIZABETH ASPINALL FURY ADDRESS 120 W. SECOND ST., WESTON, WV 26452 OIL AND GAS INSPECTOR FOR THIS WORK STEVE CASEY ADDRESS RT 2, BOX 232-D JANE LEW, WV 26378 PERMIT ISSUED OCTOBER 28, 1985 DRILLING COMMENCED NOVEMBER 9, 1985 DRILLING COMPLETED NOVEMBER 15, 1985 IF APPLICABLE: PLUGGING OF DRY HOLE ON CONTINUOUS PROGRESSION FROM DRILLING OR REWORKING. VERBAL PERMISSION OBTAINED ON

Table with 4 columns: Casing & Tubing, Used in Drilling, Left in Well, Cement fill up Cu. ft. Rows include sizes 20-16, 13-10 3/4, 9 5/8, 8 5/8, 7, 5 1/2, 4 1/2, 3, 2, and Liners used.

GEOLOGICAL TARGET FORMATION ELK Depth 5960 feet Depth of completed well 5999 feet Rotary X / Cable Tools Water strata depth: Fresh 75 feet; Salt 1180 feet Coal seam depths: 90-100 Is coal being mined in the area? NA

OPEN FLOW DATA

Producing formation ELK Pay zone depth 5960 feet Gas: Initial open flow 377 Mcf/d Oil: Initial open flow NA Bbl/d Final open flow 551 Mcf/d Final open flow NA Bbl/d Time of open flow between initial and final tests 14 hours Static rock pressure 1200 psig (surface measurement) after 14 hours shut in (If applicable due to multiple completion--)

Second producing formation BENSON Pay zone depth 4500/08/2023 feet Gas: Initial open flow 377 Mcf/d Oil: Initial open flow NA Bbl/d Final open flow 551 Mcf/d Oil: Final open flow NA Bbl/d Time of open flow between initial and final tests 14 hours Static rock pressure 1200 psig (surface measurement) after 14 hours shut in

(Continue on reverse side)

LEW 3665

DETAILS OF PERFORATED INTERVALS, FRACTURING OR STIMULATING, PHYSICAL CHANGE, ETC.

RECEIVED
DEC 28 1985

NOVEMBER 21, 1985	THREE STAGE FRAC	PERFS	HOLES	BBL	SAND	BREAKDOWN	ISIP
ELK	5972-5998		9	700	70,000	3500	2500
BENSON	4358-4500		8	800	70,000	2900	1300
BALLTOWN	3250-3358		15	900	80,000	2950	900

WELL LOG

FORMATION	COLOR	HARD OR SOFT	TOP FEET	BOTTOM FEET	REMARKS Including indication of all fresh and salt water, coal, oil and gas
FILL	BROWN	SOFT	0	12	
SAND	BROWN	SOFT	12	150	1/2" STREAM WATER 48'
COAL	BLACK	HARD	150	154	
SAND & SHALE	BROWN	MED	154	1550	1" STREAM WATER 108'
LITTLE LIME	BROWN	MED	1550	1575	
BIG LIME	RUST	HARD	1603	1690	2" STREAM WATER 790'
BIG INJUN	BROWN	MED	1690	1785	
SAND & SHALE	GREY	HARD	1785	3100	GAS CHECK @ 2238' NO SHOW
SPEECHLY	BROWN	MED	3100	3122	
BALLTOWN	BROWN	MED	3193	3408	GAS CHECK @ 2331 130/10 2" H ₂ O
SAND & SHALE	GREY	HARD	3408	4385	
BENSON	BROWN	MED	4385	4397	GAS CHECK @ 4602' 70/10 2" H ₂ O
ELK	BROWN	HARD	4560	4570	
ELK	BROWN	HARD	5920	5999	GAS CHECK 5816' 110/10 2" H ₂ O
		TD	6065		GAS CHECK @ 5877 35/10 2" H ₂ O
					GAS CHECK @ 5738' 60/10 2" H ₂ O
					GAS AT TD 377 MCF

(Attach separate sheets as necessary)

STONEWALL GAS COMPANY

Well Operator

By: Benjamin A. Hardesty 12/08/2023
 BENJAMIN A. HARDESTY, VICE PRESIDENT

Date: NOVEMBER 27, 1985

Note: Regulation 2.02(i) provides as follows:
 "The term 'log' or 'well log' shall mean a systematic detailed geological record of all formations, including coal, encountered in the drilling of a well."

RECEIVED
 DEC 26 1985

STATE OF WEST VIRGINIA
 DEPARTMENT OF MINES, OIL AND GAS DIVISION

WELL OPERATOR'S REPORT
 OF
INITIAL GAS-OIL RATIO TEST

DIVISION OF OIL & GAS
 DEPARTMENT OF ENERGY

WELL OPERATOR STONEWALL GAS COMPANY
 Address P.O. DRAWER R
JANE LEW, WV 26378

DESIGNATED AGENT Charles W. Canfield
 Address P.O. Drawer R
Jane Lew, WV 26378

GEOLOGICAL TARGET FORMATION: Elk Depth 5960 feet
 Perforation Interval _____ feet
 Elk 5972-5998
 Benson 4358-4500
 Balltown 3250-3358

GUIDELINES FOR TESTING:

- 1- A minimum of gas vented or flared
- 2- A 24 hour preflow into pipelines or tanks
- 3- Uniform producing rate during the 24 hour test per test period
- 4- Measurement standards as for Form IV-39, "Report of Annual Production" (see Regulation §1.01)
- 5- Separate Form IV-36 for each producing formation in a multiple completion

TEST DATA				
START OF TEST-DATE	TIME	END OF TEST-DATE	TIME	DURATION OF TEST
11/24/85	7:00a.m.	11/25/85	7:00a.m.	24 hours
TUBING PRESSURE	CASING PRESSURE	SEPARATOR PRESSURE	SEPARATOR TEMPERATURE	
	1200	75#	53°	
OIL PRODUCTION DURING TEST	GAS PRODUCTION DURING TEST	WATER PRODUCTION DURING TEST & SALINITY		
Show bbls.	35 Mcf	No bbls. No ppm.		
OIL GRAVITY	PRODUCING METHOD (flowing, pumping, gas lift, etc.)			
63	*API Flowing			

GAS PRODUCTION		
MEASUREMENT METHOD	POSITIVE CHOKI	
FLANGE TAP <input type="checkbox"/>	PIPE TAP <input checked="" type="checkbox"/>	CRITICAL FLOW THROTTLE <input checked="" type="checkbox"/>
ORIFICE DIAMETER	PIPE DIAMETER (INSIDE DIAM.)	NOMINAL CHOKI SIZE - IN.
2"	4 1/2"	2"
DIFFERENTIAL PRESSURE RANGE	MAX. STATIC PRESSURE RANGE	PROVER & ORIFICE DIAM. - IN.
1200#		
DIFFERENTIAL	STATIC	GAS GRAVITY (AIR=1.0)
1200#		MEASURED ESTIMATED
GAS GRAVITY (AIR=1.0)	FLOWING TEMPERATURE	GAS TEMPERATURE
.6	50°	50°
24 HOUR COEFFICIENT	24 HOUR COEFFICIENT	
	PRESSURE - psia	

TEST RESULTS			
DAILY OIL	DAILY WATER	DAILY GAS	GAS-OIL RATIO
Show bbls.	bbls.	35 Mcf.	SCF/STB

STONEWALL GAS COMPANY
 Well Operator
 By: Benjamin A. Hardesty
 Benjamin A. Hardesty
 Its: Vice President

12/08/2023

RECEIVED
DEC 26 1982
DIVISION OF OIL & GAS
DEPARTMENT OF ENERGY

12/08/2023

date ✓

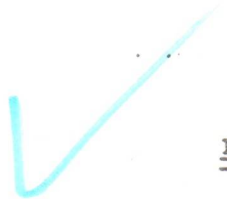

STATE OF WEST VIRGINIA
DEPARTMENT OF MINES
OIL AND GAS DIVISION
FINAL INSPECTION REQUEST
INSPECTOR'S COMPLIANCE REPORT

Permit No. 41-3665 (10-28-85) County Lewis
Company Stone Wall Gas Farm Fury
Inspector _____ Well No. 325-5
Date _____

RECEIVED
DEPARTMENT OF ENERGY
OIL AND GAS

RULE	DESCRIPTION	IN COMPLIANCE	
		Yes	No
23.06	Notification Prior to starting Work	_____	_____
25.04	Prepared before Drilling to prevent waste	_____	_____
25.03	High-Pressure Drilling	_____	_____
16.01	Required Permits at wellsite	_____	_____
15.03	Adequate Fresh Water Casing	_____	_____
15.02	Adequate Coal Casing	_____	_____
15.01	Adequate Production Casing	_____	_____
15.04	Adequate Cement Strength	_____	_____
23.02	Maintained Access Roads	_____	_____
25.01	Necessary Equipment to prevent Waste	_____	_____
23.03	Reclaimed Drilling Site	_____	_____
23.04	Reclaimed Drilling Pits	_____	_____
23.05	No surface or underground Pollution	_____	_____
7.03	Identification Markings	_____	_____

MAY 29 1986

COMMENTS: _____

I have inspected the above well and (HAVE/HAVE NOT) found it to be in compliance with all of the rules and regulations of the Office of Oil and Gas Department of Mines of the State of West Virginia.

SIGNED: Steve Casey
DATE: 5-22-86

12/08/2023

5,745'

LATITUDE 39°02'30"

80°27'30" LONGITUDE

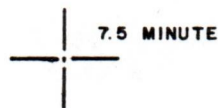
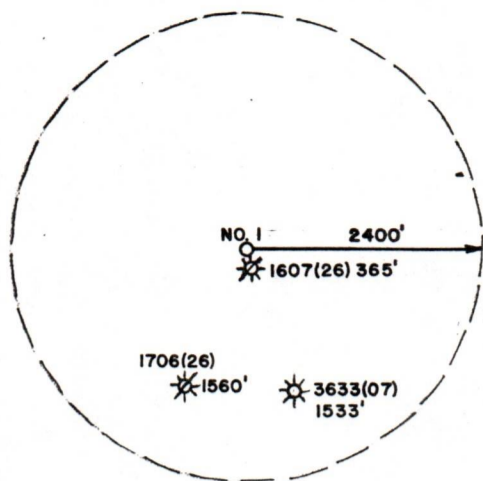

NORTH

WV BOARD OF CONTROL

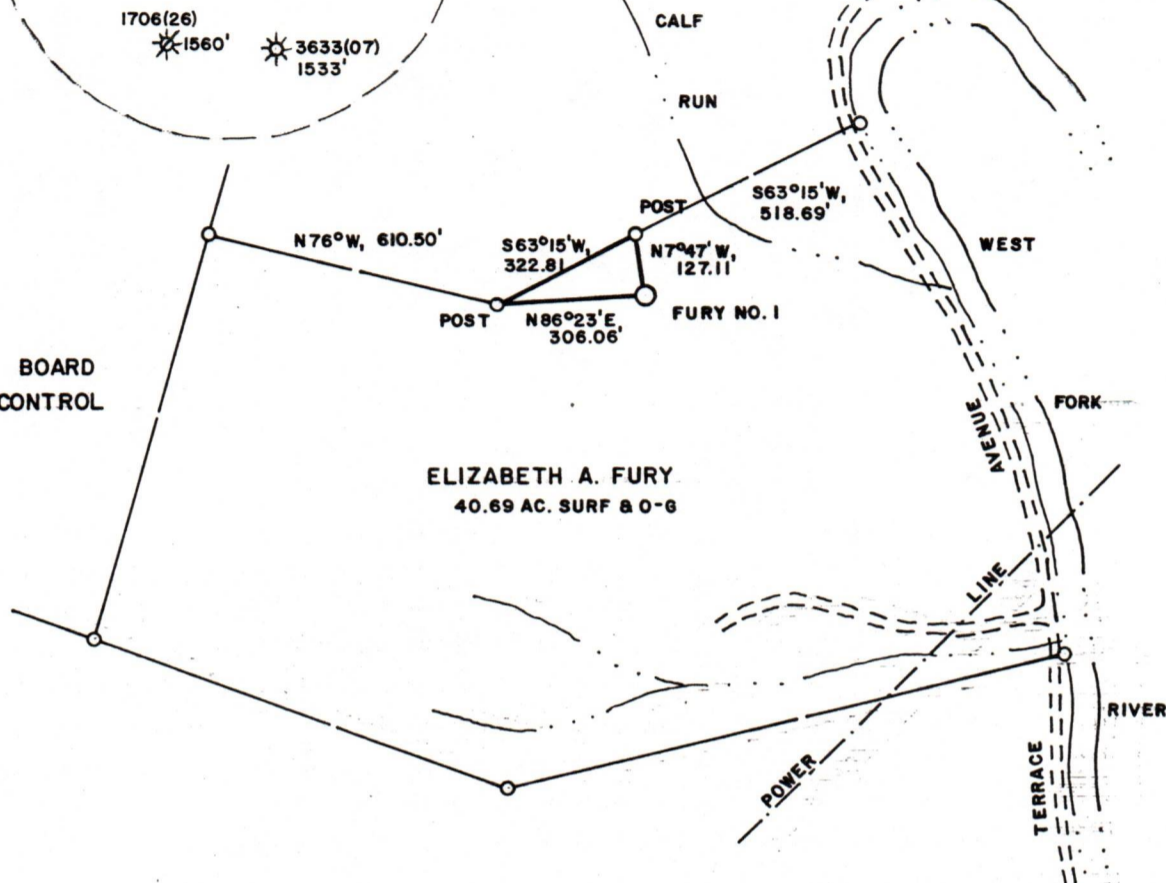

WELL REFERENCES:

N23°W, 118' TO A POST
N70°W, 90' TO 8" POPLAR

FURY

LAND SURVEYING SERVICES
1412 NORTH 18TH ST.
CLARKSBURG, WV 26301
PHONE: 304-623-1214

(+) DENOTES LOCATION OF WELL ON UNITED STATES TOPOGRAPHIC MAPS

FILE NO. _____
DRAWING NO. _____
SCALE 1" = 400'
MINIMUM DEGREE OF ACCURACY 1 in 200
PROVEN SOURCE OF ELEVATION BENCH MARK 1477' EAST OF LOCATION AT ELEVATION 1021'

I THE UNDERSIGNED, HEREBY CERTIFY THAT THIS PLAT IS CORRECT TO THE BEST OF MY KNOWLEDGE AND BELIEF AND SHOWS ALL THE INFORMATION REQUIRED BY LAW AND THE REGULATIONS ISSUED AND PRESCRIBED BY THE DEPARTMENT OF MINES.
(SIGNED) *Stephen D. Losh*
R.P.E. _____ L.L.S. NO. 674
STEPHEN D. LOSH

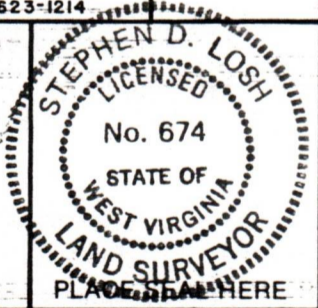

STATE OF WEST VIRGINIA
DEPARTMENT OF MINES
OIL AND GAS DIVISION



DATE OCTOBER 21, 19 85
OPERATOR'S WELL NO. FURY NO. 1
API WELL NO.

WELL TYPE: OIL ___ GAS LIQUID INJECTION ___ WASTE DISPOSAL ___
(IF "GAS,") PRODUCTION STORAGE ___ DEEP ___ SHALLOW
LOCATION: ELEVATION 1054' WATER SHED CALF RUN OF THE WEST FORK RIVER
DISTRICT COURT HOUSE COUNTY LEWIS
QUADRANGLE WESTON 7.5 MINUTE

SURFACE OWNER ELIZABETH ASPINALL FURY ACREAGE 40.69
OIL & GAS ROYALTY OWNER ELIZABETH ASPINALL FURY LEASE ACREAGE 40.69
LEASE NO. 12/08/2023

PROPOSED WORK: DRILL CONVERT ___ DRILL DEEPER ___ REDRILL ___ FRACTURE OR STIMULATE ___ PLUG OFF OLD FORMATION ___ PERFORATE NEW FORMATION ___ OTHER PHYSICAL CHANGE IN WELL (SPECIFY) _____

PLUG AND ABANDON ___ CLEAN OUT AND REPLUG ___
TARGET FORMATION FLK ESTIMATED DEPTH 5995'
WELL OPERATOR STONEWALL GAS COMPANY DESIGNATED AGENT CHARLES CANFIELD
ADDRESS P.O. DRAWER R ADDRESS P.O. DRAWER R
JANE LEW, WV 26378-0080 JANE LEW, WV 26378-0080

COUNTY NAME

PERMIT