



IV-9
(Rev 8-81)

DATE 01-12-83
WELL NO: 12802-F-5769
API NO. 47-041-3416-A

State of West Virginia
Department of Mines
Oil and Gas Division

CONSTRUCTION AND RECLAMATION PLAN

COMPANY NAME Con. Gas Supply Corp.
Address Rt. #1, Box 245-14, Weston, W.V.
Telephone 269-3771

DESIGNATED AGENT L. Joseph Timms, Jr.
Address 445 W. Main St., Clarksburg, WV
Telephone 623-8000

LANDOWNER A.C. Bazley

SOIL CONS. DISTRICT West Fork

Revegetation to be carried out by Con. Gas Supply Corp. (Agent)

This plan has been reviewed by West Fork SCD. All corrections and additions become a part of this plan: 5/16/83 (Date)

Kenneth E Knight
(SCD Agent)

ACCESS ROAD

LOCATION

Structure Culverts IRon (A)
Spacing As per manual (15" minimum ID.)
Page Ref. Manual Pg - 2-8

Structure Division Ditch (1)
Material Earth
Page Ref. Manual 2-12

Structure Rock (B)
Spacing Were needed
Page Ref. Manual N/A

Structure _____ (2)
Material _____
Page Ref. Manual _____

Structure Drainage Ditch (C)
Spacing Inside road cuts
Page Ref. Manual 2-12

Structure _____ (3)
Material OIL & GAS DIVISION
DEPT. OF MINES
Page Ref. Manual _____

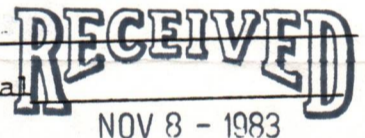

All structures should be inspected regularly and repaired if necessary. All commercial timber is to be cut and stacked and all brush and small timber to be cut and removed from the site before dirt work begins.

REVEGETATION

Treatment Area I

Treatment Area II

*Lime 2 Tons/acre
or correct to pH 6.5
Fertilizer 500 lbs/acre
(10-20-20 or equivalent)
Mulch Hay or Straw 2 Tons/acre
Seed* Ky. 31 Fescue 40 lbs/acre
Ladino Clover 5 lbs/acre
_____ lbs/acre

*Lime 2 Tons/acre
or correct to pH 6.5
Fertilizer 500 lbs/acre
(10-20-20 or equivalent)
Mulch Hay or Straw 2 Tons/acre
Seed* Ky 31 Fescue 40 lbs/acre
Ladino Clover 5 lbs/acre
_____ lbs/acre

*Inoculate all legumes such as vetch, trefoil and clovers with the proper bacterium. Inoculate with 3X recommended amount.

*Lime according to pH test. PLAN PREPARED BY E.B. Harbert 02/09/2024

NOTES: Please request landowner's cooperation to protect new seedling for one growing season. Attach separate sheets as necessary for comments.

ADDRESS Rt. #1, Box 245-14, Weston, W.V.
PHONE NO. 269-3771

ATTACH OR PHOTOCOPY SECTION OF INVOLVED TOPOGRAPHIC MAP. QUADRANGLE VADIS, W.V. 7.5'

LEGEND

Well Site 



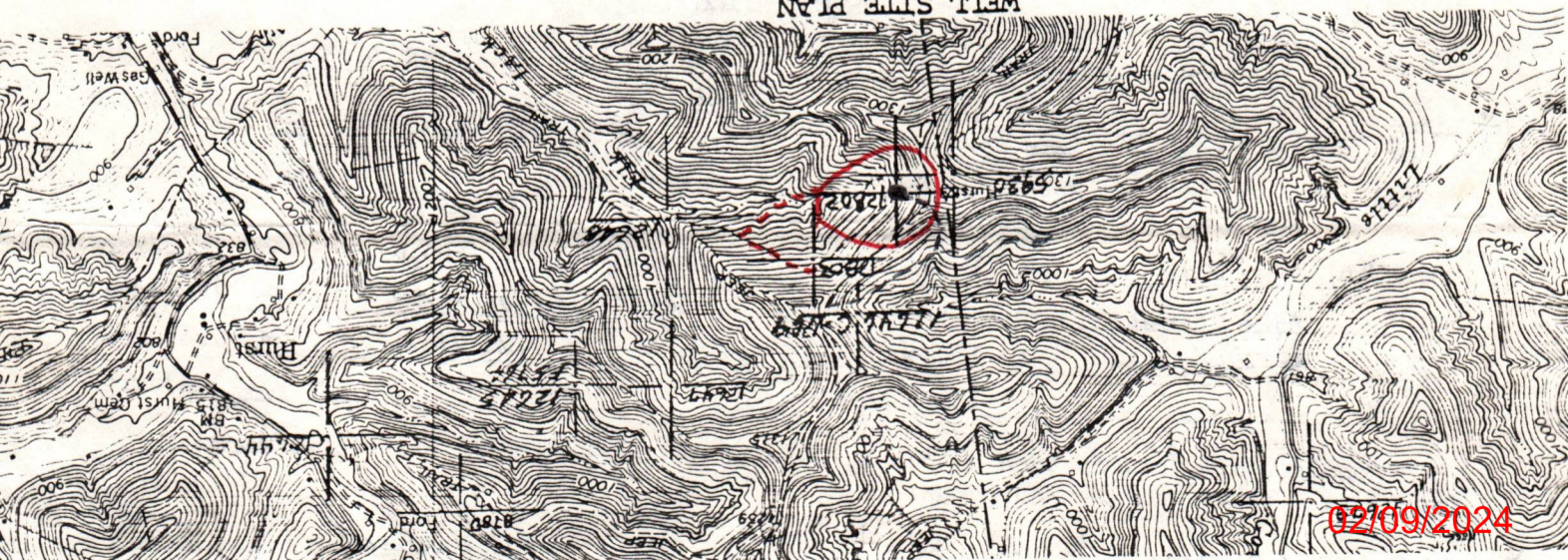

Access Road 

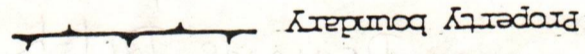
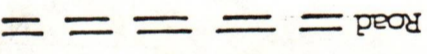

Sketch to include well location, existing access road, roads to be constructed, well sites, drilling pits and necessary structures numbered or lettered to correspond with the first part of this plan. Include all natural drainage.

DEPT. OF MINES RECEIVED NOV 8 - 1983

LEGEND

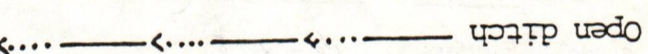
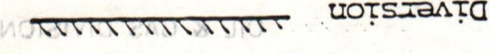
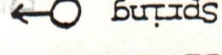
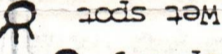
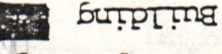
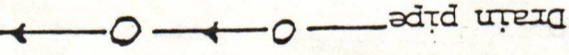
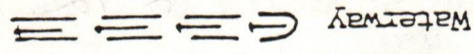
- Property boundary 
- Road 
- Existing fence 
- Planned fence 
- Stream 
- Open ditch 
- Division 
- Spring 
- Wet spot 
- Building 
- Drain pipe 
- Waterway 

Note: Fink Creek is a high quality stream Construct structures that meet specifications on page a-20 (section 10) in new Oil & Gas Manual.

Note: Topsoil will be stock piled for use in reclaiming.

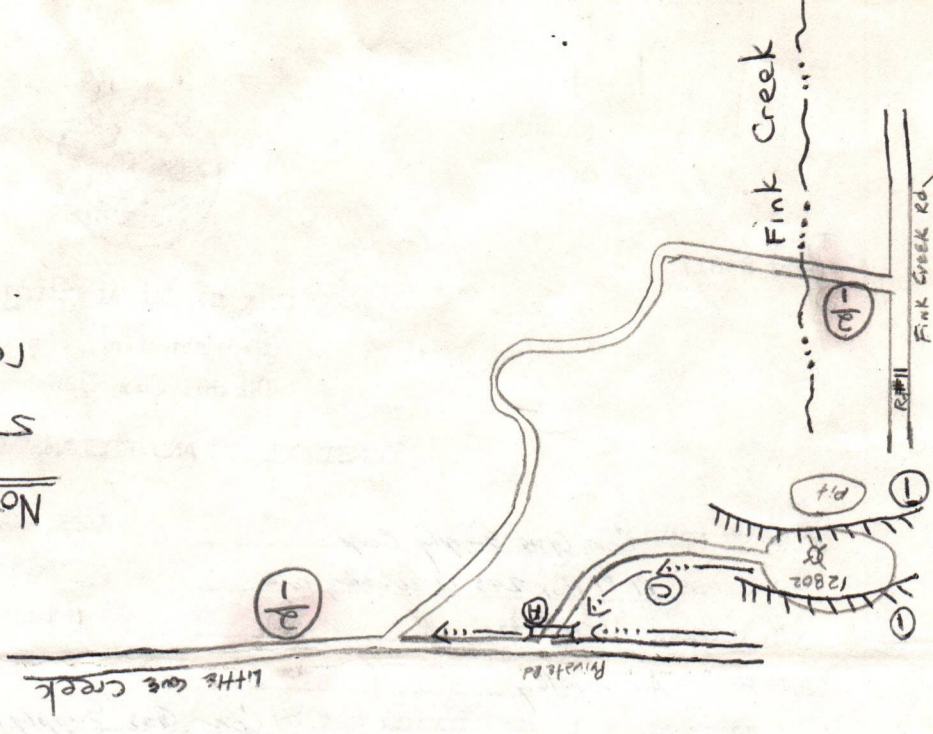

No. 650733
RECEIPT FOR CERTIFIED MAIL

NO INSURANCE COVERAGE PROVIDED—
 NOT FOR INTERNATIONAL MAIL
 (See Reverse)

CONSOL GAS SUPPLY CORP. Attn: Prod. Dept. Wells 12802&12803

SENT TO		A. C. Bailey
STREET AND NO.		First St.
P.O., STATE AND ZIP CODE		Weston, WV 26452
POSTAGE		\$
CONSULT POSTMASTER FOR FEES	CERTIFIED FEE	
	SPECIAL DELIVERY	
	RESTRICTED DELIVERY	
	OPTIONAL SERVICES	
	RETURN RECEIPT SERVICE	
	SHOW TO WHOM AND DATE DELIVERED	
	SHOW TO WHOM, DATE, AND ADDRESS OF DELIVERY	
	SHOW TO WHOM AND DATE DELIVERED WITH RESTRICTED DELIVERY	
	SHOW TO WHOM, DATE AND ADDRESS OF DELIVERY WITH RESTRICTED DELIVERY	
TOTAL POSTAGE AND FEES		\$
POSTMARK OR DATE		CLARKSBURG, WV NOV 4 1983 USPS

PS Form 3800, Apr. 1976

Coal seam depths: 590 Is coal being mined in the area? no

OPEN FLOW DATA

Producing formation Gantz Pay zone depth 2468 feet
 Gas: Initial open flow n/a Mcf/d Oil: Initial open flow Bbl/d
 Final open flow 1055 Mcf/d Final open flow Bbl/d
 Time of open flow between initial and final tests n/a hours 02/09/2024

Static rock pressure n/a psig (surface measurement) after hours shut in
 (If applicable due to multiple completion--)

Second producing formation Pay zone depth feet
 Gas: Initial open flow Mcf/d Oil: Initial open flow Bbl/d
 Final open flow Mcf/d Oil: Final open flow Bbl/d
 Time of open flow between initial and final tests hours

Static rock pressure psig (surface measurement) after hours shut in

(Continue on reverse side)

STATE OF WEST VIRGINIA
DEPARTMENT OF MINES
OIL AND GAS WELLS DIVISION

RECEIVED
FEB 2 - 1984

OIL & GAS DIVISION
DEPT. OF MINES

INSPECTOR'S WELL REPORT

Permit No. 41-3416-P

Oil or Gas Well _____
(KIND)

Company <u>Consol. Gas</u>	CASING AND TUBING	USED IN DRILLING	LEFT IN WELL	PACKERS
Address _____	Size			
Farm <u>Bailey</u>	16			Kind of Packer _____
Well No. <u>12802</u>	13			
District <u>Freemans Cr. County Lewis</u>	10			Size of _____
Drilling commenced <u>1-23-84</u>	8 1/4			
Drilling completed _____ Total depth _____	6 3/8			Depth set _____
Date shot _____ Depth of shot _____	5 3/16			
Initial open flow _____ /10ths Water in _____ Inch	3			Perf. top _____
Open flow after tubing _____ /10ths Merc. in _____ Inch	2			Perf. bottom _____
Volume _____ Cu. Ft.	Liners Used			Perf. top _____
Rock pressure _____ lbs. _____ hrs.				Perf. bottom _____
Oil _____ bbls., 1st 24 hrs.	CASING CEMENTED _____ SIZE _____ No. FT. _____ Date _____			
Fresh water _____ feet _____ feet	NAME OF SERVICE COMPANY _____			
Salt water _____ feet _____ feet	COAL WAS ENCOUNTERED AT _____ FEET _____ INCHES			
	_____ FEET _____ INCHES _____ FEET _____ INCHES			
	_____ FEET _____ INCHES _____ FEET _____ INCHES			

Drillers' Names SWJ 7

Remarks: counting conductor at 18'

1-26-84

DATE

Steve Casey

02/09/2024

DISTRICT WELL INSPECTOR

STATE OF WEST VIRGINIA
DEPARTMENT OF MINES
OIL AND GAS WELLS DIVISION

RECEIVED
FEB 6 - 1984

INSPECTOR'S WELL REPORT

OIL & GAS DIVISION
DEPT. OF MINES

41-3416-P
Permit No.

Oil or Gas Well _____
(KIND)

Company <u>Consol. Gas</u>	CASING AND TUBING	USED IN DRILLING	LEFT IN WELL	PACKERS
Address _____	Size			
Farm <u>Bailey</u>	16			Kind of Packer _____
Well No. <u>12902</u>	13			
District <u>Fremont Co. Lewis</u>	10			Size of _____
Drilling commenced _____	8 1/4			
Drilling completed _____ Total depth _____	6 5/8			Depth set _____
Date shot _____ Depth of shot _____	5 3/16			
Initial open flow _____ /10ths Water in _____ Inch	3			Perf. top _____
Open flow after tubing _____ /10ths Merc. in _____ Inch	2			Perf. bottom _____
Volume _____ Cu. Ft.	Liners Used			Perf. top _____
Rock pressure _____ lbs. _____ hrs.				Perf. bottom _____
Oil _____ bbls., 1st 24 hrs.	CASING CEMENTED _____ SIZE _____ No. FT. _____ Date _____			
Fresh water _____ feet _____ feet	NAME OF SERVICE COMPANY _____			
Salt water _____ feet _____ feet	COAL WAS ENCOUNTERED AT _____ FEET _____ INCHES			
	_____ FEET _____ INCHES _____ FEET _____ INCHES			
	_____ FEET _____ INCHES _____ FEET _____ INCHES			

Drillers' Names SWJ 7

Remarks: ceasing at 100'

Had meeting with Consol. Supervisors about stream crossing to this well.

1-31-84
DATE

Steve Casey
DISTRICT WELL INSPECTOR
02/09/2024

STATE OF WEST VIRGINIA
DEPARTMENT OF MINES
OIL AND GAS WELLS DIVISION

RECEIVED
FEB 7 - 1984

INSPECTOR'S WELL REPORT

OIL & GAS DIVISION
DEPT. OF MINES

Permit No. 41-3416-P

Oil or Gas Well _____
(KIND)

Company <u>Consol. Gas</u>	CASING AND TUBING	USED IN DRILLING	LEFT IN WELL	PACKERS
Address _____	Size			
Farm <u>Bailey</u>	16			Kind of Packer _____
Well No. <u>12802</u>	13			
District <u>Freemans CR</u> County <u>Lewis</u>	10			Size of _____
Drilling commenced _____	8 1/4			
Drilling completed _____ Total depth _____	6 3/8			Depth set _____
Date shot _____ Depth of shot _____	5 3/16			
Initial open flow _____ /10ths Water in _____ Inch	3			Perf. top _____
Open flow after tubing _____ /10ths Merc. in _____ Inch	2			Perf. bottom _____
Volume _____ Cu. Ft.	Liners Used			Perf. top _____
Rock pressure _____ lbs. _____ hrs.				Perf. bottom _____
Oil _____ bbls., 1st 24 hrs.	CASING CEMENTED _____ SIZE _____ No. FT. _____ Date _____			
Fresh water _____ feet _____ feet	NAME OF SERVICE COMPANY _____			
Salt water _____ feet _____ feet	COAL WAS ENCOUNTERED AT _____ FEET _____ INCHES			
	_____ FEET _____ INCHES _____ FEET _____ INCHES			
	_____ FEET _____ INCHES _____ FEET _____ INCHES			

Drillers' Names SWJ 7

Remarks: 10 3/4 at 236' 250 SKS, Powell

2-2-84
DATE

Steve Casey 02/09/2024
DISTRICT WELL INSPECTOR

STATE OF WEST VIRGINIA
DEPARTMENT OF MINES
OIL AND GAS WELLS DIVISION

RECEIVED
FEB 10 1984

OIL & GAS DIVISION

DEPT. OF MINES

INSPECTOR'S WELL REPORT

Permit No. 4-3416-P

Oil or Gas Well _____
(KIND)

Company <u>Consol. Gas</u>	CASING AND TUBING	USED IN DRILLING	LEFT IN WELL	PACKERS
Address _____	Size			
Farm <u>Barley</u>	16			Kind of Packer _____
Well No. <u>12802</u>	13			
District _____ County <u>Lewis</u>	10			Size of _____
Drilling commenced _____	8 1/4			
Drilling completed _____ Total depth _____	6 5/8			Depth set _____
Date shot _____ Depth of shot _____	5 3/16			
Initial open flow _____ /10ths Water in _____ Inch	3			Perf. top _____
Open flow after tubing _____ /10ths Merc. in _____ Inch	2			Perf. bottom _____
Volume _____ Cu. Ft.	Liners Used			Perf. top _____
Rock pressure _____ lbs. _____ hrs.				Perf. bottom _____
Oil _____ bbls., 1st 24 hrs.	CASING CEMENTED _____ SIZE _____ No. FT. _____ Date _____			
Fresh water _____ feet _____ feet	NAME OF SERVICE COMPANY _____			
Salt water _____ feet _____ feet	COAL WAS ENCOUNTERED AT _____ FEET _____ INCHES			
	_____ FEET _____ INCHES _____ FEET _____ INCHES			
	_____ FEET _____ INCHES _____ FEET _____ INCHES			

Drillers' Names SWJ 7

Remarks: running on iron at 890'

2-7-84
DATE

Steve Casper
02/09/2024
DISTRICT WELL INSPECTOR

STATE OF WEST VIRGINIA
DEPARTMENT OF MINES
OIL AND GAS WELLS DIVISION

RECEIVED
FEB 23 1984
OIL & GAS DIVISION
DEPT. OF MINES

INSPECTOR'S PLUGGING REPORT

Permit No. 41-3416-P

Well No. 12802

COMPANY Consolidated Gas ADDRESS _____

FARM AC Bailey DISTRICT Freemans CR COUNTY Lewis

Filling Material Used Cement

PLUGS USED AND DEPTH PLACED			BRIDGES	CASING AND TUBING		
CEMENT-THICKNESS	WOOD-SIZE	LEAD	CONSTRUCTION-LOCATION	RECOVERED	SIZE	LOST
Cleared out to 2550'					10 ³ / ₄	236'
2550 to surface			1275 sacks cement Dowell			

Drillers' Names SWJ T

Remarks:

Plugged 2-20-84

DATE

I hereby certify I visited the above well on this date.

Steve Casey

02/09/2024

DISTRICT WELL INSPECTOR

STATE OF WEST VIRGINIA
DEPARTMENT OF MINES
OIL AND GAS WELLS DIVISION

INSPECTOR'S WELL REPORT

Permit No. 41

Oil or Gas Well _____
(KIND)

	CASING AND TUBING	USED IN DRILLING	LEFT IN WELL	PACKERS
Company _____				
Address _____	Size			
Farm _____	16			Kind of Packer _____
Well No. _____	13			
District _____ County _____	10			Size of _____
Drilling commenced _____	8 1/4			
Drilling completed _____ Total depth _____	6 3/4			Depth set _____
Date shot _____ Depth of shot _____	5 3/16			
Initial open flow _____ /10ths Water in _____ Inch	3			Perf. top _____
Open flow after tubing _____ /10ths Merc. in _____ Inch	2			Perf. bottom _____
Volume _____ Cu. Ft.	Liners Used			Perf. top _____
Rock pressure _____ lbs. _____ hrs.				Perf. bottom _____
Oil _____ bbls., 1st 24 hrs.	CASING CEMENTED _____ SIZE _____ No. FT. _____ Date _____			
Fresh water _____ feet _____ feet	NAME OF SERVICE COMPANY _____			
Salt water _____ feet _____ feet	COAL WAS ENCOUNTERED AT _____ FEET _____ INCHES			
	_____ FEET _____ INCHES	_____ FEET _____ INCHES	_____ FEET _____ INCHES	_____ FEET _____ INCHES

Drillers' Names _____

Remarks: _____



1) Date: November 3, 19 83
2) Operator's Well No. 12802 (F-5769)
3) API Well No. 47 - 041- 3416-P
State County Permit

STATE OF WEST VIRGINIA
OFFICE OF OIL AND GAS, DEPARTMENT OF MINES

APPLICATION FOR A PERMIT TO PLUG AND ABANDON A WELL

- 4) WELL TYPE: A Oil _____ / Gas X / Liquid injection _____ / Waste disposal _____
 B (If "Gas", Production _____ / Underground storage) X / Deep _____ Shallow _____)
- 5) LOCATION: Elevation: 1175' Watershed: Elk Lick of Fink Creek
 District: Freemans Creek County: Lewis Quadrangle: Vadis
- 6) WELL OPERATOR Consolidated Gas Supply Corp. 7) DESIGNATED AGENT L. Joseph Timms, Jr.
 Address 145 West Main Street Address 145 West Main Street
Clarksburg, West Virginia Clarksburg, West Virginia
- 8) OIL & GAS INSPECTOR TO BE NOTIFIED 9) PLUGGING CONTRACTOR
 Name Stephen Casey Name I. L. Morris
 Address Rt 2, Box 232-D Address Glenville, WV
Jane Lew, WV 26378

10) WORK ORDER: The work order for the manner of plugging this well is as follows:

Re-drill to 2490' and plug solid with cement to surface.

RECEIVED
NOV 8 - 1983
OIL & GAS DIVISION
DEPT. OF MINES

OFFICE USE ONLY

PLUGGING PERMIT

Permit number 47-041-3416-P

November 28, 1983
Date

This permit covering the well operator and well location shown below is evidence of permission granted to plug in accordance with the pertinent legal requirements subject to the conditions contained herein and on the reverse hereof. **Notification must be given to the District Oil and Gas Inspector 24 hours before actual permitted work has commenced.**

The permitted work is as described in the Notice and Application, plat, subject to any modifications and conditions on the reverse hereof.

Permit expires November 28, 1985 unless plugging is commenced prior to that date and prosecuted with due diligence.

BLANKET BOND	Bond:	Agent: <u>[Signature]</u>	Plat: <u>[Signature]</u>	Casing: <u>[Signature]</u>	Fee: <u>[Signature]</u>
---------------------	-------	---------------------------	--------------------------	----------------------------	-------------------------

[Signature: Michael J. Lewis]
Administrator, Office of Oil and Gas

NOTE: Keep one copy of this permit posted at the plugging location.

File

See the reverse side of the APPLICANT'S COPY for instructions to the well operator.

02/09/2024

11/14

OFFICE USE ONLY

PERMIT MODIFICATIONS AND CONDITIONS (IF ANY) TO THE PROPOSED PLUGGING

WELL TYPE: A or B (If well production is in year, production is in year)

LOCATION: Township, Range, Section, Meridian, County, State

WELL OPERATOR: Consolidated Gas Supply Corp.

ADDRESS: 117th Street, East Virginia, West Virginia

PLUGGING CONTRACTOR: Robert Bates

ADDRESS: 109 Lincoln St., Charleston, W. Va. 25302

RECEIVED
NOV 8 - 1983
OIL & GAS DIVISION
DEPT. OF MINES

OFFICE USE ONLY

This part of Form IV-4(b) is to record the dates of certain occurrences and any follow-up inspections.

	Date	Follow-up inspection(s)	Date(s)
Application received			
Plugging started		" "	
Plugging completed		" "	
Well Record received		" "	

OTHER INSPECTIONS

Reason:

Reason:

BLANKET BOND



1) Date: November 3, 19 83
2) Operator's
Well No. 12802 (F-5769)
3) API Well No. 47 - 047 - 3416 - A
State County Permit

STATE OF WEST VIRGINIA
OFFICE OF OIL AND GAS, DEPARTMENT OF MINES
NOTICE OF APPLICATION TO PLUG AND ABANDON A WELL

4) SURFACE OWNER(S) OF RECORD TO BE SERVED

(i) Name A. C. Bailey
Address First St.
Weston, WV 26152
(ii) Name _____
Address _____
(iii) Name _____
Address _____

5 (i) COAL OPERATOR None

Address _____

5 (ii) COAL OWNER(S) WITH DECLARATION ON RECORD:

Name None

Address _____

Name _____

Address _____

5 (iii) COAL LESSEE WITH DECLARATION ON RECORD:

Name None

Address _____

OIL & GAS DIVISION
DEPT. OF MINES

RECEIVED
NOV 8 - 1983

TO THE PERSON(S) NAMED ABOVE: You should have received this Form and the following documents:

- (1) The Application to Plug and Abandon a Well on Form IV-4 (B), which sets out the parties involved in the work, and describes the well and its location and the plugging work order; and
- (2) The plat (surveyor's map) showing the well location on Form IV-6.

THE REASON YOU RECEIVED THESE DOCUMENTS IS THAT YOU HAVE RIGHTS REGARDING THE APPLICATION WHICH ARE SUMMARIZED IN THE "INSTRUCTIONS" ON THE REVERSE SIDE OF THE COPY OF THE APPLICATION (FORM IV-4 (B)) DESIGNATED FOR YOU. HOWEVER, YOU ARE NOT REQUIRED TO TAKE ANY ACTION AT ALL.

Take notice that under Chapter 22 of the West Virginia Code, the undersigned well operator proposes to file or has filed this Notice and Application and accompanying documents for a Permit to plug and abandon a well with the Administrator of the Office of Oil and Gas, West Virginia Department of Mines, with respect to the well at the location described on the attached Application and depicted on the attached Form IV-6. Copies of this Notice, the Application, and the plat have been mailed by registered or certified mail or delivered by hand to the person(s) named above (or by publication in certain circumstances) on or before the day of mailing or delivery to the Administrator.

The truth of the information on the Notice and Application is verified and sworn to and the Notice is signed on behalf of the Well Operator in my County and State by

J. E. Gwinn
this 3rd day of November, 19 83.
My commission expires Sept. 13, 19 86.

James D. Trobley
Notary Public, Harrison County,
State of West Virginia

WELL

OPERATOR Consolidated Gas Supply Corp.

By J. E. Gwinn
Its Manager of Production

Address 445 West Main Street
Clarksburg, West Virginia

Telephone 623-8000

I N S T R U C T I O N S T O A P P L I C A N T

CONCERNING THE LINE ITEMS:

- 1) Date of Notice.
- 2) Your well name and number.
- 3) To be filled out by the Office of Oil & Gas.
- 4) & 5) Use separate sheet if necessary.
- 4) Surface owner(s) of record to be served with Notice and Application. However, see also Code § 22-4-1m(b) if "more than three tenants in common or other co-owners of interest described in subsection (a) of this section hold interests in such lands".
- 5(i) "Coal Operator" means any person, firm, partnership, partnership association or corporation that proposes to or does operate a coal mine.
- 5(ii, iii) See Code § 22-4-20.

CONCERNING THE REQUIRED COPIES FOR FILING AND SERVICE:

Filing. Code § 22-4-1k and Regulation 7.02 provide that the original and two copies of the Application must be filed with the Administrator, accompanied by (i) an original and four copies of the Notice, (ii) an original and four copies of a plat in the form prescribed by Regulation 11, and (iii) a bond in one of the forms prescribed by Regulation 12, or in lieu thereof the other security allowed by Code § 22-4-9.

Service. In addition, service must be made on the surface owner(s) and the person(s) with an interest in the coal. See Code §§ 22-4-1m and 22-4-9.



RECEIVED
JUN 4 - 1985
OIL & GAS DIVISION
DEPT. OF MINES

State of West Virginia
Department of Mines
Oil and Gas Division
Charleston 25305
FINAL INSPECTION REPORT
INSPECTORS COMPLIANCE REPORT
March 13, 1984

COMPANY Consolidated Gas Supply Corp.

PERMIT NO 041-3416-P

(2-21-84)
WT 12802

445 W. Main Street

FARM & WELL NO A. C. Bailey

Clarksburg, West Virginia 26301

DIST. & COUNTY Freemans Creek/Lewis

RULE	DESCRIPTION	IN COMPLIANCE	
		Yes	No
23.06	Notification Prior to Starting Work	_____	_____
16.01	Required Permits at Wellsite	_____	_____
17.02	Method of Plugging	_____	_____
18.01	Materials used in Plugging	_____	_____
23.02	Maintained Access Roads	_____	_____
25.01	Necessary Equipment to Prevent Waste	_____	_____
23.04	Reclaimed Drilling Pits	_____	_____
23.05	No Surface or Underground Pollution	_____	_____
17.06	Statutory Affidavit	_____	_____
7.06	Parties Responsible	_____	_____
7.05	Identification Markings	_____	_____

I HAVE INSPECTED THE ABOVE CAPTIONED WELL AND RECOMMEND THAT IT BE RELEASED:

SIGNED Steve Casey
DATE 5-30-85

Your Affidavit of Plugging was received and reclamation requirements approved. The well designated by the above permit number has been released under your bond.

T. H. ...
Administrator-Oil & Gas Division
June 7, 1985
DATE

A. S63°30'E - 559'
B. S58°43'W - 1784'
C. S41°07'W - 1564'

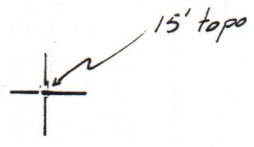

NORTH

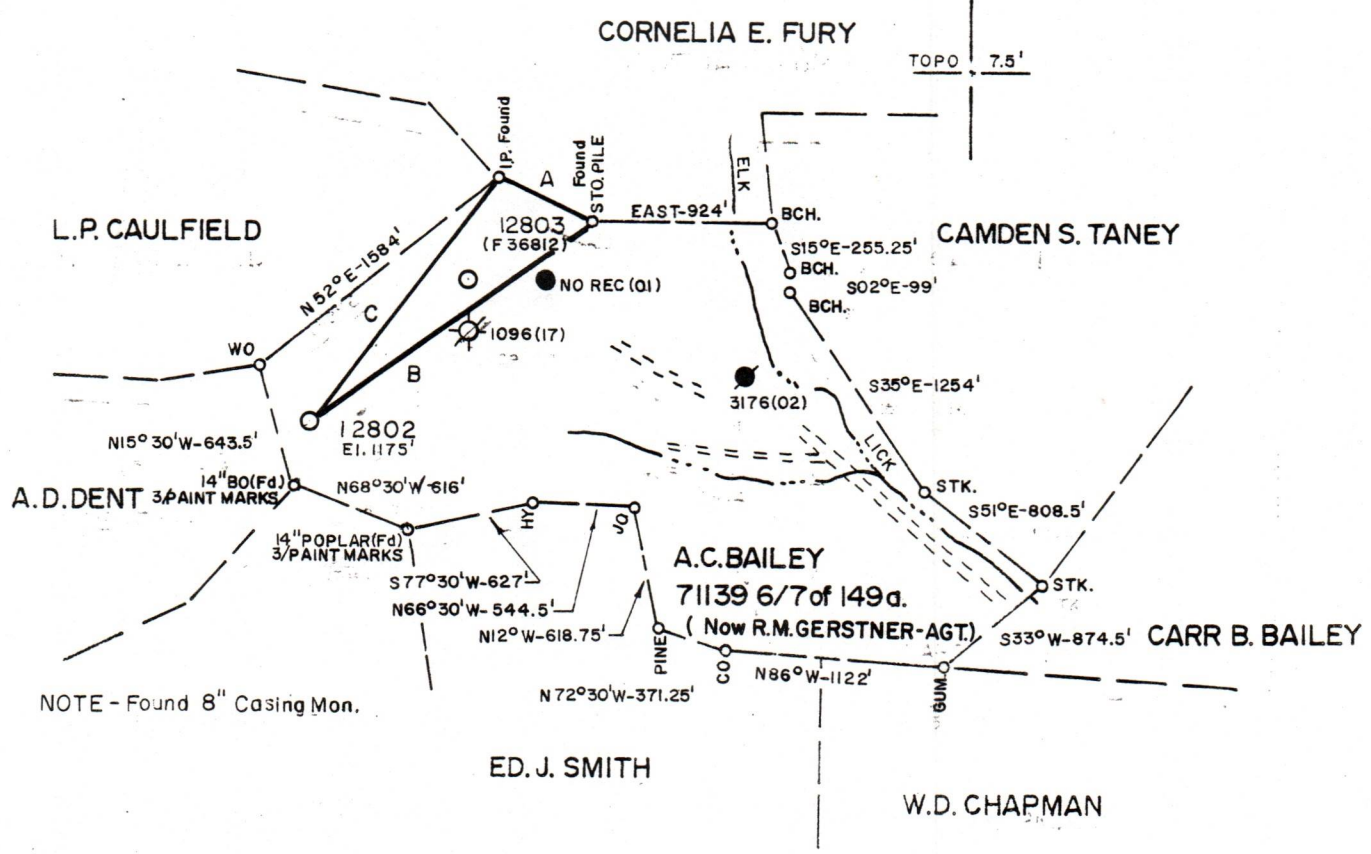

NOTE - Found 8" Casing Mon.

REVISED FB 2157 PG. 7 - 8
MP. SHT. 72 S26 W7 FB 2132 PG. 36 - 38

FILE NO. _____
DRAWING NO. _____
SCALE 1" = 1000'
MINIMUM DEGREE OF ACCURACY 1 IN 200
PROVEN SOURCE OF ELEVATION CON. GAS SUP. CORP.
Well 12646 ELV. 1171'

I THE UNDERSIGNED, HEREBY CERTIFY THAT THIS PLAT IS CORRECT TO THE BEST OF MY KNOWLEDGE AND BELIEF AND SHOWS ALL THE INFORMATION REQUIRED BY LAW AND THE REGULATIONS ISSUED AND PRESCRIBED BY THE DEPARTMENT OF MINES.
(SIGNED) Harrell M Radcliffe
R.P.E. _____ L.L.S. 74

PLACE SEAL HERE

STATE OF WEST VIRGINIA
DEPARTMENT OF MINES
OIL AND GAS DIVISION



DATE 01-10, 1983
OPERATOR'S WELL NO. 12802 (E-5769)
API WELL NO. _____
47 - 041 - 3416-P
STATE COUNTY PERMIT

(+) DENOTES LOCATION OF WELL ON UNITED STATES TOPOGRAPHIC MAPS
WELL TYPE: OIL ___ GAS X LIQUID INJECTION ___ WASTE DISPOSAL ___
(IF "GAS,") PRODUCTION ___ STORAGE X DEEP ___ SHALLOW ___
LOCATION: ELEVATION 1175' WATER SHED ELK LICK of FINK CREEK
DISTRICT FREEMANS CREEK COUNTY LEWIS
QUADRANGLE VADIS, W.V.
SURFACE OWNER A. C. BAILEY ACREAGE 6/7 of 149a
OIL & GAS ROYALTY OWNER A. C. BAILEY Now R.M.GERSTNER - AGT. LEASE ACREAGE 149
LEASE NO. 71139
PROPOSED WORK: DRILL ___ CONVERT ___ DRILL DEEPER ___ REDRILL X FRACTURE OR STIMULATE ___ PLUG OFF OLD FORMATION ___ PERFORATE NEW FORMATION ___ OTHER PHYSICAL CHANGE IN WELL (SPECIFY) _____

02/09/2024

PLUG AND ABANDON X CLEAN OUT AND REPLUG ___
TARGET FORMATION _____ ESTIMATED DEPTH _____
WELL OPERATOR CON. GAS SUP. CORP. DESIGNATED AGENT L. J. TIMMS JR.
ADDRESS 445 W. MAIN ST. ADDRESS 445 W. MAIN ST.



State of West Virginia
Department of Mines
Oil and Gas Division

Date _____
Operator's _____
Well No. 12802 (F-5769)
Farm A. C. Bailey
API No. 47-041-3416-P

WELL OPERATOR'S REPORT
OF
DRILLING, FRACTURING AND/OR STIMULATING, OR PHYSICAL CHANGE

WELL TYPE: Oil ___ / Gas X / Liquid Injection ___ / Waste Disposal ___ /
(If "Gas," Production ___ / Underground Storage X / Deep ___ / Shallow ___ /)

LOCATION: Elevation: 1175' Watershed Elk Lick of Fink Creek
District: Freemans Creek County Lewis Quadrangle Vadis

COMPANY Consolidated Gas Supply Corp.
ADDRESS 1145 W. Main St., Clarksburg, WV
DESIGNATED AGENT L. Joseph Timms, Jr.
ADDRESS 1145 W. Main St., Clarksburg, WV
SURFACE OWNER A. C. Bailey
ADDRESS First St., Weston, WV 26152
MINERAL RIGHTS OWNER Ruth M. Geratner, Agt.
ADDRESS 125 Charles St., Glenville, WV 26351
OIL AND GAS INSPECTOR FOR THIS WORK Robert
Bates ADDRESS 109 Minnich St., Weston, WV 26152
PERMIT ISSUED No record
DRILLING COMMENCED No record
DRILLING COMPLETED January 11, 1922
IF APPLICABLE: PLUGGING OF DRY HOLE ON CONTINUOUS PROGRESSION FROM DRILLING OR REWORKING. VERBAL PERMISSION OBTAINED ON _____

Casing & Tubing	Used in Drilling	Left in Well	Cement fill up Cu. ft.
Size 20-16 Cond.	NO RECORD		
13-10"			
9 5/8			
8 5/8			
7			
5 1/2			
4 1/2			
3			
2			
Liners used			

RECEIVED
NOV 8 - 1983
OIL & GAS DIVISION
DEPT. OF MINES

GEOLOGICAL TARGET FORMATION Gantz Depth 2468 feet
Depth of completed well 2490 feet Rotary ___ / Cable Tools X
Water strata depth: Fresh N/R feet; Salt ___ feet
Coal seam depths: 590 Is coal being mined in the area? no

OPEN FLOW DATA

Producing formation Gantz Pay zone depth 2468 feet
Gas: Initial open flow n/a Mcf/d Oil: Initial open flow ___ Bbl/d
Final open flow 1055 Mcf/d Final open flow ___ Bbl/d
Time of open flow between initial and final tests n/a hours
Static rock pressure n/a psig (surface measurement) after ___ hours shut in
(If applicable due to multiple completion--)
Second producing formation ___ Pay zone depth ___ feet
Gas: Initial open flow ___ Mcf/d Oil: Initial open flow ___ Bbl/d
Final open flow ___ Mcf/d Oil: Final open flow ___ Bbl/d
Time of open flow between initial and final tests ___ hours
Static rock pressure ___ psig (surface measurement) after ___ hours shut in

02/09/2024

DETAILS OF PERFORATED INTERVALS, FRACTURING OR STIMULATING, PHYSICAL CHANGE, ETC.

None

WELL LOG

FORMATION	COLOR	HARD OR SOFT	TOP FEET	BOTTOM FEET	REMARKS Including indication of all fresh and salt water, coal, oil and gas
Pittsburgh Coal			590		
Gantz			2468		
Total Depth				2490	

RECEIVED
 NOV 8 1983
 OIL & GAS DIVISION
 DEPT. OF MINES

(Attach separate sheets as necessary)

Consolidated Gas Supply Corp.
Well Operator

02/09/2024

By: J. E. Swinn Manager of Production

Date: November 3, 1983

Note: Regulation 2.02(i) provides as follows:
 "The term 'log' or 'well log' shall mean a systematic detailed geological record of all formations, including coal, encountered in the drilling of a well."