

4102479 P

WW-7
8-30-06



West Virginia Department of Environmental Protection
Office of Oil and Gas
WELL LOCATION FORM: GPS

API: 47-041-02479 WELL NO.: WV 601973 (Teter #1973)

FARM NAME: David Teter

RESPONSIBLE PARTY NAME: EQT Production Company

COUNTY: Lewis 41 DISTRICT: Courthouse 2

QUADRANGLE: Camden 7.5' 276

SURFACE OWNER: John L. & Connie M. Metheny

ROYALTY OWNER: EQT Production Company

UTM GPS NORTHING: 4319507

UTM GPS EASTING: 539046 GPS ELEVATION: 373 m (1225 ft)

The Responsible Party named above has chosen to submit GPS coordinates in lieu of preparing a new well location plat for a plugging permit or assigned API number on the above well. The Office of Oil and Gas will not accept GPS coordinates that do not meet the following requirements:

1. Datum: NAD 1983, Zone: 17 North, Coordinate Units: meters, Altitude: height above mean sea level (MSL) – meters.
2. Accuracy to Datum – 3.05 meters
3. Data Collection Method:

Survey grade GPS _____ : Post Processed Differential _____
Real-Time Differential _____

Mapping Grade GPS X : Post Processed Differential X
Real-Time Differential _____

4. Letter size copy of the topography map showing the well location. JAN 12 2015

I the undersigned, hereby certify this data is correct to the best of my knowledge and belief and shows all the information required by law and the regulations issued and prescribed by the Office of Oil and Gas.

[Signature]
Signature

PS #2180
Title

12/19/14
Date

Received
Office of Oil & Gas

4102479 P

Topo Quad: Camden 7.5' Scale: 1" = 2000'

County: Lewis Date: October 01, 2014

District: Court House Project No: 73-12-00-08

47-041-02479 WV 601973 (Teeter #1973)

Topo

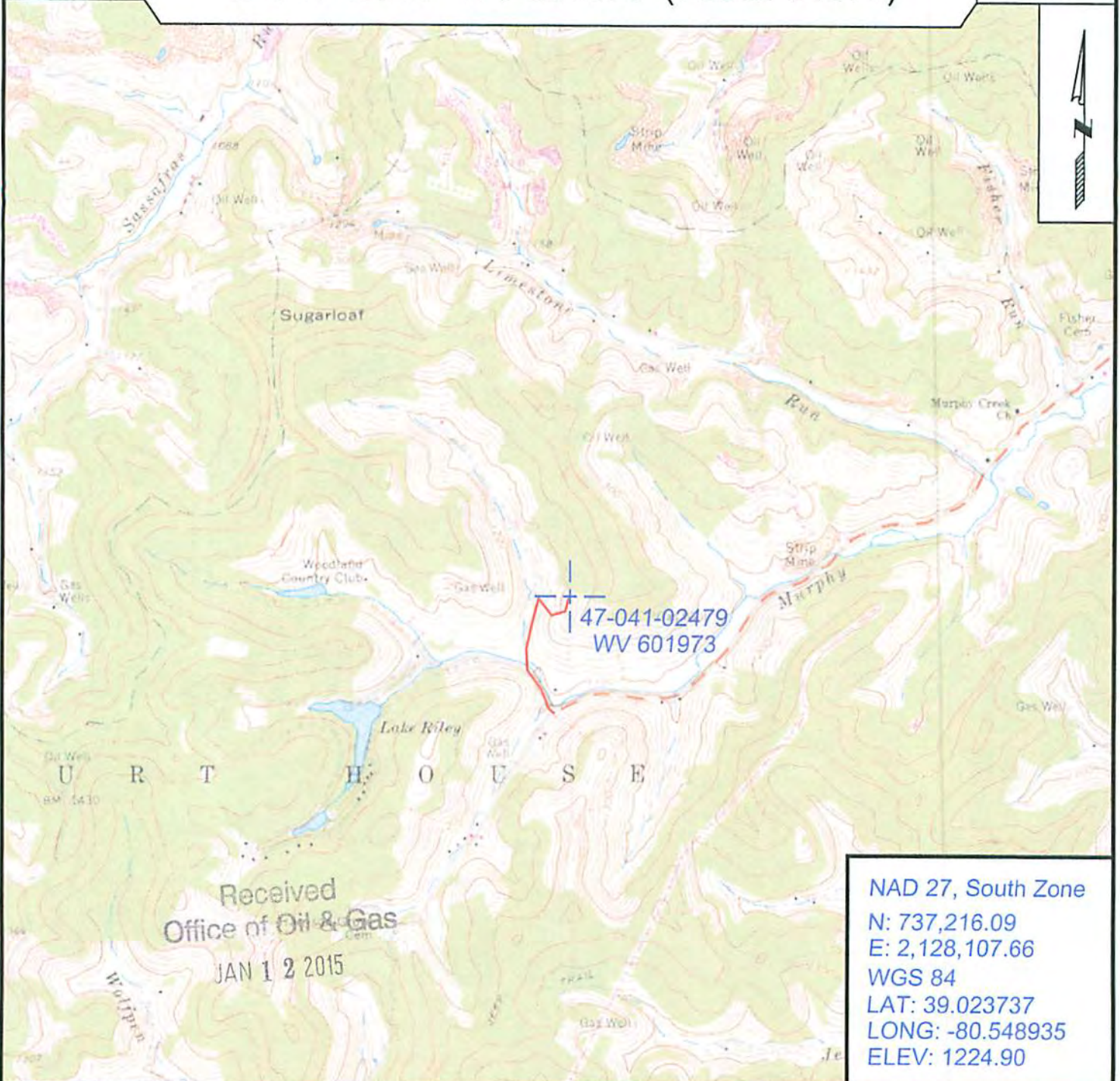

SURVEYING AND MAPPING SERVICES PERFORMED BY:

ALLEGHENY SURVEYS, INC.

1-800-482-8606
237 Birch River Road
Birch River, WV 26610
PH: (304) 649-8606
FAX: (304) 649-8608

PREPARED FOR:

EQT Production Company

P.O. Box 280
Bridgeport, WV 26330