

- Fracture...
- Redrill...
- New Location...
- Drill Deeper...
- Abandonment...

Source of Elevation ROAD FORKS, ELV. 1061 USGS

I, the undersigned, hereby certify that this map is correct to the best of my knowledge and belief and shows all the information required by paragraph 6 of the rules and regulations of the oil and gas section of the mining laws of West Virginia.

Minimum accuracy, one part in 200

Company ALLEGHENY LAND & MINERAL CO.
 Address CLARKSBURG, W.VA. 26301
 Farm S.C. CAMDEM
 Tract 109th Acres 1,600 Lease No. _____
 Well (Farm) No. _____ Serial No. A-504
 Elevation (Spirit Level) 1147'
 Quadrangle VADIS SE 4th
 County LEWIS District FREEMANS CK.
 Engineer R.S. McWilliam
 Engineer's Registration No. 105 L.L.S.
 File No. 224/ Drawing No. _____
 Date 6-9-73 Scale 1" = 500'

STATE OF WEST VIRGINIA
 DEPARTMENT OF MINES
 OIL AND GAS DIVISION
 CHARLESTON

WELL LOCATION MAP
 FILE NO. Lew-1924
DRILLING CANCELED

+ Denotes location of well on United States Topographic Maps, scale 1 to 62,500, latitude and longitude lines being represented by border lines as shown.

— Denotes one inch spaces on border line of original tracing.

47 041

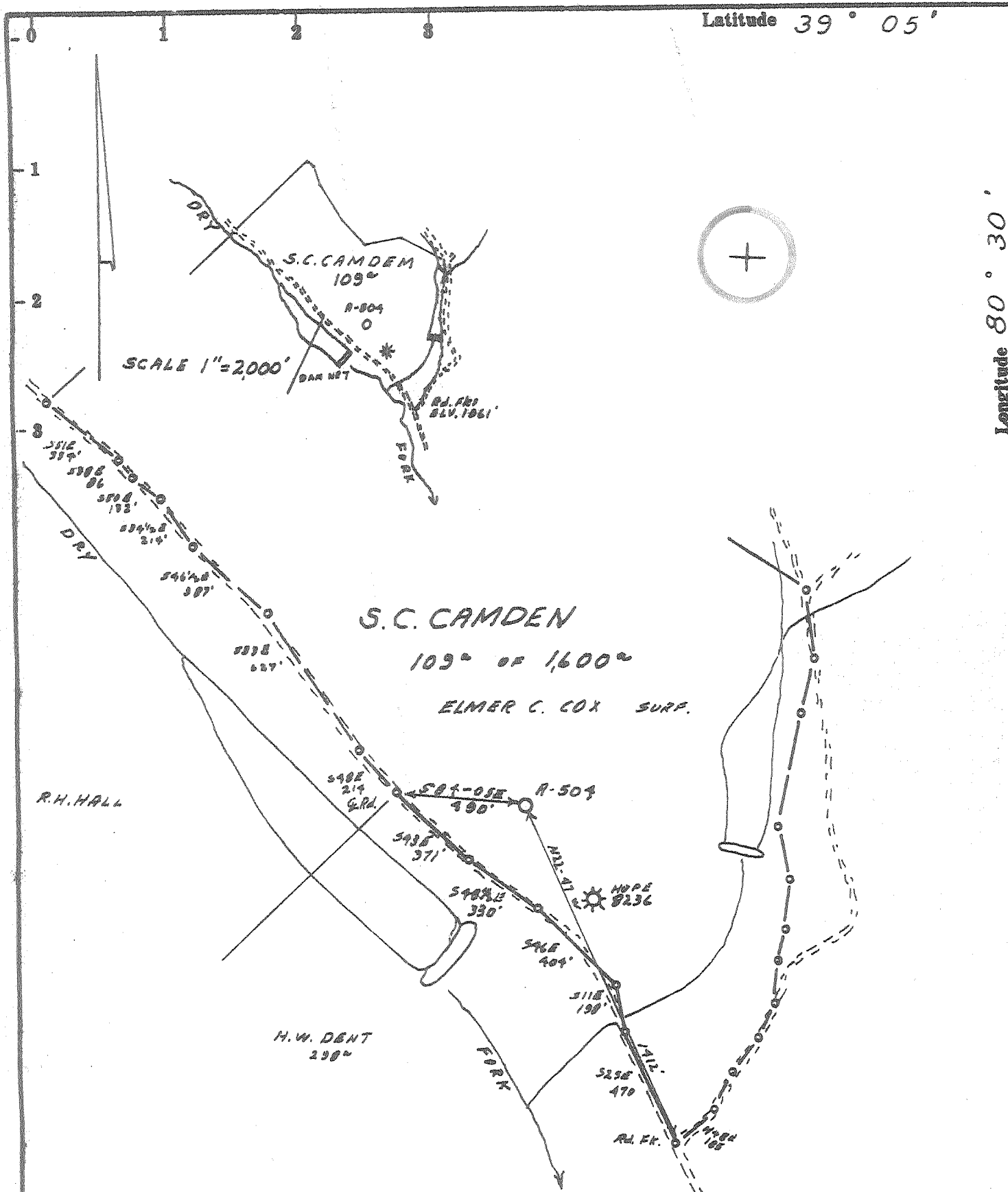

- Fracture
- Redrill
- New Location
- Drill Deeper
- Abandonment

Source of Elevation ROAD FORKS, ELY. 1061' U.S.G.S.

I, the undersigned, hereby certify that this map is correct to the best of my knowledge and belief and shows all the information required by paragraph 8 of the rules and regulations of the oil and gas section of the mining laws of West Virginia.

Minimum accuracy, one part in 200

Company ALLEGHENY LAND & MINERAL CO.
 Address CLARKSBURG, W.VA. 26301
 Farm S.C. CAMDEM
 Tract 109° Acres 1,600 Lease No. _____
 Well (Farm) No. _____ Serial No. A-504
 Elevation (Spirit Level) 1147'
 Quadrangle VADIS SE 4'
 County LEWIS District FREEMANS CK.
 Engineer P. J. McWilliam
 Engineer's Registration No. 105 L.L.S.
 File No. 229/ Drawing No. _____
 Date 6-9-73 Scale 1" = 500'

STATE OF WEST VIRGINIA
 DEPARTMENT OF MINES
 OIL AND GAS DIVISION
 CHARLESTON

WELL LOCATION MAP
 FILE NO. Lev-1924

+ Denotes location of well on United States Topographic Maps, scale 1 to 62,500, latitude and longitude lines being represented by border lines as shown.

- Denotes one inch spaces on border line of original tracing.

47 041



STATE OF WEST VIRGINIA
DEPARTMENT OF MINES

RECEIVED
JUN 15 1973
OIL & GAS DIVISION
DEPT. OF MINES

Oil and Gas Division

OIL AND GAS WELL PERMIT APPLICATION

TO THE DEPARTMENT OF MINES,
Charleston, W. Va.

DATE June 14th., 1973

Surface Owner Dorothy Irene Cox, et vir.

Company Allegheny Land and Mineral Company

Address Route 4, Weston, WV - 26452

Address Clarksburg, WV 26301

Mineral Owner Elva Mae Strickland, et al.

Farm S. D. Camden Acres 1600

Address 32 Hillside Drive, Denver, Colo.

Location (waters) Dry Fork of Polk Creek

Coal Owner Rev. James H. Reed, Agent

Well No. A-504 Elevation 1147'

Address Box 2469, Charleston, WV - 25300

District Freemans Creek County Lewis

Coal Operator none

Quadrangle VADIS SE

Address _____

NOTE: No wells are being drilled, no wells have been drilled to the Oriskany horizon within one mile of this location, excepting wells drilled or drilling by Allegheny Land and Mineral Company.

THIS PERMIT MUST BE POSTED AT THE WELL SITE

All provisions being in accordance with Chapter 22, of the W. Va. Code, the location is hereby approved for drilling. This permit shall expire if operations have not commenced by 10-18-73.

INSPECTOR TO BE NOTIFIED Mr. Paul Thomas
Box 17
Buckhannon PH: 472-6418
WV. 26201

Robert T. Bell
Deputy Director - Oil & Gas Division

GENTLEMEN:

The undersigned well operator is entitled to drill upon the above named farm or tract of land for oil and gas, having fee title thereto, (or as the case may be) under grant or lease dated See attached sheet 19 by _____ made to _____ and recorded on the _____ day of _____ 19____, in _____ County, Book _____ Page _____

XX NEW WELL _____ DRILL DEEPER _____ REDRILL _____ FRACTURE OR STIMULATE _____ OIL AND GAS WELL ORIGINALLY DRILLED BEFORE JUNE 5, 1969.

The enclosed plat was prepared by a registered engineer or licensed land surveyor and all coal owners and/or operators have been notified as of the above date.

The above named coal owners and/or operator are hereby notified that any objection they wish to make, or are required to make by Section 3 of the Code, must be received by, or filed with the Department of Mines within ten (10) days. *

Copies of this notice and the enclosed plat were mailed by registered mail, or delivered to the above named coal operators or coal owners at their above shown respective address _____ day _____ before, or on the same day with the mailing or delivery of this copy to the Department of Mines at Charleston, West Virginia.

Very truly yours, ALLEGHENY LAND AND MINERAL CO.
(Sign Name) By: _____ Manager
Land Well Operator and Right of Way

Address of Well Operator
P. O. Box 1740 Street
Clarksburg City or Town
West Virginia 26301 State

*SECTION 3 If no objections are filed or found by the Department of mines, within said period of ten days from the receipt of notice and plat by the department of mines, to said proposed location, the department shall forthwith issue to the well operator a permit reciting the filing of such plat, that no objections have been made by the coal operators or found thereto by the department and that the same is approved and the well operator authorized to proceed.

Lew-1924 PERMIT NUMBER
47 041

BLANKET BOND

THIS IS AN ESTIMATE ONLY
ACTUAL INFORMATION WILL BE SUBMITTED ON OG-10 UPON COMPLETION

PROPOSED WORK ORDER TO XX DRILL _____ DEEPEN _____ FRACTURE-STIMULATE _____
 DRILLING CONTRACTOR: (If Known) RESPONSIBLE AGENT:
 NAME Union Drilling, Inc. NAME Allegheny Land and Mineral Company
 ADDRESS Buckhannon, WV - 26201 ADDRESS Clarksburg, WV - 26301
 TELEPHONE _____ TELEPHONE 624-7659
 ESTIMATED DEPTH OF COMPLETED WELL: 7017' ROTARY XX CABLE TOOLS _____
 PROPOSED GEOLOGICAL FORMATION: Oriskany
 TYPE OF WELL: OIL _____ GAS XX COMB. _____ STORAGE _____ DISPOSAL _____
 RECYCLING _____ WATER FLOOD _____ OTHER _____

TENTATIVE CASING PROGRAM:

CASING AND TUBING SIZE	USED FOR DRILLING	LEFT IN WELL	CEMENT FILL UP OR SACKS - CUBIC FT.
20 - 16	20'	20'	cement to surface
13 - 10			
9 - 5/8	1400'	1400'	cement to surface
8 - 5/8			
7			
5 1/2			cement to 300' above
4 1/2	7017'	7017'	the Chert formation
3			Perf. Top
2			Perf. Bottom
Liners			Perf. Top
			Perf. Bottom

APPROXIMATE FRESH WATER DEPTHS 550 FEET SALT WATER _____ FEET
 APPROXIMATE COAL DEPTHS 200-670
 IS COAL BEING MINED IN THE AREA? no BY WHOM? _____

TO DRILL:

SUBMIT FIVE (5) COPIES OF OG - 1, \$100.00 PERMIT FEE, PERFORMANCE BOND AND PERMANENT COPY OF PLAT.

TO DRILL DEEPER OR REDRILL:

SUBMIT FIVE (5) COPIES OF OG - 1, SHOWING ORIGINAL PERMIT NUMBER AND PERFORMANCE BOND. ON WELLS DRILLED PRIOR TO 1929, A PERMANENT COPY OF THE PLAT AND THE ORIGINAL WELL RECORD MUST ALSO BE SUBMITTED.

TO FRACTURE - STIMULATE:

OIL AND/OR GAS WELL ORIGINALLY DRILLED BEFORE JUNE 5, 1929, FIVE (5) COPIES OG - 1, PERFORMANCE BOND, PERMANENT PLAT AND ORIGINAL WELL RECORD.

OIL AND/OR GAS WELL ORIGINALLY DRILLED ON AND/OR AFTER JUNE 5, 1929, FIVE COPIES OG - 1, SHOWING ORIGINAL PERMIT NUMBER, AND PERFORMANCE BOND.

Required forms must be filed within ninety (90) days of completion for bond release. Inspector to be notified twenty-four (24) hours in advance.

The following waiver must be completed by the coal operator if the permit is to be issued within ten days of receipt thereof.

WAIVER: I the undersigned, Agent for _____ Coal Company, Owner or Operator of the coal under this lease have examined and place on our mine maps this proposed well location.

We the _____ Coal Company have no objections to said well being drilled at this location, providing operator has complied with all rules and regulations in Articles 4, 5, and 7, Chapter 22 of the West Virginia Code.

For Coal Company

Official Title

RECEIVED

JUN 15 1973

OIL & GAS DIVISION
DEPT. OF MINES

Under grant or lease dated the 15th. day
of June, 1899, between S. D. Camden and
Flora Camden, his wife, and the Southern
Oil Company, Subsequently Consolidated Gas
Supply Corporation, and of record in the
County Clerks Office of Lewis County, West
Virginia, in Lease or Deed Book 40 at Page
561, on October 30th. 1899. The said lease
has been assigned to Allegheny Land and
Mineral Company by Consolidated Gas Supply
Corporation under agreement dated the 12th.
day of April, 1973