

NOV 09 2015

WW-7
8-30-06

WV Department of
Environmental Protection



West Virginia Department of Environmental Protection
Office of Oil and Gas

WELL LOCATION FORM: GPS

API: 47-041-00406 WELL NO.: 10247
FARM NAME: Catherine A. See
RESPONSIBLE PARTY NAME: CNX Gas Company LLC
COUNTY: Lewis DISTRICT: Skin Creek
QUADRANGLE: Crawford
SURFACE OWNER: Mary B See & Ralph Edward See
ROYALTY OWNER: See Attached
UTM GPS NORTHING: 4,311,204.422 (UTM83) = 4311762.3
UTM GPS EASTING: 550,519.873 (UTM83) = 550648.5 GPS ELEVATION: 1184'

The Responsible Party named above has chosen to submit GPS coordinates in lieu of preparing a new well location plat for a plugging permit or assigned API number on the above well. The Office of Oil and Gas will not accept GPS coordinates that do not meet the following requirements:

1. Datum: NAD 1983, Zone: 17 North, Coordinate Units: meters, Altitude: height above mean sea level (MSL) – meters.
2. Accuracy to Datum – 3.05 meters
3. Data Collection Method:

Survey grade GPS : Post Processed Differential

Real-Time Differential

Mapping Grade GPS : Post Processed Differential

Real-Time Differential

4. Letter size copy of the topography map showing the well location.

I the undersigned, hereby certify this data is correct to the best of my knowledge and belief and shows all the information required by law and the regulations issued and prescribed by the Office of Oil and Gas.

Mary Naulty Permitting Manager 11/09/2015
Signature Title Date

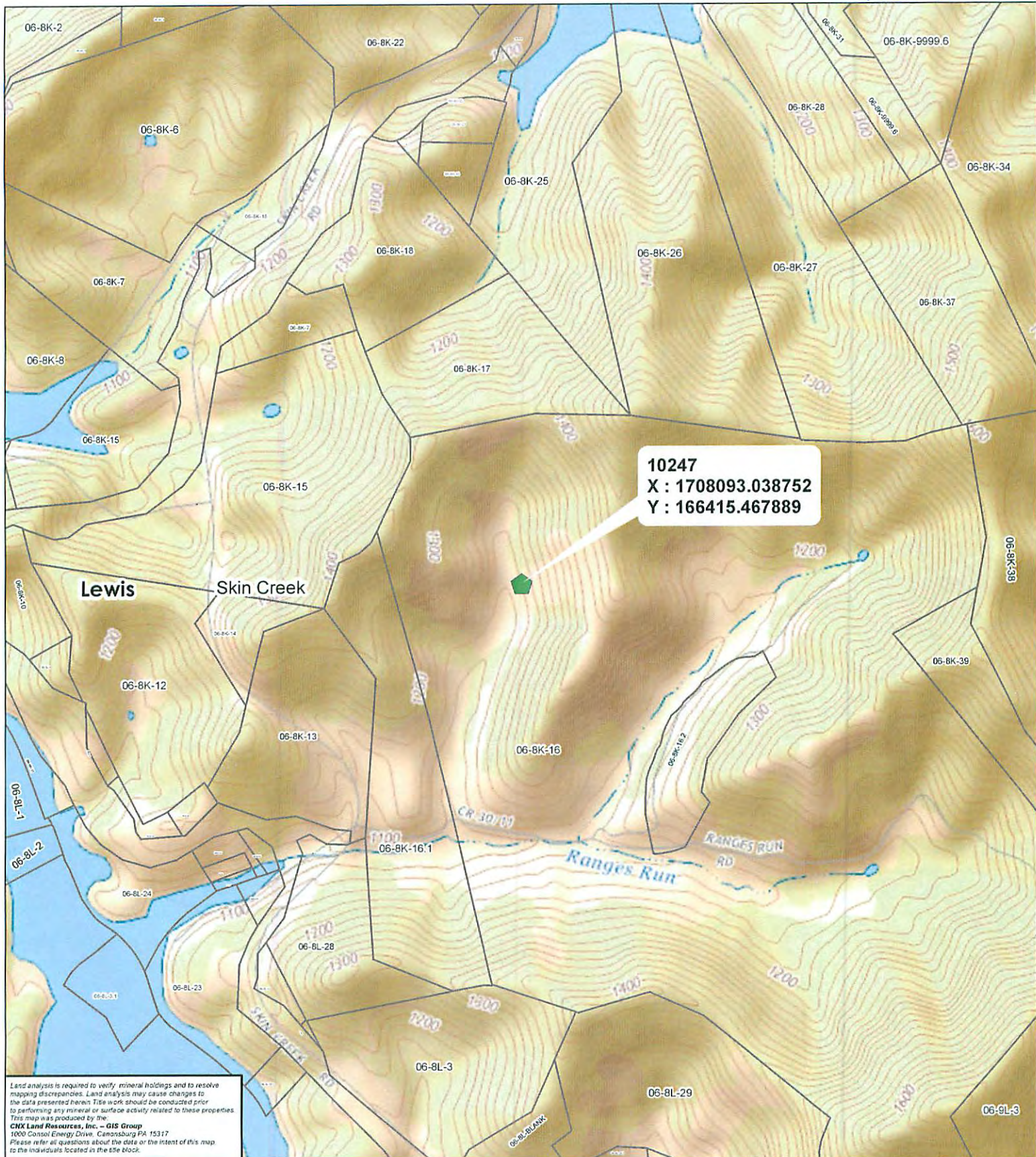

10247
X : 1708093.038752
Y : 166415.467889

Land analysis is required to verify mineral holdings and to resolve mapping discrepancies. Land analysis may cause changes to the data presented herein. Title work should be conducted prior to performing any mineral or surface activity related to these properties. This map was produced by the:
CNX Land Resources, Inc. - GIS Group
 1000 Consol Energy Drive, Canonsburg PA 15317
 Please refer all questions about the data or the intent of this map to the individuals located in the title block.

Legend
 10247
 Surface Parcel Updates

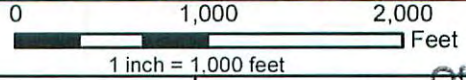

RECEIVED
CONSOL ENERGY
 CNX Center, Canonsburg, PA
 Office of Oil and Gas

Original Date: 10/8/2015	Prepared By: Julie Long
Revision Date: 10/8/2015	Approved By: K. Pritchard

OCT 23 2015
 GP207
 10247
 Lewis County, WV
11/20/2015
Environmental Protection

This map is property of CNX Land Resources Inc. and contains information that is proprietary and confidential in nature and may not be copied or reproduced without prior written consent.
 © Copyright CNX Land Resources Inc. 2011