







Diversified Gas & Oil Corporation  
 100 Diversified Way  
 Pikeville KY, 41051

47-041-00116

Plugging Map

**Legend**

-  Well
-  Access Road
-  Pits
-  Pad
-  Public Roads

RECEIVED  
 Office of Oil and Gas  
 OCT 27 2021  
 WV Department of Environmental Protection

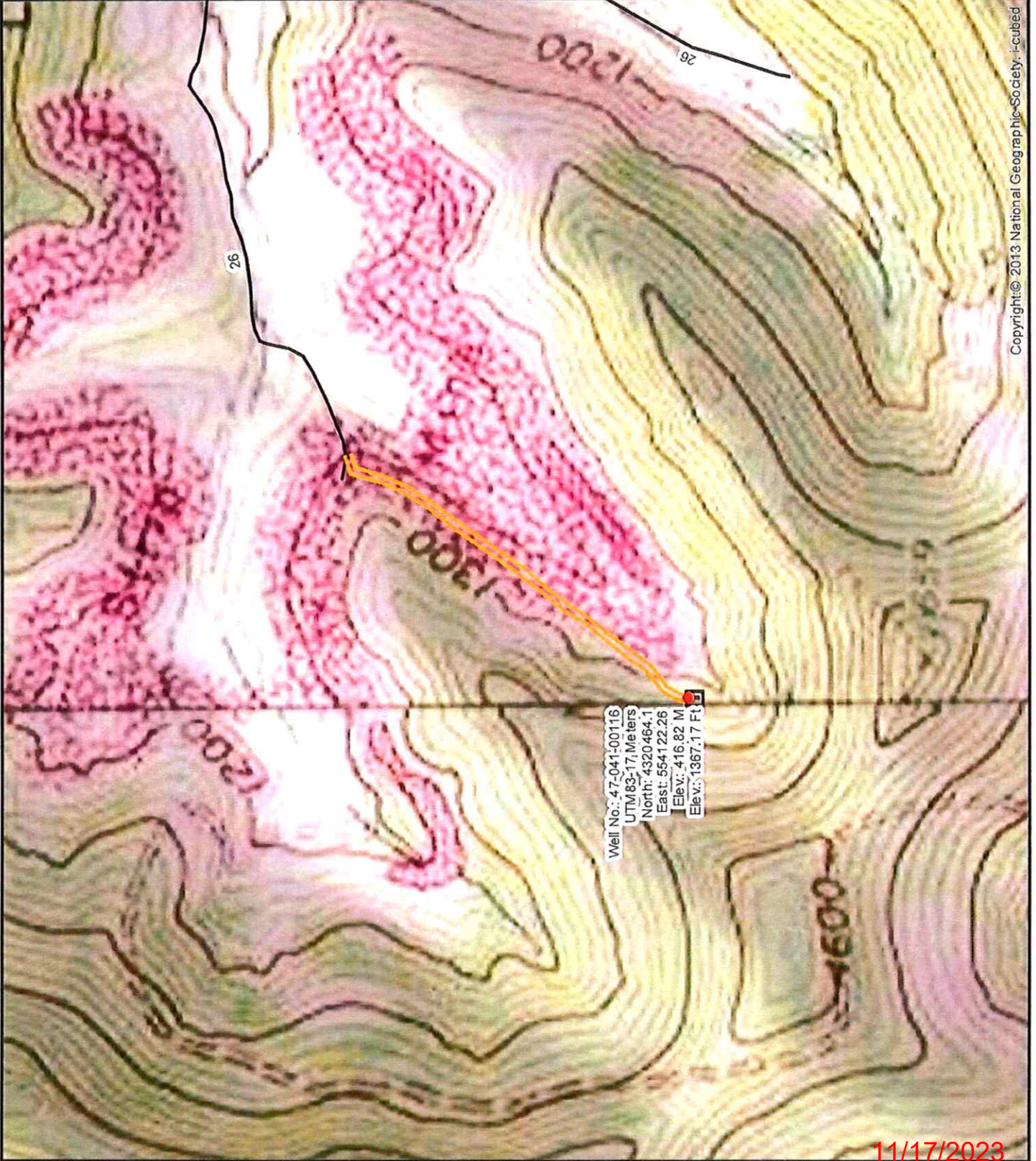
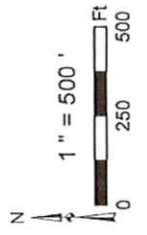
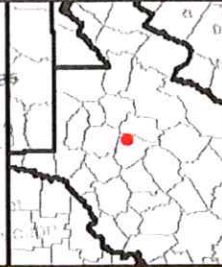

Well No.: 47-041-00116  
 UTM 183-17, Meters  
 North: 4320464.1  
 East: 554122.26  
 Elev.: 416.82 M  
 Elev.: 1367.17 Ft

Copyright © 2013 National Geographic Society. i-cubed

11/17/2023







Diversified Gas & Oil Corporation  
 100 Diversified Way  
 Pikeville KY, 41051

47-041-00116

Plugging Map

**Legend**

-  Well
-  Access Road
-  Pits
-  Pad
-  Public Roads

RECEIVED  
 Office of Oil and Gas  
 OCT 27 2023

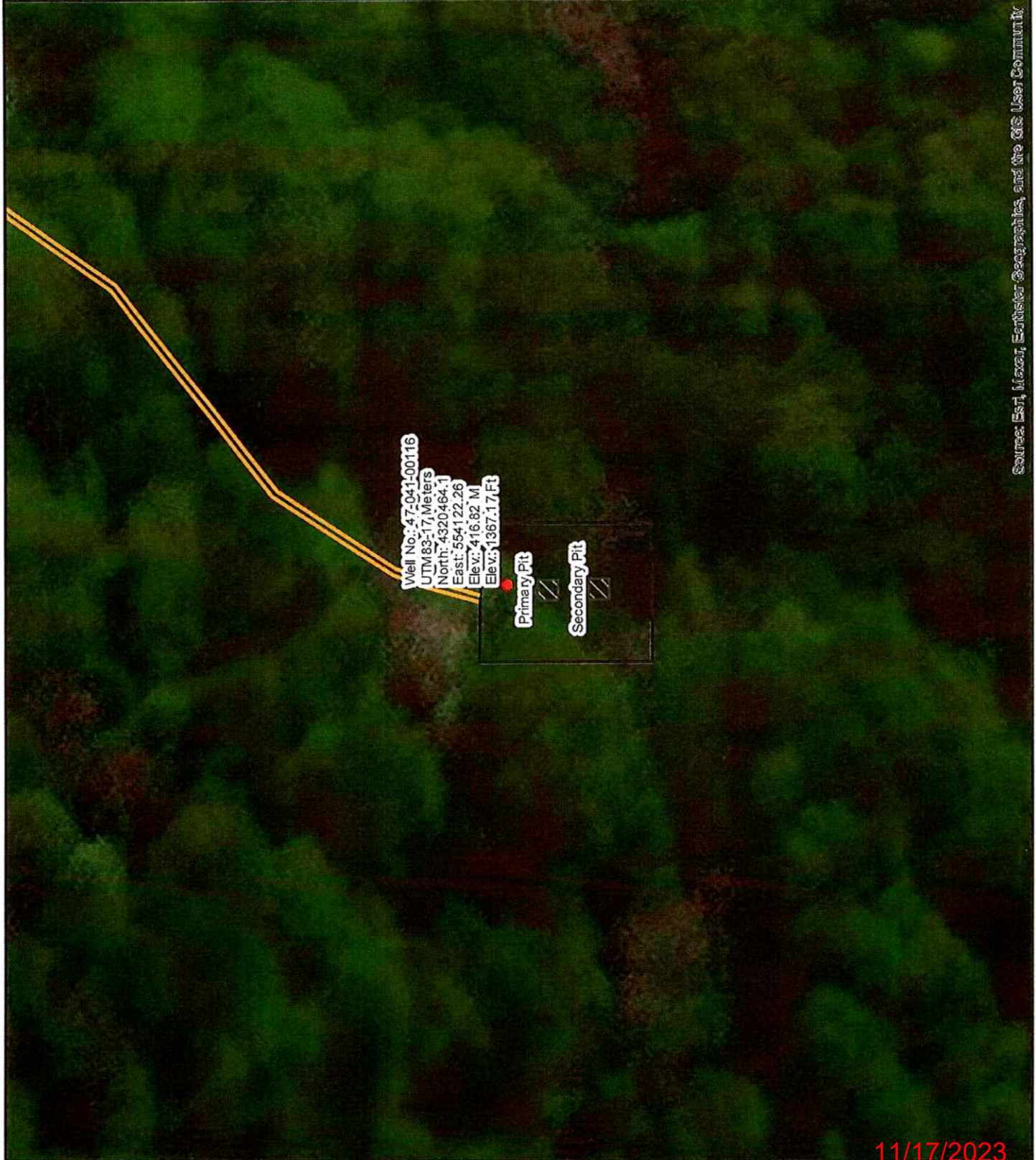
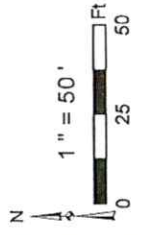

Source: Esri, Maxar, Earthstar Geographics, and the GIS User Community

11/17/2023

WW-7  
8-30-06



West Virginia Department of Environmental Protection  
Office of Oil and Gas  
**WELL LOCATION FORM: GPS**

API: 4704100116 WELL NO.: Gould W - 9036  
FARM NAME: W.G. Gould  
RESPONSIBLE PARTY NAME: Diversified Production, LLC  
COUNTY: Lewis DISTRICT: Hackers Creek  
QUADRANGLE: Weston 7.5'  
SURFACE OWNER: Beckwith Lumber Co.  
ROYALTY OWNER: Helen S. Henderson, Alma Rexroad, Brenda L. Gould  
UTM GPS NORTHING: 4320464.1  
UTM GPS EASTING: 554122.26 GPS ELEVATION: 1367.17'

The Responsible Party named above has chosen to submit GPS coordinates in lieu of preparing a new well location plat for a plugging permit or assigned API number on the above well. The Office of Oil and Gas will not accept GPS coordinates that do not meet the following requirements:

- Datum: NAD 1983, Zone: 17 North, Coordinate Units: meters, Altitude: height above mean sea level (MSL) – meters.
- Accuracy to Datum – 3.05 meters
- Data Collection Method:  
Survey grade GPS  : Post Processed Differential   
Real-Time Differential   
Mapping Grade GPS  : Post Processed Differential   
Real-Time Differential
- Letter size copy of the topography map showing the well location.

I the undersigned, hereby certify this data is correct to the best of my knowledge and belief and shows all the information required by law and the regulations issued and prescribed by the Office of Oil and Gas.

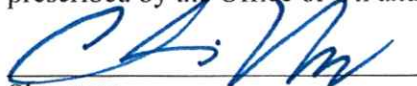
  
Signature

Chris Veazey - Permitting Supervisor  
Title

09/15/23  
Date

RECEIVED  
Office of Oil and Gas  
OCT 27 2023  
WV Department of  
Environmental Protection

11/17/2023