

Latitude 38 55

Longitude 81 30

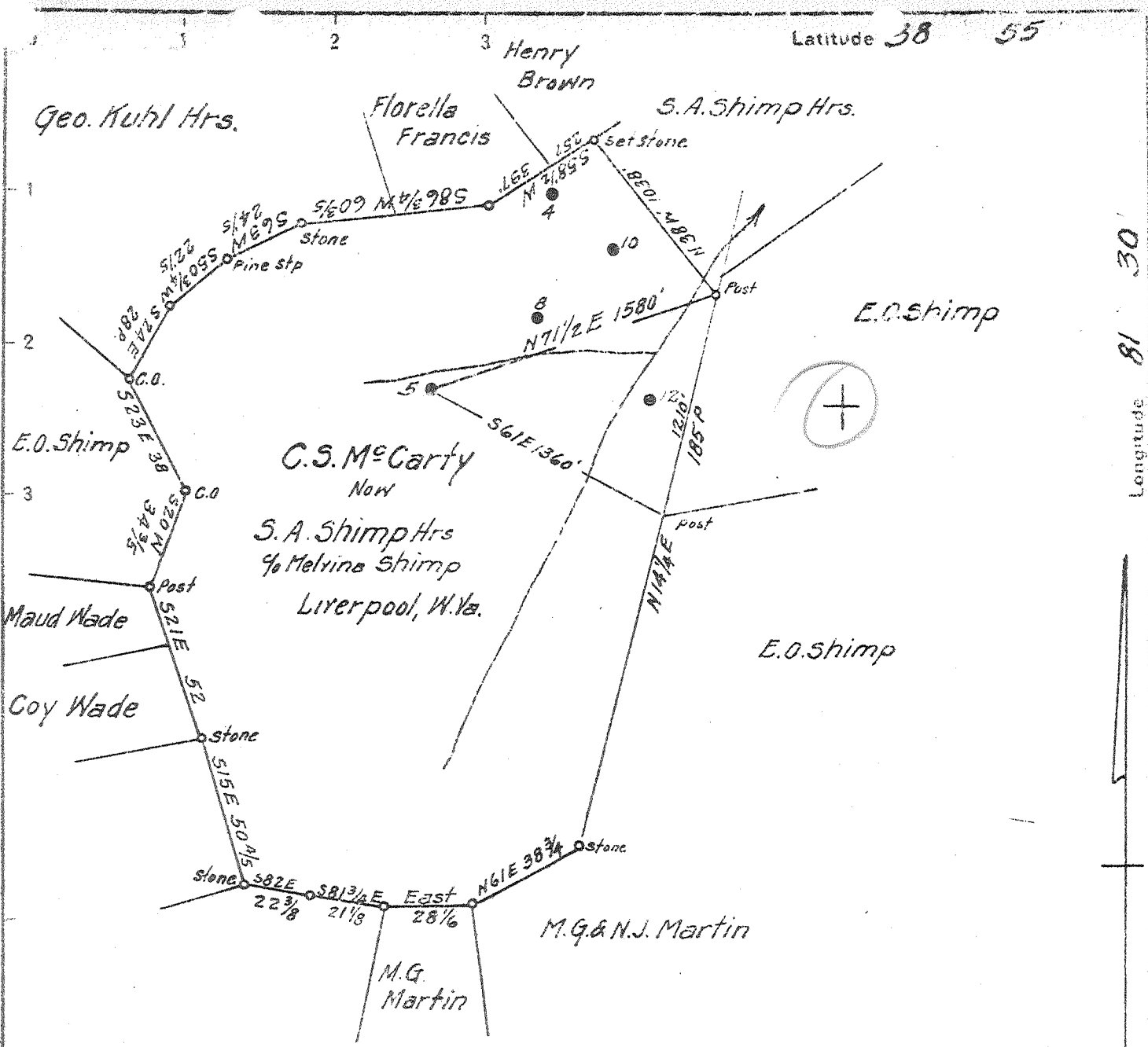

No Coal

*(Handwritten initials and a checkmark)*

*(Handwritten notes: 2.00-W, 2.57-S)*

New Location   
 Drill Deeper   
 Abandonment

538 W 51-52 Map 30

Company South Penn Natural Gas Co.  
 Address Parkersburg, W.Va.  
 Farm C.S. McCarty  
 Tract \_\_\_\_\_ Acres 235 Lease No. 74952  
 Well (Farm) No. 5 Serial No. \_\_\_\_\_  
 Elevation (Spirit Level) 745.54  
 Quadrangle Ripley  
 County Jackson District Ravenswood  
 Engineer E.C. Tabler  
 Engineer's Registration No. \_\_\_\_\_  
 File No. \_\_\_\_\_ Drawing No. \_\_\_\_\_  
 Date 12-7-43 Scale 1"=800'

STATE OF WEST VIRGINIA  
 DEPARTMENT OF MINES  
 OIL AND GAS DIVISION  
 CHARLESTON

WELL LOCATION MAP  
 FILE NO. JAC-86A

+ Denotes location of well on United States Topographic Maps, scale 1 to 62,500, latitude and longitude lines being represented by border lines as shown.

- Denotes one inch spaces on border line of original tracing.

*(Handwritten: 6-6-161, Liverpool)*

C.S. McCARTY No. 5 - SOUTH PENN N.G. Co. - JAC-86-A



100

STATE OF WEST VIRGINIA  
DEPARTMENT OF MINES  
OIL AND GAS DIVISION

WELL RECORD

Permit No. 86-A

Oil or Gas Well OIL  
(KIND)

Company South Penn Natural Gas Company  
Address Union Trust Bldg. Parkersburg, W. Va.  
Farm C. S. McCarty Acres 235  
Location (waters) Sandy (Buck Run)  
Well No. 5 Elev. 745.54  
District Ravenswood County Jackson  
The surface of tract is owned in fee by S. A. Shimp Heirs  
c/o Melvina Shimp Address Liverpool, W. Va.  
Mineral rights are owned by S. A. Shimp Heirs et al  
c/o Melvina Shimp Address Liverpool, W. Va.  
Drilling commenced Feb. 28, 1929  
Drilling completed April 18, 1929  
Date Shot 1-25-29 - 30 qts. Both shots  
1-25-34 - 40 qts. in Berea

Casing and Tubing	Used in Drilling	Left in Well	Packers
Size			
16			Kind of Packer <u>er</u>
18			<u>B.H. Lead Pack-</u>
10	<u>925'</u>		Size of <u>6-5/8" X 8-1/4"</u>
8 3/4	<u>1301' (Pulled)</u>		Depth set <u>2204</u>
6%	<u>2219'</u>		Perf. top <u>-</u>
5 3/16			Perf. bottom <u>-</u>
3			Perf. top <u>-</u>
2			Perf. bottom <u>-</u>
Liners Used			Perf. top <u>-</u>
<u>16'</u>			Perf. bottom <u>-</u>

Open Flow /10ths Water in - Inch  
/10ths Merc. in - Inch  
Volume - Cu. Ft.  
Rock Pressure - lbs. - hrs.  
Oil 20 bbls., 1st 24 hrs.  
Fresh water - feet - feet  
Salt water 1525 feet 1950 feet

CASING CEMENTED - SIZE - No. Ft. - Date -  
COAL WAS ENCOUNTERED AT - FEET - INCHES  
- FEET - INCHES - FEET - INCHES  
- FEET - INCHES - FEET - INCHES

Formation	Color	Hard or Soft	Top	Bottom	Oil, Gas or Water	Depth Found	Remarks
Slate			16	50			
Red Rock			50	150			
Lime			150	200			
Red Rock			200	300			
Slate & Shells			300	350			
Red Rock & Slate			350	690			
✓ Pgh. Sand, 1st			690	793			
Slate			793	795			
✓ Pgh. Sand, 2nd			795	825			
Slate			825	860			
Lime			860	890			
Slate			890	927			
Shell			927	930			
Red Rock			930	960			
Lime			960	1000			
Red Rock			1000	1035			
Lime			1035	1075			
Slate			1075	1135			
Lime			1135	1200			
Slate			1200	1225			
Lime			1225	1275			
Pink Rock			1275	1285			
✓ Big Dunkard			1285	1390			
Slate			1390	1420			
Sand			1420	1510			
Black Slate			1510	1525			
Sand			1525	1590			
Slate			1590	1600	Water	1525	
Sand			1600	1825			
Lime			1825	1905			
✓ Salt Sand			1905	2095	Water	1950	Hole full
✓ Big Lime			2095	2150			
✓ Big Injun			2150	2175			
Slate			2175	2198			

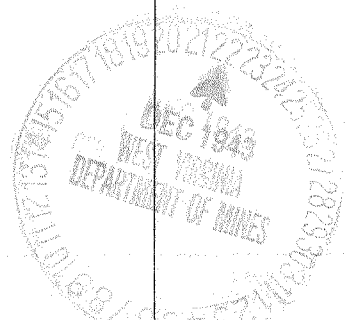

Formation	Color	Hard or Soft	Top	Bottom	Oil, Gas or Water	Depth Found	Remarks
Cont'd.							
Shells			2198	2206			
Slate			2206	2250			
Shells			2250	2260			
Slate & Shells			2260	2375			
Slate			2375	2583			
Black Shale - <i>Copper Shale?</i>			2583	2591			
Shell			2591	2593			
Berea			2593	2603			
					Oil	2594-2603	
Total Depth				2606			
				(410)			

Date Dec. 21, 1943., 194

APPROVED SOUTH PENN NATURAL GAS COMPANY, Owner

By *Elton Elving* Land Agent.  
(Title)