

NOTE:
THIS PLAT HAS BEEN PREPARED
FROM DEEDS AND TAX MAPS;
NOT A BOUNDARY SURVEY

* NO BUILDINGS OR WELLS
LOCATED WITHIN 200'

SURFACE LOCATION OF WELL ON
UNITED STATES (NAD83)
TOPOGRAPHIC MAPS (7 1/2')
NAD83
LAT: 38° 52' 44.55"
LONG: 81° 41' 05.51"
UTM METERS (NAD83)
N: 4303576.7
E: 440595.3

FILE # _____
DRAWING # 12597
SCALE: 1" = 400'
MINIMUM DEGREE
OF ACCURACY: 1:2,500'
PROVEN SOURCE STATIC GPS SURVEY
OF ELEVATION: WITH TIES TO NGS DATA

I, THE UNDERSIGNED, HEREBY CERTIFY THAT THIS
PLAT IS CORRECT TO THE BEST OF MY KNOWLEDGE AND
BELIEF AND SHOWS ALL THE INFORMATION REQUIRED BY
LAW AND THE REGULATIONS ISSUED AND PRESCRIBED BY
THE DEPARTMENT OF ENVIRONMENTAL PROTECTION.

Signed: *[Signature]*
R.P.E.: _____ L.L.S.: 1064

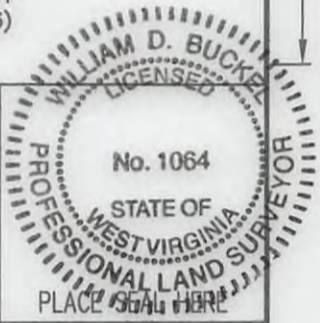

+) DENOTES LOCATION OF WELL ON
UNITED STATES TOPOGRAPHIC MAPS
WVDEP
OFFICE OF OIL & GAS
601 57TH STREET
CHARLESTON, WV 25304



DATE: 12/27/2016
OPERATOR'S WELL #: 12597
API WELL #: 47 035 03027 T
STATE COUNTY PERMIT

Well Type: Oil Waste Disposal Production Deep
 Gas Liquid Injection Storage Shallow

WATERSHED: ~~SEEP FORK~~ MUD RUN ELEVATION: 804'
COUNTY/DISTRICT: JACKSON / RIPLEY QUADRANGLE: SANDYVILLE
SURFACE OWNER: MICHAEL W. & BILLIE J. DEBERRY ACREAGE: 132
OIL & GAS ROYALTY OWNER: OTIS COAST AND KATIE COAST ACREAGE: 50
LEASE NO. 1052291-000 (SURFACE) 1052786-000 (BOTTOM HOLE)
DRILL CONVERT DRILL DEEPER REDRILL FRACTURE OR STIMULATE
PLUG OFF OLD FORMATION PERFORATE NEW FORMATION PLUG & ABANDON
CLEAN OUT & REPLUG OTHER CHANGE SPECIFY): _____

TARGET FORMATION: ORISKANY SANDSTONE (STORAGE RESERVOIR) ESTIMATED DEPTH: 5003 FT. TVD
5196 FT. MD
WELL OPERATOR COLUMBIA GAS TRANSMISSION DESIGNATED AGENT PAUL AMICK
Address 1700 MACCORKLE AVE. SE PO BOX 1273 Address 1700 MACCORKLE AVE. SE PO BOX 1273
City CHARLESTON State WV Zip Code 25325-1273 City CHARLESTON State WV Zip Code 25325-1273

03/03/2017

RECEIVED
JAN 08 2017
WV Department of Environmental Protection

3503027T

(PORTLAND)



SANDYVILLE QUADRANGLE
WEST VIRGINIA
TOPOGRAPHIC SERIES

(ROCKPORT)

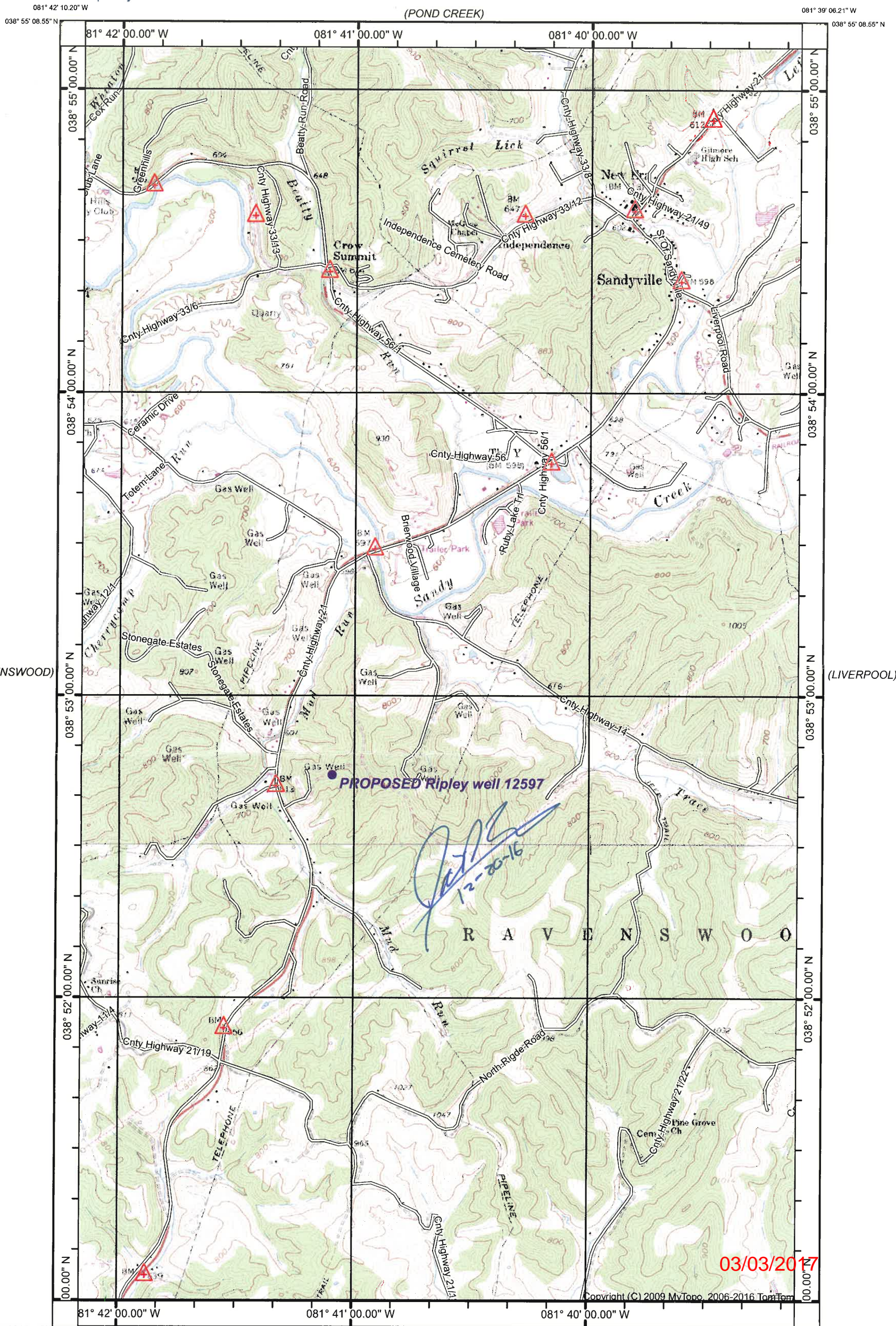

(RAVENSWOOD)

(LIVERPOOL)

PROPOSED Ripley well 12597

[Handwritten signature]
12-20-16

R A V E N S W O O

03/03/2017

Copyright (C) 2009 MyTopo, 2006-2016 TomTom

Printed: Sat Dec 17, 2016

(COTTAGEVILLE)

(GAY)

Declination



(RIPLEY)
SCALE 1:24000

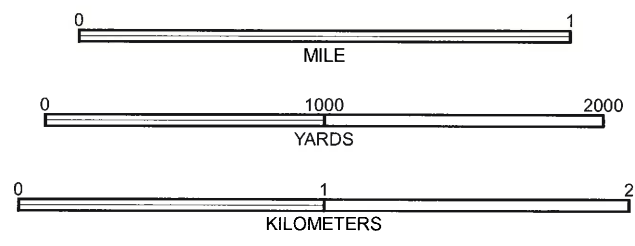

Produced by MyTopo Terrain Navigator
Topography based on USGS 1:24,000 Maps
North American 1983 Datum (NAD83)
Polyconic Projection
To place on the predicted North American 1927 move the
projection lines 9M N and 13M E

SANDYVILLE, WV
1960

CONTOUR INTERVAL 20 FEET
NATIONAL GEODETIC VERTICAL DATUM 1929