



Diversified Gas & Oil Corporation  
 100 Diversified Way  
 Pikeville KY, 41051

47-035-01875

Plugging Map

**Legend**

- Well
- Access Road
- Pits
- Pad
- Public Roads

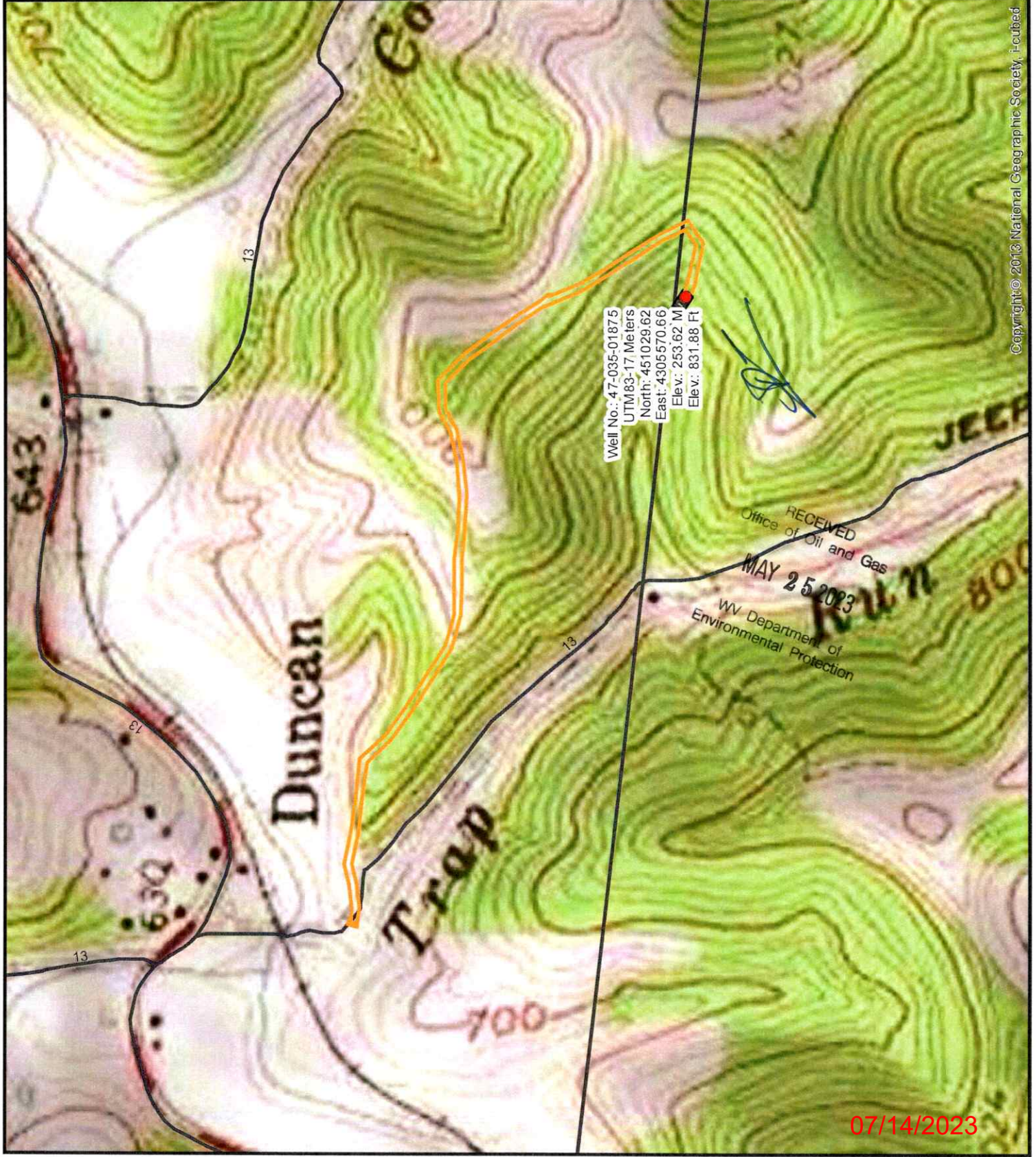
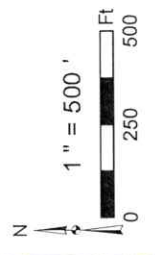
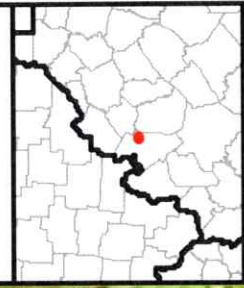

Copyright © 2018 National Geographic Society, Inc.

07/14/2023

WW-7  
8-30-06



West Virginia Department of Environmental Protection  
Office of Oil and Gas  
**WELL LOCATION FORM: GPS**

API: 47-035-01875 WELL NO.: KEM #352

FARM NAME: Bertha Conner Utt

RESPONSIBLE PARTY NAME: Diversified Energy

COUNTY: Jackson DISTRICT: Ravenswood

QUADRANGLE: Liverpool 7.5'

SURFACE OWNER: David & Gladys Wade

ROYALTY OWNER: See Attached

UTM GPS NORTHING: 451029.62

UTM GPS EASTING: 4305570.66 GPS ELEVATION: 832'

The Responsible Party named above has chosen to submit GPS coordinates in lieu of preparing a new well location plat for a plugging permit or assigned API number on the above well. The Office of Oil and Gas will not accept GPS coordinates that do not meet the following requirements:

1. Datum: NAD 1983, Zone: 17 North, Coordinate Units: meters, Altitude: height above mean sea level (MSL) – meters.
2. Accuracy to Datum – 3.05 meters
3. Data Collection Method:

Survey grade GPS \_\_\_\_ : Post Processed Differential \_\_\_\_  
Real-Time Differential \_\_\_\_

Mapping Grade GPS X : Post Processed Differential X  
Real-Time Differential \_\_\_\_

4. **Letter size copy of the topography map showing the well location.**

I the undersigned, hereby certify this data is correct to the best of my knowledge and belief and shows all the information required by law and the regulations issued and prescribed by the Office of Oil and Gas.

Chris Veazey  
Signature

Chris Veazey - Permitting Supervisor  
Title

5/11/23  
Date

RECEIVED  
Office of Oil and Gas  
MAY 25 2023  
WV Department of  
Environmental Protection

07/14/2023