

Latitude 38° 55'

Longitude 81° 45'

4.00 MI. S.  
2.92 MI. W.

L.E. STEPHENS  
105 ACRES

ACCURACY: 1P/200P

Source of Elevation ROAD INTERSECTION (872')

I, the undersigned, hereby certify that this map is correct to the best of my knowledge and belief and shows all the information required by paragraph 6 of the rules and regulations of the oil and gas section of the mining laws of West Virginia.

- New Location
- Drill Deeper
- Abandonment
- Fracture
- Redrill

*Chet Waterman*

Company W.C. STALNAKER  
 Address CHARLESTON, W. VA.  
 Farm L.E. STEPHENS  
 Tract Acres 105 <sup>of 170</sup> Lease No. \_\_\_\_\_  
 Well (Farm) No. 1 Serial No. \_\_\_\_\_  
 Elevation (Spirit Level) 775'  
 Quadrangle RAVENSWOOD EC  
 County JACKSON District UNION  
 Engineer CHET WATERMAN  
 Engineer's Registration No. 3788  
 File No. 70003-471 Drawing No. \_\_\_\_\_  
 Date 12/8/70 Scale 1" = 30P

STATE OF WEST VIRGINIA  
DEPARTMENT OF MINES  
OIL AND GAS DIVISION  
CHARLESTON

WELL LOCATION MAP  
FILE NO. File 2268-P

+ Denotes location of well on United States Topographic Maps, scale 1 to 62,500, latitude and longitude lines being represented by border lines as shown.

-- Denotes one inch spaces on border line of original tracing.

6-6 North Ripley (342) Deep Well

FEB 28 1974

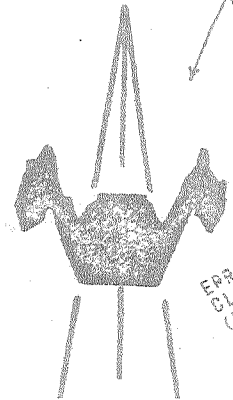
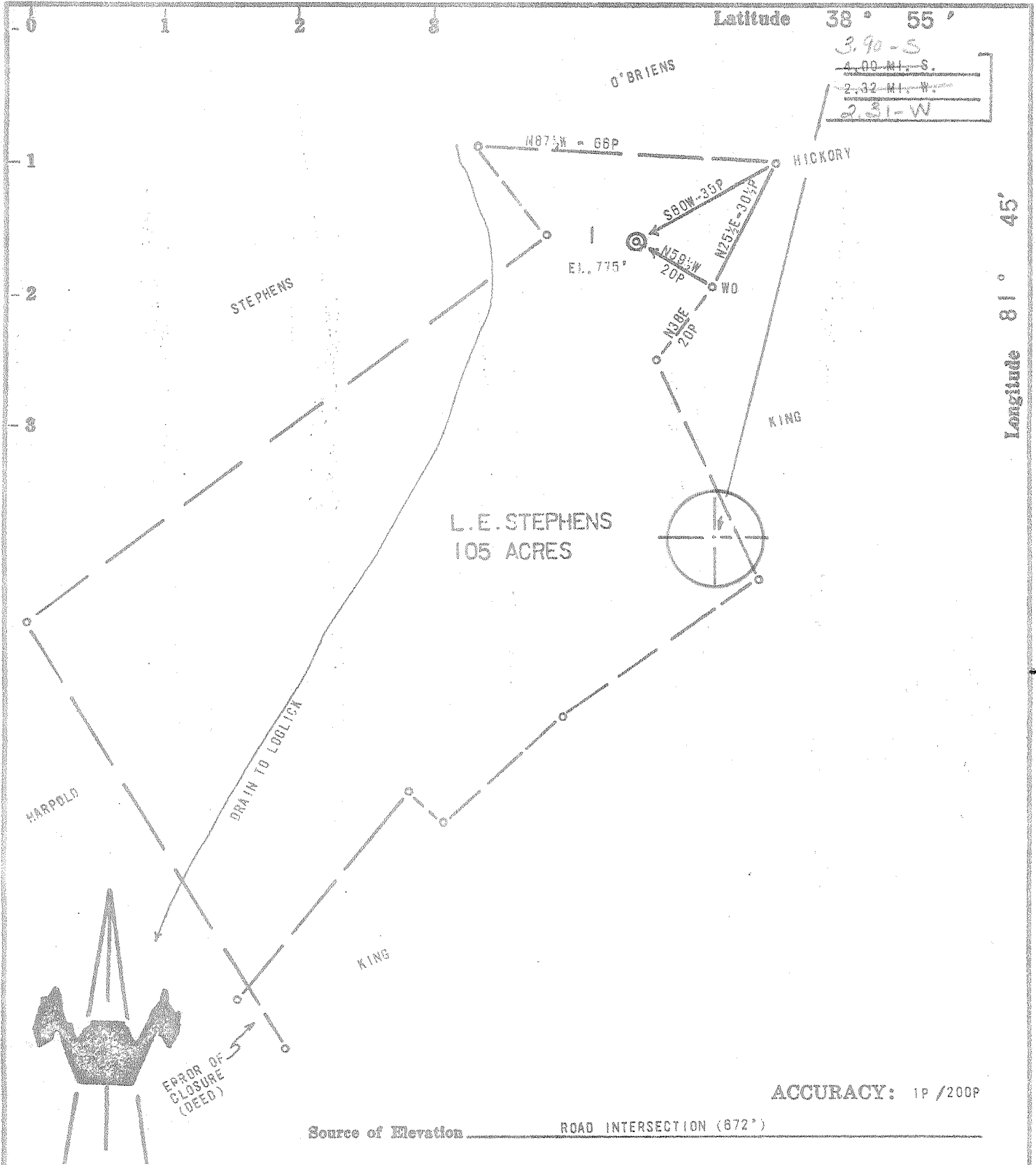

ERROR OF CLOSURE (DEED)

ACCURACY: 1P/200P

Source of Elevation ROAD INTERSECTION (872')

- New Location
- Drill Deeper
- Abandonment
- Fracture
- Redrill

I, the undersigned, hereby certify that this map is correct to the best of my knowledge and belief and shows all the information required by paragraph 6 of the rules and regulations of the oil and gas section of the mining laws of West Virginia.

*Chet Waterman*

Company W.C. STALNAKER  
 Address CHARLESTON, W. VA.  
 Farm L.E. STEPHENS  
 Tract Acres 105 <sup>of 170</sup> Lease No. \_\_\_\_\_  
 Well (Farm) No. 1 Serial No. \_\_\_\_\_  
 Elevation (Spirit Level) 775'  
 Quadrangle RAVENSWOOD EC  
 County JACKSON District UNION  
 Engineer CHET WATERMAN  
 Engineer's Registration No. 3788  
 File No. 70003-471 Drawing No. \_\_\_\_\_  
 Date 12/8/70 Scale 1" = 30P

STATE OF WEST VIRGINIA  
 DEPARTMENT OF MINES  
 OIL AND GAS DIVISION  
 CHARLESTON

WELL LOCATION MAP  
 FILE NO. Jac 1268

+ Denotes location of well on United States Topographic Maps, scale 1 to 62,500, latitude and longitude lines being represented by border lines as shown.

--- Denotes one inch squares on border line of original tracing.

*WO 66 Ridley 311 Deep well (Working) APR 5 1971*

RECEIVED

JUN 15 1971



STATE OF WEST VIRGINIA  
DEPARTMENT OF MINES  
OIL AND GAS WELLS DIVISION

OIL & GAS DIVISION  
DEPT. OF MINES

- Spudder
- Cable Tools
- Storage
- E. HOLL

Quadrangle... Ravenswood  
Permit No. Jac - 1268

WELL RECORD

Oil or Gas Well Gas (KIND)

Company W. C. Stalnaker  
 Address Charleston, W. Va.  
 Farm L. E. Stephens Acres 105  
 Location (waters) Loglick Run  
 Well No. 1 Elev. K.B. 789  
 District Union County Jackson  
 The surface of tract is owned in fee by Same  
 Mineral rights are owned by \_\_\_\_\_  
 Drilling commenced 3-26-71  
 Drilling completed 4-22-71  
 Date Shot \_\_\_\_\_ From \_\_\_\_\_ To \_\_\_\_\_

Casing and Tubing	Used in Drilling	Left in Well	Packers
Size			Kind of Packer
16			
13	150	150	
10			Size of
<u>9 5/8"</u>	2339	2339	Depth set
6 3/4	5250	5250	
5 3/16			Perf. top
4 1/2			Perf. bottom
3	5271	5271	Perf. top
2			Perf. bottom
Liners Used			

Open Flow \_\_\_\_\_ /10ths Water in \_\_\_\_\_ Inch  
 \_\_\_\_\_ /10ths Merc. in \_\_\_\_\_ Inch  
 Volume Est. 7-8 MM 7,000,000 Cu. Ft.  
 Rock Pressure \_\_\_\_\_ lbs. \_\_\_\_\_ hrs.  
 Oil \_\_\_\_\_ bbls., 1st 24 hrs.

Attach copy of cementing record.  
 CASING CEMENTED \_\_\_\_\_ SIZE \_\_\_\_\_ No. Ft. \_\_\_\_\_ Date \_\_\_\_\_  
 Amount of cement used (bags) \_\_\_\_\_  
 Name of Service Co. \_\_\_\_\_  
 COAL WAS ENCOUNTERED AT \_\_\_\_\_ FEET \_\_\_\_\_ INCHES  
 \_\_\_\_\_ FEET \_\_\_\_\_ INCHES  
 \_\_\_\_\_ FEET \_\_\_\_\_ INCHES

WELL ACIDIZED (DETAILS) \_\_\_\_\_  
 WELL FRACTURED (DETAILS) 4-26-71 30,000# 20/40, 500 gal. MA 816 bbls. H<sub>2</sub>O  
 RESULT AFTER TREATMENT (Initial open Flow or bbls.) \_\_\_\_\_  
 ROCK PRESSURE AFTER TREATMENT \_\_\_\_\_ HOURS \_\_\_\_\_  
 Fresh Water \_\_\_\_\_ Feet \_\_\_\_\_  
 Producing Sand Newburg Depth \_\_\_\_\_

7,000 MCF GPD  
 Salt Water 1" stream Feet 698'

Formation	Color	Hard or Soft	Top	Bottom	Oil, Gas or Water	Depth	Remarks
Rig			0	14			
Slate & Red Rock			14	230			
Sand			230	255			
Red Rock			255	330			
Slate & Red Rock			330	555			
Sand - <u>1 1/2" P.H.S?</u>			555	595			
Red Rock, slate & shells			595	1075			
Sand			1075	1165			
Slate & shells			1165	1245			
Sand			1245	1280			
Slate			1280	1330			
Sand			1330	1425			
Slate & Shells			1425	1675			
Big Lime } <u>340</u>			1675	1825			
Slate			1825	1855			
Anjun			1855	1982			
Slate & shells			1982	2295			
Coffee Shale			2295	2310			
Berea			2310	2315			

(over)

JUN 28 1971

Formation	Color	Hard or Soft	Top	Bottom	Oil, Gas or Water	Depth Found	Remarks
Slate & shells			2315	2675			
White slate & shells			2675	3470			
Brown shale - 4A1			3470	3590			
Slate & shells			3590	3740			
Brown shale			3740	3970			
White slate			3970	4355			
Brown shale			4355	4493			
Corniferous - 463			4493	4579			
Oriskany			4579	4601			
Helderberg			4601	4780			
Salina			4780	5246			
Williamsport	Sandy shale		5246				
Newburg Sand	intermed		<del>5267</del>	<del>5273</del>	5278-E		
<del>McKenzie</del>			<del>5278</del>				
TOTAL DEPTH			5298	545	Log MCKZ		
			Csg.	Cem.			
	13"	3-28	150	140 sks.	Well Service		
	9 5/8"	4-14	2330	550 sks.	Dowell		
	7"	4-20	5250	100 sks.	Dowell		

Date \_\_\_\_\_, 19\_\_

APPROVED \_\_\_\_\_, Owner

By \_\_\_\_\_ (Title)