

5.10 M.I.S.  
8.91 M.I.W.

Longitude 81° 40'

HUGHES - NUZUM  
104 ACRES

YOUNG

EI. 852'

N 131° 48' E  
300'

NUZUM

ACCURACY: 1" = 200'

Source of Elevation PIKE @ DRIVE (747)

I, the undersigned, hereby certify that this map is correct to the best of my knowledge and belief and shows all the information required by paragraph 6 of the rules and regulations of the oil and gas section of the mining laws of West Virginia.

- New Location
- Drill Deeper
- Abandonment
- Fracture
- Redrill

8-2-1-74

*Chet Waterman*

Company NATIONAL PETROLEUM CORP  
 Address COLUMBUS, OHIO  
 Farm HUGHES - NUZUM  
 Tract \_\_\_\_\_ Acres 104 Lease No. \_\_\_\_\_  
 Well (Farm) No. 2 Serial No. \_\_\_\_\_  
 Elevation (Spirit Level) 852  
 Quadrangle RIPLEY NW  
 County JACKSON District RAVENSWOOD  
 Engineer CHET WATERMAN  
 Engineer's Registration No. 3788  
 File No. 21003-17 Drawing No. \_\_\_\_\_  
 Date 1/24/71 Scale 1" = 300'

STATE OF WEST VIRGINIA  
DEPARTMENT OF MINES  
OIL AND GAS DIVISION  
CHARLESTON

WELL LOCATION MAP  
FILE NO. WAC-1261-P

+ Denotes location of well on United States Topographic Maps, scale 1 to 62,500, latitude and longitude lines being represented by border lines as shown.

-- Denotes one inch spaces on border line of original tracing.

*Deep Well*

FEB 27 1974

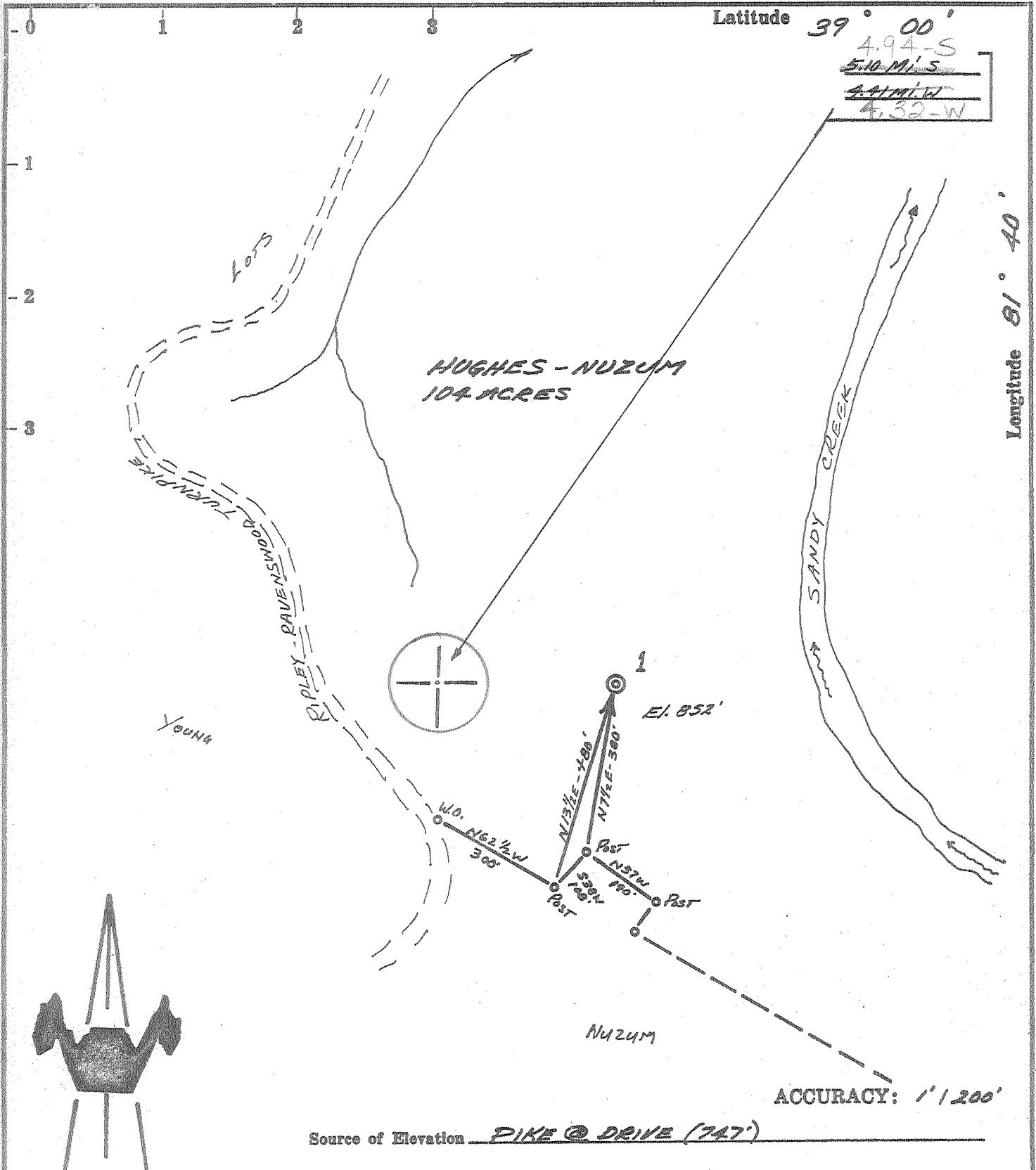

Source of Elevation PIKE @ DRIVE (747')

- New Location
- Drill Deeper
- Abandonment
- Fracture
- Redrill

I, the undersigned, hereby certify that this map is correct to the best of my knowledge and belief and shows all the information required by paragraph 6 of the rules and regulations of the oil and gas section of the mining laws of West Virginia.

*Chet Waterman*

Company	<u>NATIONAL PETROLEUM CORP.</u>		
Address	<u>COLUMBUS, OHIO</u>		
Farm	<u>HUGHES - NUZUM</u>		
Tract	Acres	Lease No.	
	<u>104</u>		
Well (Farm) No.	<u>1</u>	Serial No.	
Elevation (Spirit Level)	<u>852</u>		
Quadrangle	<u>RIPLEY NW</u>		
County	<u>JACKSON</u>	District	<u>RAVENSWOOD</u>
Engineer	<u>CHET WATERMAN</u>		
Engineer's Registration No.	<u>3788</u>		
File No.	<u>71003-17</u>	Drawing No.	
Date	<u>1/24/71</u>	Scale	<u>1" = 300'</u>

STATE OF WEST VIRGINIA  
DEPARTMENT OF MINES  
OIL AND GAS DIVISION  
CHARLESTON

WELL LOCATION MAP  
FILE NO. JAC-1261

+ Denotes location of well on United States Topographic Maps, scale 1 to 62,500, latitude and longitude lines being represented by border lines as shown.

— Denotes one inch spaces on border line of original tracing.



IVED

DEC 3 1971 Rotary

STATE OF WEST VIRGINIA  
DEPARTMENT OF MINES & GEOLOGICAL SURVEY  
OIL AND GAS WELLS DIVISION

Spudder   
Cable Tools   
Storage

Quadrangle Ripley  
Permit No. JAC 1261

WELL RECORD

Oil or Gas Well Gas  
(KIND)

Company National Petroleum Corporation  
Address 6161 Busch, Columbus, Ohio 43229  
Farm Hughes-Nuzum Acres 104  
Location (waters) Ohio River  
Well No. One Elev. 852  
District Ravenswood County Jackson  
The surface of tract is owned in fee by Philip Hughes,  
S.W. Nuzum Address Ravenswood, W. Va.  
Mineral rights are owned by Same  
Address \_\_\_\_\_  
Drilling commenced 1-30-71  
Drilling completed 2-15-71  
Date Shot \_\_\_\_\_ From \_\_\_\_\_ To \_\_\_\_\_  
With \_\_\_\_\_

Casing and Tubing	Used in Drilling	Left in Well	Packers
Size			Kind of Packer
16 3/8	363'	363'	
10 3/8	2064	2064	Size of
6 1/2	5300	5300	Depth set
5 1/2			Perf. top
4 1/2			Perf. bottom
3			Perf. top
2			Perf. bottom
Liners Used			

Open Flow 10ths Water in \_\_\_\_\_ Inch  
10ths Merc. in \_\_\_\_\_ Inch  
Volume 20,000,000 Cu. Ft.  
Rock Pressure 1400 lbs. 24 hrs.  
Oil \_\_\_\_\_ bbls., 1st 24 hrs.

Attach copy of cementing record.  
CASING CEMENTED \_\_\_\_\_ SIZE \_\_\_\_\_ No. Ft. \_\_\_\_\_ Date \_\_\_\_\_  
Amount of cement used (bags) \_\_\_\_\_  
Name of Service Co. \_\_\_\_\_  
COAL WAS ENCOUNTERED AT \_\_\_\_\_ FEET \_\_\_\_\_ INCHES  
\_\_\_\_\_ FEET \_\_\_\_\_ INCHES \_\_\_\_\_ FEET \_\_\_\_\_ INCHES  
\_\_\_\_\_ FEET \_\_\_\_\_ INCHES \_\_\_\_\_ FEET \_\_\_\_\_ INCHES

WELL ACIDIZED (DETAILS) \_\_\_\_\_  
WELL FRACTURED (DETAILS) 770 bbl. treated water, 18,500 lbs. 20-40 sand

RESULT AFTER TREATMENT (Initial open flow or bbls.) 40,000,000  
ROCK PRESSURE AFTER TREATMENT \_\_\_\_\_ HOURS 24  
Fresh Water 228 Feet \_\_\_\_\_ Salt Water 956 Feet \_\_\_\_\_  
Producing Sand Newburg Depth 5332'

Formation	Color	Hard or Soft	Top	Bottom	Oil, Gas or Water	Depth	Remarks
ALL MEASUREMENTS FROM 867' KB ELEV.							
Clay & Shells			0	94			
Sand			94	103			
Slate & Shells			103	1121			
Sand			1121	1145			
Slate & Shells			1145	1544			
Sand			1544	1580			
Slate & Shells			1580	1695			
Lime - <u>Big Lime</u>			1695	1845			
Sandy Lime			1845	1935			
Sand			1935	1974			
Shale & Shells			1974	2332			
Sand - <u>Berea</u>			2332	2337			
Shale			2337	4550			
Corniferous	<u>463</u>		4550	4640			
Oriskany			4640	4645			
Lime, Dolomite	<u>HEWERBERG</u>		4645	5332			
& Anhydrite	<u>SALINA</u>		5332	5344			
Newburg			5344	5359			
Dolomite	<u>McKenzie</u>						
ALL CEMENTING BY HALLIBURTON							
			13 3/8	with 100 sacks		2-1-71	
			8 5/8	with 400 sacks		2-6-71	
			5 1/2"	with 165 sacks		2-11-71	

*Page top and bottom from P1 card.*

T.D. 545