

1/12/70 CEN

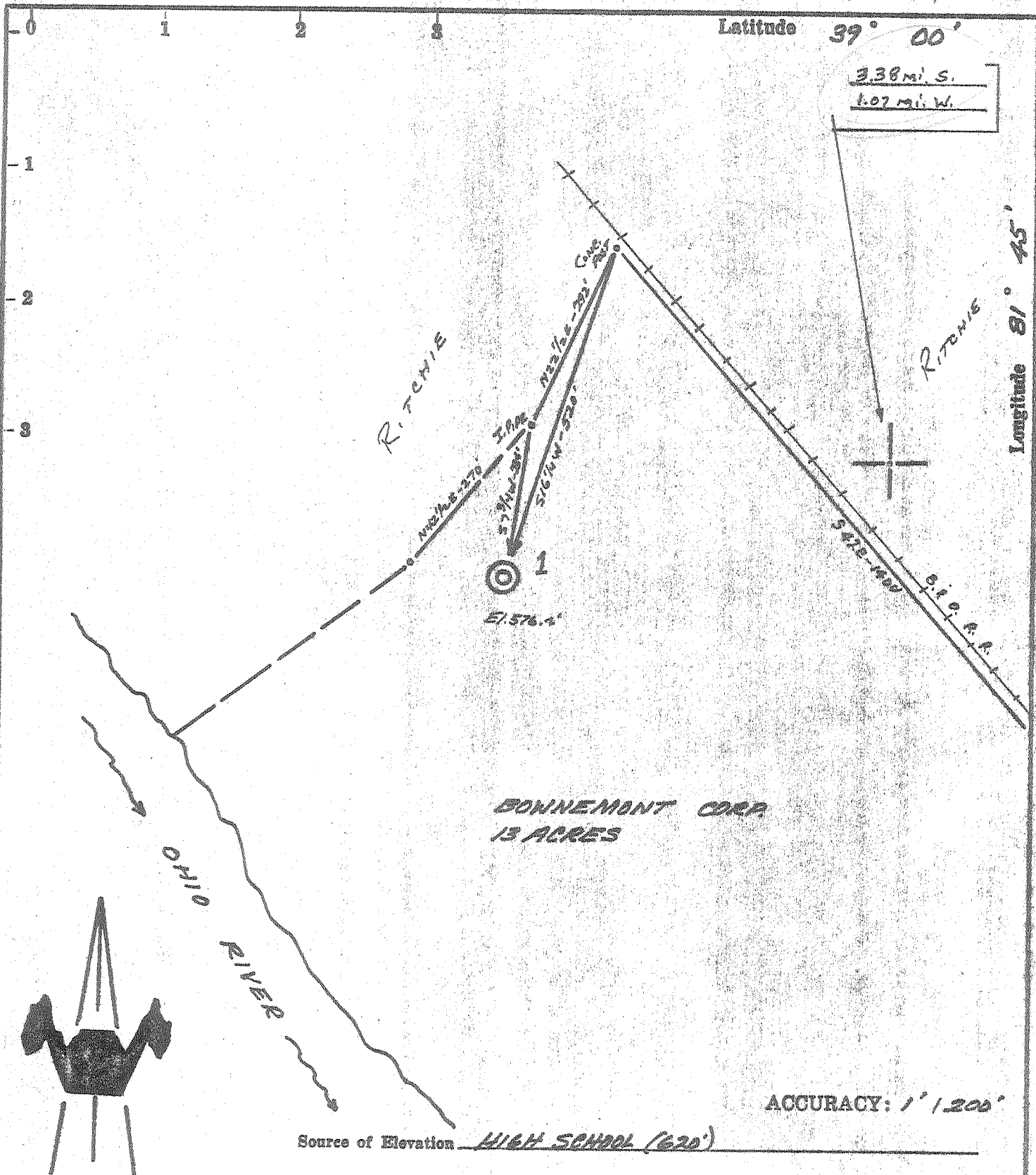

- New Location  **REVISED 1/8/70**
- Drill Deeper
- Abandonment  **Issued 5-26-71**
- Fracture
- Redrill

I, the undersigned, hereby certify that this map is correct to the best of my knowledge and belief and shows all the information required by paragraph 6 of the rules and regulations of the oil and gas section of the mining laws of West Virginia.

*Chet Waterman*

Company	<u>R. &amp; S. GAS &amp; OIL</u>
Address	<u>CHARLESTON, W.VA.</u>
Farm	<u>BONNEMONT CORP.</u>
Tract	Acres <u>13</u> Lease No. _____
Well (Farm) No.	<u>2</u> Serial No. _____
Elevation (Spirit Level)	<u>576.4'</u>
Quadrangle	<u>RAVENSWOOD</u> <u>NE</u>
County	<u>JACKSON</u> District <u>RAVENSWOOD</u>
Engineer	<u>CHET WATERMAN</u>
Engineer's Registration No.	<u>3788</u>
File No.	<u>70003-16</u> Drawing No. _____
Date	<u>1/8/70</u> Scale <u>1" = 200'</u>

STATE OF WEST VIRGINIA  
DEPARTMENT OF MINES  
OIL AND GAS DIVISION  
CHARLESTON

**WELL LOCATION MAP**

FILE NO. JAC-1182 REVISED-8

+ Denotes location of well on United States Topographic Maps, scale 1 to 62,500, latitude and longitude lines being represented by border lines as shown.

— Denotes one inch spaces on border line of original tracing.

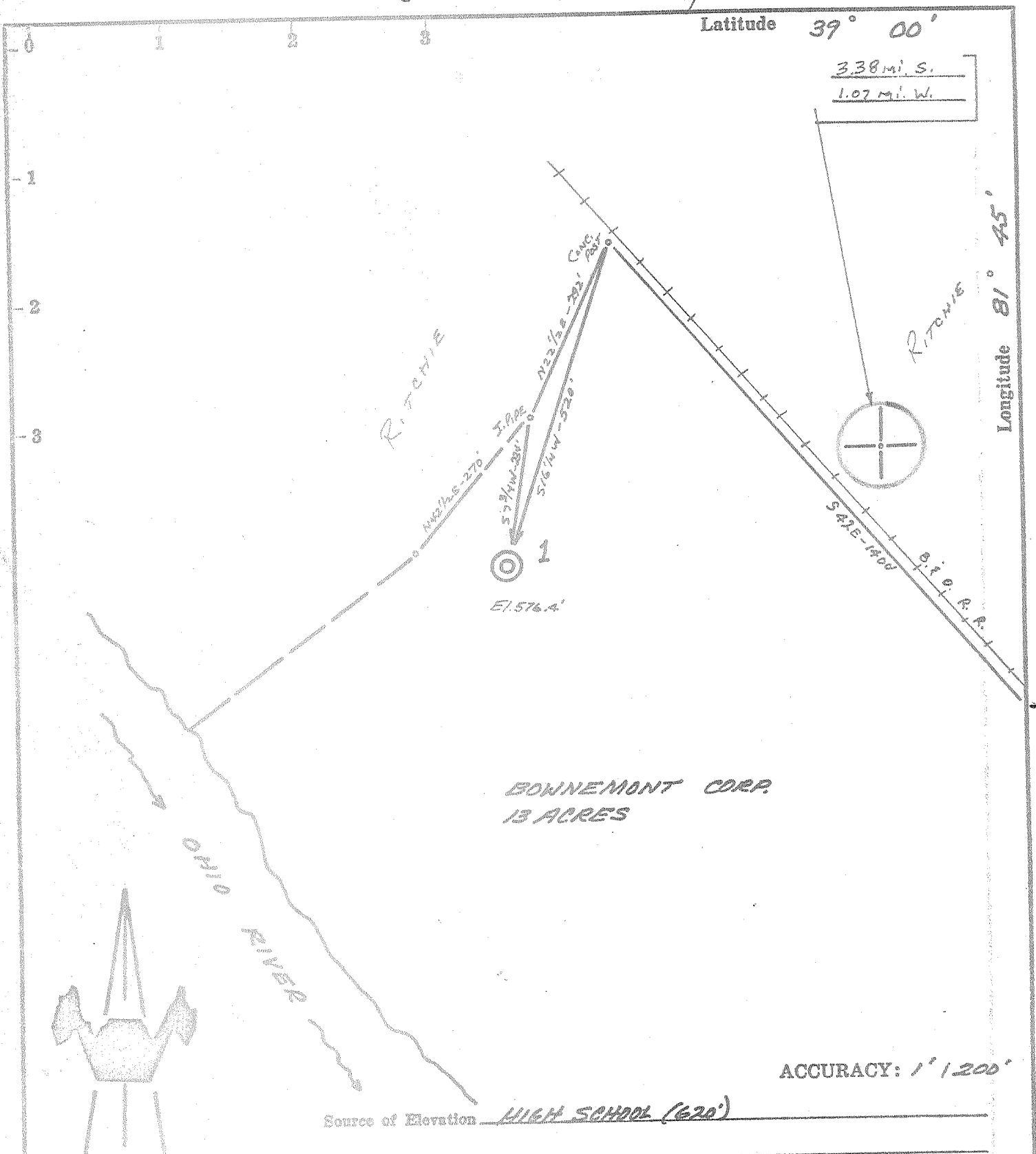

- New Location  **REVISED 1/8/70**
- Drill Deeper
- Abandonment
- Fracture
- Redrill

I, the undersigned, hereby certify that this map is correct to the best of my knowledge and belief and shows all the information required by paragraph 6 of the rules and regulations of the oil and gas section of the mining laws of West Virginia.

*Chet Waterman*

Company	<u>R. S. S. GAS &amp; OIL</u>
Address	<u>CHARLESTON, W.VA.</u>
Farm	<u>BANNEMONT CORP.</u>
Tract	Acres <u>13</u> Lease No. _____
Well (Farm) No.	<u>1</u> Serial No. _____
Elevation (Spirit Level)	<u>576.4'</u>
Quadrangle	<u>RAVENSWOOD NE</u>
County	<u>JACKSON</u> District <u>RAVENSWOOD</u>
Engineer	<u>CHET WATERMAN</u>
Engineer's Registration No.	<u>3788</u>
File No.	<u>22023-16</u> Drawing No. _____
Date	<u>1/9/70</u> Scale <u>1" = 200'</u>

STATE OF WEST VIRGINIA  
 DEPARTMENT OF MINES  
 OIL AND GAS DIVISION  
 CHARLESTON

**WELL LOCATION MAP**  
 FILE NO. JAC-1187 REVISED

+ Denotes location of well on United States Topographic Maps, scale 1 to 62,500, latitude and longitude lines being represented by border lines as shown.

— Denotes one inch spaces on border line of original tracing.

12/16/69 CEM

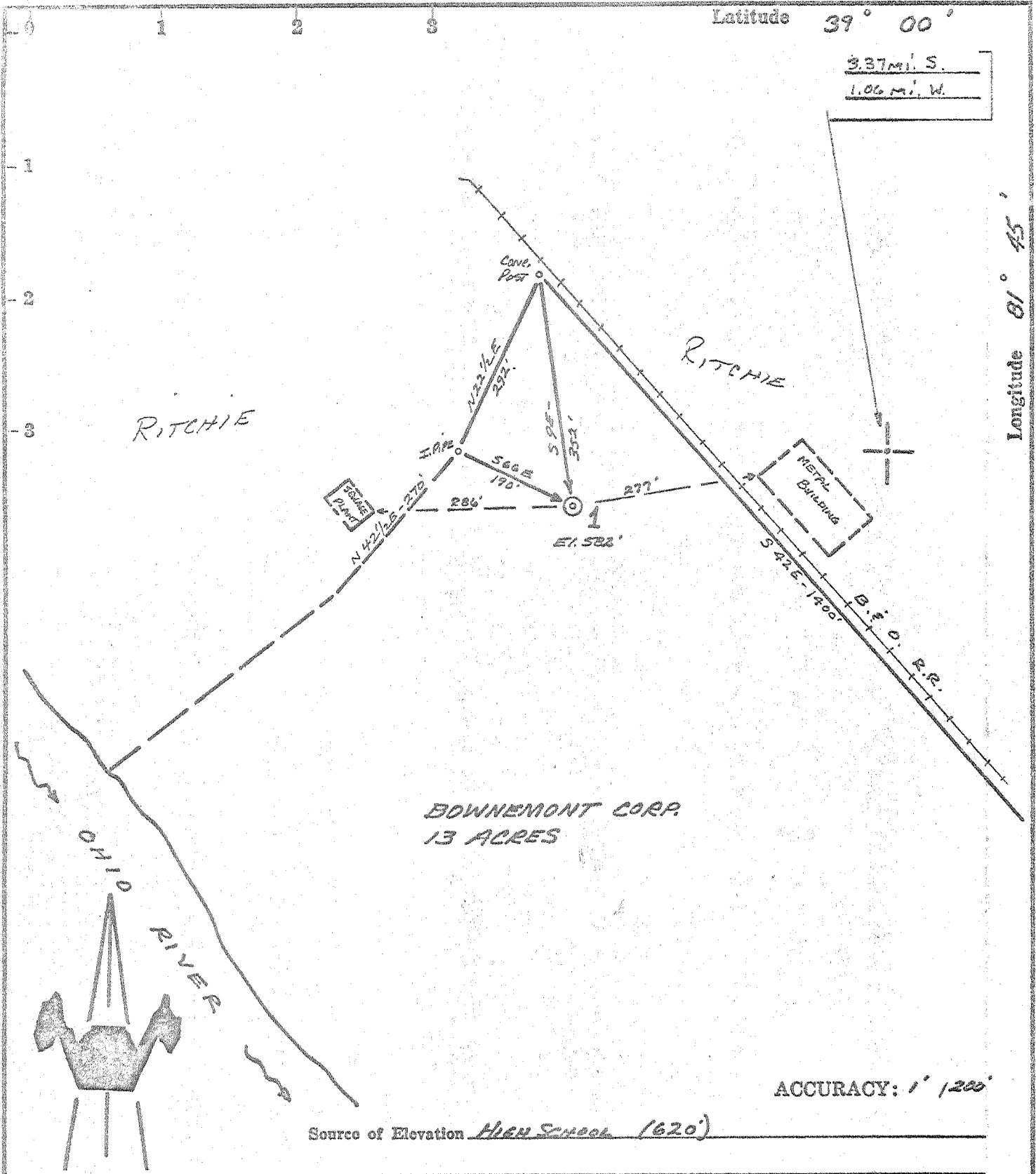

- New Location
- Drill Deeper
- Abandonment
- Fracture
- Redrill

I, the undersigned, hereby certify that this map is correct to the best of my knowledge and belief and shows all the information required by paragraph 6 of the rules and regulations of the oil and gas section of the mining laws of West Virginia.

*Chas Waterman*

Company R. E. S. GAS & OIL  
 Address CHARLESTON, W.VA.  
 Farm BOWNMONT CORP.  
 Tract \_\_\_\_\_ Acres 13 Lease No. \_\_\_\_\_  
 Well (Farm) No. 2 Serial No. \_\_\_\_\_  
 Elevation (Spirit Level) 582.  
 Quadrangle RAVENSWOOD NE  
 County JACKSON District RAVENSWOOD  
 Engineer CHAS WATERMAN  
 Engineer's Registration No. 3788  
 File No. 65223-422 Drawing No. \_\_\_\_\_  
 Date 12/13/69 Scale 1" = 200'

STATE OF WEST VIRGINIA  
 DEPARTMENT OF MINES  
 OIL AND GAS DIVISION  
 CHARLESTON

WELL LOCATION MAP  
 FILE NO. JAG-1187

+ Denotes location of well on United States Topographic Maps, scale 1 to 62,500, latitude and longitude lines being represented by border lines as shown.

— Denotes one inch spaces on border line of original tracing.

*Deep Well (Newburg)*  
 JAN 02 1970

RECEIVED

JAN 7 1971



STATE OF WEST VIRGINIA  
DEPARTMENT OF MINES  
OIL AND GAS DIVISION 7

OIL & GAS DIVISION  
DEPT. ROTARY LINE

- Rotary
- Spudder
- Cable Tools
- Storage

F. NOLL

Oil or Gas Well Gas  
(KIND)

WELL RECORD

39-00  
3-34

Form OG-10

Quadrangle Ravenswood  
Permit No. Jac - 1187

Company R & S Gas and Oil  
 Address Charleston, W. Va.  
 Farm Bownemont Corp. Acres 13  
 Location (waters) Ohio River  
 Well No. 1 Elev. 590' KB  
 District Ravenswood County Jackson  
 The surface of tract is owned in fee by \_\_\_\_\_  
 Address \_\_\_\_\_  
 Mineral rights are owned by \_\_\_\_\_  
 Address \_\_\_\_\_  
 Drilling commenced 1-11-70  
 Drilling completed 1-24-70  
 Date Shot \_\_\_\_\_ From \_\_\_\_\_ To \_\_\_\_\_  
 With \_\_\_\_\_  
 Open Flow \_\_\_\_\_ /10ths Water in \_\_\_\_\_ Inch  
 \_\_\_\_\_ /10ths Merc. in \_\_\_\_\_ Inch  
 Volume \_\_\_\_\_ Cu. Ft.  
 Rock Pressure \_\_\_\_\_ lbs. \_\_\_\_\_ hrs.  
 Oil \_\_\_\_\_ bbls., 1st 24 hrs.  
 WELL ACIDIZED (DETAILS) \_\_\_\_\_  
 WELL FRACTURED (DETAILS) 1-28-70 500 gal MA 20,000# 20/40 sd.

Casing and Tubing	Used in Drilling	Left in Well	Packers
Size			Kind of Packer
16			
13			Size of
<u>10 11 3/4</u>	<u>101</u>	<u>101</u>	Depth set
<u>8 5/8"</u>	<u>1610</u>	<u>1610</u>	
<u>6 5/8"</u>			
<u>5 3/16 5 1/2"</u>	<u>4910</u>	<u>4910</u>	
<u>4 1/2</u>			
<u>3</u>		<u>4938</u>	Perf. top
<u>2</u>			Perf. bottom
Liners Used			Perf. top
			Perf. bottom

Attach copy of cementing record.  
 CASING CEMENTED \_\_\_\_\_ SIZE \_\_\_\_\_ No. Ft. \_\_\_\_\_ Date \_\_\_\_\_  
 Amount of cement used (bags) See other side  
 Name of Service Co. \_\_\_\_\_  
 COAL WAS ENCOUNTERED AT \_\_\_\_\_ FEET \_\_\_\_\_ INCHES  
 \_\_\_\_\_ FEET \_\_\_\_\_ INCHES FEET \_\_\_\_\_ INCHES  
 \_\_\_\_\_ FEET \_\_\_\_\_ INCHES FEET \_\_\_\_\_ INCHES

RESULT AFTER TREATMENT (Initial open Flow or bbls.) Est. 3MM 3,000 MCF GPD 3,000,000  
 ROCK PRESSURE AFTER TREATMENT \_\_\_\_\_ HOURS \_\_\_\_\_  
 Fresh Water \_\_\_\_\_ Feet \_\_\_\_\_ Salt Water \_\_\_\_\_ Feet \_\_\_\_\_  
 Producing Sand Newburg Depth \_\_\_\_\_

Formation	Color	Hard or Soft	Top	Bottom	Oil, Gas or Water	Depth	Remarks
Sand & Gravel			0	30			
River Rock			30	67			
Sandstone			67	69			
Red Rock			69	112			
Sand & Shale			112	223			
Dark sand & shale			223	300			
Sand white - <u>1st Rte?</u>			300	475			
Red Rock			475	505			
Sand			505	555			
Shale & Red Rock			555	605			
Shale & Lime Stringers			605	755			
Sand			755	867			
Grey Shale & Red Rock			867	905			
Sand White - <u>Big Dark?</u>			905	970			
Grey Shale & Red Rock			970	1085			
Salt Sand - <u>?</u>			1085	1270			
Slate			1270	1340			
Grey Shale			1340	1400			
					(over)		

JAN 18 1971

Formation	Color	Hard or Soft	Top	Bottom	Oil, Gas or Water	Depth Found	Remarks
Sand			1400	1445			
Big Lime			1445	1475			
Injun			1475	1560			
Sandy Shale			1560	1825			
Shale			1825	4170			
Onon. * 463		Here too great	4170	4680			
Lime & Dolomite		Slime	4680	4942			
Newburg			4942	4952			
Lime & Shale		McKenzie	4952				
			545				
			TOTAL DEPTH			4960	
	1-13-70	11 3/4"	101'	50 sks	Lawson		
	1-17-70	8 5/8"	1610'	300 sks.	Dowell		
	1-22-70	5 1/2"	4910'	150 sks.	Dowell		

Date 12-29- 1970

APPROVED R & S Gas and Oil, Inc. Owner

By Gene Haney, Cons. Geol. (Title)