

Drill Deeper
 Redrill
 Abandonment

SOURCE OF ELEVATION **BM 926**
 "I, the undersigned, hereby certify that this map is correct to the best of my knowledge and belief and shows all the information required by paragraph 6 of the rules and regulations of the oil and gas section of the mining laws of West Virginia."
1-30-69

Company STOVESTREET LANDS CO
 Address Kanawha Valley Bank Bldg
CHARLESTON, W.VA.
 Farm FRANK A. HARDY ETAL
 Tract _____ Acres 250 1/2 Lease No. _____
 Well (Farm) No. 1 Serial No. _____
 Elevation (Spirit Level) 948.72
 Quadrangle KENNA WC
 County JACKSON District RIPLEY
 Engineer [Signature]
 Engineer's Registration No. 1530
 File No. S-407 Drawing No. 5
 Date Dec 19, 1968 Scale SCALE 1" = 2000'

STATE OF WEST VIRGINIA
 DEPARTMENT OF MINES
 OIL AND GAS DIVISION
 CHARLESTON
WELL LOCATION MAP
 FILE NO. Jac-1167-P
 + Denotes location of well on United States Topographic Maps, scale 1 to 62,500, latitude and longitude lines being represented by border lines as shown.
 - Denotes one inch spaces on border line of original tracing.

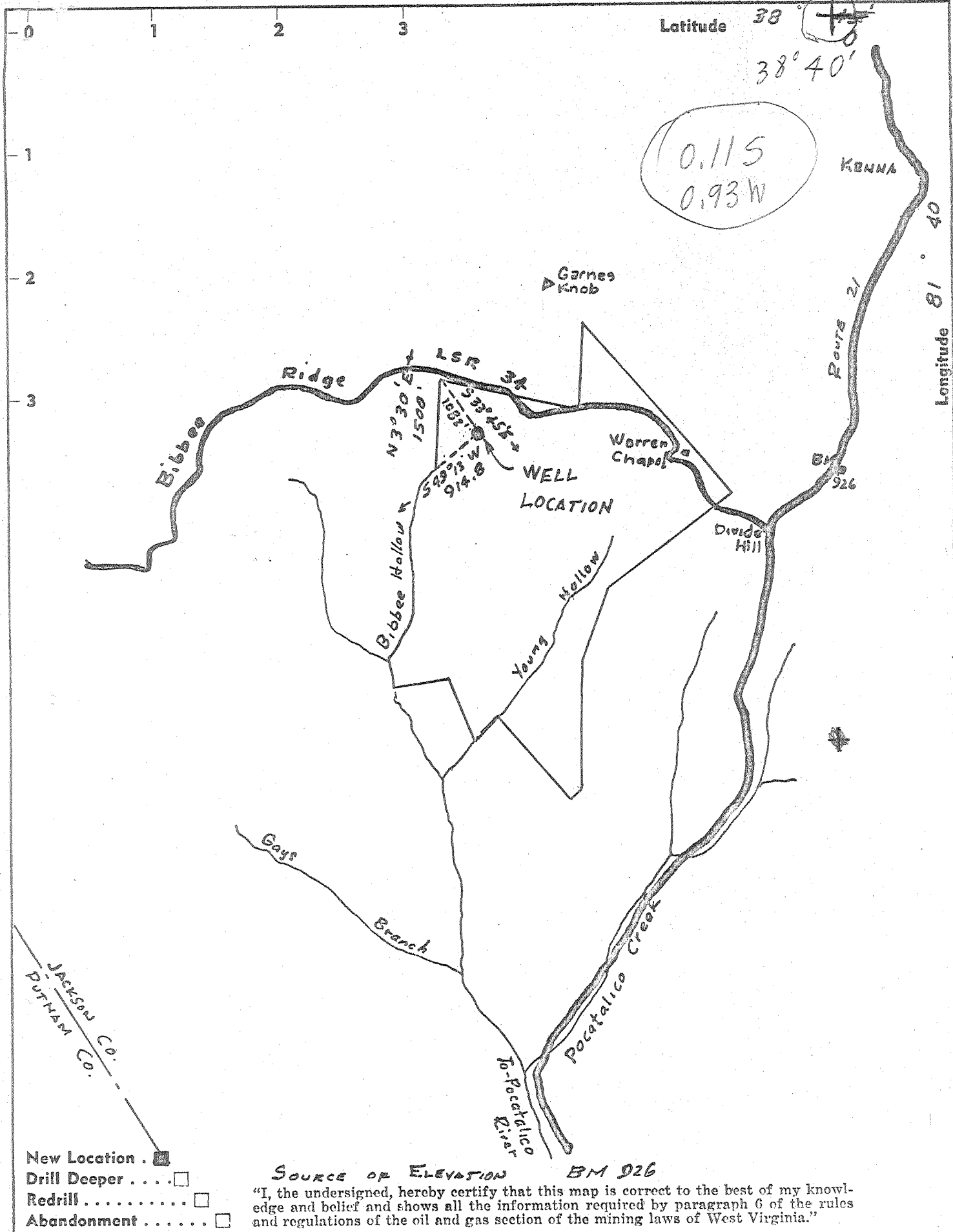

- New Location .
- Drill Deeper
- Redrill
- Abandonment

SOURCE OF ELEVATION BM 926
 "I, the undersigned, hereby certify that this map is correct to the best of my knowledge and belief and shows all the information required by paragraph 6 of the rules and regulations of the oil and gas section of the mining laws of West Virginia."

Company STOURSTREET LANDS Co
 Address Kanawha Valley Bank Bldg
CHARLESTON, W. VA.
 Farm FRANK A. HARRY ETAL
 Tract _____ Acres 250 Unit _____ Lease No. _____
 Well (Farm) No. 1 Serial No. _____
 Elevation (Spirit Level) 948.72
 Quadrangle KENNA
 County JACKSON District RIPLEY
 Engineer [Signature]
 Engineer's Registration No. 1530
 File No. S-407 Drawing No. 5
 Date Dec 19, 1968 Scale SCALE 1"=2000'

STATE OF WEST VIRGINIA
 DEPARTMENT OF MINES
 OIL AND GAS DIVISION
 CHARLESTON

WELL LOCATION MAP
 FILE NO. JOC-1167

+ Denotes location of well on United States Topographic Maps, scale 1 to 62,500, latitude and longitude lines being represented by border lines as shown.
 - Denotes one inch spaces on border line of original tracing.

RECEIVED
OCT 28 1988

DIVISION OF OIL & GAS
DEPARTMENT OF ENERGY

1) Date: Sept. 15, 1988
2) Operator's well number Hardy No. 1
3) API Well No: 47 - 035 - 1167-RED-FRA
State - County - Permit

STATE OF WEST VIRGINIA
DEPARTMENT OF ENERGY, DIVISION OF OIL AND GAS

NOTICE AND APPLICATION FOR A WELL WORK PERMIT

- | | |
|--|---|
| <p>4) Surface Owner(s) to be served:</p> <p>(a) Name <u>Howard L. White</u> Address <u>866 Divide Ridge</u> <u>Kenna, WV 25248</u></p> <p>(b) Name _____ Address _____</p> <p>(c) Name _____ Address _____</p> | <p>5) (a) Coal Operator:</p> <p>Name <u>N/A</u> Address _____</p> <p>(b) Coal Owner(s) with Declaration</p> <p>Name <u>N/A</u> Address _____</p> <p>Name _____ Address _____</p> <p>(c) Coal Lessee with Declaration</p> <p>Name <u>N/A</u> Address _____</p> |
| <p>6) Inspector <u>Jerry Tephacock</u> Address <u>Rt. 1, Box 101-A</u> <u>Ripley, WV 25271</u> Telephone (304)-<u>372 - 6805</u></p> | |

TO THE PERSON(S) NAMED ABOVE TAKE NOTICE THAT:

___ Included is the lease or leases or other continuing contract or contracts by which I hold the right to extract oil and gas OR
x Included is the information required by Chapter 22B, Article 1, Section 8(d) of the Code of West Virginia (see page 2)

I certify that as required under Chapter 22B of the West Virginia Code I have served copies of this notice and application, a location plat, and accompanying documents pages 1 through 8 on the above named parties, by:
___ Personal Service (Affidavit attached)
x Certified Mail (Postmarked postal receipt attached)
___ Publication (Notice of Publication attached)

I have read and understand Chapter 22B and 38 CSR 11-18, and I agree to the terms and conditions of any permit issued under this application.

I certify under penalty of law that I have personally examined and am familiar with the information submitted on this application form and all attachments, and that based on my inquiry of those individuals immediately responsible for obtaining the information, I believe that the information is true, accurate, and complete.

I am aware that there are significant penalties for submitting false information, including the possibility of fine and imprisonment.

Well Operator Angerman Associates, Inc.
By: [Signature]
Its: President
Address 109 Zeta Dr.
Pittsburgh, PA 15238
Telephone (412) 963 - 0550

Subscribed and sworn before me this 15th day of Sept., 1988

Gregory A. Smith Notary Public
My commission expires 12/7/92

STATE OF WEST VIRGINIA
DEPARTMENT OF ENERGY, DIVISION OF OIL AND GAS
WELL WORK PERMIT APPLICATION

- 1) Well Operator: Angerman Associates, Inc. 2200, 3, 415
- 2) Operator's Well Number: Hardy No. 1 (47-035-1167-P) 3) Elevation: 948.72'
- 4) Well type: (a) Oil / or Gas /
(b) If Gas: Production / Underground Storage /
Deep / Shallow /
- 5) Proposed Target Formation(s): Alexander -04
- 6) Proposed Total Depth: 4700 feet
- 7) Approximate fresh water strata depths: 80'
- 8) Approximate salt water depths: 1600'
- 9) Approximate coal seam depths: N/A
- 10) Does land contain coal seams tributary to active mine? Yes / No /
- 11) Proposed Well Work: Redrill, Clean Out & Stimulate
- 12)

CASING AND TUBING PROGRAM

| TYPE | SPECIFICATIONS | | | FOOTAGE INTERVALS | | CEMENT |
|--------------|-------------------------------------|-------|----------------|-------------------|--------------|-------------------------------------|
| | Size | Grade | Weight per ft. | For drilling | Left in well | Fill-up (cu. ft.) |
| Conductor | | | | | | |
| Fresh Water | Existing - See Attached Well Record | | | | | |
| Coal | <u>11 3/4</u> | | | | <u>226'</u> | |
| Intermediate | <u>8 5/8</u> | | | | <u>225'</u> | |
| Production | <u>4 1/2"</u> | | | <u>4700'</u> | <u>4600'</u> | 200 SKS 50/50 POZ/ 38 CSR 18-11. |
| Tubing | | | | | | |
| Liners | | | | | | |

RECEIVED
OCT 28 1988

PACKERS : Kind _____
Sizes _____
Depths set _____

For Division of Oil and Gas Use Only

DIVISION OF OIL & GAS
DEPARTMENT OF ENERGY

Fee(s) paid: 36 Well Work Permit 50 Blanket Reclamation Fund 36 WPCP

Plat 36 WW-9 36 WW-2B 36 Bond 50 Blanket Agent 36

009962
36
36
36



STATE OF WEST VIRGINIA
DEPARTMENT OF MINES
OIL AND GAS DIVISION

Rotary
Spudder
Cable Tools
Storage

Dry
Oil or Gas Well Gas
(KIND)

Quadrangle Kenna
Permit No. JAC-1167

WELL RECORD

Company Stonestreet Lands Company
Address Box 350, Spencer, W. Va.
Farm Frank A. Hardy Acres 250
Location (waters) Poca River
Well No. 1 Elev. 948.72
District Ripley County Jackson
The surface of tract is owned in fee by _____
Address _____
Mineral rights are owned by Frank A. Hardy et al
Address _____
Drilling commenced Jan. 1, 1969
Drilling completed Jan. 30, 1969
Date Shot _____ From _____ To _____
With _____
Open Flow _____ /10ths Water in _____ Inch
_____ /10ths Merc. in _____ Inch
Volume _____ Cu. Ft.
Rock Pressure _____ lbs. _____ hrs.
Oil _____ bbls., 1st 24 hrs.
WELL ACIDIZED (DETAILS) _____
WELL FRACTURED (DETAILS) _____

| Casing and Tubing | Used in Drilling | Left in Well | Packers |
|----------------------|------------------|--------------|----------------|
| Size | | | Kind of Packer |
| 16 | | | |
| 13 | | | |
| 12 11 3/4 | 226 | 226 | Size of |
| 10 8 5/8 | 2257 | 2257 | Depth set |
| 6 5/8 | | | |
| 5 3/16 | | | |
| 4 1/2 | | | |
| 3 | | | Perf. top |
| 2 | | | Perf. bottom |
| Liners Used | | | Perf. top |
| | | | Perf. bottom |

Attach copy of cementing record. see attached records
CASING CEMENTED _____ SIZE _____ No. Ft. _____ Date _____
Amount of cement used (bags) _____
Name of Service Co. _____
COAL WAS ENCOUNTERED AT _____ FEET _____ INCHES
_____ FEET _____ INCHES _____ FEET _____ INCHES
_____ FEET _____ INCHES _____ FEET _____ INCHES

RESULT AFTER TREATMENT (Initial open Flow or bbls.) _____
ROCK PRESSURE AFTER TREATMENT _____ HOURS
Fresh Water _____ Feet 80 Salt Water _____ Feet 1600
Producing Sand _____ Depth _____

| Formation | Color | Hard or Soft | Top | Bottom | Oil, Gas or Water | Depth | Remarks |
|--------------------|-----------------|--------------|------|--------|-------------------|-------|---------|
| Red Rock and slate | | | 0 | 226 | Fresh water | 80 | |
| Shale | | | 226 | 260 | | | |
| Red Rock | | | 260 | 390 | | | |
| Sandy Shale | | | 390 | 480 | | | |
| Red Rock | | | 480 | 490 | | | |
| Shale | | | 490 | 625 | | | |
| Sandy Shale | | | 625 | 800 | | | |
| Shale | | | 800 | 945 | | | |
| Sandy Shale | | | 945 | 1000 | | | |
| Sand Broken | | | 1000 | 1900 | Salt water | 1600 | |
| Lime | | | 1900 | 2260 | | | |
| Shale | | | 2260 | 5160 | | | |
| Con. Lime | <i>-A63</i> | | 5160 | 5260 | | | |
| Oris. Sand | | | 5260 | 5280 | | | |
| Shale | <i>McKenzie</i> | | 5280 | 6150 | | | |
| TD | | | 6150 | | | | |

540

Note no sand rptd in Newburg interval

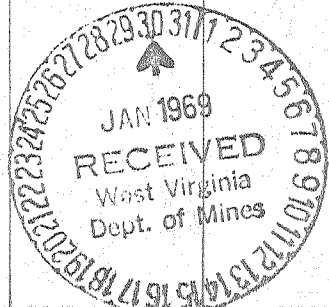

*6150
5280
870 expl. Sootage*