

- SOURCE ELEV. WELL NO. 1
- Drill Deeper
- Redrill
- Abandonment

SOURCE ELEV. WELL NO. 1

892.5

"I, the undersigned, hereby certify that this map is correct to the best of my knowledge and belief and shows all the information required by paragraph 6 of the rules and regulations of the oil and gas section of the mining laws of West Virginia."

Company EDISON J. PARSONS
 Address RIPLBY, W. VA
 Farm C. D. LATHNEY
 Tract 2 Acres 49.6 Lease No. _____
 Well (Farm) No. 2 Serial No. _____
 Elevation (Spirit Level) 871.59
 Quadrangle RAVENSWOOD SE
 County JACKSON District RIPLBY
 Engineer G. J. Dyer
 Engineer's Registration No. 804
 File No. _____ Drawing No. _____
 Date 4-17-67 Scale 1" = 300'

STATE OF WEST VIRGINIA
 DEPARTMENT OF MINES
 OIL AND GAS DIVISION
 CHARLESTON

WELL LOCATION MAP
 FILE NO. JAC 1139-P

+ Denotes location of well on United States Topographic Maps, scale 1 to 62,500, latitude and longitude lines being represented by border lines as shown.

— Denotes one inch spaces on border line of original tracing.

APR 16 1969

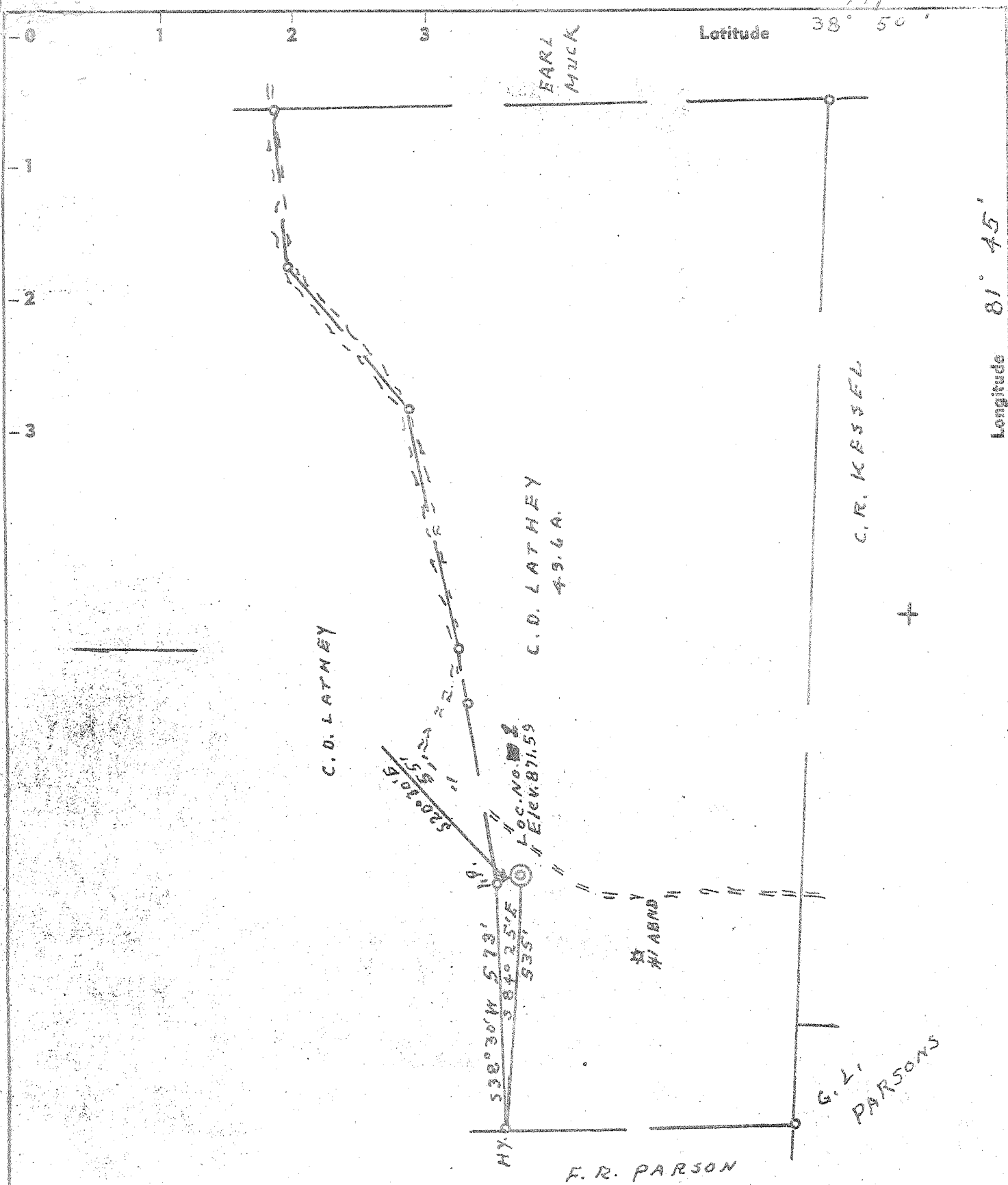

ACCURACY 1" IN 200
892.9

New Location SOURCE ELEV. WELL NO. 1
 Drill Deeper
 Redrill
 Abandonment "I, the undersigned, hereby certify that this map is correct to the best of my knowledge and belief and shows all the information required by paragraph 6 of the rules and regulations of the oil and gas section of the mining laws of West Virginia."

Company EDISON J. PARSONS
 Address RIPLEY, W. VA
 Farm C. D. LATHEY
 Tract 2 Acres 49.6 Lease No. _____
 Well (Farm) No. _____ Serial No. _____
 Elevation (Spirit Level) 871.59
 Quadrangle RAVENSWOOD - SE
 County JACKSON District RIPLEY
 Engineer L. J. Dye
 Engineer's Registration No. 804
 File No. _____ Drawing No. _____
 Date 4-17-67 Scale 1" = 300'

STATE OF WEST VIRGINIA
 DEPARTMENT OF MINES
 OIL AND GAS DIVISION
 CHARLESTON

WELL LOCATION MAP

FILE NO. JAC 1139
 Corrected Permit Number To Replaces Jac-1079 00

+ Denotes location of well on United States Topographic Maps, scale 1 to 62,500, latitude and longitude lines being represented by border lines as shown.

— Denotes one inch spaces on border line of original tracing.

MAY 10 1967

Newburg



STATE OF WEST VIRGINIA
DEPARTMENT OF MINES
OIL AND GAS DIVISION 4

Rotary
Spudder
Cable Tools
Storage

Quadrangle RAVENSWOOD
JAC-1139
Permit No. JAG-1039-Rev.

WELL RECORD
COMPLETION

Oil or Gas Well Gas
(KIND)

Company <u>Edison J. Parsons</u>	Casing and Tubing	Used in Drilling	Left in Well	Packers
Address <u>119 Highlawn Drive Ripley, W. Va.</u>	Size			
Farm <u>C. D. Lathey</u> Acres <u>49.6</u>	16			Kind of Packer
Location (waters) <u>Parchment Creek</u>	13			
Well No. <u>2</u> Elev. <u>895</u>	10	<u>21'</u>	<u>21 1/10'</u>	contractor
District <u>Ripley</u> County <u>W Jackson</u>	8 1/4			Lawson Gementi
The surface of tract is owned in fee by <u>C. D. Lathey</u>	6 3/4 <u>7"</u>	<u>2653'</u>	<u>2653 1/50'</u>	Depth set
Address <u>Ripley, W. Va.</u>	5 3/16			
Mineral rights are owned by <u>C. D. Lathey et al</u>	<u>4 1/2 - 11.6#</u>	<u>5108'</u>	<u>5108 1/100'</u>	Perf. top <u>4994</u>
Address <u>Ripley, West Va.</u>	3			Perf. bottom <u>5000</u>
Drilling commenced <u>April 21, 1967</u>	2	<u>5002'</u>	<u>5002'</u>	Perf. top
Drilling completed <u>May 8, 1967</u>	Liners Used			Perf. bottom
Date Shot From To				

Attach copy of cementing record.

Open Flow 20 /10ths Water in two Inch
/10ths Merc. in Inch

CASING CEMENTED see above No. Ft. Date

Amount of cement used (bags)

Volume Cu. Ft.

Rock Pressure lbs. hrs.

Name of Service Co.

Oil bbls., 1st 24 hrs.

WELL ACIDIZED (DETAILS)

COAL WAS ENCOUNTERED AT FEET INCHES

WELL FRACTURED (DETAILS) Dowell waterfrac. 18,000# sand, 464 Bbls. water, 1000 gal mud acid breakdown 2000#; treat 5100#, floback immediate, gas to surface 60 mins. hard blo. minutes well died - 2 inch run and swabbed well after few days (1,020 Mcf) increasing

RESULT AFTER TREATMENT (Initial open flow or bbls.)

ROCK PRESSURE AFTER TREATMENT 1000# increasing HOURS 24 hrs.

Fresh Water Feet Salt Water Feet

Producing Sand Oriskany Depth 4994-5000

Formation	Color	Hard or Soft	Top	Bottom	Oil, Gas or Water	Depth	Remarks
Clay	red	soft	0	26			
sand	light	hard	26	65			
red rock	red	soft	65	90			
sand stone	light	hard	90	135			
red rock	red	soft	135	182			
red rock	light	med					
slate & sand	to drk.	hd.	182	720			
sandy lse & blu sh.	lt. to med dk	med	720	1115			
slate & red rock		med	1115	1185			
slate	gry	med	1185	1220			
sand	light	hard	1220	1278			
shale	black	soft	1278	1281			
sandy lime	light	med	1281	1375			
silty shale	gry	med	1375	1740			
sand	light	med	1740	1755			
sand	light	med hd	1755	1800			
sandy lime	light	med	1800	1902			
sdy lse & sh.	light	med	1902	2115			
sand	light	med	2115	2130			
sandy shles	lt & drk	med	2130	2567			
sand	light	med	2567	2580			
sandy shles	lt & drk	med	2580	2660			
shale	drk	soft	2660	4899			
lime - 463	lt brn	med	4899	4994			
sand	light	med	4994	5000	Gas 475		
shale sdy	gry	med	5000	5022			
sand	light	med	5022	5032			

SAME AS JACK 1141

RECEIVED JUN 1967 West Virginia Dept. of Mines

Oriskany ss

(over)

JUN 20 1967

Formation	Color	Hard or Soft	Top	Bottom	Oil, Gas or Water	Depth Found	Remarks
andy limes	<i>Helderberg</i> lt & dk	med & sft	5032	5731			
shales	lt & dk	med	5731	5743			
sandshl	lt & dk	med	5743	5780	Newburg sand -		sand very fine
shaly dol	lt & dk	med	5743	5780	(dry)		total depth
<i>McKenzie</i>				<u>5745</u>			5780
<p><i>P.I. card shows gas @ 5023-32 total 360 MCF GPD</i></p>							
					5780		
					5032		
					<u>746</u>	-expl. ftg	

Date 6/9 1967

APPROVED *Edwin J. Sumner*, Owner

By *[Signature]* (Title)