

Redrill & Abandon - 11-20-73

- New Location
- Drill Deeper.....
- Abandonment.....

Company Carl E. Smith, Inc.

Address P.O. Box 4, Sandyville, W.Va. 25275

Formerly: W.M. KING (James M. Harper) Now: W.M. KING (James M. Harper)

Farm W.M. KING (James M. Harper)

Tract Acres 260 Lease No. _____

Well (Farm) No. ONE Serial No. _____

Elevation (Spirit Level) 604.4'

Quadrangle RAVENSWOOD S.E.

County JACKSON District RIPLEY

Engineer W.S. GRAVELY

Engineer's Registration No. _____

File No. _____ Drawing No. _____

Date APRIL 10, 1944 Scale 1" = 1320'

STATE OF WEST VIRGINIA
DEPARTMENT OF MINES
OIL AND GAS DIVISION
CHARLESTON

WELL LOCATION MAP
FILE NO. JAC-470-RED-P

+ Denotes location of well on United States Topographic Maps, scale 1 to 62,500, latitude and longitude lines being represented by border lines as shown.

- Denotes one inch spaces on border line of original tracing.

47 035

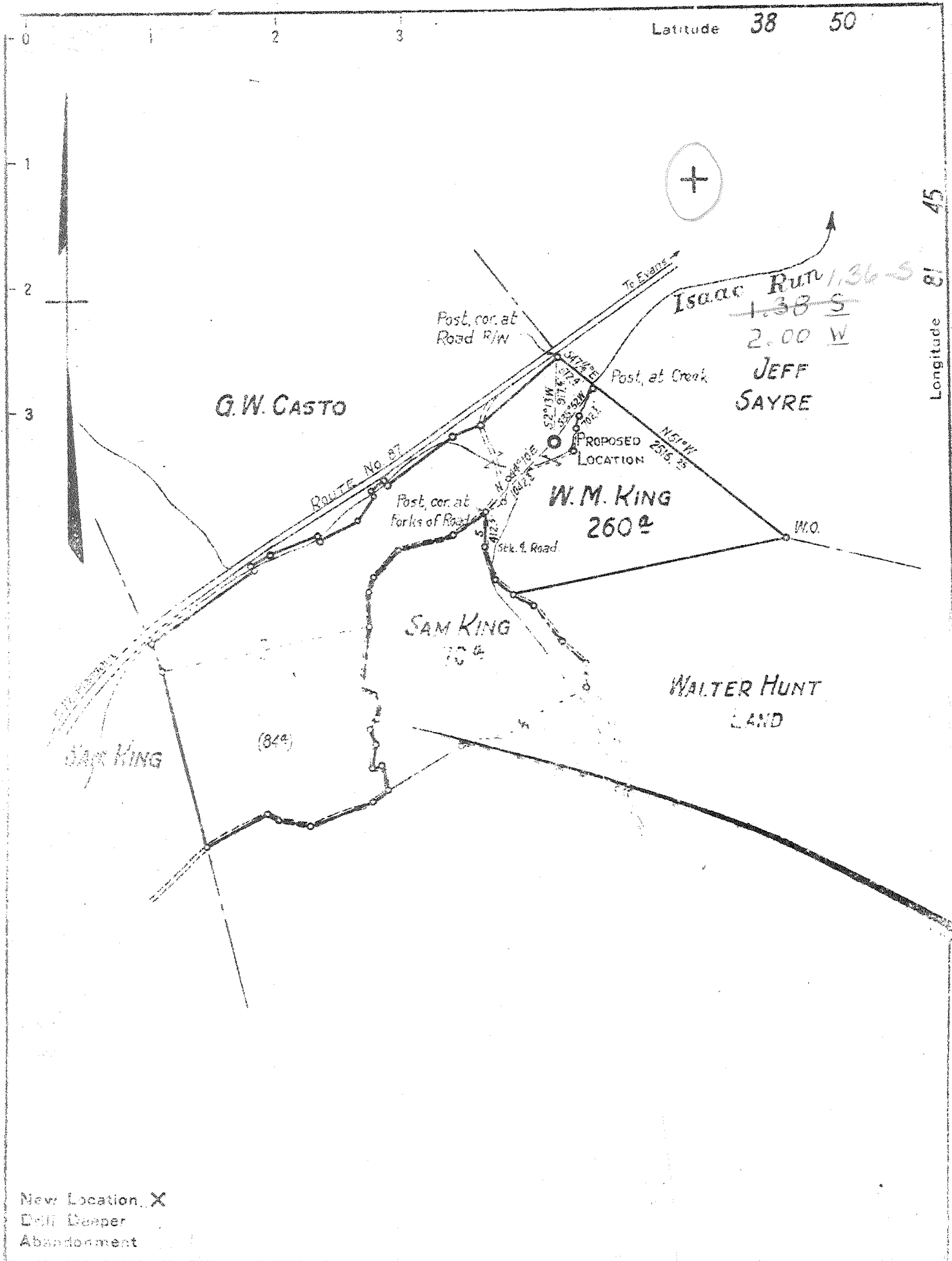

New Location X
 Drill Deeper
 Abandonment

Company HARLAN STAATS ET AL
 Address RIPLEY, W. VA.
 Farm W. M. KING
 Tract _____ Acres 260 Lease No. _____
 Well (Farm) No. ONE Serial No. _____
 Elevation (Spirit Level) 604.4'
 Quadrangle RAVENSWOOD-S.E.
 County JACKSON District RIPLEY
 Engineer W. S. GRAVELY
 Engineer's Registration No. _____
 File No. _____ Drawing No. _____
 Date APRIL 10, 1944 Scale 1" = 1320'

STATE OF WEST VIRGINIA
 DEPARTMENT OF MINES
 OIL AND GAS DIVISION
 CHARLESTON

WELL LOCATION MAP
 FILE NO. JAC-470

+ Denotes location of well on United States Topographic Maps, scale 1 to 62,500. latitude and longitude lines being represented by border lines as shown.

- Denotes one inch spaces on border of original tracing.

1-0-0

Deep Well

P

Longitude 91 45

WEST VIRGINIA DEPARTMENT OF MINES
OIL & GAS DIVISION
W E L L R E C O R D

Permit No. 470			
Ravenswood S.E. Quad.			Dry Hole
Company	E.H. Staats et al		CASING & TUBING
Address	Ripley, W.Va.	16	31 None
Farm	W.M. King Acres 260	13 1/2 OD	295
Location	Mill Creek	10 1/2 "	898
Well No.	1 Elev. 604 L	8 1/2	1665
District	Ripley Jackson County	6 5/8	1870
Surface	W.M. King, Evans, W.Va.		
Mineral	Same		Coal at 1090'
Commenced	July 10, 1944		
Completed	Nov. 15, 1944		
Not shot			
Open flow	2/10ths W in 1"		
Volume	15,000 C.F.		
Fresh Water	20', 95' H.F.W.; 990' 1 blr. pr. hr.		
Salt Water	1310' H.F.W.; 1760' HFV		
	2239' 1/4 blr.		

Soil	0	20	Oriskany Sand	4560	4591
Gravel	20	30	Lime - Held.	4591	
Red Rock	30	80	TOTAL DEPTH	4594	
Sand	80	130			
Blue Slate	130	152			
Sand	152	180			
Red Rock	180	295			
Blue Slate	295	332			
Red Rock	332	374			
Sand	374	410			
Red Rock	410	442			
Slate	442	457			
Pink Slate	457	465			
Grey Slate	465	482			
Sand	482	495			
Slate	495	520			
Red Rock	520	570			
Sand	570	590			
Red Rock	590	630			
Sand	630	672			
Sand	672	690			
Black Slate	690	732			
Sand	740	784			
Red Rock	784	825	Show oil at 830'		
Sand	825	845			
Grey Slate	845	920			
Sand - Big Dunkard?	845	920			
Slate & Shell	920	1050	Show oil at 1085'		
Salt Sand	1050	1065			
Break	1065	1090			
Sand	1090	1095			
Coal - 1090-95	1095	1290			
Sand	1290	1465	Settling Sand at 1515'		
Black Lime	1465	1515			
Maxon Sand - Salt Sand?	1515	1665			
Big Lime	1665	1745			
Slate	1745	1752			
Injun Sand	1752	1863			
Lime	1863	1900			
Weir Shells	1900	1996			
Slate Shells	1996	2218			
Brown Shale	2216	2233			
Berea Shells	2233	2245			
Slate Shells	2245	2475			
Lime	2475	2535			
Slate Shells	2535	3200	Gas at 3250		
Slate Shells	3200	3905			
White Slate	3905	4285			
Br. Shale	4285	4470			
Corniferous Lime	4470	4560	Gas 4561' 2/10 W 1" Vol. 15000 C.F.		