

New Location   
 Drill Deeper  *issued*  
 Abandonment  *10-27-71* PRO. LOC. 10 M. N.E. OF SHATTO

Company Cities Service Oil Co.  
~~COLUMBIAN CARBON CO.~~  
 Address BOX 240 CHARLESTON W.VA. 25323  
 Farm GERTIE HARMON ET AL  
 Tract \_\_\_\_\_ Acres 160 Lease No. CT-93  
 Well (Farm) No. ONE Serial No. GW-665  
 Elevation (Spirit Level) 786.9  
 Quadrangle RIPLEY SW. 2-8-  
 County JACKSON District RIPLEY  
 Engineer J. S. Sell  
 Engineer's Registration No. 772  
 File No. \_\_\_\_\_ Drawing No. 298  
 Date 3-28-42 Scale 1" = 660'

STATE OF WEST VIRGINIA  
 DEPARTMENT OF MINES  
 OIL AND GAS DIVISION  
 CHARLESTON

WELL LOCATION MAP  
 FILE NO. JAC-324-P

+ Denotes location of well on United States Topographic Maps, scale 1 to 62,500, latitude and longitude lines being represented by border lines as shown.  
 - Denotes one inch spaces on border line of original tracing.

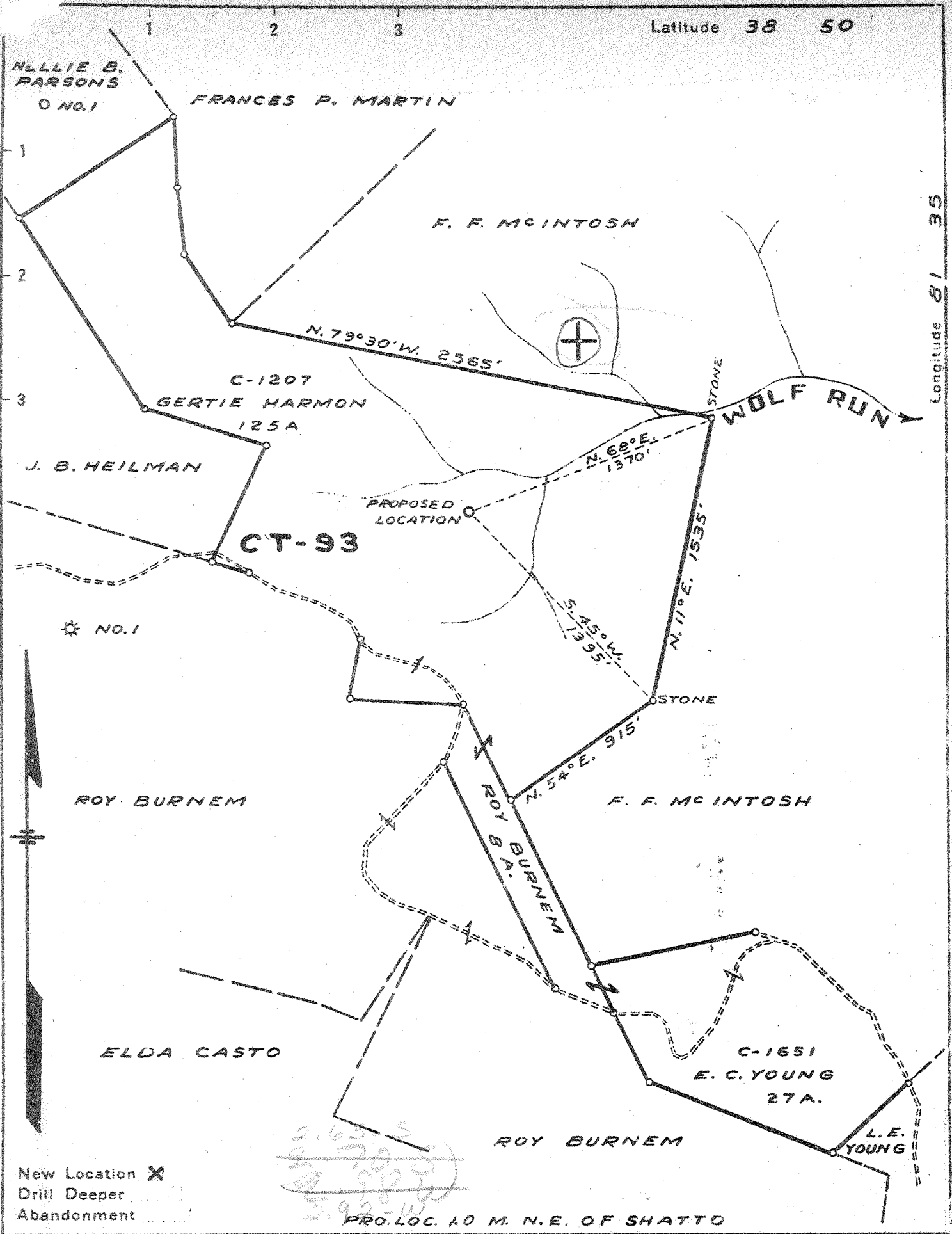

NO. 1



New Location X  
 Drill Deeper  
 Abandonment

2.63  
 2.70  
 2.95  
 2.95-W

PRO. LOC. 1.0 M. N.E. OF SHATTO

Company COLUMBIAN CARBON CO.  
 Address BOX 1240 CHARLESTON W.VA.  
 Farm GERTIE HARMON ET AL  
 Tract \_\_\_\_\_ Acres 160 Lease No. CT-93  
 Well (Farm) No. ONE Serial No. \_\_\_\_\_  
 Elevation (Spirit Level) 786.9  
 Quadrangle RIPLEY S.W. 8C-8-  
 County JACKSON District RIPLEY  
 Engineer J. Sell  
 Engineer's Registration No. 772  
 File No. \_\_\_\_\_ Drawing No. 298  
 Date 3-28-42 Scale 1" = 660'

STATE OF WEST VIRGINIA  
 DEPARTMENT OF MINES  
 OIL AND GAS DIVISION  
 CHARLESTON

### WELL LOCATION MAP

FILE NO. JAC-324

+ Denotes location of well on United States Topographic Maps, scale 1 to 62,500, latitude and longitude lines being represented by border lines as shown.

- Denotes one inch spaces on border line of original tracing.

6-6-42

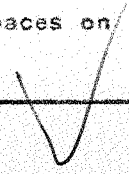

WEST VIRGINIA DEPARTMENT OF MINES  
OIL & GAS DIVISION  
W E L L R E C O R D

Permit No. Jac-324

Company	Columbian Carbon Co.	Gas Well
Address	Box 873, Charleston, W.Va.	CASING & TUBING
Farm	Gertie Harmon et al Acres 160	16 41'2 41'2
Location	Wolf Run	13 3/8 759' 0
Well No	1 (GW-665) Elev. 791.9 D.F.	10 1/2 1266' 0
District	Ripley Jackson County	85/8 2115'11 0
Surface	Gertie Harmon, et vix	7 5059'6 5059'6
	Cottageville, W.Va.	3"(7.50#) 93'3 93'3

Mineral  
Commenced 4-17-42  
Completed 7-14-42  
Shot 7-14-42 Depth 5117-5157' SLM

Volume 10,676 MCF  
Rock Pressure 1635 lbs. 4 days  
Fresh Water 305' 1-15" blr./hr.; 565' 1/2-15" blr.pr.hr.  
Salt Water 1385' 1/2-9" blr./hr.; 1817' 2-9" blrs.pr.hr.  
1845' Hole Full

Red Rock	0	40	Lime	1265	1285
Sand	40	55	Sand	1285	1330
Slate	55	115	White Slate	1330	1350
Red Rock	115	160	Black Slate	1350	1382
Lime	160	200	Sand	1382	1418
Slate	200	210	Slate	1418	1425
Red Rock	210	250	Sand	1425	1462
Lime	250	275	Slate	1462	1675
Sand	275	312	Salt Sand	1675	1920
Slate	312	320	Black Lime	1920	1931
Red Rock	320	330	Big Lime	1931	1970
Lime	330	350	Sand - Injun	1970	2057
Slate	350	365	Slate	2057	2059
Sand	365	390	Sandy Lime	2059	2078
Red Rock	390	393	Slate & Shells	2078	2098 SLM
Lime	393	415	Lime	2098 SLM	2190
Red Rock	415	490	Slate & Shells	2190	2440
Slate	490	500	Brown Shale	2440	2450
Red Rock	500	535	Becca Sand	2450	2460
Sand	535	570	Slate & Shells	2460	2950
Slate	570	575	Slate	2950	3615
Lime	575	592	Slate & Shells	3615	3990
Sand	592	620	Brown Shale - 441	3990	4121
Slate	620	645	White Slate	4121	4183
Lime	645	675	Brown Shale	4183	4293
Slate	675	695	White Slate	4293	4750
Sand	695	715	Brown Shale	4750	5006 SLM
Slate	715	720	Corniferous Lime - 463	5006 SLM	5117 SLM
Red Rock	720	770	Oriskany Sand	5117 SLM	5175
Lime	770	771	Lime	5175	5188
Red Rock	771	780	Oriskany Sand	5188	5204 SLM
Slate	780	815	Lime	5204 SLM	5209 SLM
Red Rock	815	845	TOTAL DEPTH 485		5209 SLM
Sand	845	865	Pay 5120-31		
Red Rock	865	885	Gas 2450 15 M Est.		
Lime	885	898			
Sand	898	915	CEMENT RECORD: 4-28-42 Aquagelled 13 3/8"		
Black Slate	915	953	casing. Ran 20 sacks Aquagel and 1 bail		
Lime	953	975	Fibrotex.		
Slate	975	985	5-6-42 Aquagelled 10 1/2" casing. Ran 20		
Red Rock	985	1000	sacks aquagel and 1 bail Fibrotex.		
Slate	1000	1011			
Sand	1011	1030	5-18-42 Aquagelled 8 5/8" casing. Ran		
Slate	1030	1055	23 sacks aquagel and 1 bail fibrotex.		
Sand	1055	1070			
Lime	1070	1110	6-25-42 Cemented 7" casing. Ran 12		
Slate & Shells	1110	1150	sacks Superior cement. Picked up pipe		
Lime	1150	1170	60' off bottom. Ran 50 sacks aquagel		
Big Dunkard Sand	1170	1250	and 4 bails Fibrotex. 39' cement in		
Black Slate	1250	1265	pipe.		