

1 2 3

Latitude 38 35

Longitude 81 35

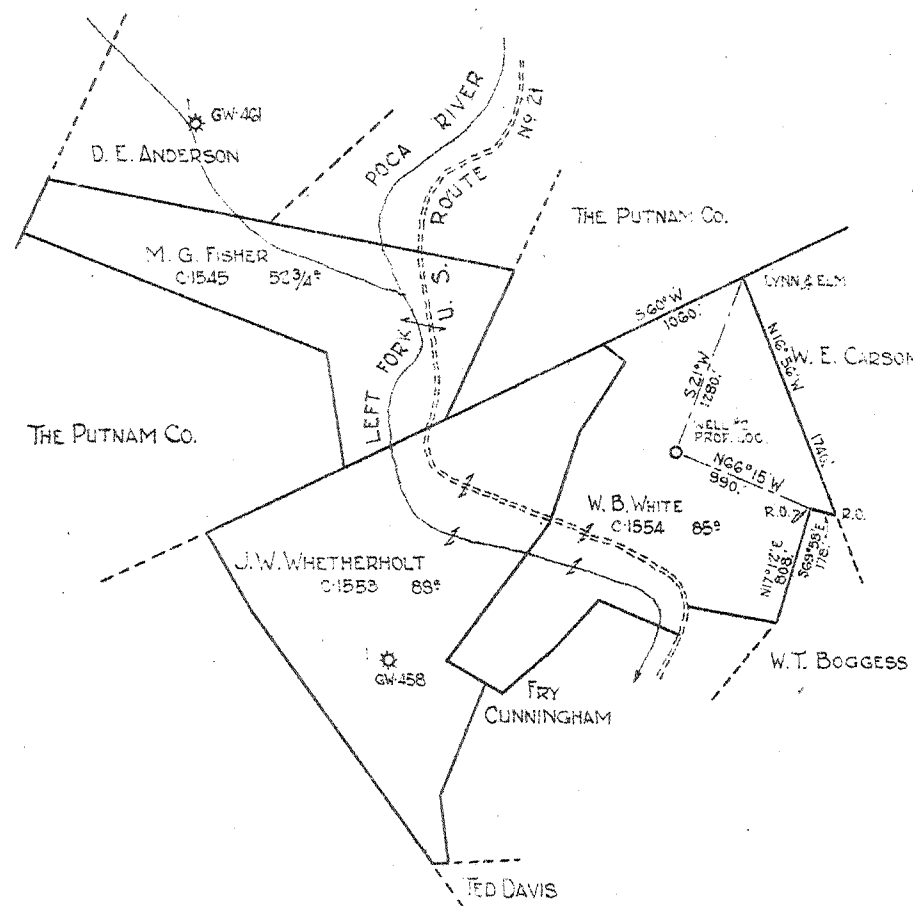

Abandoned July 49

W - 2.8
S - 1.55

New Location
 Drill Deeper
 Abandonment

0.6 Mi. - N Loop

Company COLUMBIAN CARBON CO.
 Address Box # 1240 CHARLESTON, W. VA.
 Farm J.W. WHETHERHOLT ET AL
 Tract _____ Acres 225 3/4 Lease No. C-1545- C-1553- C-1554
 Well (Farm) No. 2 Serial No. _____
 Elevation (Spirit Level) 867.4
 Quadrangle KENNA SW (8) SC
 County JACKSON District RIPLEY
 Engineer C.A. Branham
 Engineer's Registration No. 683
 File No. _____ Drawing No. _____
 Date 4/15/41 Scale 1" = 1320'

STATE OF WEST VIRGINIA
 DEPARTMENT OF MINES
 OIL AND GAS DIVISION
 CHARLESTON

WELL LOCATION MAP
 FILE NO. JAC-142

+ Denotes location of well on United States Topographic Maps, scale 1 to 62,500, latitude and longitude lines being represented by border lines as shown.

- Denotes one inch spaces on border line of original tracing.

WEST VIRGINIA DEPARTMENT OF MINES
OIL & GAS DIVISION
W E L L R E C O R D

Permit No. Jac-142		Gas Well
Company	Columbian Carbon Co.	Casing & Tubing
Address	Box 1240, Charleston, W.Va.	16 21'8" 21'8"
Farm	J.W. Whetherholt Acres 225- $\frac{3}{4}$	10 $\frac{1}{2}$ 899' Pulled
Location	Left fork of Poca River	8 5/8 2077'2" 2077'2"
Well No	2 (GW-484) Elev. 844.0 DF	7" 5060'7" 5060'7"
District	Ripley Jackson County	2 3/8 5234'3" 5234'3"
Surface	W.B. White, R.F.D.#1, Konna, W.Va.	Liner
Mineral	J.W. Whetherhold et al	3 $\frac{1}{2}$ " 93'7" 93'7"
	(Contact Columbian Carbon Co for addresses)	
Commenced	5-24-41	
Completed	8-30-41	
Shot	8-30-41 Depth 5123' SLM 5178' SLM	
Volume	3,285 MCF	
Rock Pressure	650 lbs. 3 days	
Salt Water	1500' Hole Full; 1650' Hole Full	

Red Rock	0	40	Brown Shale	3937	3975
Sand	40	50	White Slate	3975	4025
Grey Slate	50	60	Brown Shale	4025	4058
Red Rock	60	115	Slate	4058	4085
Slate	115	120	Brown Shale	4085	4250
Red Rock	120	150	Slate	4250	4690
Slate	150	170	Brown Shale	4690	4935
Red Rock	170	185	White Slate	4935	4955
Slate	185	195	Brown Shale	4955	5012
Sand	195	248	Corniferous Lime	5012	5120 SLM
Slate	248	390	Oriskany Sand	5120 SLM	5168
Sand	390	400	Lime Break	5168	5180
Slate	400	410	Oriskany Sand	5180	5211 SLM
Red Rock	410	470	Lime	5211 SLM	5225 SLM
Slate & Shells	470	492	TOTAL DEPTH		5223 SLM
Red Rock	492	550			
Slate	550	575	PAYS: 5123-33; 5151-52; 5160-65;		
Red Rock	575	587	5170-73		
Slate	587	610			
Sand	610	620	CEMENT RECORD:		
Slate	620	797	6-5-41-Ran 10 $\frac{1}{2}$ " casing.		
Lime	797	815	6-30-41-Cemented 8 5/8" casing		
Sand	815	853	Ran 95 sacks Alpha cement mixed with		
Slate	853	858	2 sacks Aquagel. 9' cement in pipe.		
Sand	858	925	8-14-41-Cemented 7" casing. Ran 11		
Slate	925	995	sacks Alpha cement. 40' cement in		
Black Slate	995	1018	pipe.		
Sand	1018	1095			
Slate & Shells	1095	1152			
Sand	1152	1190			
Slate	1190	1295			
Sand	1295	1305			
Slate	1305	1375			
Sand	1375	1395			
Slate	1395	1435			
Salt Sand	1435	1728			
Break	1728	1733			
Salt Sand	1733	1764			
Slate	1764	1766			
Dark Lime	1766	1859			
Gritty Lime	1859	1866			
Big Lime	1866	1948			
Sand	1948	2023			
Slate & Shells	2023	2085			
Sand	2085	2102			
Lime	2102	2145			
Slate	2145	2415			
Lime	2415	2424	Sm. Show gas 2420		
Slate & Shells	2424	3616			
Lime Shell	3616	3624			
Slate	3624	3650			
Brown Shale	3650	3705			
Slate & Shells	3705	3937			