

LATITUDE 38° 50'

LONGITUDE 81° 35'

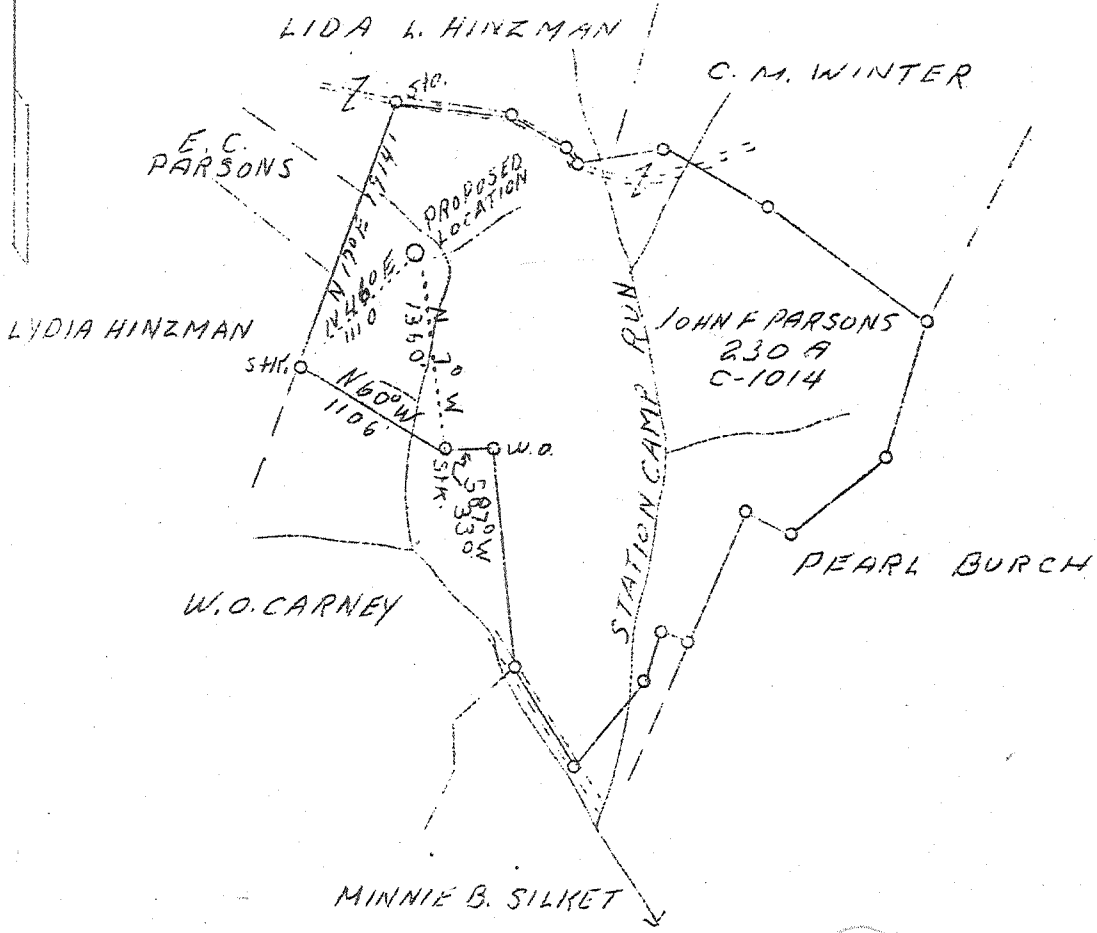

Permit Issued: 6-6-39

ABD
2/46

4.02 W
1.35
0.29-S

New location

Company Columbian Carbon Co.
 Address Box 1240 Charleston, W.Va.
 Farm John F. Parsons
 Acres 230
 Lease No. C - 1014
 Tract (Farm) No. 1
 A.C. (S.L.) 797.7 L
 Quadrangle Ripley. S
 County Jackson
 District Ripley
 Eng. James N. Soll
 Eng. Reg. No. 772
 Date 5/20/39
 Scale 1" = 1320'

STATE OF WEST VIRGINIA
 Department of Mines
 OIL AND GAS DIVISION
 Charleston

WELL LOCATION MAP

File No. 100-47

x Denotes location of well on U.S. Topographic Maps, scale 1 to 62,500, latitude and longitude lines being represented by border lines as shown.

- Denotes one inch spaces on border line of original tracing.

Roll 6-9-1939

