



Hope Natural Gas Company

STATE OF WEST VIRGINIA DEPARTMENT OF MINES OIL AND GAS DIVISION

May 9 1909

641

WELL RECORD

Permit No. 800-A

Oil or Gas Well (KIND)

Company Hope Natural Gas Company. Address 445 West Main St. Clarksburg, W. Va. Farm A. C. Hall Acres 78 Location (waters) Well No. 7966 Elev. 1096 District Coal County Harrison The surface of tract is owned in fee by Mineral rights are owned by Drilling commenced March 19, 1909 Drilling completed May 12, 1909 Date Shot From To With Open Flow /10ths Water in Inch /10ths Merc. in Inch Volume Cu. Ft. Rock Pressure lbs hrs Oil bbls., 1st 24 hrs. Fresh water 540 feet feet Salt water 880- 1005 feet feet

Table with columns: Casing and Tubing, Used in Drilling, Left in Well, Packers. Rows include sizes 16, 13, 10, 8 1/4, 6, 5 3/16, 3, 2 and packer details like Kind of Packer, Size of, Depth set, Perf. top/bottom.

CASING CEMENTED Not cemented SIZE No. Ft. Date COAL WAS ENCOUNTERED AT 20 FEET 96 INCHES FEET INCHES FEET INCHES FEET INCHES FEET INCHES

Main well log table with columns: Formation, Color, Hard or Soft, Top, Bottom, Oil, Gas or Water, Depth Found, Remarks. Rows include Pittsburgh Coal, Little Dunkard, Gas sand, First Salt, Second Salt, Little Lime, Pencil cave, Big Lime, Big Injun, Fifty Foot, Thirty Foot, Gordon stray, Fourth sand, 5th sand, Speechley sand, Total depth.

MAY 17 1944

Formation	Color	Hard or Soft	Top	Bottom	Oil, Gas or Water	Depth Found	Remarks

Date _____, 194__

APPROVED _____, Owner

By _____ (Signature)

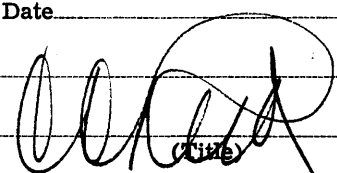

Coal District, Harrison County, W. Va.
 By Hope Natural Gas Co., 145 W. Main St., Clarksburg, W. Va.
 Abandoned under permit Har-.....-A7
 On 73 acres.
 Elevation, 1096' L.
 Drilling commenced March 19, 1909; completed May 12, 1909.
 Fresh water at 540'.
 Salt water at 880 and 1005'.
 10" casing, 253'; 8 1/2", 910'; 6 1/2", 1470'; 5", 2241' (pulled); 2" tubing,
 3116' (pulled).
 Casing not cemented.
 Coal was encountered at 20-28'.
 Gas well. Abandonment reported to Dept. of Mines (filed) March 7, 1944.
 Record to RCT from Hrs. Griffith Aug. 17, 1944. Old File No. 64.

	Top.	Bottom.
Pittsburgh Coal	20	- 28
Little Dunkard Sand	420	- 430
Gas Sand (water, 540')///	750	- 760
First Salt Sand	775	- 800
Second Salt Sand (water, 880-11005')	870	- 1060
Little Line	1390	- 1385
Pencil Cave	1385	- 1390
Big Line	1390	- 1455
Big Injun Sand	1455	- 1550
Fifty-foot Sand (gas, 1985-1990')	1950	- 2000
Thirty-foot Sand	2025	- 2085
Gordon Stray Sand	2236	- 2285
Fourth Sand	2305	- 2330
5th Sand (gas, 2390')	2388	- 2421
Speckley Sand (gas, 3084-3089')	3082	- 3094
Total depth		3108

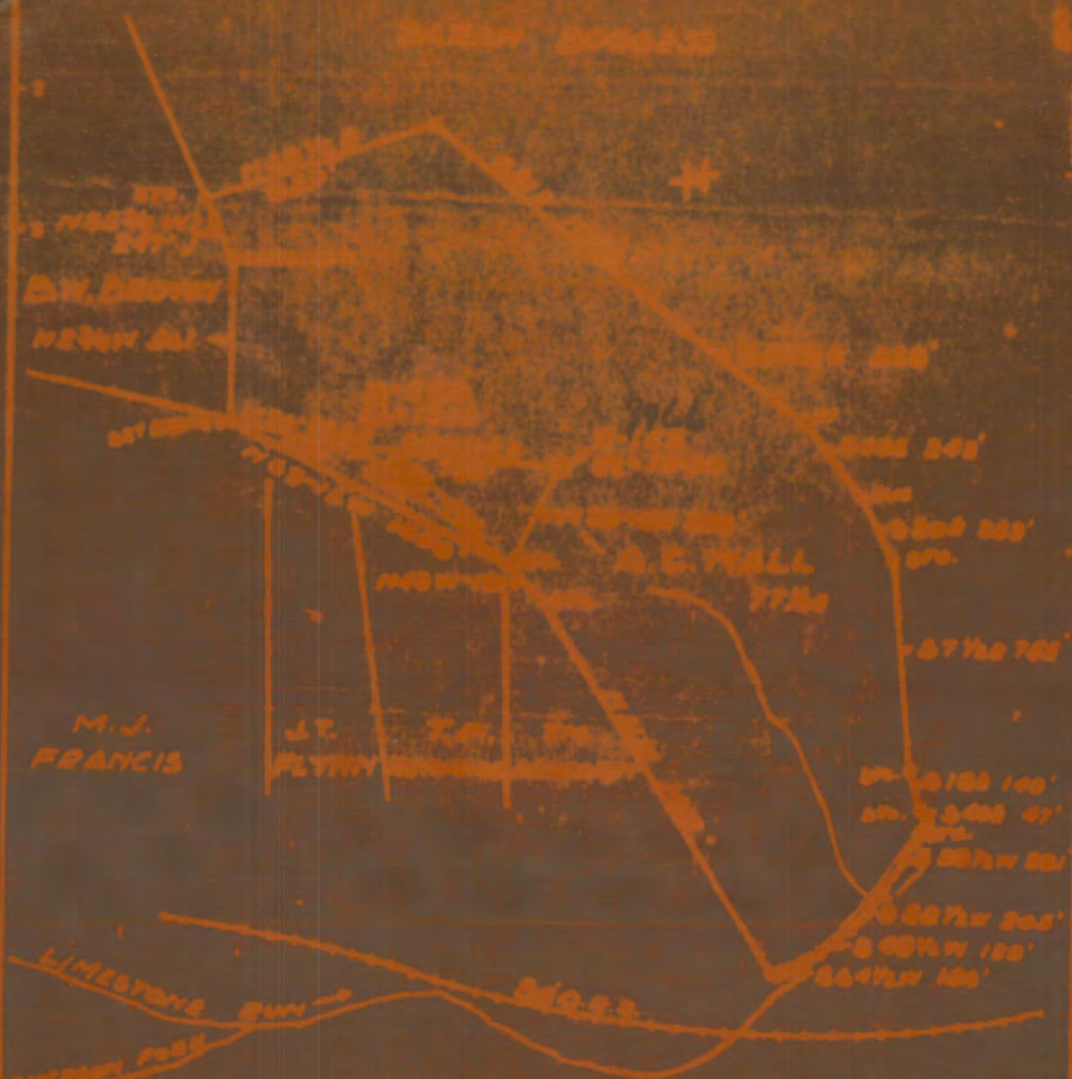

Flow Location
 Drill Deeper
 Abandonment W-260

CA-60000 SURVEY SHEET #44

Company	RESERVE GAS CO
Address	CLEMING, MISSISSIPPI
Farm	A.C. HALL FARM
Tract /	Acres 20
Well (Farm) No.	111
Elevation (Base Level)	SEMI 5000
County	CLEMING
State	MISSISSIPPI

State of MISSISSIPPI
 Department of Energy
 Oil and Gas Division
 Jackson

WELL LOCATION MAP
 FILE NO. _____

A double location of well on United States
 Geological Survey map 100-10000