

LATITUDE 39° 20'

LONGITUDE 80° 25'

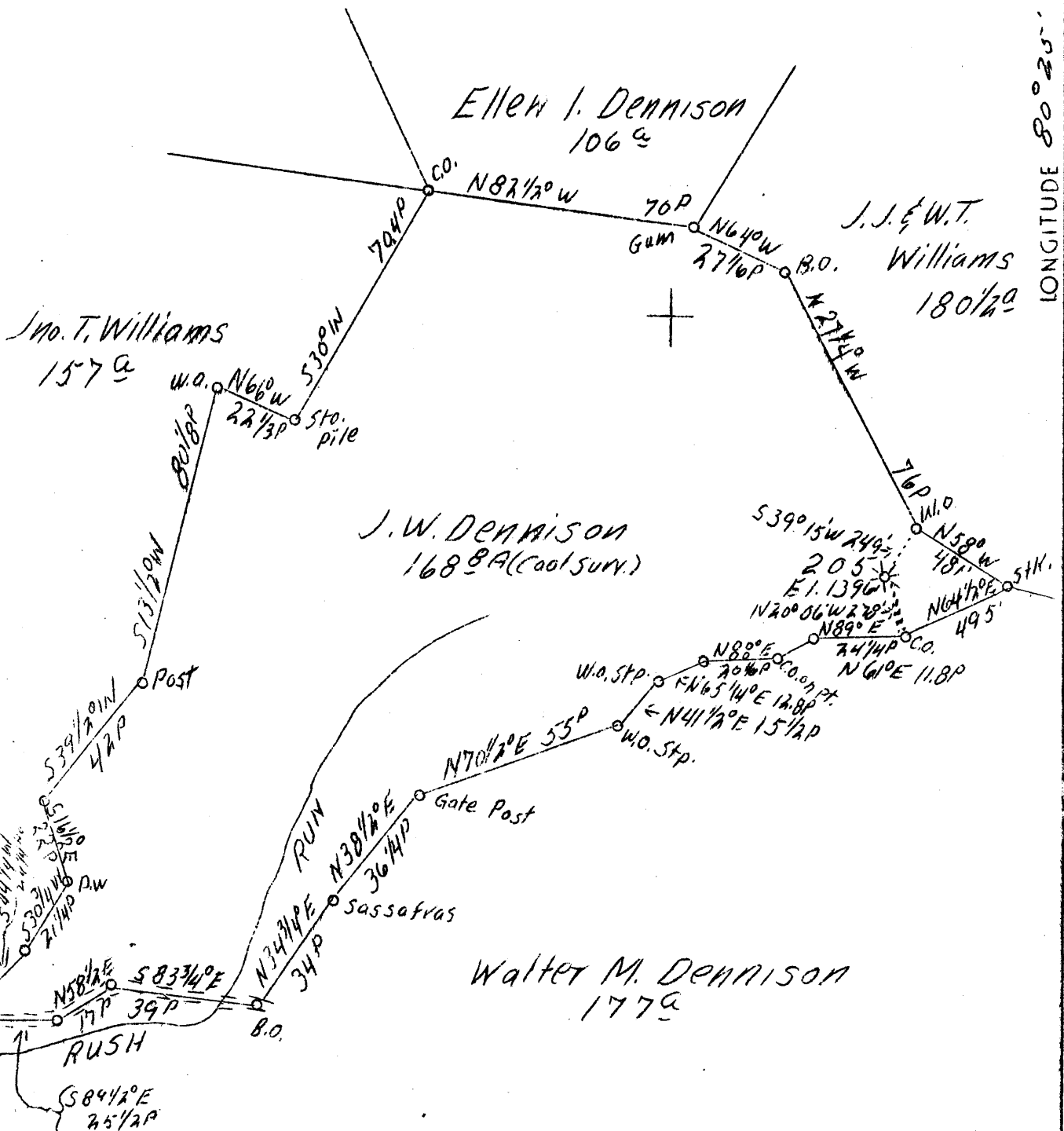

2.83S
2.57W
S-2.88
W-2.61

A.B.D.

F.B. 673 P 27E 28

Company	Hope Natural Gas Co.
Address	Clarksburg, W. Va.
Farm	J. W. Dennison
Acres	173
Lease No.	778
Well (Farm) No.	-
Serial No.	205
Elevation (SL)	1396
Quadrangle SW	Clarksburg
County	Harrison
District	Ten Mile
Engineer	W. M. Bowers
Eng. Reg. No.	900
Date	June 28, 1939
Scale	1" - 40 poles

STATE OF WEST VIRGINIA
Department of Mines
OIL & GAS DIVISION
Charleston

WELL LOCATION MAP

File No. Har-497-A

x Denotes location of well on U. S. Topographic Maps, scale 1 to 62,500, latitude and longitude lines being represented by border lines as shown.

- Denotes one inch spaces on border line of original tracing.

STATE OF WEST VIRGINIA
DEPARTMENT OF MINES
OIL AND GAS DIVISION

401

WELL RECORD

Gas

Permit No. 497-A *Clarkburg JW* Oil or Gas Well (Kind) _____

Company Hope Natural Gas Company
Address Clarksburg, W. Va.
Farm J. W. Dennison Acres 177
Location (waters) Dennison's Run
Well No. 205 Elev. _____
District Ten Mile County Harrison
The surface of tract is owned in fee by _____
Address _____
Mineral rights are owned by _____
Address _____
Drilling commenced July 14, 1900
Drilling completed August 26, 1900
Date shot No record Depth of shot _____
Open Flow /10ths Water in _____ Inch
/10ths Merc. in _____ Inch
Volume _____ Cu. Ft.
Rock Pressure _____ lbs. _____ hrs.
Oil _____ bbls., 1st 24 hrs.
Fresh water None recorded feet _____ feet
Salt water None recorded feet _____ feet

Casing and Tubing	Used in Drilling	Left in Well	Packers
Size			Kind of Packer
16			
13			
10	546	Pulled	Size of
8 1/4	967	Pulled	
6 5/8	1920	1920	Depth set
5 3/16			
3	2856	Pulled	Perf. top
2			Perf. bottom
Liners Used			Perf. top
			Perf. bottom

CASING CEMENTED _____ SIZE _____ No. FT. _____ Date _____
Not cemented
COAL WAS ENCOUNTERED AT 480 FEET 72 INCHES
_____ FEET _____ INCHES _____ FEET _____ INCHES
_____ FEET _____ INCHES _____ FEET _____ INCHES

Formation	Color	Hard or Soft	Top	Bottom	Oil Gas or Water	Depth Found	Remarks
Pittsburgh Coal			480	486			
Big Dunkard Sand			980	1080			
Salt Sand			1480	1550			
Big Lime			1800	1900			
Big Injun Sand			1900	1950			
Fifty Foot Sand			2400	2420			
Thirty Foot Sand			2500	2530			
Gordon Stray Sand			2532	2590			
Gordon Sand			2591	2640			
Fifth Sand			2832	2836	Gas	2836	
Total Depth			2856				

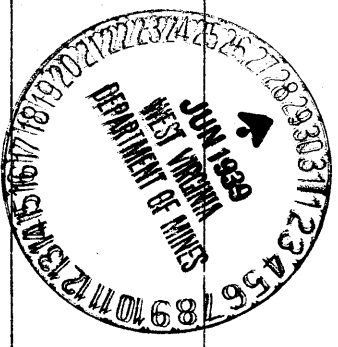

Formation	Color	Hard or Soft	Top	Bottom	Oil, Gas or Water	Depth Found	Remarks

Date June 28,....., 1939.

APPROVED Hope Natural Gas Company....., Owner

By.....W. Reed..... General Supt.

(Title) W. Reed

STATE OF WEST VIRGINIA
DEPARTMENT OF MINES
OIL AND GAS DIVISION

AFFIDAVIT OF PLUGGING AND FILLING WELL

Permit No. Har-497

No coal operations in vicinity.

Hope Natural Gas Company

COAL OPERATOR OR OWNER

NAME OF WELL OPERATOR

ADDRESS

Clarksburg, W. Va.

COMPLETE ADDRESS

COAL OPERATOR OR OWNER

July 25,

19 39

ADDRESS

Ten Mile

WELL AND LOCATION

District

LESSOR OR PROPERTY OWNER

Harrison

County

ADDRESS

Well No. 808

J. W. Dennison

Farm

AFFIDAVIT TO BE MADE IN TRIPPLICATE. ONE COPY TO BE MAILED BY REGISTERED MAIL TO THE DEPARTMENT, ONE COPY TO BE RETURNED BY THE WELL OPERATOR AND THE THIRD COPY (AND OTHER COPIES IF REQUIRED) TO BE MAILED BY REGISTERED MAIL TO THE OPERATOR ABOVE NAMED AT THEIR RESPECTIVE ADDRESSES.

STATE OF WEST VIRGINIA,

AFFIDAVIT

County of Harrison

Thomas P. Sturm

Geoffrey C. Meredith

being first duly sworn according to law depose and say that they are experienced in the work of plugging and filling oil and gas wells and were employed by Hope Natural Gas Company, well operator, and participated in the work of plugging and filling the above well, that said work was commenced on the 25th day of July, 1939, and that the well was plugged and filled in the following manner:

Manner in which well was plugged:

Filled with clay to 2812, 20 feet above Fifth sand. Placed a cement plug. Filled with clay to 2971. Placed a cement plug. Bridged at 1920. Filled with clay to 1920. Drove lead plug at this point. All gas shut off. Ripped 6-3/8" casing at 1520, 1200, 1000 and at last at 813 feet. Was unable to pull casing below that point, as it had been mudded around. Filled with clay from 813 feet to 516 feet.

Manner in which coal was plugged:

Sealed from 516 to 460 feet. Filled from 460 to surface with clay and mud.

Description of monument:

Concrete shaft with inscription - H.N.G.Co. No. 205

THIS AFFIDAVIT MUST BE MADE IN ORIGINAL AND IN ACCORDANCE WITH THE PROVISIONS OF SECTION 10, ARTICLE 4, CHAPTER 60 OF THE CODE;

and that the work of plugging and filling said well was completed on the 25 day of July, 1939.

And for the deponents with not.



Thomas P. Sturm
Geoffrey C. Meredith
M. A. Sampson
Notary Public

August 18, 1942