

LATITUDE 39° 20'

LONGITUDE 80° 25'

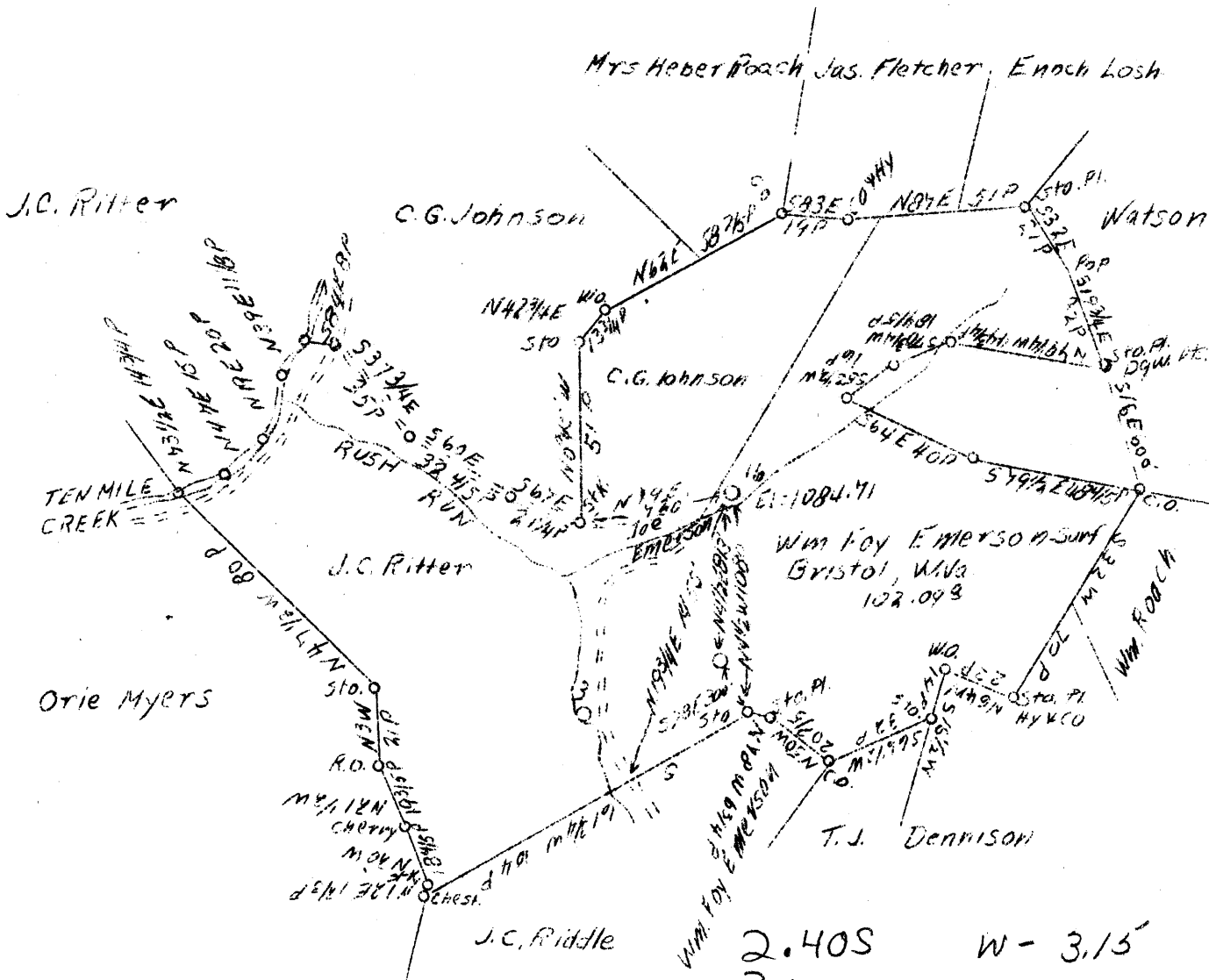

Coal-owned by Senator David J. Baird et al
Camden, N.J.

Well to be A.B.D.

Company	South Penn Oil Co.
Address	411 Seventh Ave., Pittsburgh, Pa.
Farm	P. C. Williams
Acres	200
Lease No.	27336
Well (Farm) No.	16
Quadrangle	Clarksburgh SW
County	Harrison
District	Ten Mile
Eng.	E.C. Tabler
Date	12/8/38
Scale	1" - 800'

STATE OF WEST VIRGINIA
Department of Mines
OIL AND GAS DIVISION
Charleston

WELL LOCATION MAP

File No. Map-459-A

x Denotes location of well on U.S. Topographic Maps, scale 1 to 62,500, latitude and longitude lines being represented by border lines as shown.

- Denotes one inch spaces on border line of original tracing.

WEST VIRGINIA DEPARTMENT OF MINES
OIL AND GAS DIVISION

375

WELL RECORD

Permit No. AP-459-A-

Oil or Gas Well OIL
(Kind)

Company South Penn Oil Company
 Address 411 Seventh Ave., Pittsburgh, Pa.
 Farm P. C. Williams Acres 200
 Location (waters) Ten Mile Creek
 Well No. 16 Elev. 1084.71
 District Ten Mile County Harrison
 The surface of tract is owned in fee by Wm. Foy Emerson
 Address Bristol, W. Va.
 Mineral rights are owned by Lloyd W. Williams et al
239 Meigs Ave., Address Clarksburg, W. Va.
 Drilling commenced April 11, 1900
 Drilling completed May 22, 1900
 Date shot See below Depth of shot --
 Open Flow /10ths Water in -- Inch
 /10ths Merc. in -- Inch
 Volume -- Cu. Ft.
 Rock Pressure -- lbs. -- hrs.
 Oil 130 bbls., 1st 24 hrs.
 Fresh water -- feet
 Salt water -- feet

Casing and Tubing	Used in Drilling	Left in Well	Packers
Size			
16.			Kind of Packer <u>-</u>
13.			<u>-</u>
10.	<u>339 (Pulled)</u>		Size of <u>-</u>
8 1/4.	<u>837 (Pulled)</u>		<u>-</u>
6 5/8.	<u>1808'</u>		Depth set <u>-</u>
5 3/16.			<u>-</u>
3.			Perf. top <u>-</u>
2.			Perf. bottom <u>-</u>
Liners Used <u>406' 5X5 1/2</u>			Perf. top <u>-</u>
			Perf. bottom <u>-</u>

CASING CEMENTED - SIZE - No. FT. - Date -
 COAL WAS ENCOUNTERED AT 320 FEET 72 INCHES
- FEET - INCHES - FEET - INCHES
- FEET - INCHES - FEET - INCHES

Formation	Color	Hard or Soft	Top	Bottom	Oil Gas or Water	Depth Found	Remarks
Pittsburgh Coal			320	326			
Big Dunkard Sand			820	900			
Salt Sand			1420	1500			
Big Lime			1640	1740			
Big Injun Sand			1740	1800			
Fifty Foot Sand			2240	2270			
Gordon Sand			2422	2480			
Fifth Sand			2663	2669			
Total Depth				2685			

Shot Record.
 Mar. 19, 1901 24 Qt.
 July 26, 1922 20 Qt.
 Aug. 4, 1922 60 Qt.



