



BENTON STOUT NO. 4957 WELL.

LOCATION NOT FOUND  
No. 215 O.F. (Harr.)

Har-278-A

0384

Elk District, Harrison County, W. Va.  
 Hope Natural Gas Co., 445 W. Main St., Clarksburg, W. Va.  
 Own 133 acres, surface owned by Alfonso and Ross F. Stout,  
 Route 1, Mt. Clare, W. Va., and mineral rights by  
 Hutchinson Coal Co., Fairmont, W. Va.  
 Elevation, 1379' L.  
 10" casing, 152'; 6-5/8", 1640'.  
 Coal was encountered at 90-96'.  
 Abandonment reported to Dept. of Mines Nov. 6, 1935.  
 Well was shot at 2580-2595'.  
 Fresh water at 190 and 320'; salt water at 1105'.  
 Gas well. . Now exhausted.

	Top.	Bottom.
Pittsburgh Coal	90	96
Water, 190'.		
Water, 320'.		
Little Dunkard Sand	400	425
Big Dunkard Sand	520	550
Gas Sand	750	800
First Salt Sand	855	885
Second Salt Sand (water, 1105')	960	1195
Maxton Sand	1505	1535
Little Lime	1550	1560
Pencil Cave	1560	1564
Big Lime	1564	1645
Big Injun Sand	1645	1781
Berea Sand	1845	1890
Gantz Sand	1982	2018
50-Ft. Sand	2072	2110
30-Ft. Sand	2125	2300
Gordon Stray Sand	2398	2406
Gordon Sand	2416	2459
Fourth Sand	2486	2510
Fifth Sand (gas, 2585-2590')	2578	2611
Total depth		2638

WV 4 BELL NO. 4957

INDPE NATURAL GAS CO

BENTON STOUT

ELK

County HARRISON

Building, W. Va., by

Plan covering 200 Acres

County, W. Va.

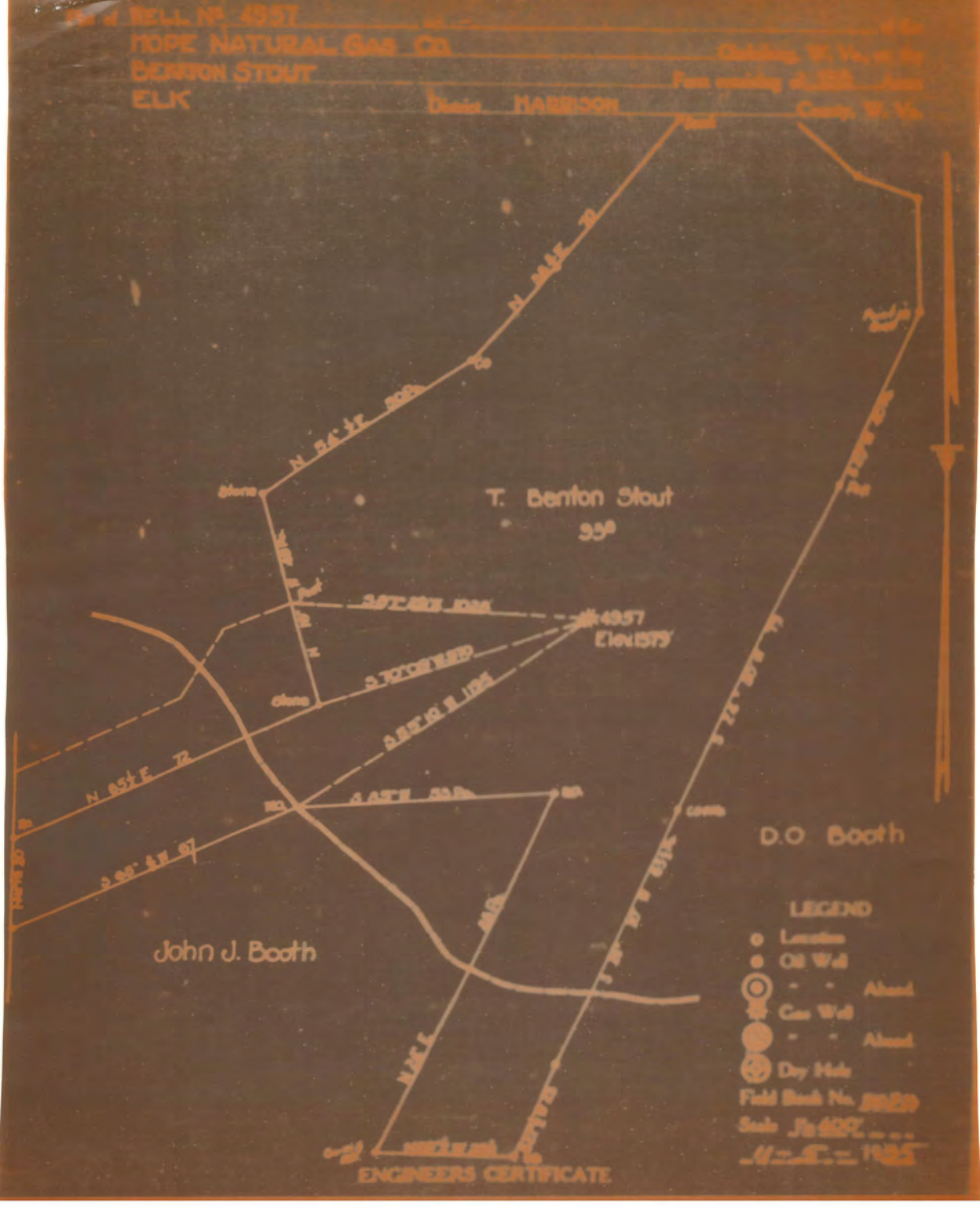

T. Benton Stout

95°

4957  
Elev 1575'

D.O. Booth

John J. Booth

LEGEND

- Location
- Oil Well
- ⊙ - - Ahead
- ⊗ Gas Well
- - - Ahead
- ⊙ Dry Hole

Field Book No. 20029

Scale 1/4" = 400'

11-5-1925

ENGINEERS CERTIFICATE