

LATITUDE 39°20'00"

LONGITUDE 80°17'30"



2.462  
0.65W

7'5 OGIS topo location

7.5' loc \_\_\_\_\_ 15' loc \_\_\_\_\_  
  (calc.) \_\_\_\_\_

Company Hope Cons. & Ref Co.

Farm D. Coffman # 240

Quad Clarksburg 7'12

County Harrison

District Coal

**WELL LOCATION MAP**

File No. 033-30234

234A

Coal District, Harrison County, W. Va.

By Hope Cons. &amp; Ref. Co., 445 W. Main St., Clarksburg, W. Va.

On 32 acres, surface owned by Mike Diniski, Route 2, Clarksburg,  
W. Va., and mineral rights by Consolidation Coal Co.,  
Fairmont, W. Va.

Elevation, 1196' L.

10" casing, 241'; 8 $\frac{1}{4}$ ", 1233'; 6-5/8", 1710'; 2" tubing, 2732'.

Coal was encountered at 41-44 and 168-178'.

Abandonment reported to Dept. of Mines March 13, 1935.

Well was shot at 2670-2690'.

Salt water at 1025-1030'.

Gas well; now exhausted.

	Top.	Bottom.	Thickness.
Native coal	41	- 44	3
Pittsburgh Coal	168	- 178	10
Little Dunkard Sand	625	- 655	30
Big Dunkard Sand	750	- 770	20
Gas Sand	906	- 945	39
First Salt Sand (water, 1025-1030')	1012	- 1106	94
Second Salt Sand	1125	- 1220	95
Maxton Sand	1500	- 1520	20
Little Lime	1595	- 1620	25
Pencil Cave	1620	- 1640	20
Big Lime	1640	- 1710	70
Big Injun Sand	1710	- 1795	85
Gentz Sand	1895	- 1910	15
Fifty-foot Sand	2152	- 2185	33
Thirty-foot Sand (gas, 2202-2204')	2200	- 2254	54
Gordon Stray Sand	2256	- 2305	49
Gordon Sand	2328	- 2353	25
Sand	2499	- 2560	61
Fifth Sand (oil, 2670-2690'; gas, 2654')	2652	- 2696	44
Total depth		2732	

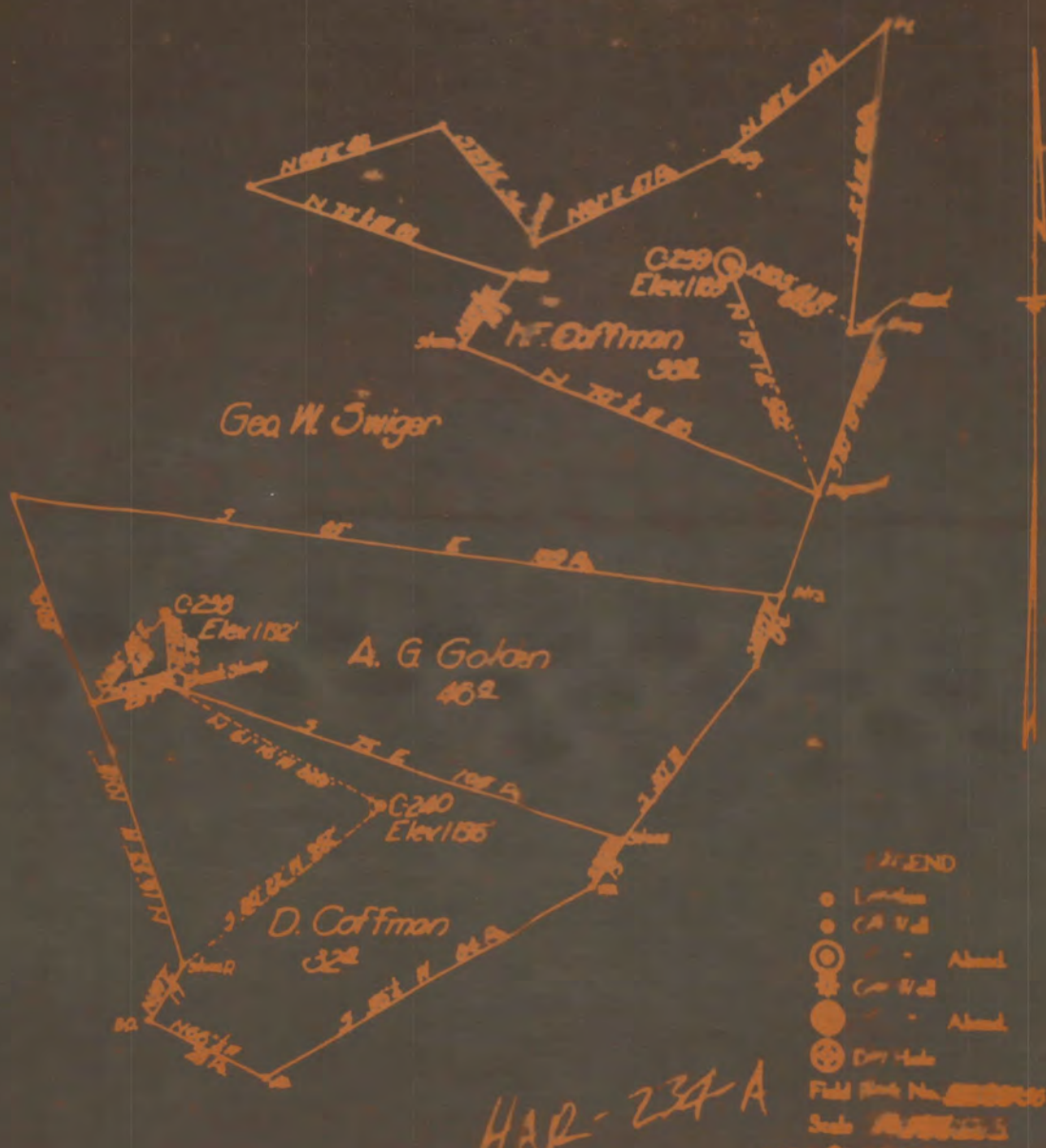

**HAR-234A**

**ENGINEERS CERTIFICATE**

239 Sept 28 - 1924  
 240 Nov 9 - 1924  
 240 Mar 18 - 1925

I, the undersigned, hereby certify that this map is correct and shows all the information to the best of my knowledge and belief, acquired by the oil and gas section of the mining laws of West Virginia.