

Coal District, Harrison County, W. Va.

221-A

By Hope Cons. & Ref. Co., 445 W. Main St., Clarksburg, W. Va.

On 26 acres, surface owned by Melvin Monroe, R. F. D., Clarksburg, W. Va., and mineral rights by The Consolidation Coal Co., Fairmont, W. Va.

Elevation, 1339' L.

10" casing, 361'; 6-5/8", 1812'; 5-3/16", 2578'; 2" tubing, 2871'.

Coal was encountered at 195-197, 266-271, and 303-310'.

Abandonment reported to Dept. of Mines Jan. 10, 1935.

Well was shot at 2812-2822'.

Salt water at 1200'.

Producing hole; exhausted. Gas well.

	Top.	Bottom.	Thickness.
Native coal	195	- 197	2
Coal	266	- 271	5
Pittsburgh Coal	303	- 310	7
Little Dunkard Sand	720	- 750	30
Big Dunkard Sand	800	- 835	35
Gas Sand	1030	- 1075	45
First Salt Sand	1110	- 1170	60
Second Salt Sand (water, 1200')	1185	- 1272	97
Big Lime	1755	- 1812	57
Big Injun Sand	1812	- 1918	106
Squaw Sand	1936	- 1945	9
Fifty-foot Sand	2285	- 2335	50
Thirty-foot Sand	2340	- 2495	155
Gordon Stray Sand	2573	- 2584	11
Gordon Sand	2625	- 2635	10
Fourth Sand	2645	- 2665	20
Fifth Sand (gas, 2719')	2715	- 2728	13
Bayard Sand (gas, 2814'; oil, 2820')	2785	- 2825	40
Total depth		2871	

Plan of WELLS No 3082-3731-3880-7392 & HOE WELLS No 487-241-
 HOPE NATURAL GAS Co. & HOPE CONSTRUCTION & REFINING Co. Clarksburg, W. Va., on the
 JESSE ASHCRAFT 15th NO. FLOWERS 508 L.S. HORNOR 232nd from consisting of _____ Acres
 G. B. PARR 20th COAL. Date HARRISON County, W. Va.

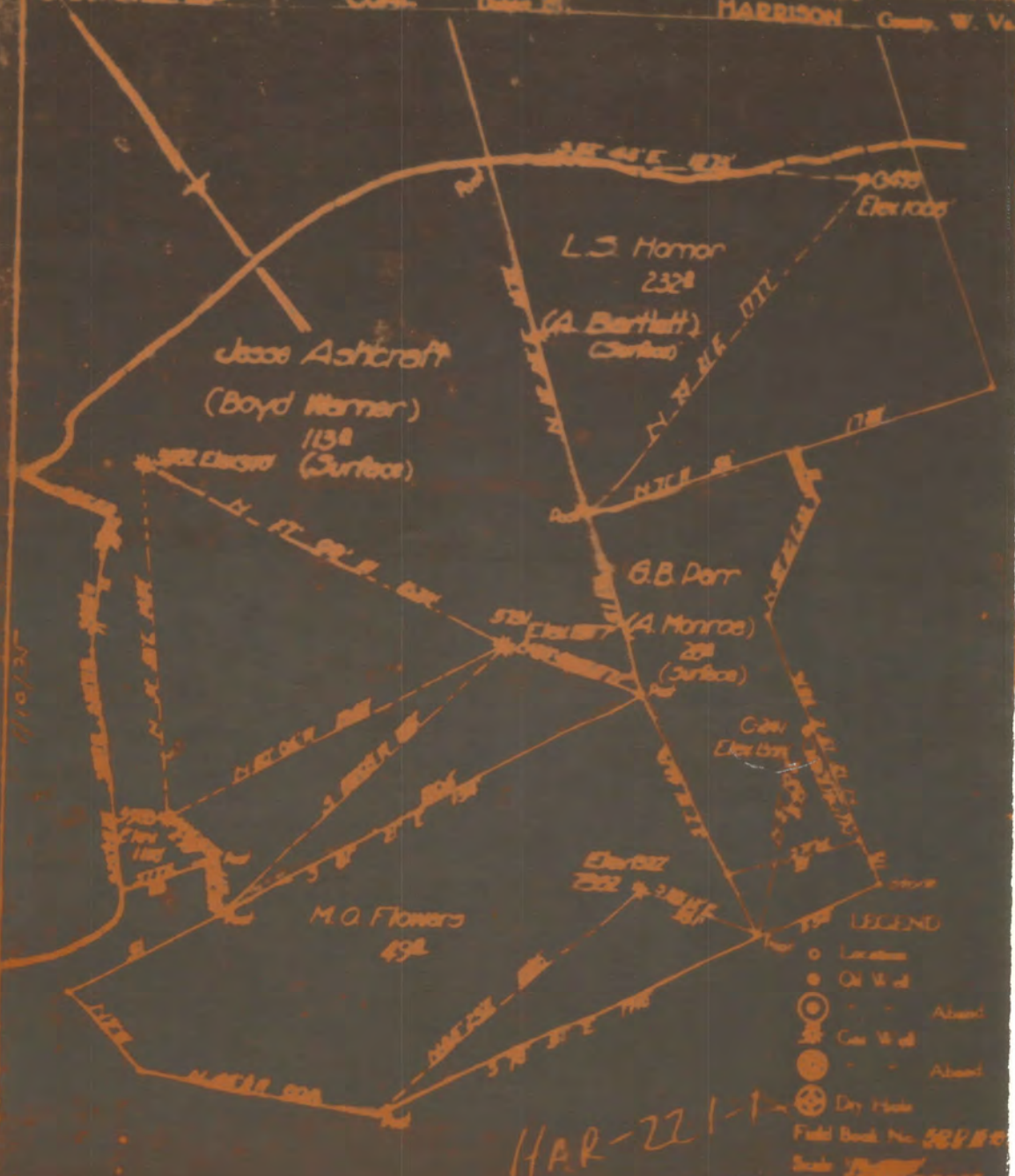

ENGINEER'S CERTIFICATE

I, the undersigned, hereby certify that this map is correct and shows all the information to the best of my knowledge.

Field Book No. 3880-7392
 Scale 1" = 400'
 C-241 11-28-1925