

11,123' to Bottom Hole

5,367' to Top Hole

HG Energy II Appalachia, LLC
Well No. Schoen 1205 S-8H

Page 1 of 2

Notes: Well No. Schoen 1205 S-8H
UTM NAD 1983 (USSF)
Top Hole Coordinates
N: 14,218,431.91'
E: 1,824,095.14'
Landing Point Coordinates
N: 14,218,241.61'
E: 1,824,373.81'
Bottom Hole Coordinates
N: 14,202,192.92'
E: 1,830,279.33'

TOP LATITUDE 39 - 10 - 00
BTM LATITUDE 39 - 07 - 30

TOP HOLE LONGITUDE 80 - 20 - 00
BTM HOLE LONGITUDE 80 - 17 - 30

5,563' to Top Hole



Legend

- Proposed gas well
- ⊕ Well Reference, as noted
- ⊗ Monument, as noted
- ☀ Existing Well, as noted
- ☀ Existing Plugged Well, as noted
- ☀ Digitized Well, as noted
- Creek or Drain
- - - Existing Road
- - - Surface boundary (approx.)
- - - Interior surface tracts (approx.)



I, the undersigned, hereby certify that this plat is correct to the best of my knowledge and belief and shows all the information required by law and the rules issued and prescribed by the Department of Environmental Protection.

Dwayne D. Matheny
Dwayne D. Matheny, P.S., 2070

Notes: Well No. Schoen 1205 S-8H
West Virginia Coordinate System of 1927, North Zone based upon Differential GPS Measurements.
Top Hole coordinates Latitude: 39°09'05.00" Longitude: 80°21'08.15"
Bottom Hole coordinates Latitude: 39°06'23.99" Longitude: 80°19'51.15"
UTM Zone 17, NAD 1983
Top Hole Coordinates N: 4,333,786.714m E: 555,985.311m
Bottom Hole Coordinates N: 4,328,837.060m E: 557,870.255m
Plat orientation and corner and well references are based upon the grid north meridian. Well location references are based upon the magnetic meridian.

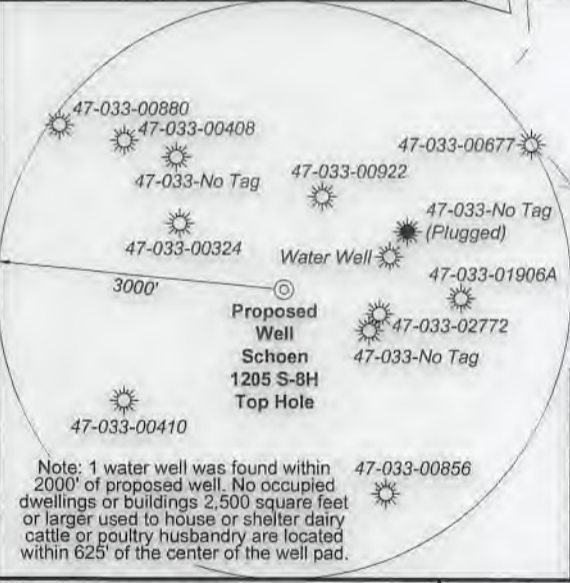

Tag	Bearing	Dist.
L1	S 70°59' E	1,526.3'
L2	S 56°31' E	1,300.3'
L3	N 87°54' W	1,224.8'
L4	N 71°53' W	992.8'
L5	S 55°40' E	337.5'

FILE NO: 32-36-G-19
DRAWING NO: Schoen 1205 S-8H Well Plat
SCALE: 1" = 2000'
MINIMUM DEGREE OF ACCURACY: Submeter
PROVEN SOURCE OF ELEVATION: CORS, Bridgeport, WV

STATE OF WEST VIRGINIA
DEPARTMENT OF ENVIRONMENTAL PROTECTION
OIL AND GAS DIVISION

DATE: December 30 2020
OPERATOR'S WELL NO. Schoen 1205 S-8H
API WELL NO
47 - 033 - 06002
STATE COUNTY PERMIT

WELL TYPE: OIL GAS LIQUID INJECTION WASTE DISPOSAL
(IF GAS) PRODUCTION: STORAGE DEEP SHALLOW
LOCATION: ELEVATION: 1,407.3' WATERSHED: Middle West Fork Creek
DISTRICT: Grant / Hackers Creek
SURFACE OWNER: George & Rosanne Schoen
ROYALTY OWNER: Willa Post Robey, et al LEASE NO: ACREAGE: 78.20
PROPOSED WORK: DRILL CONVERT DRILL DEEPER FRACTURE OR STIMULATE PLUG OFF OLD FORMATION
 PERFORATE NEW FORMATION OTHER PHYSICAL CHANGE IN WELL (SPECIFY) 7,240' TVD
 PLUG AND ABANDON CLEAN OUT AND REPLUG TARGET FORMATION: Marcellus Shale ESTIMATED DEPTH: 24,802' MD

WELL OPERATOR: HG Energy II Appalachia, LLC DESIGNATED AGENT: Diane C. White
ADDRESS: 5260 Dupont Road ADDRESS: 5260 Dupont Road
Parkersburg, WV 26101 Parkersburg, WV 26101



ID	Lease
1	A.B. Post, et al
4	Charlotte C. Gerlach
5	French S. Young, et al
8	Susan V. Curry & Ida M. Curry
9	L.D. & Addie Swisher
11	P.T. Allman
12	French S. Young, et al
14	M.M.F. & S.F. Randolph
19	Sidney & Virginia Haymond
20	Alcinda B. & M.E. Jackson
21	Patricia B. Smith, et al
64	Melvina E. Cookman
70	Mary Alkire
71	Allie & M.E. Jackson, et al

Harrison County				
No.	TM / Par	Owner	Bk / Pg	Ac.
1	447 / 2	George & Rosanne Schoen	1148 / 1059	65.00
2	447 / 3	George & Rosanne Schoen	1253 / 302	10.06
3	446 / 29	John F. McCuskey II, et al	1121 / 25	75.00
4	447 / 20	Richard & Janet Stout	1175 / 320	51.00
5	447 / 4.13	Richard & Janet Sprout	1389 / 669	5.04
6	447 / 21	Richard & Rebecca Sprout	1600 / 849	6.09
7	447 / 22	Daniel & Stacie Cooley	1310 / 1072	16.59
8	447 / 33	Joseph C. Queen	1349 / 508	20.00
9	447 / 34	Sharon K. Patsy J. Salate	1360 / 84	43.00
10	447 / 35	Kenneth Maxwell & Patricia Myers	1311 / 423	11.67
11	447 / 43	Betty J. & Isaac H. Maxwell III	1543 / 141	123.95
12	467 / 1	Margaret L. Gyimesi	1306 / 775	78.79
13	467 / 2	Jackson L. Smith	1378 / 976	95.16
14	467 / 1.1	Margaret Gyimesi	1306 / 775	1.45
15	467 / 30	William L. Randolph, et ux	1518 / 19	73.73
16	467 / 33.1	Eugene W. Hanby	1428 / 1	4.76
17	467 / 33.2	Charles R. Sutton	1472 / 181	1.03
18	467 / 33	Charles R. & Franklin L. Sutton	1472 / 181	39.20
19	467 / 34	Joseph M. Richards	1439 / 1234	9.15
20	467 / 36	Joseph M. Richards	1439 / 1234	73.93
21	467 / 52	David L. & Lisle C. Hinkle	1282 / 389	175.50
22	487 / 4.1	Catherine A. Mauro	1244 / 135	95.45
23	487 / 5	Kimberly & Terri Glaze Wriston	W 83 / 97	129.62
Lewis County				
24	10C / 11	Thomas C. Kennedy	W 3 / 428	92.50
25	10C / 16	Terri Smith Glaze	W 34 / 428	105.00
26	10C / 15	Thomas C. Kennedy	W 3 / 428	107.00

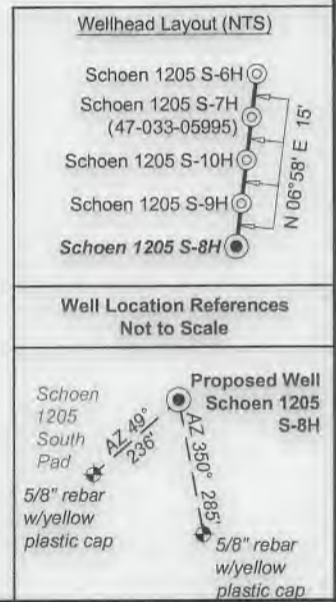

FILE NO: 32-36-G-19
DRAWING NO: Schoen 1205 S-8H Well Plat
SCALE: 1" = 2000'
MINIMUM DEGREE OF ACCURACY: Submeter
PROVEN SOURCE OF ELEVATION: CORS, Bridgeport, WV

STATE OF WEST VIRGINIA
DEPARTMENT OF ENVIRONMENTAL PROTECTION
OIL AND GAS DIVISION

DATE: December 30 2020
OPERATOR'S WELL NO. Schoen 1205 S-8H
API WELL NO
47 - 033 - 06002
STATE COUNTY PERMIT

WELL TYPE: OIL GAS LIQUID INJECTION WASTE DISPOSAL
(IF GAS) PRODUCTION: STORAGE DEEP SHALLOW

LOCATION: ELEVATION: 1,407.3' WATERSHED: Middle West Fork Creek
DISTRICT: Grant / Hackers Creek
SURFACE OWNER: George & Rosanne Schoen
ROYALTY OWNER: Willa Post Robey, et al LEASE NO: ACREAGE: 78.20

PROPOSED WORK: DRILL CONVERT DRILL DEEPER FRACTURE OR STIMULATE PLUG OFF OLD FORMATION
 PERFORATE NEW FORMATION OTHER PHYSICAL CHANGE IN WELL (SPECIFY) _____ 7,240' TVD
 PLUG AND ABANDON CLEAN OUT AND REPLUG TARGET FORMATION: Marcellus Shale ESTIMATED DEPTH: 24,802' MD

WELL OPERATOR: HG Energy II Appalachia, LLC DESIGNATED AGENT: Diane C. White
ADDRESS: 5260 Dupont Road ADDRESS: 5260 Dupont Road
Parkersburg, WV 26101 Parkersburg, WV 26101

11,123' to Bottom Hole

5,367' to Top Hole

HG Energy II Appalachia, LLC
Well No. Schoen 1205 S-8H

Page 1 of 2

TOP LATITUDE 39 - 10 - 00
BTM LATITUDE 39 - 07 - 30



TOP HOLE LONGITUDE 80 - 20 - 00
BTM HOLE LONGITUDE 80 - 17 - 30
5,563' to Top Hole
6,674' to Bottom Hole

Notes: Well No. Schoen 1205 S-8H
UTM NAD 1983 (USSF)
Top Hole Coordinates
N: 14,218,431.91'
E: 1,824,095.14'
Landing Point Coordinates
N: 14,218,241.61'
E: 1,824,373.81'
Bottom Hole Coordinates
N: 14,202,192.92'
E: 1,830,279.33'

Legend

- Proposed gas well
- Well Reference, as noted
- Monument, as noted
- Existing Well, as noted
- Existing Plugged Well, as noted
- Digitized Well, as noted
- Creek or Drain
- Existing Road
- Surface boundary (approx.)
- Interior surface tracts (approx.)

Notes: Well No. Schoen 1205 S-8H
West Virginia Coordinate System of 1927, North Zone based upon Differential GPS Measurements.
Top Hole coordinates Bottom Hole coordinates
Latitude: 39°09'05.00" Latitude: 39°06'23.99"
Longitude: 80°21'08.15" Longitude: 80°19'51.15"
UTM Zone 17, NAD 1983
Top Hole Coordinates Bottom Hole Coordinates
N: 4,333,786.714m N: 4,328,837.060m
E: 555,985.311m E: 557,870.255m
Plat orientation and corner and well references are based upon the grid north meridian. Well location references are based upon the magnetic meridian.

GRID NORTH



I, the undersigned, hereby certify that this plat is correct to the best of my knowledge and belief and shows all the information required by law and the rules issued and prescribed by the Department of Environmental Protection.

Dwayne D. Matheny
Dwayne D. Matheny, P.S., 2070

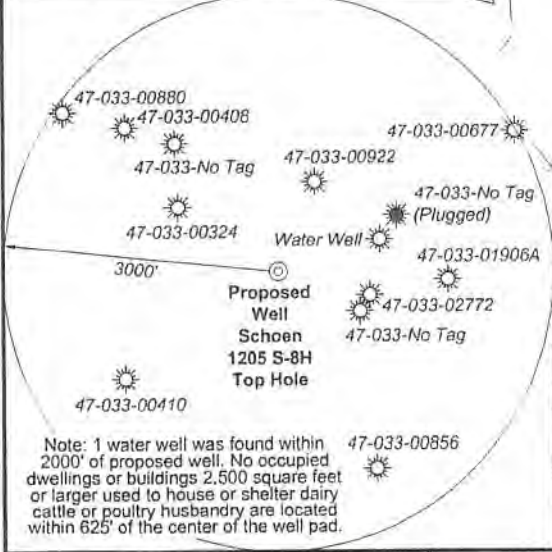

Tag	Bearing	Dist.
L1	S 70°59' E	1,526.3'
L2	S 56°31' E	1,300.3'
L3	N 87°54' W	1,224.8'
L4	N 71°53' W	992.8'
L5	S 55°40' E	337.5'

FILE NO: 32-36-G-19
DRAWING NO: Schoen 1205 S-8H Well Plat
SCALE: 1" = 2000'
MINIMUM DEGREE OF ACCURACY: Submeter
PROVEN SOURCE OF ELEVATION: CORS, Bridgeport, WV

STATE OF WEST VIRGINIA
DEPARTMENT OF ENVIRONMENTAL PROTECTION
OIL AND GAS DIVISION

DATE: December 30 2020
OPERATOR'S WELL NO. Schoen 1205 S-8H
API WELL NO
47 - 033 - 06002
STATE COUNTY PERMIT

WELL TYPE: OIL GAS LIQUID INJECTION WASTE DISPOSAL
(IF GAS) PRODUCTION: STORAGE DEEP SHALLOW
LOCATION: ELEVATION: 1,407.3' WATERSHED: Middle West Fork Creek
DISTRICT: Grant / Hackers Creek
SURFACE OWNER: George & Rosanne Schoen
ROYALTY OWNER: Willa Post Robey, et al
PROPOSED WORK: DRILL CONVERT DRILL DEEPER FRACTURE OR STIMULATE PLUG OFF OLD FORMATION
 PERFORATE NEW FORMATION OTHER PHYSICAL CHANGE IN WELL (SPECIFY)
 PLUG AND ABANDON CLEAN OUT AND REPLUG TARGET FORMATION: Marcellus Shale ESTIMATED DEPTH: 7,240' TVD 24,802' MD

WELL OPERATOR: HG Energy II Appalachia, LLC
ADDRESS: 5260 Dupont Road Parkersburg, WV 26101
DESIGNATED AGENT: Diane C. White
ADDRESS: 5260 Dupont Road Parkersburg, WV 26101

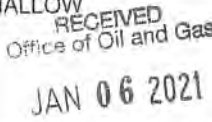



ID	Lease
1	A.B. Post, et al
4	Charlotte C. Gerlach
5	French S. Young, et al
6	Susan V. Curry & Ida M. Curry
9	L.D. & Addie Swisher
11	P.T. Allman
12	French S. Young, et al
14	M.M.F. & S.F. Randolph
19	Sidney & Virginia Haymond
20	Alcinda B. & M.E. Jackson
21	Patricia B. Smith, et al
64	Melvina E. Cookman
70	Mary Alkire
71	Allie & M.E. Jackson, et al

Harrison County				
No.	TM / Par	Owner	Bk / Pg	Ac.
1	447 / 2	George & Rosanne Schoen	1148 / 1059	65.00
2	447 / 3	George & Rosanne Schoen	1253 / 302	10.06
3	446 / 29	John F. McCuskey II, et al	1121 / 25	75.00
4	447 / 20	Richard & Janet Stout	1175 / 320	51.00
5	447 / 4.13	Richard & Janet Sprout	1389 / 669	5.04
6	447 / 21	Richard & Rebecca Sprout	1600 / 849	6.09
7	447 / 22	Daniel & Stacie Cooley	1310 / 1072	16.59
8	447 / 33	Joseph C. Queen	1349 / 508	20.00
9	447 / 34	Sharon K. Patsy J. Salate	1360 / 84	43.00
10	447 / 35	Kenneth Maxwell & Patricia Myers	1311 / 423	11.67
11	447 / 43	Betty J. & Isaac H. Maxwell III	1543 / 141	123.95
12	467 / 1	Margaret L. Gyimesi	1306 / 775	78.79
13	467 / 2	Jackson L. Smith	1378 / 976	95.16
14	467 / 1.1	Margaret Gyimesi	1306 / 775	1.45
15	467 / 30	William L. Randolph, et ux	1518 / 19	73.73
16	467 / 33.1	Eugene W. Hanby	1428 / 1	4.76
17	467 / 33.2	Charles R. Sutton	1472 / 181	1.03
18	467 / 33	Charles R. & Franklin L. Sutton	1472 / 181	39.20
19	467 / 34	Joseph M. Richards	1439 / 1234	9.15
20	467 / 36	Joseph M. Richards	1439 / 1234	73.93
21	467 / 52	David L. & Lisle C. Hinkle	1282 / 389	175.50
22	487 / 4.1	Catherine A. Mauro	1244 / 135	95.45
23	487 / 5	Kimberly & Terri Glaze Wriston Lewis County	W 83 / 97	129.62
24	10C / 11	Thomas C. Kennedy	W 3 / 428	92.50
25	10C / 16	Terri Smith Glaze	W 34 / 428	105.00
26	10C / 15	Thomas C. Kennedy	W 3 / 428	107.00

RECEIVED
Office of Oil and Gas
JAN 06 2021

WV DEPARTMENT of
Environmental Protection

RECEIVED
Office of Oil and Gas

JAN 06 2021

DEPARTMENT of
Environmental Protection

Wellhead Layout (NTS)

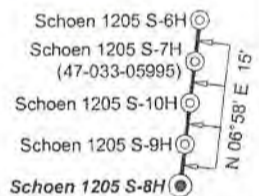

Well Location References
Not to Scale

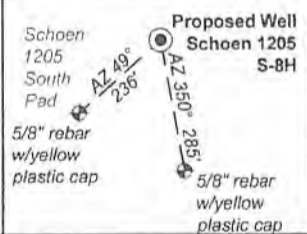

FILE NO: 32-36-G-19
DRAWING NO: Schoen 1205 S-8H Well Plat
SCALE: 1" = 2000'
MINIMUM DEGREE OF ACCURACY:
Submeter
PROVEN SOURCE OF ELEVATION:
CORS, Bridgeport, WV

STATE OF WEST VIRGINIA
DEPARTMENT OF ENVIRONMENTAL PROTECTION
OIL AND GAS DIVISION

DATE: December 30 2020
OPERATOR'S WELL NO. Schoen 1205 S-8H
API WELL NO
47 - 033 - 06002
STATE COUNTY PERMIT

WELL TYPE: OIL GAS LIQUID INJECTION WASTE DISPOSAL
(IF GAS) PRODUCTION: STORAGE DEEP SHALLOW

LOCATION: ELEVATION: 1,407.3' WATERSHED: Middle West Fork Creek

DISTRICT: Grant / Hackers Creek

SURFACE OWNER: George & Rosanne Schoen

ROYALTY OWNER: Willa Post Robey, et al

PROPOSED WORK: DRILL CONVERT DRILL DEEPER FRACTURE OR STIMULATE PLUG OFF OLD FORMATION

PERFORATE NEW FORMATION OTHER PHYSICAL CHANGE IN WELL (SPECIFY) _____

PLUG AND ABANDON CLEAN OUT AND REPLUG TARGET FORMATION: Marcellus Shale ESTIMATED DEPTH: 24,802' MD

Top: Mount Clare
QUADRANGLE: Btm: Berlin
COUNTY: Harrison / Lewis
ACREAGE: 65.00

WELL OPERATOR: HG Energy II Appalachia, LLC

DESIGNATED AGENT: Diane C. White

ADDRESS: 5260 Dupont Road
Parkersburg, WV 26101

ADDRESS: 5260 Dupont Road
Parkersburg, WV 26101