

5,493' to Bottom Hole
 2,076' to Top Hole
 BTM LATITUDE 39 - 07 - 30
 TOP LATITUDE 39 - 10 - 00

TOP LONGITUDE 80 - 22 - 30
 BTM LONGITUDE 80 - 20 - 00
 3,432' to Top Hole
 5,420' to Bottom Hole

Tag	Bearing	Dist.	Description
L1	N 80°20' W	3,375.2'	5/8" Rebar
L2	N 63°24' E	1,434.1'	47-033-00629
L3	S 83°36' E	2,978.2'	1" Iron pipe
L4	S 62°44' E	1,697.5'	47-033-01215

Notes:
 Well No. Antonio 1206 S-9H
 UTM NAD 1983 (USSF)
 Top Hole Coordinates
 N: 14,220,502.02'
 E: 1,815,558.70'
 Landing Point Coordinates
 N: 14,220,961.95'
 E: 1,817,570.86'
 Bottom Hole Coordinates
 N: 14,203,405.91'
 E: 1,824,084.19'

Notes: Well No. Antonio 1206 S-9H
 West Virginia Coordinate System of 1927, North Zone
 based upon Differential GPS Measurements.
 Top Hole coordinates Bottom Hole coordinates
 Latitude: 39°09'26.06" Latitude: 39°06'36.43"
 Longitude: 80°22'56.37" Longitude: 80°21'09.65"

UTM Zone 17, NAD 1983
 Top Hole Coordinates Bottom Hole Coordinates
 N: 4,334,417.685m N: 4,329,206.780m
 E: 553,383.399m E: 555,981.973m



I, the undersigned, hereby certify that this plat is correct to the best of my knowledge and belief and shows all the information required by law and the rules issued and prescribed by the Department of Environmental Protection.

Dwayne D. Matheny
 Dwayne D. Matheny, P.S. 2070

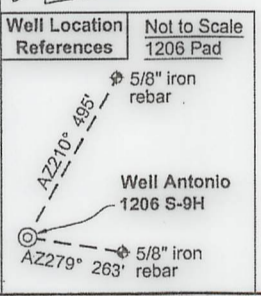
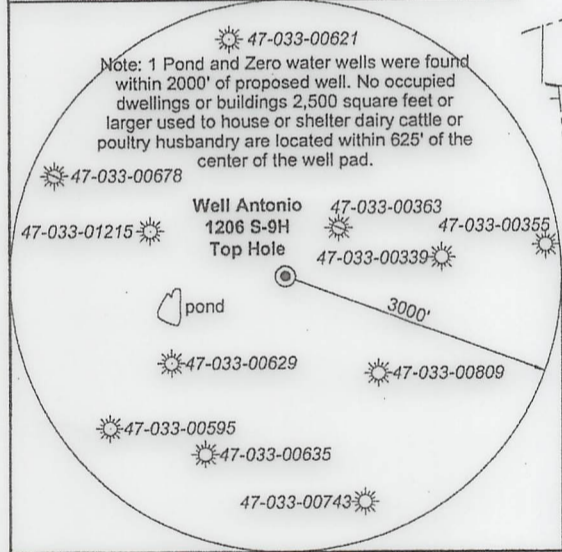

FILE NO: 06-36-12-G-H-19
 DRAWING NO: Antonio 1206 S-9H As-Drilled
 SCALE: 1" = 2000'
 MINIMUM DEGREE OF ACCURACY: Submeter
 PROVEN SOURCE OF ELEVATION: CORS, Bridgeport, WV

STATE OF WEST VIRGINIA
 DEPARTMENT OF ENVIRONMENTAL PROTECTION
OIL AND GAS DIVISION

DATE: November 22, 2021
 OPERATOR'S WELL NO. Antonio 1206 S-9H
 API WELL NO
 47 - 033 - 05986
 STATE COUNTY PERMIT

WELL TYPE: OIL GAS LIQUID INJECTION WASTE DISPOSAL
 (IF GAS) PRODUCTION: STORAGE DEEP SHALLOW
 LOCATION: ELEVATION: 1,350' WATERSHED: Middle West Fork Creek QUADRANGLE: West Milford
 DISTRICT: Grant COUNTY: Harrison
 SURFACE OWNER: Antonio P., LLC ACREAGE: 233.35
 ROYALTY OWNER: C. Earl Snider, et al LEASE NO: ACREAGE:
 PROPOSED WORK: DRILL CONVERT DRILL DEEPER FRACTURE OR STIMULATE PLUG OFF OLD FORMATION
 PERFORATE NEW FORMATION OTHER PHYSICAL CHANGE IN WELL (SPECIFY) 7,898' TVD
 PLUG AND ABANDON CLEAN OUT AND REPLUG TARGET FORMATION: Marcellus Shale ESTIMATED DEPTH: 26,647' MD

WELL OPERATOR: HG Energy II Appalachia, LLC DESIGNATED AGENT: Diane C. White
 ADDRESS: 5260 Dupont Road ADDRESS: 5260 Dupont Road
 Parkersburg, WV 26101 Parkersburg, WV 26101



Wellhead Layout
(Not to Scale)

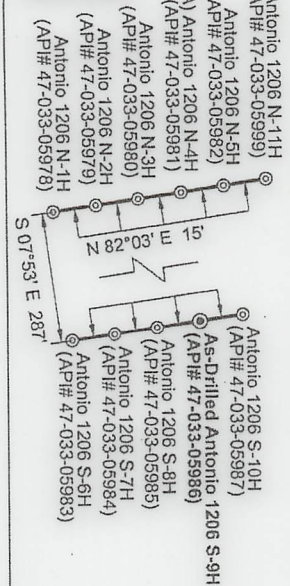

Harrison County - Grant Outside District				
No.	TM / Par	Owner	Bk / Pg	Ac.
1	426 / 71	Antonio P., LLC	1503 / 291	233.35
2	426 / 72	AL-N-EL Farms, Inc.	1623 / 1057	30.00
3	426 / 63	AL-N-EL Farms, Inc.	1623 / 1057	51.33
4	426 / 73	AL-N-EL Farms, Inc.	1623 / 1057	22.96
5	426 / 74	Harriet June Ferree, et al	1514 / 480	60.30
6	446 / 4	Bob R. Blankenship	1310 / 750	27.67
7	446 / 3	Antonio P., LLC	1503 / 291	200.00
8	446 / 23	Ann A. & William S. Davisson	1466 / 431	21.46
9	446 / 23.1	Ann A. & William S. Davisson	1405 / 277	5.00
10	446 / 6.2	Kenneth R. Maxwell	1548 / 896	0.97
11	446 / 23.2	Ann A. & William S. Davisson	1466 / 431	25.10
12	446 / 24	Robert N. Rector	1621 / 719	82.90
13	446 / 23.3	Greg G. & Cathy L. Burnside	1465 / 84	19.35
14	446 / 34	David & Daniel Curry	1451 / 987	97.41
15	446 / 48	AL-N-EL Farms, Inc.	1623 / 1057	98.75
16	446 / 47	AL-N-EL Farms, Inc.	1623 / 1057	27.00
17	446 / 44	Mary M. Myres	F112 / 625	0.23
18	446 / 45	Chad W. Owens	1546 / 721	0.20
19	446 / 46	Chad W. Owens	1546 / 721	0.31
20	466 / 17	AL-N-EL Farms, Inc.	1623 / 1057	43.38
21	466 / 18	AL-N-EL Farms, Inc.	1623 / 1057	82.50
22	466 / 37	AL-N-EL Farms, Inc.	1623 / 1057	11.50
23	466 / 36	AL-N-EL Farms, Inc.	1623 / 1057	50.00
24	466 / 38	AL-N-EL Farms, Inc.	1623 / 1057	123.00
25	466 / 70	Frank N. Wine Jr & III	1596 / 809	114.77
26	466 / 56	AL-N-EL Farms, Inc.	1623 / 1057	110.00
27	466 / 71	Joyce A. & Vernon D. Cochran, Jr.	1253 / 240	91.79
Lewis County - Hackers Creek District				
No.	TM / Par	Owner	Bk / Pg	Ac.
28	9C / 48	Everet Randolph	W28 / 236	12.11
29	9C / 40	Rose A. Kolb Irrev. Trust & John Hunter	769 / 157	101.25
30	9C / 41	Elizabeth J. Hicks	W26 / 481	47.37
31	9C / 38	Thomas C. Kennedy Testamentary Trust	W34 / 428	91.20
32	10C / 74	Myrtle B. Arbogast	W17 / 218	48.90
33	9C / 39	Rose A. Kolb Irrev. Trust & John Hunter	769 / 157	81.51

Legend	
⊙	Proposed gas well
⊕	Well Reference, as noted
⊗	Monument, as noted
☀	Existing Well, as noted
☀	Existing Plugged Well, as noted
☀	Digitized Well, as noted
—	Surface boundary (approx.)
- - -	Interior surface tracts (approx.)
- - -	Creek or Drain
- - -	Existing Road

ID	Lease
1	C. Earl Snider, et al
27	H.A. Boylen, et al
32	Alton Bell, et al
33	Alton Bell
34	Marcella R. Bond, et al
37	Lillie Gifford, et al
38	Lloyd Stout, et al
40	L.B. Davisson
44	Lucy Davisson
48	Allen M. Dyer, et al
51	Paul A. Davisson, et al
52	N.A. McWhorter, et al
56	Sopha McWhorter, et al
57	Alicinda B. Jackson, et vir
58	J.W.C. Kolb, et al
60	Brooks Randolph, et al

FILE NO: 06-36-12-G-H-19
DRAWING NO: Antonio 1206 S-9H As-Drilled
SCALE: 1" = 2000'
MINIMUM DEGREE OF ACCURACY:
Submeter
PROVEN SOURCE OF ELEVATION:
CORS, Bridgeport, WV

STATE OF WEST VIRGINIA
DEPARTMENT OF ENVIRONMENTAL PROTECTION
OIL AND GAS DIVISION

DATE: November 22 2021
OPERATOR'S WELL NO. Antonio 1206 S-9H
API WELL NO
47 - 033 - 05986
STATE COUNTY PERMIT

WELL TYPE: OIL GAS LIQUID INJECTION WASTE DISPOSAL
(IF GAS) PRODUCTION: STORAGE DEEP SHALLOW

LOCATION: ELEVATION: 1,350' WATERSHED: Middle West Fork Creek

QUADRANGLE: West Milford

DISTRICT: Grant

COUNTY: Harrison

SURFACE OWNER: Antonio P., LLC

ACREAGE: 233.35

ROYALTY OWNER: C. Earl Snider, et al

LEASE NO: ACREAGE:

PROPOSED WORK: DRILL CONVERT DRILL DEEPER FRACTURE OR STIMULATE PLUG OFF OLD FORMATION
 PERFORATE NEW FORMATION OTHER PHYSICAL CHANGE IN WELL (SPECIFY) _____ 7,898' TVD

PLUG AND ABANDON CLEAN OUT AND REPLUG TARGET FORMATION: Marcellus Shale ESTIMATED DEPTH: 26,647' MD

WELL OPERATOR: HG Energy II Appalachia, LLC

DESIGNATED AGENT: Diane C. White

ADDRESS: 5260 Dupont Road

ADDRESS: 5260 Dupont Road

Parkersburg, WV 26101

Parkersburg, WV 26101