

Tag	Bearing	Dist.
L1	S 88°58' E	2,891.0'
L2	S 70°57' E	1,523.3'
L3	N 76°00' W	3,500.4'
L4	N 52°46' E	1,524.0'
L5	S 75°57' W	1,475.2'

Notes:
 Well No. 1206 N-2H
 UTM NAD 1983 (USSF)
 Top Hole Coordinates
 N: 14,220,782.34'
 E: 1,815,489.63'
 Landing Point Coordinates
 N: 14,220,424.32'
 E: 1,814,058.49'
 Bottom Hole Coordinates
 N: 14,231,654.98'
 E: 1,810,089.99'

Notes: Well No. 1206 N-2H
 West Virginia Coordinate System of 1927, North Zone
 based upon Differential GPS Measurements.
 Top Hole coordinates
 Latitude: 39°09'28.83"
 Longitude: 80°22'57.22"
 Bottom Hole coordinates
 Latitude: 39°11'16.69"
 Longitude: 80°24'04.88"
 UTM Zone 17, NAD 1983
 Top Hole Coordinates
 N: 4,334,503.126m
 E: 553,362.346m
 Bottom Hole Coordinates
 N: 4,337,817.114m
 E: 551,716.592m
 Plat orientation and corner and well references are based upon the grid north meridian.
 Well location references are based upon the magnetic meridian.

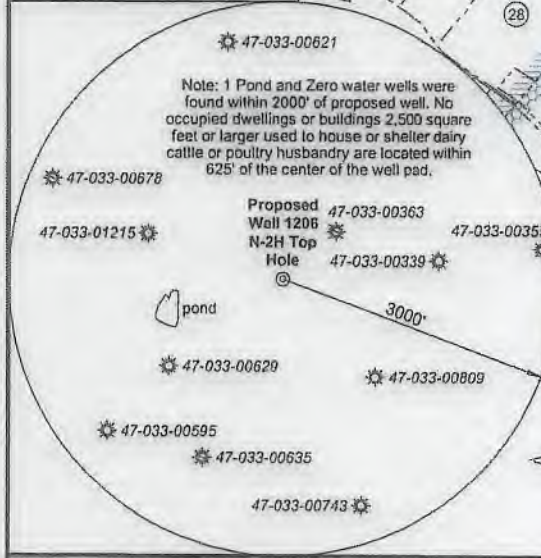

FILE NO: 06-36-12-G-H-19
 DRAWING NO: 1206 N-2H Well Plat
 SCALE: 1" = 1500'
 MINIMUM DEGREE OF ACCURACY:
 Submeter
 PROVEN SOURCE OF ELEVATION:
 CORS, Bridgeport, WV

STATE OF WEST VIRGINIA
 DEPARTMENT OF ENVIRONMENTAL PROTECTION
OIL AND GAS DIVISION

DATE: October 14 2019
 OPERATOR'S WELL NO. 1206 N-2H
 API WELL NO
 47 - 033 - 05979
 STATE COUNTY PERMIT

WELL TYPE: OIL GAS LIQUID INJECTION WASTE DISPOSAL
 (IF GAS) PRODUCTION: STORAGE DEEP SHALLOW
 LOCATION: ELEVATION: 1,350' WATERSHED: Middle West Fork Creek
 DISTRICT: Grant QUADRANGLE: West Milford
 COUNTY: Harrison
 SURFACE OWNER: Charles R. & Franklin L. Sutton ACREAGE: 30.00
 ROYALTY OWNER: Charles R. Sutton LEASE NO: ACREAGE: 30.00
 PROPOSED WORK: DRILL CONVERT DRILL DEEPER FRACTURE OR STIMULATE PLUG OFF OLD FORMATION
 PERFORATE NEW FORMATION OTHER PHYSICAL CHANGE IN WELL (SPECIFY) _____ 7,252' TVD
 PLUG AND ABANDON CLEAN OUT AND REPLUG TARGET FORMATION: Marcellus Shale ESTIMATED DEPTH: 19,901' MD

WELL OPERATOR: HG Energy II Appalachia, LLC DESIGNATED AGENT: Diane C. White
 ADDRESS: 5260 Dupont Road ADDRESS: 5260 Dupont Road
 Parkersburg, WV 26101 Parkersburg, WV 26101

No.	TM / Par	Owner	Bk / Pg	Ac.
1	426 / 72	Charles R. & Franklin L. Sutton	1301 / 98	30.00
2	446 / 3	Antonio P. LLC	1503 / 291	200.00
3	426 / 71	Antonio P. LLC	1503 / 291	233.35
4	446 / 2	Antonio P. LLC	1503 / 291	43.90
5	446 / 1	Antonio P. LLC	1503 / 291	24.10
6	425 / 30.1	James W. & Susan A. Freeman	1139 / 386	30.00
7	425 / 30	Earl H. & Melissa J. Graham	1337 / 366	21.39
8	425 / 23.6	Joshua D. Messenger, et ux	1425 / 1133	8.50
9	425 / 23	George P. Koutsobanis, et ux	--- / ---	2.76
10	425 / 23.5	Rhonda R. & George P. Koutsobanis	1411 / 1231	0.29
11	425 / 23.3	Rhonda R. & George P. Koutsobanis	1420 / 93	0.54
12	425 / 29.1	Rhonda R. & George P. Koutsobanis	1420 / 93	0.27
13	425 / 23.4	Marlene & Robert V. Shepherd	1201 / 12	0.80
14	425 / 29	Marva Shepherd	W166 / 413	53.04
15	425 / 22	Duck Creek Mission Church Trust	1024 / 964	0.912
16	425 / 21	Judith H. Russell	1212 / 1074	15.26
17	425 / 20	Jeffery L. & Parry S. Harvey	1394 / 607	3.00
18	425 / 19	Antonio P. LLC	1503 / 291	31.00
19	425 / 10	Joy L. Jarrett	1272 / 348	9.60
20	425 / 11.1	Linda Snyder	1124 / 768	5.12
21	425 / 11	Linda Snyder	1124 / 768	6.29
22	425 / 18	Antonio P. LLC	1503 / 291	46.00
23	425 / 17	Antonio P. LLC	1503 / 291	48.00
24	426 / 38	Antonio P. LLC	1503 / 291	50.75
25	426 / 37	Antonio P. LLC	1503 / 291	54.00
26	426 / 13	Antonio P. LLC	1503 / 291	149.74
27	425 / 16	Antonio P. LLC	1503 / 291	122.25
28	425 / 12	Antonio P. LLC	1503 / 291	42.30
29	425 / 14	WVDNR	W85 / 624	73.60
30	425 / 15	WVDNR	W85 / 624	40.85
31	405 / 81	WVDNR	W85 / 624	42.00
32	405 / 82	Jim K. Stuller	1563 / 89	206.52
33	405 / 86	Antonio P. LLC	1503 / 291	33.00
34	405 / 74	Mary Lou Smith	W117 / 1179	107.76
35	405 / 73	Mary Lou Smith	W117 / 1179	45.00
36	405 / 62.2	Danny Joe Miller	1521 / 1108	9.93
37	405 / 62	Evelyn Marie Ward, LE	--- / ---	56.18
38	405 / 63.8	Kimberly K. & John T. Lough	1518 / 822	80.25
39	405 / 64	Robert M. Lewis, Jr.	1518 / 814	62.26
40	405 / 65.1	Kernit P. & Deborah B. Stuller	1181 / 306	20.65
41	405 / 64.1	Tracy L. Davis	1443 / 766	8.20
42	405 / 64.6	Edward G. Lewis (LE)	1394 / 367	0.82
43	405 / 49	Connie J. & Robert M. Lewis, Jr.	1221 / 898	12.12
44	405 / 48	Connie J. & Robert M. Lewis, Jr.	1518 / 814	13.20
45	405 / 47	Robin Ann Stark	1518 / 809	14.06
46	405 / 63.4	Kimberly K. & John T. Lough	1518 / 822	5.27
47	405 / 41.6	Linger Consulting LLC	1538 / 770	4.59
48	405 / 41	Luella Cayton, et al	--- / ---	1.20
49	405 / 86	Shirley E. Everett (LE)	1139 / 416	0.84
50	405 / 41.5	Carole & Robert L. Norton, Jr.	1474 / 616	1.02
51	405 / 41.4	Christopher S. Cullip & Ashley N. Mullooly	1464 / 1184	9.90
52	405 / 50	Connie J. & Robert M. Lewis, Jr.	1518 / 814	16.22
53	405 / 51	Connie J. & Robert M. Lewis, Jr.	1518 / 814	0.80

ID	Lease
1	A.C. Thrasher, et al
2	Hiram E. Edmonds, et al
3	C. Earl Snider, et al
4	Alton Bell, et al
5	Alton Bell
16	Lewis M. Stout, et al
18	H.D. Smith, et al
19	Suzanne D. Simmons, et al
20	Mae Gaston, et al
21	Charles H. Gaston, et al
22	Rachel S. Hershey, et al
23	Rachel S. Hersthey, et al
24	Mary A. Lowther, et al
25	Porter Maxwell, et al
42	Hattie O. West, et al
43	Petitto Brothers, Inc.
44	Jettie Cox, et al
45	Robert & Betty Stevenson, et al
46	Roscoe Aliman, et ux
47	WV Division of Natural Resources
54	Creed W. Snider, et al
55	Lloyd Stout

FILE NO: 06-36-12-G-H-19
DRAWING NO: 1206 N-2H Well Plat
SCALE: 1" = 1500'
MINIMUM DEGREE OF ACCURACY:
Submeter
PROVEN SOURCE OF ELEVATION:
CORS, Bridgeport, WV

STATE OF WEST VIRGINIA
DEPARTMENT OF ENVIRONMENTAL PROTECTION
OIL AND GAS DIVISION

DATE: October 14 2019
OPERATOR'S WELL NO. 1206 N-2H
API WELL NO
47 - 033 - 05979
STATE COUNTY PERMIT

WELL TYPE: OIL GAS LIQUID INJECTION WASTE DISPOSAL
(IF GAS) PRODUCTION: STORAGE DEEP SHALLOW

LOCATION: ELEVATION: 1,350' WATERSHED: Middle West Fork Creek
DISTRICT: Grant

QUADRANGLE: West Milford
COUNTY: Harrison
ACREAGE: 30.00

SURFACE OWNER: Charles R. & Franklin L. Sutton
ROYALTY OWNER: Charles R. Sutton

LEASE NO: _____ ACREAGE: 30.00

PROPOSED WORK: DRILL CONVERT DRILL DEEPER FRACTURE OR STIMULATE PLUG OFF OLD FORMATION
 PERFORATE NEW FORMATION OTHER PHYSICAL CHANGE IN WELL (SPECIFY) _____
 PLUG AND ABANDON CLEAN OUT AND REPLUG TARGET FORMATION: Marcellus Shale ESTIMATED DEPTH: 7,252' TVD
19,901' MD

WELL OPERATOR: HG Energy II Appalachia, LLC
ADDRESS: 5260 Dupont Road
Parkersburg, WV 26101

DESIGNATED AGENT: Diane C. White
ADDRESS: 5260 Dupont Road
Parkersburg, WV 26101