

7,883' to Top Hole

3,013' to Bottom Hole

HG Energy II Appalachia, LLC  
Well No. Neel 1207 N-3H  
As-Drilled

Page 1 of 2

I, the undersigned, hereby certify that this plat is correct to the best of my knowledge and belief and shows all the information required by law and the rules issued and prescribed by the Department of Environmental Protection.

Dwayne D. Matheny, P.S. 2070

Notes: Well No. Neel 1207 N-3H West Virginia Coordinate System of 1927, North Zone based upon Differential GPS Measurements. Top Hole coordinates Latitude: 39°09'07.91" Longitude: 80°24'10.10" Bottom Hole coordinates Latitude: 39°11'45.19" Longitude: 80°25'38.29" UTM Zone 17, NAD 1983 Top Hole Coordinates N: 4,333,846.534m E: 551,617.358m Bottom Hole Coordinates N: 4,338,681.019m E: 549,469.990m Plat orientation and corner and well references are based upon the grid north meridian. Well location references are based upon the magnetic meridian.

BTM LATITUDE 39 - 12 - 30  
TOP LATITUDE 39 - 10 - 00



TOP LONGITUDE 80 - 22 - 30  
BTM LONGITUDE 80 - 25 - 00

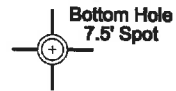

5,268' to Top Hole

Notes:  
Well No. Neel 1207 N-3H UTM NAD 1983 (USSF)  
Top Hole Coordinates N: 14,218,628.17" E: 1,809,764.61"  
Landing Point Coordinates N: 14,218,198.99" E: 1,808,509.09"  
Bottom Hole Coordinates N: 14,234,489.31" E: 1,802,719.46"

5"x9"x7" stone w/ 3 hack marks

Legend

- Proposed gas well
- Well Reference, as noted
- Monument, as noted
- Existing Well, as noted
- Existing Plugged Well, as noted
- Digitized Well, as noted
- Creek or Drain
- Existing Road
- Surface boundary (approx.)
- Interior surface tracts (approx.)



ID	Lease
2	A.J. Smith, et ux
3	Dora B. McWhorter, et al
8	Charles H. Gaston, et al
9	Leeman Maxwell, et al
11	Camella Y. Morris, et al
12	WV Conservation Committee
15	Hiram J. Burnside
20	Union National Bank, et al
22	Vance Ward, et al
24	Zina M. Davis, et al

Notes: 1 water well was found within 2000' of proposed well. No occupied dwellings or buildings 2,500 square feet or larger used to house or shelter dairy cattle or poultry husbandry are located within 625' of the center of the well pad.

Tag	Bearing	Dist.
L1	S 00°19' E	1,179.3'
L2	S 23°17' W	1,312.3'
L3	S 83°35' W	2,154.1'
L4	N 59°39' W	1,165.0'

FILE NO: 296-36-G-18  
DRAWING NO: 1207 Neel N-3H ASWP  
SCALE: 1" = 2000'  
MINIMUM DEGREE OF ACCURACY: Submeter  
PROVEN SOURCE OF ELEVATION: CORS, Bridgeport, WV

STATE OF WEST VIRGINIA  
DEPARTMENT OF ENVIRONMENTAL PROTECTION  
OIL AND GAS DIVISION

DATE: April 14 20 21  
OPERATOR'S WELL NO. Neel 1207 N-3H  
API WELL NO  
47 - 033 - 05970  
STATE COUNTY PERMIT

WELL TYPE:  OIL  GAS  LIQUID INJECTION  WASTE DISPOSAL  
(IF GAS) PRODUCTION:  STORAGE  DEEP  SHALLOW

LOCATION: ELEVATION: 1,344' WATERSHED: Middle West Fork Creek QUADRANGLE: West Milford  
DISTRICT: Grant / Union COUNTY: Harrison  
SURFACE OWNER: HG Energy II Appalachia, LLC ACREAGE: 103.07  
ROYALTY OWNER: Dora B. McWhorter, et al LEASE NO: ACREAGE: 103.00  
PROPOSED WORK:  DRILL  CONVERT  DRILL DEEPER  FRACTURE OR STIMULATE  PLUG OFF OLD FORMATION  
 PERFORATE NEW FORMATION  OTHER PHYSICAL CHANGE IN WELL (SPECIFY) 7,247' TVD  
 PLUG AND ABANDON  CLEAN OUT AND REPLUG TARGET FORMATION: Marcellus Shale ESTIMATED DEPTH: 24,858' MD

WELL OPERATOR: HG Energy II Appalachia, LLC DESIGNATED AGENT: Diane C. White  
ADDRESS: 5260 Dupont Road ADDRESS: 5260 Dupont Road  
Parkersburg, WV 26101 Parkersburg, WV 26101

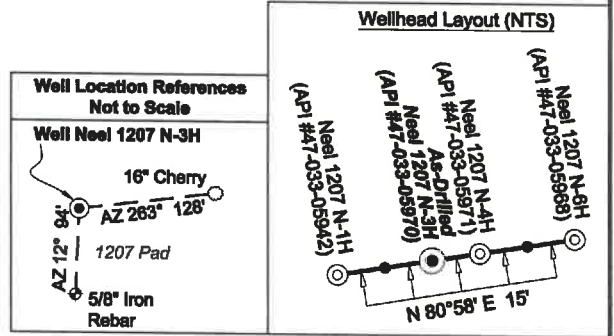

No.	TM / Par	Ac.	Owner	Bk / Pg
1	445 / 5	89.07	HG Energy II Appalachia, LLC	— / —
2	445 / 13	132.852	Mickey Potitto	WB175 / 1153
3	445 / 3	64.00		
4	445 / 12	64.50	Lisa M. Nutter	WB687 / 445
5	445 / 5.1	3.38	David W. Lohr	1531 / 421
6	425 / 28	32.30	WV State Conservation Commission	WB33 / 148
7	445 / 2	84.57	Lisa M. Nutter	WB687 / 445
8	445 / 25	194.90		
9	445 / 24	19.80	Linda J. Maxwell Revocable Trust	1302 / 793
10	425 / 5	173.80		
	425 / 7	5.50	WV State Conservation Commission	WB33 / 148
11	445 / 25.2	83.199		
	425 / 4	4.35	Laurinda R. Beckstead	1420 / 941
12	425 / 4.4	1.99	Robert W. & Jennifer L. Delaney	1501 / 21
13	425 / 25.1	5.45		1284 / 1121
14	425 / 4.2	3.14		
15	425 / 4.1	2.02	Paul R. & Linda R. Beatty	
16	425 / 3	14.00		1286 / 489
17	405 / 76	57.68	WV State Conservation Commission	WB33 / 148
18	405 / 75	202.18	William Michael McDonald	1377 / 99
19	425 / 4.3	30.50	Laurinda Raye Beckstead	1177 / 651
20	405 / 87	38.10	Terence L. Washburn, et al	1436 / 989
21	405 / 59	43.40	Terence L. Washburn	1294 / 433
22	405 / 89	62.35	James D. McWhorter	— / —
23	405 / 61	12.00		
24	405 / 60	18.12	Samuel S. Stark	1327 / 1048
25	406 / 68	2.47	James D. McWhorter	1505 / 1158
26	385 / 81	85.50	Buffalo Lake Development, LLC	1526 / 585
27	405 / 4	20.17	Betty Jo & Kyle Fridley	1233 / 244
28	405 / 89.3	4.0	Jeremy T. & Erin N. Bowers	1497 / 897
29	405 / 1.4	25.07		
30	405 / 1.3	10.48	Joseph Workman	1377 / 1131
31	405 / 89.1	0.72	Roberta K. Cottrill	1178 / 739
32	405 / 6	21.93	James Ivan McDonald	1373 / 505
33	405 / 4	20.17	Betty Jo & Kyle Fridley	1347 / 1133
34	405 / 62	58.24	Evelyn M. Ward LE	1233 / 244
35	405 / 5	6.05	James Ivan McDonald	— / —
36	405 / 1	0.94	Brandon T. Leary	1229 / 370
37	405 / 8	10.19	Larry W. & Dorothy L. Detamore	1498 / 749
38	405 / 8.1	1.06		1196 / 714
39	405 / 8.2	0.52	George F. & Helen M. Peterson	1379 / 1146
40	405 / 26.1	0.88	William & Cynthia Marsh	1410 / 1060
41	405 / 26.2	0.74	Eugene D. Wilson	1139 / 446
42	405 / 26.4	0.405		957 / 247
43	405 / 26.6	0.140	John & Linda Cathell	980 / 697
44	405 / 26	3.759	Margaret L. Phillips	1101 / 779
45	405 / 62.1	74.30	John & Mary Stenger	1177 / 635
46	405 / 4.1	0.94	James Ivan McDonald	1402 / 334
47	405 / 70	3.452		1229 / 370
48	405 / 70.1	3.452	Michael A. & Carleen	1527 / 649
49	405 / 71	2.97	Eugene & Violet A. Debarr	1109 / 97
50	405 / 71.1	1.485	Kathy D. Bennett	1109 / 97
51	405 / 62.10	2.06	Danny J. & Deborah J. Miller	1505 / 8
52	405 / 62.6	2.63	Michael T. Jr & Ramona J. Morris	1527 / 376

No.	TM / Par	Ac.	Owner	Bk / Pg
51	405 / 62.3	1.28	Wayne & Naomi McHenry	1537 / 486
52	405 / 72	4.32	Sandra W. & Willard Miller	1031 / 654
53	405 / 72.1	4.32	Melissa Barker	1403 / 68
	405 / 62.4	0.99		1336 / 890
54	405 / 62.7	0.48	Tricia A. & Jeremy L. Dobbins	1452 / 340
	405 / 62.9	0.74		1476 / 953
	405 / 73	45.00		WB177 / 1179
55	405 / 74	107.76	Mary Lou Smith	WB177 / 1179
	405 / 80	90.97		WB177 / 1179
	405 / 81	42.00		
56	425 / 6	105.55	WV Dept. of Natural Resources	WB85 / 624
	425 / 14	73.60		
	425 / 15	40.85		
57	425 / 13	9.00	Penny L. Hill	1481 / 53
58	425 / 5	61.50	WV State Conservation Comm.	WB33 / 148
59	425 / 8	151.09	James L. Sellers Family Revocable Trust	1480 / 728
	425 / 8.1	13.481		
60	425 / 27	26.40	Marva Sheperd	WB166 / 413
	425 / 28	19.92		
61	425 / 12	42.30		
	425 / 18	122.25	Antonio P. LLC	1503 / 291
	425 / 17	48.00		
62	425 / 11	6.29		
	425 / 11.1	5.12	Linda Snyder	1124 / 768
63	425 / 10	9.60	Joy L. Jarrett	1272 / 348
64	425 / 10.1	3.10	Robert R. & Debbie A Partain	1308 / 653
65	425 / 9	3.88	Leslie S. Riggleman	WB127 / 680
66	425 / 8.3	1.408	Melanie S. & Jay A. Morris	1386 / 660
67	425 / 8.2	0.39	Linda & Mark Wilfong	1438 / 83
68	425 / 20	3.00	Jeffery L. & Parry S. Harvey	1394 / 607
69	425 / 21	15.28	Juddith H. Russell	1212 / 1074
70	425 / 22	1.00	Duck Creek Mission Church Trust	1024 / 984
71	425 / 9.1	4.22	Sharon Campbell	1374 / 1083
72	425 / 9.2	4.66	Michael & Cecilia Daughtery	1543 / 1305
73	385 / 82.1	10.05	Lloyd W. Brake Jr. Trust	1427 / 141
74	405 / 6	21.93	James Ivan McDonald	1347 / 113
75	405 / 83	1.01	Pamela M. Puddister	1277 / 279
76	405 / 83.2	42.47	Larry D. Meyers Revocable Trust	W191 / 1279
77	405 / 83.6	42.47	John P. & Virginia R. Markley	1353 / 1084
78	405 / 83.7	1.00	Robert J. Jr. & Joyce B. Markley	1560 / 310
79	405 / 83.5	4.00	Charles F. & Dawn L. Grow	1485 / 523
80	405 / 63.10	4.00	Kimberly K. & John T. Lough	1518 / 822
81	425 / 23.3	0.54		
	425 / 29.1	0.27	Rhonda R. & George P. Koutsobaris	1420 / 93
82	405 / 28	2.80	David Allen Bunch	W173 / 1273
83	405 / 27	1.04	Betty Fridley	W160 / 268
84	405 / 26.8	1.04		
	405 / 89	3.50	Megan & Chad Fincham	1524 / 645

FILE NO: 296-36-G-18  
 DRAWING NO: 1207 Neel N-3H ASWP  
 SCALE: 1" = 2000'  
 MINIMUM DEGREE OF ACCURACY: Submeter  
 PROVEN SOURCE OF ELEVATION: CORS, Bridgeport, WV

**STATE OF WEST VIRGINIA**  
 DEPARTMENT OF ENVIRONMENTAL PROTECTION  
**OIL AND GAS DIVISION**

DATE: April 14 20 21  
 OPERATOR'S WELL NO. Neel 1207 N-3H  
 API WELL NO  
47 — 033 — 05970  
 STATE COUNTY PERMIT

WELL TYPE:  OIL  GAS  LIQUID INJECTION  WASTE DISPOSAL  
 (IF GAS) PRODUCTION:  STORAGE  DEEP  SHALLOW

LOCATION: ELEVATION: 1,344' WATERSHED: Middle West Fork Creek QUADRANGLE: West Milford  
 DISTRICT: Grant / Union COUNTY: Harrison  
 SURFACE OWNER: HG Energy II Appalachia, LLC ACREAGE: 89.07  
 ROYALTY OWNER: Dora B. McWhorter, et al LEASE NO: \_\_\_\_\_ ACREAGE: 103.00  
 PROPOSED WORK:  DRILL  CONVERT  DRILL DEEPER  FRACTURE OR STIMULATE  PLUG OFF OLD FORMATION  
 PERFORATE NEW FORMATION  OTHER PHYSICAL CHANGE IN WELL (SPECIFY) \_\_\_\_\_ 7,247' TVD  
 PLUG AND ABANDON  CLEAN OUT AND REPLUG TARGET FORMATION: Marcellus Shale ESTIMATED DEPTH: 24,858' MD

WELL OPERATOR: HG Energy II Appalachia, LLC DESIGNATED AGENT: Diane C. White  
 ADDRESS: 5260 Dupont Road ADDRESS: 5260 Dupont Road  
Parkersburg, WV 26101 Parkersburg, WV 26101