

4,392' to Bottom Hole
2,220' to Top Hole

BTM LATITUDE 39 - 12 - 30
TOP LATITUDE 39 - 10 - 00

Tag	Bearing	Dist.
L1	N 88°22' W	1,344.8'
L2	N 66°01' W	1,184.3'
L3	S 38°29' E	1,199.0'
L4	S 22°44' E	1,206.3'
L5	N 62°22' E	1,842.0'

ID	Lease
1	Jerome B. Gusman
6	Leeman B. Maxwell Heirs
7	Leeman Maxwell, et ux
9	Rebecca F. Reed, et al
10	Rebecca D. Reed, et al
14	Joseph Chauvront, et al
15	Howard W. Vanscoy, et al
16	Howard W. Vanscoy, et al
18	George W. Washburn, et al
19	Lloyd Washburn, et al



I, the undersigned, hereby certify that this plat is correct to the best of my knowledge and belief and shows all the information required by law and the rules issued and prescribed by the Department of Environmental Protection.

Dwayne D. Matheny, P.S. 2070

05/10/2019

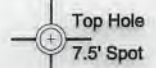

SEAL

Legend

- ⊙ Proposed gas well
- ⊙ Well Reference, as noted
- ⊙ Monument, as noted
- ⊙ Existing Well, as noted
- ⊙ Existing Plugged Well, as noted
- ⊙ Digitized Well, as noted
- Creek or Drain
- Existing Road
- Surface boundary (approx.)
- Interior surface tracts (approx.)

Notes:
Well No. 1208 N-5H
UTM NAD 1983 (USSF)
Top Hole Coordinates
N: 14,218,999.46' E: 1,803,613.12'
Landing Point Coordinates
N: 14,219,853.79' E: 1,805,245.03'
Bottom Hole Coordinates
N: 14,230,835.74' E: 1,801,364.41'

Notes: Well No. 1208 N-5H
West Virginia Coordinate System of 1927, South Zone based upon Differential GPS Measurements.
Top Hole coordinates Bottom Hole coordinates
Latitude: 39°09'11.98" Latitude: 39°11'09.15"
Longitude: 80°25'28.18" Longitude: 80°25'55.80"
UTM Zone 17, NAD 1983
Top Hole Coordinates Bottom Hole Coordinates
N: 4,333,959.703m N: 4,337,567.409m
E: 549,742.379m E: 549,056.970m
Plat orientation and corner and well references are based upon the grid north meridian.
Well location references are based upon the magnetic meridian.

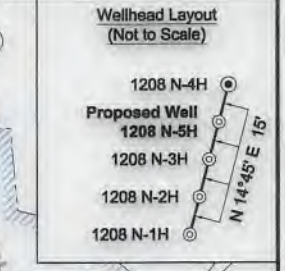
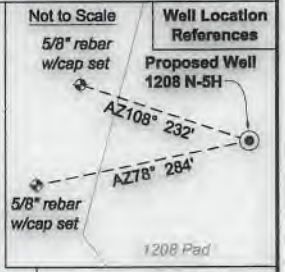
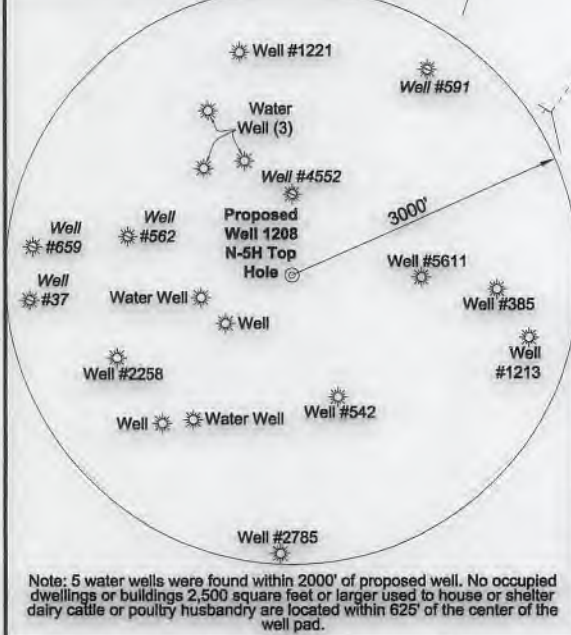

FILE NO: 195-36-G-18
DRAWING NO: 1208 N-5H Well Plat
SCALE: 1" = 1500'
MINIMUM DEGREE OF ACCURACY: Submeter
PROVEN SOURCE OF ELEVATION: CORS, Bridgeport, WV

STATE OF WEST VIRGINIA
DEPARTMENT OF ENVIRONMENTAL PROTECTION
OIL AND GAS DIVISION

DATE: January 24 20 19
OPERATOR'S WELL NO. 1208 N-5H
API WELL NO. **H6A**
47 - 033 - 0597
STATE COUNTY PERMIT

WELL TYPE: OIL GAS LIQUID INJECTION WASTE DISPOSAL
(IF GAS) PRODUCTION: STORAGE DEEP SHALLOW

LOCATION: ELEVATION: 1,149' WATERSHED: Middle West Fork Creek
DISTRICT: Grant / Union
SURFACE OWNER: Linda & William W. Brodwater III
ROYALTY OWNER: Leeman B. Maxwell Heirs, et al LEASE NO: _____ ACREAGE: 247.84
PROPOSED WORK: DRILL CONVERT DRILL DEEPER FRACTURE OR STIMULATE PLUG OFF OLD FORMATION
 PERFORATE NEW FORMATION OTHER PHYSICAL CHANGE IN WELL (SPECIFY) _____ 7,050' TVD
 PLUG AND ABANDON CLEAN OUT AND REPLUG TARGET FORMATION: Marcellus Shale ESTIMATED DEPTH: 19,518' MD

WELL OPERATOR: HG Energy II Appalachia, LLC DESIGNATED AGENT: Diane C. White
ADDRESS: 5260 Dupont Road ADDRESS: 5260 Dupont Road
Parkersburg, WV 26101 Parkersburg, WV 26101

05/10/2019

No.	TM / Par	Owner	Bk / Pg	Ac.
35	404 / 17.1	Dameon Tyler Hall	1556 / 320	0.75
34	404 / 19	Terry Weldon & Regina T. Tallman	1357 / 569	3.56
33	404 / 18	Russell A. Suder	1113 / 88	2.02
32	404 / 17	Mary Jo Short	808 / 456	0.83
31	404 / 16.1		761 / 822	1.82
30	404 / 16.2	Richard Vance Short	1262 / 155	0.06
29	404 / 16	Jeffrey & Victoria J. Roark	1518 / 173	3.08
28	404 / 22	John L. & Mary Beth Stenger	1280 / 455	70.90
27	405 / 59	Terence L. Washburn	1294 / 433	43.40
26	404 / 34	Callwell J. & Patricia F. Hutson	1209 / 163	11.00
25	404 / 35	Bruce W. & Luella R. Cayton	1029 / 339	12.80
24	404 / 36	Dennis J. Bunside	1326 / 149	16.30
23	404 / 37	Larry & Rebecca Myers	WB146 / 1089	18.10
22	404 / 55			54.74
21	404 / 38	Rebecca D. Arther	1504 / 1251	34.48
20	404 / 56	Jacob Walter & Karen A. Post	1350 / 1076	5.50
19	405 / 75	William Michael McDonald	1377 / 99	202.18
18	425 / 1	Joel B. Shuman, et al	WB166/472	89.00
17	425 / 25.4	Ronald L. & Mary Jo Hitt	1193 / 304	4.55
16	425 / 2.1	Del Marie Brenn	1339 / 100	7.40
15	425 / 2	Lonzo A. & Erica Martin	1569 / 1076	5.035
14	425 / 25.2	Laurinda R. Beckstead	1420 / 941	83.199
13	425 / 2.2	Jennifer Irene McWhorter	1422 / 1117	26.66
12	425 / 33	David A. & Julie Keesucker	1262 / 81	34.70
11	425 / 33.4	David J. & Angeena K. Keesucker	1439 / 457	3.01
10	425 / 33.3	Earl Milton Jenkins	1285 / 521	2.00
9	425 / 24	Linda J. Maxwell Revocable Trust	1302 / 793	19.60
8	425 / 25			212.80
7	425 / 31.3	Gary S. & Melinda M. Brodwater	1354 / 175	2.00
6	425 / 31.1	Dona R. & David R. Scarff	1360 / 652	1.00
5	425 / 31.2	Linda & William W. Brodwater III	1343 / 1279	1.16
4	445 / 1		- / -	87.78
3	445 / 10	Lisa M. Nutter	WB 687 / 445	66.87
2	445 / 2			84.57
1	425 / 31	Linda & William W. Brodwater III	1410 / 1045	247.84

FILE NO: 195-36-G-18
DRAWING NO: 1208 N-5H Well Plat
SCALE: 1" = 1500'
MINIMUM DEGREE OF ACCURACY:
Submeter
PROVEN SOURCE OF ELEVATION:
CORS, Bridgeport, WV

STATE OF WEST VIRGINIA
DEPARTMENT OF ENVIRONMENTAL PROTECTION
OIL AND GAS DIVISION

DATE: January 24 20 19
OPERATOR'S WELL NO. 1208 N-5H
API WELL NO
47 - 033 - *H6A*
STATE COUNTY PERMIT *05957*

WELL TYPE: OIL GAS LIQUID INJECTION WASTE DISPOSAL
(IF GAS) PRODUCTION: STORAGE DEEP SHALLOW

LOCATION: ELEVATION: 1,149' WATERSHED: Middle West Fork Creek

QUADRANGLE: West Milford

DISTRICT: Grant / Union

COUNTY: Harrison

SURFACE OWNER: Linda & William W. Brodwater III

ACREAGE: 200

ROYALTY OWNER: Leeman B. Maxwell Heirs, et al

LEASE NO: _____ ACREAGE: 247.84

PROPOSED WORK: DRILL CONVERT DRILL DEEPER FRACTURE OR STIMULATE PLUG OFF OLD FORMATION
 PERFORATE NEW FORMATION OTHER PHYSICAL CHANGE IN WELL (SPECIFY) _____ 7,050' TVD

PLUG AND ABANDON CLEAN OUT AND REPLUG TARGET FORMATION: Marcellus Shale ESTIMATED DEPTH: 19,518' MD

WELL OPERATOR: HG Energy II Appalachia, LLC

DESIGNATED AGENT: Diane C. White

ADDRESS: 5260 Dupont Road
Parkersburg, WV 26101

ADDRESS: 5260 Dupont Road
Parkersburg, WV 26101