

T.H. LATITUDE 39°15'00"
B.H. LATITUDE 39°17'30"

ARSENAL RESOURCES PRITT SOUTH 212

T.H. 1,918' T.H.

(S.P.C. NORTH ZONE) (UTM(M) ZONE 17 NORTH)

NAD'83 S.P.C.(FT)	N. 271,995.9	E. 1,774,058.0
NAD'83 GEO.	LAT-(N) 39.244735	LONG-(W) 80.186560
NAD'83 UTM (M)	N. 4,344,250.9	E. 570,194.4

LANDING POINT

NAD'83 S.P.C.(FT)	N. 272,431.7	E. 1,773,598.9
NAD'83 GEO.	LAT-(N) 39.245922	LONG-(W) 80.188193
NAD'83 UTM (M)	N. 4,344,381.3	E. 570,052.3

BOTTOM HOLE

NAD'83 S.P.C.(FT)	N. 279,212.6	E. 1,771,264.5
NAD'83 GEO.	LAT-(N) 39.264489	LONG-(W) 80.196621
NAD'83 UTM (M)	N. 4,346,435.4	E. 569,306.7

T.H. LONGITUDE 80°10'00"
B.H. LONGITUDE 80°10'00"

TAG	SURFACE OWNER	TAX MAP / PCL	ACREAGE
A	IRA H. & LAURA E. PRITT	351-4	69.09±
B	O. L. WARDER ET AL.	351-7	47.40±
C	IRA H. & LAURA E. PRITT	351-2	18.79±
D	WEST VIRGINIA DEPARTMENT OF TRANSPORTATION, DIVISION OF HIGHWAYS	ORAL LAKE ROAD	N/A
E	KEVIN MCNEMAR	351-1.1	0.57±
F	KEVIN MCNEMAR	351-1	24.22±
G	JOHN TROY & CYNTHIA R. SNIDER	331-24	48.14±
H	CLEB T. HENDERSON, II	331-19	33.43±
I	RICHARD L. KINER	331-18.2	66.80±
J	WILLIE & GOLDIE MOORE ESTATE	331-13	4.69±
K	D. M. PATRICK	331-7	31.13±

**PRITT SOUTH 212
WELL TIES**

LINE	BEARING	DISTANCE
L1	S 26°40' E	2569.08'
L2	S 12°54' W	931.84'
L3	S 56°36' W	301.75'
L4	N 19°00' W	636.58'

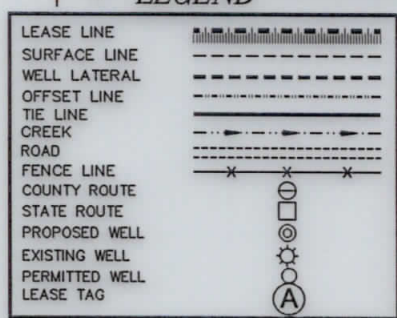
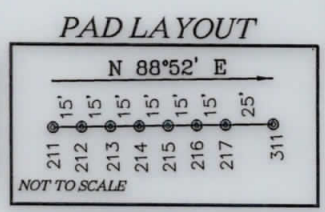

**AS DRILLED COORDINATES
FOR WELL NO. 212**

(S.P.C. NORTH ZONE) (UTM(M) ZONE 17 NORTH)

NAD'83 S.P.C.(FT)	N. 271,995.9	E. 1,774,058.0
NAD'83 GEO.(DD)	LAT-(N) 39.244735	LONG-(W) 80.186560
NAD'83 GEO.(DMS)	LAT-(N) 39°14'41.0"	LONG-(W) 80°11'11.6"
NAD'83 UTM (M)	N. 4,344,250.9	E. 570,194.4

LANDING POINT

NAD'83 S.P.C.(FT)	N. 272,646.1	E. 1,773,536.6
NAD'83 GEO.(DD)	LAT-(N) 39.246509	LONG-(W) 80.188419
NAD'83 GEO.(DMS)	LAT-(N) 39°14'47.4"	LONG-(W) 80°11'18.3"
NAD'83 UTM (M)	N. 4,344,446.3	E. 570,032.2

BOTTOM HOLE

NAD'83 S.P.C.(FT)	N. 279,259.2	E. 1,771,268.1
NAD'83 GEO.(DD)	LAT-(N) 39.264617	LONG-(W) 80.196610
NAD'83 GEO.(DMS)	LAT-(N) 39°15'52.6"	LONG-(W) 80°11'47.8"
NAD'83 UTM (M)	N. 4,346,449.6	E. 569,307.6

NOTES ON SURVEY

- NO WATER WELLS WERE FOUND WITHIN 250' OF PROPOSED GAS WELL. NO AGRICULTURAL BUILDINGS > 2500 SQ. FT. OR DWELLINGS WERE FOUND WITHIN 625' OF THE CENTER OF PROPOSED WELL PAD.
- WELL SPOT CIRCLE & TOPO MARK SCALE IS 1"=2000'
- AS-DRILLED DATA PROVIDED BY ARSENAL RESOURCES.

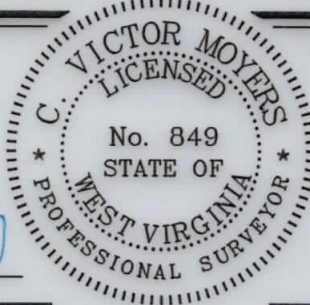

(+) DENOTES LOCATION OF WELL ON UNITED STATES TOPOGRAPHIC MAPS.

DATE AUGUST 2, 20 19

REVISED _____

OPERATORS WELL NO. PRITT SOUTH 212

API WELL NO. 47 - 033 - 05905

STATE COUNTY PERMIT

SLS
Land & Energy Development
Solutions from the ground up.
P.O. Box 150 • 12 Vanhorn Drive • Glenville, WV 26351 • (304) 462-5634
www.slsww.com

I THE UNDERSIGNED, HEREBY CERTIFY THAT THIS PLAT IS CORRECT TO THE BEST OF MY KNOWLEDGE AND BELIEF AND SHOWS ALL THE INFORMATION REQUIRED BY LAW AND THE REGULATIONS ISSUED AND PRESCRIBED BY THE DIVISION OF ENVIRONMENTAL PROTECTION.

P.S. 849 *C. Victor Moyers*

MINIMUM DEGREE OF ACCURACY 1 / 2500 FILE NO. 8383AD212.dwg

HORIZONTAL & VERTICAL CONTROL DETERMINED BY DGPS (SURVEY GRADE TIE TO CORS NETWORK) SCALE 1" = 2000'

STATE OF WEST VIRGINIA
DIVISION OF ENVIRONMENTAL PROTECTION
OFFICE OF OIL AND GAS

WELL TYPE: OIL GAS LIQUID INJECTION WASTE DISPOSAL IF "GAS" PRODUCTION STORAGE DEEP SHALLOW

LOCATION: ELEVATION EXISTING: 1,352.60' / PROPOSED: 1,354.80' WATERSHED BEARDS RUN & PIGTAIL RUN

DISTRICT SIMPSON COUNTY HARRISON QUADRANGLE BROWNTON 7.5'

SURFACE OWNER IRA & LAURA PRITT ACREAGE 69.096±

ROYALTY OWNER IRA & LAURA PRITT ET AL ACREAGE 92.06±

PROPOSED WORK: DRILL CONVERT DRILL DEEPER REDRILL FRACTURE OR STIMULATE PLUG OFF OLD FORMATION PERFORATE NEW FORMATION PLUG AND ABANDON CLEAN OUT AND REPLUG OTHER

PHYSICAL CHANGE IN WELL (SPECIFY) _____ TARGET FORMATION MARCELLUS

ESTIMATED DEPTH 15,274.2' TMD / 7,719' TVD

WELL OPERATOR ARSENAL RESOURCES DESIGNATED AGENT WILLIAM VEIGEL

ADDRESS 6031 WALLACE RD. EXT. SUITE 300 WEXFORD, PA 15090 ADDRESS 65 PROFESSIONAL PLACE BRIDGEPORT, WV 26330

COUNTY NAME

PERMIT