

**ARSENAL RESOURCES  
PRITT SOUTH 211**

(S.P.C. NORTH ZONE) (UTM(M) ZONE 17 NORTH)  
 NAD'83 S.P.C.(FT) N. 271,995.6 E. 1,774,043.0  
 NAD'83 GEO. LAT-(N) 39.244734 LONG-(W) 80.186613  
 NAD'83 UTM (M) N. 4,344,250.7 E. 570,189.8  
**LANDING POINT**  
 NAD'83 S.P.C.(FT) N. 272,156.8 E. 1,772,741.5  
 NAD'83 GEO. LAT-(N) 39.245149 LONG-(W) 80.191213  
 NAD'83 UTM (M) N. 4,344,293.2 E. 569,792.4  
**BOTTOM HOLE**  
 NAD'83 S.P.C.(FT) N. 278,629.6 E. 1,770,513.1  
 NAD'83 GEO. LAT-(N) 39.262872 LONG-(W) 80.199259  
 NAD'83 UTM (M) N. 4,346,254.0 E. 569,080.7

TAG	SURFACE OWNER	TAX MAP / PCL	ACREAGE
A	IRA H. & LAURA E. PRITT	351-4	69.09±
B	JULIA L. CRIM	351-15.3	4.19±
C	IRA H. & LAURA E. PRITT	351-3	0.72±
D	IRA H. & LAURA E. PRITT	351-2	18.749±
E	CAROLYN S. CLEGHORN	351-4.2	85.80±
F	ROBERT J. CLEGHORN & DONNA J. STEGEMANN	351-4.5	1.78±
G	SCOTT CHENOWETH	351-4.3	1.29±
H	WILLIAM C. III & MICHELLE D. SPURLOCK	331-23.3	7.77±
I	WILLIAM C. III & MICHELLE D. SPURLOCK	331-23.5	2.79±
J	JOHN T. & CYNTHIA R. SNIDER	331-24	48.14±
K	WEST VIRGINIA DEPARTMENT OF TRANSPORTATION, DIVISION OF HIGHWAYS	ORAL LAKE ROAD	N/A
L	EDWARD L. & ERICA L. ABRAHAM	331-23.4	4.61±
M	SARAH L. SPURLOCK	331-23.6	10.88±
N	GARY A. & PATTY L. WELLS	331-23	7.02±
O	OWEN B. MARK	331-18	16.62±
P	WILLIE & GOLDIE MOORE ESTATE	331-13	4.69±
Q	D. M. PATRICK	331-7	31.13±

**PRITT SOUTH 211 WELL TIES**

LINE	BEARING	DISTANCE
L1	S 26°58' E	2575.59'
L2	S 12°00' W	928.32'
L3	S 68°04' W	1179.73'
L4	N 19°00' W	636.5'

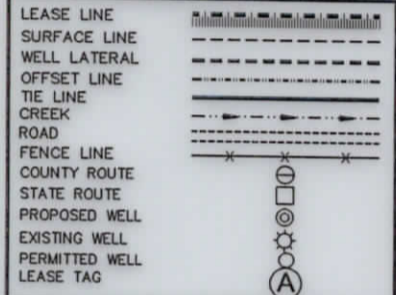
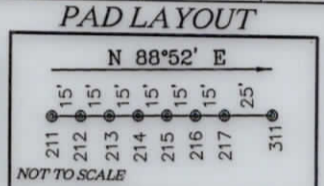

**AS DRILLED COORDINATES FOR WELL NO. 211**

(S.P.C. NORTH ZONE) (UTM(M) ZONE 17 NORTH)

NAD'83 S.P.C.(FT) N. 271,995.6 E. 1,774,043.0  
 NAD'83 GEO.(DD) LAT-(N) 39.244734 LONG-(W) 80.186613  
 NAD'83 GEO.(DMS) LAT-(N) 39°14'41.0" LONG-(W) 80°11'11.8"  
 NAD'83 UTM (M) N. 4,344,250.7 E. 570,189.8  
**LANDING POINT**  
 NAD'83 S.P.C.(FT) N. 272,285.0 E. 1,772,685.9  
 NAD'83 GEO.(DD) LAT-(N) 39.245500 LONG-(W) 80.191413  
 NAD'83 GEO.(DMS) LAT-(N) 39°14'43.8" LONG-(W) 80°11'29.1"  
 NAD'83 UTM (M) N. 4,344,332.0 E. 569,774.8  
**BOTTOM HOLE**  
 NAD'83 S.P.C.(FT) N. 278,667.8 E. 1,770,507.0  
 NAD'83 GEO.(DD) LAT-(N) 39.262977 LONG-(W) 80.199282  
 NAD'83 GEO.(DMS) LAT-(N) 39°15'46.7" LONG-(W) 80°11'57.4"  
 NAD'83 UTM (M) N. 4,346,265.6 E. 569,078.7

**NOTES ON SURVEY**

- NO WATER WELLS WERE FOUND WITHIN 250' OF PROPOSED GAS WELL. NO AGRICULTURAL BUILDINGS > 2500 SQ. FT. OR DWELLINGS WERE FOUND WITHIN 625' OF THE CENTER OF PROPOSED WELL PAD.
- WELL SPOT CIRCLE & TOPO MARK SCALE IS 1"=2000'
- AS-DRILLED DATA PROVIDED BY ARSENAL RESOURCES.

**SLS**  
Land & Energy Development  
Solutions from the ground up.  
P.O. Box 150 • 12 Vanhorn Drive • Glenview, WV 26351 • (304) 462-5634  
www.slsww.com

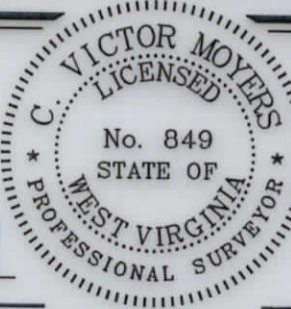

(+) DENOTES LOCATION OF WELL ON UNITED STATES TOPOGRAPHIC MAPS.  
 DATE AUGUST 2, 20 19  
 REVISED \_\_\_\_\_  
 OPERATORS WELL NO. PRITT SOUTH 211  
 API WELL NO. 47-033-05903  
 STATE COUNTY PERMIT

I THE UNDERSIGNED, HEREBY CERTIFY THAT THIS PLAT IS CORRECT TO THE BEST OF MY KNOWLEDGE AND BELIEF AND SHOWS ALL THE INFORMATION REQUIRED BY LAW AND THE REGULATIONS ISSUED AND PRESCRIBED BY THE DIVISION OF ENVIRONMENTAL PROTECTION.  
 P.S. C. Victor Moyers  
 849

MINIMUM DEGREE OF ACCURACY 1 / 2500 FILE NO. 8383AD211.dwg  
 HORIZONTAL & VERTICAL CONTROL DETERMINED BY DGPS (SURVEY GRADE TIE TO CORS NETWORK) SCALE 1" = 2000'

STATE OF WEST VIRGINIA  
 DIVISION OF ENVIRONMENTAL PROTECTION  
 OFFICE OF OIL AND GAS

**WELL TYPE:** OIL  GAS  INJECTION  WASTE DISPOSAL  IF "GAS" PRODUCTION  STORAGE  DEEP  SHALLOW

**LOCATION:**  
 ELEVATION EXISTING: 1,352.00' / PROPOSED: 1,354.80' WATERSHED BEARDS RUN & PIGTAIL RUN  
 DISTRICT SIMPSON COUNTY HARRISON QUADRANGLE BROWNTON 7.5'  
 SURFACE OWNER IRA & LAURA PRITT ACREAGE 69.096±  
 ROYALTY OWNER IRA & LAURA PRITT ET AL ACREAGE 92.06± **11/12/2021**  
**PROPOSED WORK:**  
 DRILL  CONVERT  DRILL DEEPER  REDRILL  FRACTURE OR STIMULATE  PLUG OFF OLD FORMATION   
 PERFORATE NEW FORMATION  PLUG AND ABANDON  CLEAN OUT AND REPLUG  OTHER   
 PHYSICAL CHANGE IN WELL (SPECIFY) \_\_\_\_\_ TARGET FORMATION MARCELLUS  
 ESTIMATED DEPTH 15,058.9' TMD / 7,676' TVD

**WELL OPERATOR** ARSENAL RESOURCES **DESIGNATED AGENT** WILLIAM VEIGEL  
**ADDRESS** 6031 WALLACE RD. EXT. SUITE 300 **ADDRESS** 65 PROFESSIONAL PLACE  
 WEXFORD, PA 15090 BRIDGEPORT, WV 26330

COUNTY NAME PERMIT