

8,507' to Bottom Hole

5,423' to Top Hole

TOP & BOTTOM HOLE LATITUDE 39 - 17 - 30

Notes:

West Virginia Coordinate System of 1927, North Zone based upon Differential GPS Measurements.

Well No. April Unit 1H Top Hole coordinates are N: 276,150.82' Latitude: 39°15'12.00" E: 1,699,759.45' Longitude: 80°33'36.88" Bottom Hole coordinates are N: 285,926.57' Latitude: 39°16'48.26" E: 1,696,674.64' Longitude: 80°34'17.58"

UTM Zone 17, NAD 1983

Top Hole Coordinates N: 4,344,991.804m E: 537,958.652m Bottom Hole Coordinates N: 4,347,954.346m E: 536,969.239m

Plat orientation and corner and well references are based upon the grid north meridian. Well location references are based upon the magnetic meridian.

Antero Resources Well No. April Unit 1H Antero Resources Corporation

Table with columns Bearing and Dist. containing survey data for L1 through L5.

I, the undersigned, hereby certify that this plat is correct to the best of my knowledge and belief and shows all the information required by law and the rules issued and prescribed by the Department of Environmental Protection.

Kenneth J. Plum, P.S. 2216



Tax Map 301 Parcels

Table listing parcels 23-34 with columns for Parcel, Owner, DB/Pg, and Acres.

Tax Map 321 Parcels

Table listing parcels 1-22 with columns for Parcel, Owner, DB/Pg, and Acres.



Well Location References

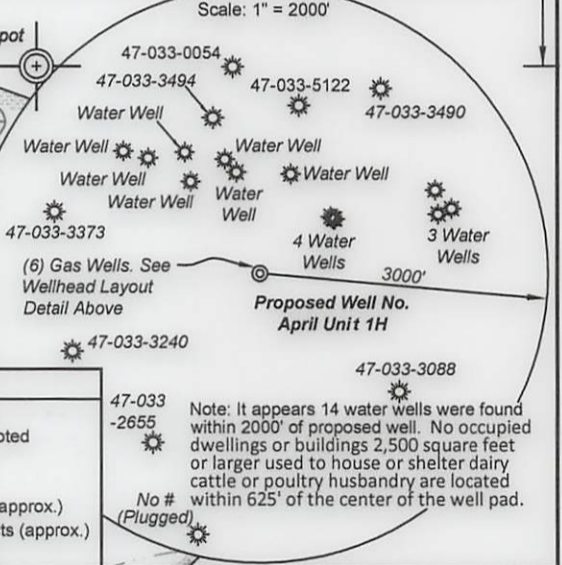
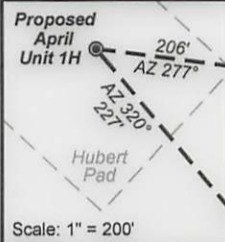

Legend table defining symbols for Proposed gas well, Found corner, Creek or Drain, Existing Road, Surface boundary, Interior surface tracts, and Existing Fenceline.

FILE NO: 10-36-TM-13 DRAWING NO: 10-13 April 1H Well Plat SCALE: 1" = 1200' MINIMUM DEGREE OF ACCURACY: Submeter PROVEN SOURCE OF ELEVATION: WV DOT, Bridgeport, WV

STATE OF WEST VIRGINIA DEPARTMENT OF ENVIRONMENTAL PROTECTION OIL AND GAS DIVISION

DATE: July 29 2013 OPERATOR'S WELL NO. April Unit 1H API WELL NO. H6A 47 - 033 - 05786 STATE COUNTY PERMIT

WELL TYPE: OIL GAS LIQUID INJECTION WASTE DISPOSAL (IF GAS) PRODUCTION: STORAGE DEEP SHALLOW LOCATION: ELEVATION: 1376' WATERSHED: Patterson Fork QUADRANGLE: Salem DISTRICT: Tenmile COUNTY: Harrison SURFACE OWNER: Hubert Jr. & Lorena Bland Haymond R. & Carolyn N. Plaughter; Victor G. Taylor Paul J. Watson, et ux, et al; J. Moses Raad, et al 21184; 22027 ACREAGE: 28.50 108; 29; 50 ROYALTY OWNER: DEPI, et al; Linda C. Fluharty; Tetrick Group II Revocable Trust LEASE NO: DV019191; 21030 ACREAGE: 283; 447; 55.5 PROPOSED WORK: DRILL CONVERT DRILL DEEPER FRACTURE OR STIMULATE PLUG OFF OLD FORMATION PERFORATE NEW FORMATION OTHER PHYSICAL CHANGE IN WELL (SPECIFY) PLUG AND ABANDON CLEAN OUT AND REPLUG TARGET FORMATION: Marcellus Shale ESTIMATED DEPTH: 7,600' TVD 18,400' MD

WELL OPERATOR: Antero Resources Corporation DESIGNATED AGENT: Dianna Stamper - CT Corporation System ADDRESS: 1625 17th Street Denver, CO 80202 ADDRESS: 5400 D Big Tyler Road Charleston, WV 25313

CANCELLED

02/05/2016



west virginia department of environmental protection

Office of Oil and Gas
601 57th Street SE
Charleston, WV 25304
(304) 926-0450
(304) 926-0452 fax

Earl Ray Tomblin, Governor
Randy C. Huffman, Cabinet Secretary
www.dep.wv.gov

January 22, 2016

FINAL INSPECTION REPORT

Well Permit Cancelled

ANTERO RESOURCES CORPORATION,

The FINAL INSPECTION REPORT for the CANCELLED permit, API Well Number: 47-3305786, issued to ANTERO RESOURCES CORPORATION, and listed below has been received in this office. The permit has been cancelled as of 1/21/2016.

James Martin
Chief

Operator: ANTERO RESOURCES CORPORATION
Operator's Well No: APRIL UNIT 1H
Farm Name: BLAND, HUBERT JR. & LORENA
API Well Number: 47-3305786
Date Issued: 10/09/2013

Date Cancelled: 01/21/2016

Promoting a healthy environment.

02/05/2016

INSPECTORS PERMIT SUMMARY FORM

GPS YES [] NO []

DATE STARTED/LOCATION: _____ OPERATOR: ANTERO RESOURCES CORPORATI
 DRILLING COMMENCED: _____ FARM: BLAND, HUBERT JR. & LORENA
 TO DATE: _____ DEPTHS: _____ Well No: APRIL UNIT 1H
 WATER DEPTHS: _____ COAL DEPTHS _____

QUESTIONS FOR THIS REPORT ARE IN ACCORDANCE OF WV CODE 22-6-30 AND REGULATIONS 35CSR 4-12.1 AND 35CSR 4-16 AND THE GENERAL WATER POLLUTION CONTROL PERMIT.

POINTS ARE TO BE GIVEN UP TO MAXIMUM AS SHOWN BASED ON PERFORMANCE.

1. DID OPERATOR GIVE PROPER NOTICE TO INSPECTOR BEFORE THE FOLLOWING:
- A. CONSTRUCTION YES [] NO [] (2_PTS) (4_PTS) _____
 - B. DRILLING YES [] NO [] (2_PTS)
2. WAS THE TIMBER CUT, STACKED, AND BRUSH USED FOR SEDIMENT BARRIERS BEFORE DIRT WORK STARTED? YES [] NO [] (2_PTS) (4_PTS) _____
3. ARE ALL LOCATION AND/OR ROAD BANKS BEING SLOPED? YES [] NO [] (4_PTS) (4_PTS) _____
4. CONSTRUCTIONS:
 WERE THE FOLLOWING SEDIMENT CONTROL STRUCTURES PROPERLY INSTALLED/MAINTAINED?
- A. ROAD DITCHES (1)_ (2)_ (3)_ (4)_ (PTS) B. CROSS DRAINS (1)_ (2)_ (3)_ (4)_ (5)_ (PTS)
 - C. CULVERTS (1)_ (2)_ (3)_ (4)_ (5)_ (PTS) D. CREEK CROSSINGS (1)_ (2)_ (3)_ (PTS)
 - E. DIVERSION DITCHES (1)_ (2)_ (3)_ (PTS) F. BARRIERS (1)_ (2)_ (3)_ (PTS)
 - G. TEMPORARY SEEDING YES [] NO [] (10_PTS)

POINTS AVAILABLE FOR QUESTION 4: (33_PTS) _____

5. HAS TOP SOIL (IF ANY) BEEN STOCKED PILED? YES [] NO [] (2_PTS) (2_PTS) _____
6. IS THE PIT PROPERLY INSTALLED AND MAINTAINED? YES [] NO [] (9_PTS) (9_PTS) _____
7. RECLAMATION:
- A. ROADWAY (1)_ (2)_ (3)_ (PTS) B. LOCATION (1)_ (2)_ (3)_ (PTS)
 - C. PITS (1)_ (2)_ (3)_ (PTS) D. PIPELINES (1)_ (2)_ (3)_ (PTS)
 - E. TANK DIKES (1)_ (2)_ (3)_ (PTS) F. API INSTALLED YES [] NO [] (3_PTS)
 - G. ADEQUATE SEEDING MATERIALS (1)_ (2)_ (3)_ (PTS)
 - H. WAS SEED BED ADEQUATE (1)_ (2)_ (3)_ (PTS)

POINTS AVAILABLE FOR QUESTION 7: (24_PTS) _____

8. WAS RECLAMATION COMPLETED WITHIN:
 6 MTHS OF TD 6_PTS ONLY; 4 MTHS OF TD 12_PTS ONLY; 2 MTHS OF TD 19_PTS ONLY;
 POINTS AVAILABLE FOR QUESTION 8: (19_PTS) _____

TOTAL MAXIMUM POSSIBLE SCORE OF 99.

TOTAL RECLAMATION SCORE: _____

1/21/2016
DATE RELEASED

[Signature]
INSPECTOR'S SIGNATURE

RECORD INSPECTIONS TO THIS WELL ON PAGE 2

Cancel