



west virginia department of environmental protection

Office of Oil and Gas
601 57th Street SE
Charleston, WV 25304
(304) 926-0450
(304) 926-0452 fax

Earl Ray Tomblin, Governor
Randy C. Huffman, Cabinet Secretary
www.dep.wv.gov

PERMIT MODIFICATION APPROVAL

November 05, 2013

PDC MOUNTAINEER LLC
POST OFFICE BOX 26
BRIDGEPORT, WV 26330

Re: Permit Modification Approval for API Number 3305741 , Well #: MAXWELL 3HM
Changed bottom hole

Oil and Gas Operator:

The Office of Oil and Gas has reviewed the attached permit modification for the above referenced permit. The attached modification has been approved and well work may begin. Please be reminded that the oil and gas inspector is to be notified twenty-four (24) hours before permitted well work is commenced.

Please call James Martin at 304-926-0499, extension 1654 if you have any questions.

Sincerely,

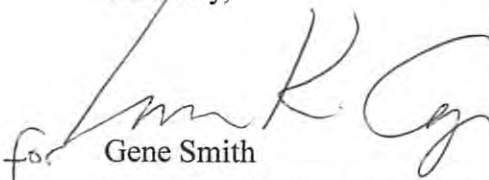
for Gene Smith
Regulatory/Compliance Manager
Office of Oil and Gas

STATE OF WEST VIRGINIA
DEPARTMENT OF ENVIRONMENTAL PROTECTION, OFFICE OF OIL AND GAS
W.VA. CODE §22-6A - WELL WORK PERMIT APPLICATION

1) Well Operator: PDC Mountaineer LLC 494494839 Harrison Union Mount Clare 7.5'
Operator ID County District Quadrangle

2) Operator's Well Number: 3 HM Well Pad Name: Maxwell

3 Elevation, current ground: 1462' Elevation, proposed post-construction: 1459'

4) Well Type: (a) Gas Oil
Other
(b) If Gas: Shallow Deep
Horizontal

5) Existing Pad? Yes or No: No

6) Proposed Target Formation(s), Depth(s), Anticipated Thicknesses and Associated Pressure(s):
Marcellus Shale, 7600' TVD, Approximately 100 feet thick, 7600' x 0.594 psi/ft = 4514 psi calculated reservoir pressure.
SDW
9/5/13

7) Proposed Total Vertical Depth: 7600'

8) Formation at Total Vertical Depth: Marcellus Shale

9) Proposed Total Measured Depth: 13,700'

10) Approximate Fresh Water Strata Depths: 302', 369', 396', & 429'

11) Method to Determine Fresh Water Depth: Reported wells: 47-033-04775, 04559, 04575, & 05556

12) Approximate Saltwater Depths: 628', 1261'

13) Approximate Coal Seam Depths: 361', 540'

14) Approximate Depth to Possible Void (coal mine, karst, other): Not Known.

15) Does land contain coal seams tributary or adjacent to, active mine? No

16) Describe proposed well work: Drill & stimulate a new horizontal Marcellus well following all State & Federal guidelines.

All casing used in the wellbore will be new casing. Centralizers will be used contingent upon final log of well. Production string cement will be at least 100 feet into the intermediate string. Cement will be API grade.

17) Describe fracturing/stimulating methods in detail:

Slick water frac, pumping 80 bbls minimum. Each stage to contain approximately 10,000 bbl of water and 40,000 pounds of sand.
Frac additives, chemical names, and CAS #'s are provided on the next page.

18) Total area to be disturbed, including roads, stockpile area, pits, etc, (acres): _____

19) Area to be disturbed for well pad only, less access road (acres): _____

Received
SEP -6 2013
Office of Oil and Gas
WV Dept. of Environmental Protection

20)

CASING AND TUBING PROGRAM

<u>TYPE</u>	<u>Size</u>	<u>New or Used</u>	<u>Grade</u>	<u>Weight per ft.</u>	<u>FOOTAGE: For Drilling</u>	<u>INTERVALS: Left in Well</u>	<u>CEMENT: Fill -up (Cu. Ft.)</u>
Conductor	20"	New	H-40	94#	65'	65'	Cement to Surface
Fresh Water	13 3/8"	New	J-55	54.5#	500'	500'	Cement to Surface
Coal							
Intermediate	9 5/8"	New	J-55	40#	2850'	2850'	Cement to Surface
Production	5 1/2"	New	P-110	20#	13,700'	13,700'	2791 minimum
Tubing							
Liners							

<u>TYPE</u>	<u>Size</u>	<u>Wellbore Diameter</u>	<u>Wall Thickness</u>	<u>Burst Pressure</u>	<u>Cement Type</u>	<u>Cement Yield</u>
Conductor	20"	24"	0.756	1500	1	1.06
Fresh Water	13 3/8"	17 1/2"	0.66	1730	1	1.18
Coal						
Intermediate	9 5/8"	12 1/4"	0.704	3520	1	1.18
Production	5 1/2"	8.5"/8.75"	0.722	12,460	H	1.18
Tubing						
Liners						

SDW
a/s/13

PACKERS

Kind:				
Sizes:				
Depths Set:				

Received
SEP - 6 2013

Office of Oil and Gas
WV Dept. of Environmental Protection

MAXWELL LEASE WELL NO.'S 1HM - 6HM

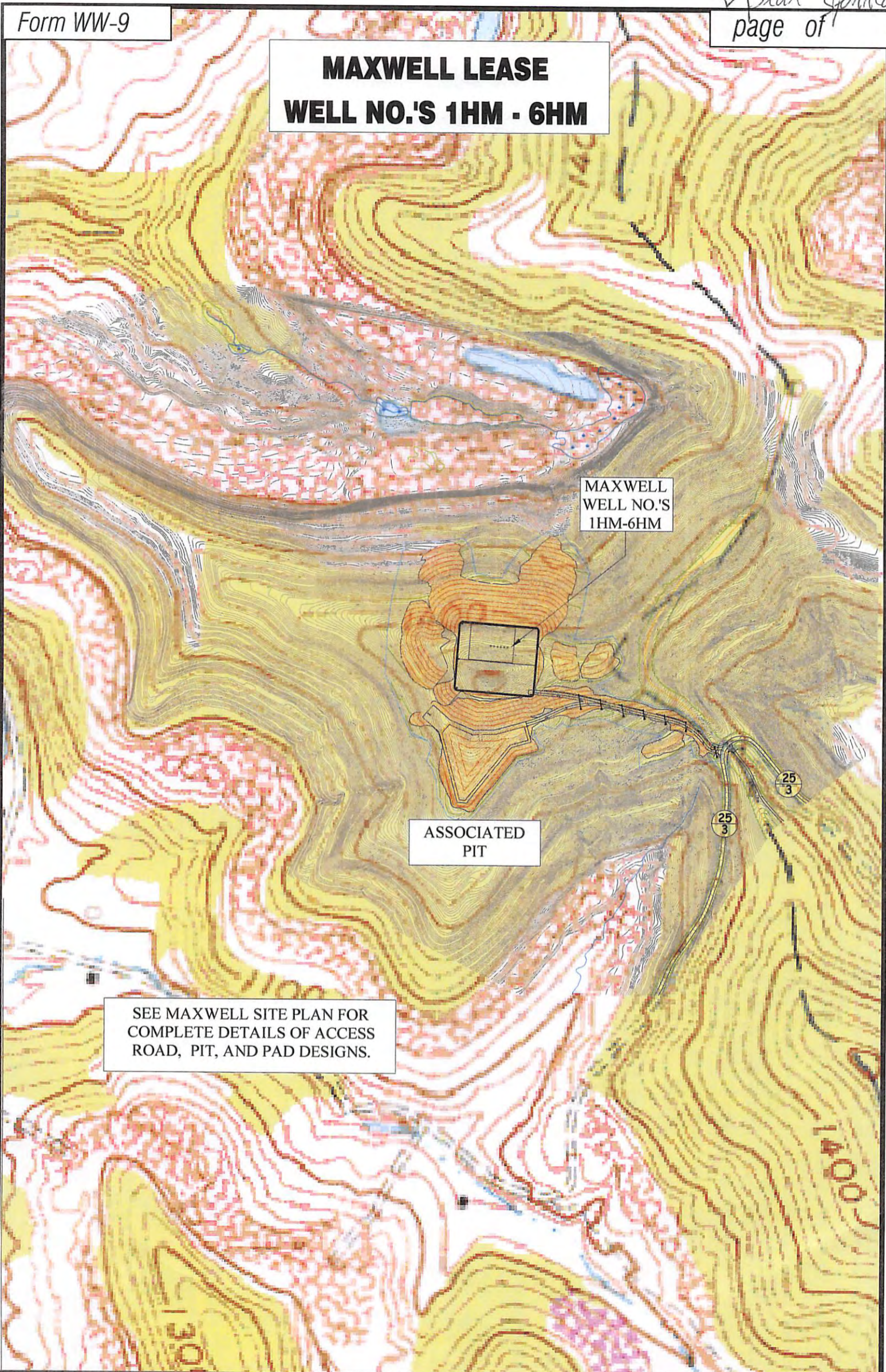

MAXWELL
WELL NO.'S
1HM-6HM

ASSOCIATED
PIT

SEE MAXWELL SITE PLAN FOR
COMPLETE DETAILS OF ACCESS
ROAD, PIT, AND PAD DESIGNS.

Professional Energy Consultants
A DIVISION OF SMITH LAND SURVEYING

SURVEYORS PROJECT MGMT. **SLS** ENGINEERS ENVIRONMENTAL

226 West Main St
P.O. Box 150
Glennville, WV 26031
(815) 482-5831

56665 Diller Bottom Road
Shelbyville, OH 43087
(740) 671-9911

HONESTY, INTEGRITY, QUALITY

TOPO SECTION OF USGS
MOUNT CLARE 7.5' QUADRANGLE



DRAWN BY C.P.M.	FILE NO. 7995	DATE 03-28-13	CADD FILE: 7995REC.DWG
--------------------	------------------	------------------	---------------------------

MAXWELL LEASE WELL NO. 3HM

LONGITUDE 80°20'00"

3HM WELL TIES

LINE	BEARING	DISTANCE
L1	N 02°08'46" W	4232.05'
L2	N 14°45'23" E	2524.34'
L3	N 20°00'00" W	5290.00'
L4	S 64°40'28" W	331.53'



WELL NO. 3HM TOP HOLE
STATE PLANE COORDINATES (NORTH ZONE NAD '27)
N. 265,036
E. 1,754,372

TOP HOLE (NAD 27)
LAT=(N) 39°13'29.9"
LONG=(W) 80°22'01.3"

TOP HOLE (NAD 83)
LAT=(N) 39°13'28.3"
LONG=(W) 80°22'00.6"

TOP HOLE UTM (NAD 83)
(N) 4,341,883
(E) 554,653

WELL NO. 3HM LANDING POINT
STATE PLANE COORDINATES (NORTH ZONE NAD '27)
N. 265,236
E. 1,753,210

LANDING POINT (NAD 27)
LAT=(N) 39°13'29.8"
LONG=(W) 80°22'16.1"

LANDING POINT (NAD 83)
LAT=(N) 39°13'30.1"
LONG=(W) 80°22'15.4"

LANDING POINT UTM (NAD 83)
(N) 4,341,938
(E) 554,298

WELL NO. 3HM BOTTOM HOLE
STATE PLANE COORDINATES (NORTH ZONE NAD '27)
N. 270,207
E. 1,751,400

BOTTOM HOLE (NAD 27)
LAT=(N) 39°14'18.8"
LONG=(W) 80°22'39.7"

BOTTOM HOLE (NAD 83)
LAT=(N) 39°14'19.1"
LONG=(W) 80°22'39.0"

BOTTOM HOLE UTM (NAD 83)
(N) 4,343,443
(E) 553,722

REFERENCES



NOTES ON SURVEY

1. TIES TO WELLS, REFERENCES, AND CORNERS ARE BASED ON GRID NORTH FOR THE WV STATE PLANE COORDINATE SYSTEM NORTH ZONE NAD '27.
2. LEASE BOUNDARY SHOWN HEREON TAKEN FROM DEED BOOK 142 PAGE 484 AND ADJOINING DEEDS.
3. SURFACE OWNER AND ADJOINER INFORMATION TAKEN FROM THE ASSESSOR AND COUNTY CLERK RECORDS OF HARRISON COUNTY IN JULY, 2012.
4. WELL LAT./LONG. (NAD'27) ESTABLISHED BY DGPS(SURVEY GRADE).



I THE UNDERSIGNED, HEREBY CERTIFY THAT THIS PLAT IS CORRECT TO THE BEST OF MY KNOWLEDGE AND BELIEF AND SHOWS ALL THE INFORMATION REQUIRED BY LAW AND THE REGULATIONS ISSUED AND PRESCRIBED BY THE DIVISION OF ENVIRONMENTAL PROTECTION

P.S. 677 *Gregory A. Smith*



(+) DENOTES LOCATION OF WELL ON UNITED STATES TOPOGRAPHIC MAPS.

DATE APRIL 3 , 20 13

REVISED DATE SEPTEMBER 3 , 20 13

OPERATORS WELL NO. MAXWELL 3HM

API WELL NO. 47 - 33 - MOD 05741 H6A

STATE 33 COUNTY MOD PERMIT 05741 H6A

MINIMUM DEGREE OF ACCURACY 1 / 200 FILE NO. 7995P3HMR3(448-13)

PROVEN SOURCE OF ELEVATION DGPS (SUBMETER MAPPING GRADE) SCALE 1" = 2,000'

STATE OF WEST VIRGINIA
DIVISION OF ENVIRONMENTAL PROTECTION
OFFICE OF OIL AND GAS



WELL TYPE: OIL GAS LIQUID INJECTION WASTE DISPOSAL IF "GAS" PRODUCTION STORAGE DEEP SHALLOW

LOCATION: ELEVATION 1,462' WATERSHED WEST FORK RIVER

DISTRICT UNION COUNTY HARRISON QUADRANGLE MOUNT CLARE 7.5'

SURFACE OWNER LYNCH FARM, LLC ACREAGE 37.5±

ROYALTY OWNER WBM PROPERTIES LLC, ET AL ACREAGE 748, 42, 44.21, 73.75, 97.5, & 132±

PROPOSED WORK: DRILL CONVERT DRILL DEEPER REDRILL FRACTURE OR STIMULATE PLUG OFF OLD FORMATION PERFORATE NEW FORMATION PLUG AND ABANDON CLEAN OUT AND REPLUG OTHER

PHYSICAL CHANGE IN WELL (SPECIFY) _____ TARGET FORMATION MARCELLUS

ESTIMATED DEPTH 7,590' TVD / TMD 13,695'

WELL OPERATOR PDC MOUNTAINEER, LLC DESIGNATED AGENT JAMIE HAGA

ADDRESS 120 GENESIS BOULEVARD BRIDGEPORT, WV 26330 ADDRESS 120 GENESIS BOULEVARD BRIDGEPORT, WV 26330

COUNTY NAME PERMIT