

Antero Resources
Well No. Cecele 2H
 As-Drilled
Antero Resources Corporation

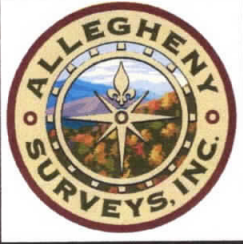

Top Hole coordinates verified by survey grade GPS. As-drilled data and information was provided by Antero Resources Corporation. Allegheny Surveys, Inc. (ASI) is not certifying the data and information provided. ASI is not responsible for any errors or inaccuracies with the data and information that has been provided.

Notes:
 West Virginia Coordinate System of 1927, North Zone based upon Differential GPS Measurements.
 Well No. Cecele 2H coordinates are
 N: 250,741.23' Latitude: 39°11'02.23"
 E: 1,711,688.35' Longitude: 80°31'01.59"
 UTM Zone 17, NAD 1983
 Top Hole Coordinates
 N: 4,337,311.335m
 E: 541,721.879m
 Plat orientation and corner and well references are based upon the grid north meridian.
 Well location references are based upon the magnetic meridian.

4,850' to Top Hole

LATITUDE 39 - 12 - 30

LONGITUDE 80 - 30 - 00

8,881' to Top Hole

Legend

- ⊙ Proposed gas well
- ⊗ Found corner, as noted
- ☀ Existing Well, as noted
- ☀ Digitized Well
- Existing Road
- Surface boundary (approx.)
- - - Interior surface tracts (approx.)

Detail Not to Scale

- ⊙ Everett Unit 1H (47-033-05688)
- ⊙ Mirth Unit 2H (47-033-05691)
- ⊙ Mirth Unit 1H (47-033-05693)
- ⊙ Carpenter Unit 2H (47-033-05690)
- ⊙ Carpenter Unit 1H (47-033-05689)
- ⊙ Cecele Unit 2H (47-033-05692)

GRID NORTH

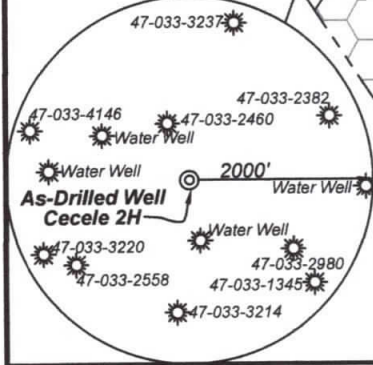

Note: 4 water wells were found within 2000' of proposed well. No occupied dwellings or buildings 2,500 square feet or larger used to house or shelter dairy cattle or poultry husbandry are located within 625' of the center of the well pad.

I, the undersigned, hereby certify that this plat is correct to the best of my knowledge and belief and shows all the information required by law and the rules issued and prescribed by the Department of Environmental Protection.

Bradley D. Miller
 Bradley D. Miller, P.S. 2167

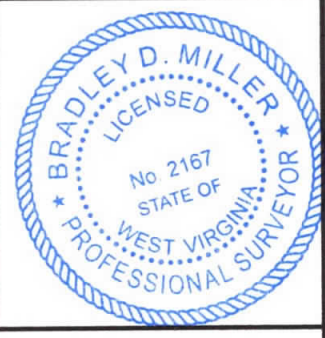

FILE NO: 185-36-U-12
 DRAWING NO: Cecele 2H As-Drilled
 SCALE: 1" = 500'
 MINIMUM DEGREE OF ACCURACY: Submeter
 PROVEN SOURCE OF ELEVATION: WVDOT, Bridgeport, WV

STATE OF WEST VIRGINIA
 DEPARTMENT OF ENVIRONMENTAL PROTECTION
OIL AND GAS DIVISION

DATE: June 3 2020
 OPERATOR'S WELL NO. Cecele 2H
 API WELL NO
 47 - 033 - 5692
 STATE COUNTY PERMIT

WELL TYPE: OIL GAS LIQUID INJECTION WASTE DISPOSAL
 (IF GAS) PRODUCTION: STORAGE DEEP SHALLOW
 LOCATION: ELEVATION: As-Built 1,290' WATERSHED: Middle West Fork Creek QUADRANGLE: Big Issac
 DISTRICT: Union COUNTY: Harrison
 SURFACE OWNER: Richard B. Washbourne ACREAGE: 46.57
 ROYALTY OWNER: Mildred D. & Carl N. Posey LEASE NO: ACREAGE: 102
 PROPOSED WORK: DRILL CONVERT DRILL DEEPER FRACTURE OR STIMULATE PLUG OFF OLD FORMATION
 PERFORATE NEW FORMATION OTHER PHYSICAL CHANGE IN WELL (SPECIFY) As-Drilled 40' TVD
 PLUG AND ABANDON CLEAN OUT AND REPLUG TARGET FORMATION: Marcellus Shale ESTIMATED DEPTH: 40' MD

WELL OPERATOR: Antero Resources Corporation DESIGNATED AGENT: Dianna Stamper - CT Corporation System
 ADDRESS: 1615 Wynkoop Street ADDRESS: 5400 D Big Tyler Road
 Denver, CO 80202 Charleston, WV 25313