

Line	Bearing	Distance
L1	N 49°46' W	1888.9'
L2	N 79°27' W	3129.7'
L3	S 68°33' W	1564.7'
L4	S 66°32' W	1862.5'

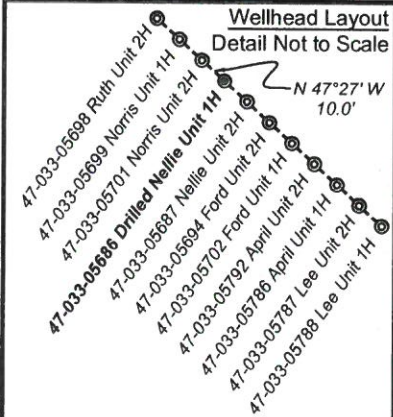

Top Hole coordinates verified by survey grade GPS. As-drilled data and information was provided by Antero Resources Corporation. Allegheny Surveys, Inc. (ASI) is not certifying the data and information provided. ASI is not responsible for any errors or inaccuracies with the data and information that has been provided.

**Notes:**  
**West Virginia Coordinate System of 1927, North Zone**  
**based upon Differential GPS Measurements.**  
 Well No. Nellie Unit 1H Top Hole coordinates are  
 N: 276,184.54 Latitude: 39°15'12.33"  
 E: 1,699,722.53 Longitude: 80°33'37.36"  
 Bottom Hole coordinates are  
 N: 270,220.21 Latitude: 39°14'14.18"  
 E: 1,706,647.47 Longitude: 80°32'08.45"  
**UTM Zone 17, NAD 1983**  
 Top Hole Coordinates: N: 4,345,001.890m E: 537,947.233m  
 Bottom Hole Coordinates: N: 4,343,220.036m E: 540,087.247m  
 Plat orientation and corner and well references are based upon the grid north meridian. Well location references are based upon the magnetic meridian.

Par	Tax Map 321 Owner	Bk/Pg	Acres
1 31.1	Robert G. Jr. & Betty A. Matheny	1405/720	4.87
2 31.3	Robert G. Jr. & Betty A. Matheny	1114/167	3.53
3 31	Carl H. Jr. & Jeanne Adkins	1356/1050	2.35
4 38.1	John & Marianne Clevenger	1247/289	4.17
5 38.2	John & Marianne Clevenger	1247/289	1.05
6 38	Robert N. & Shirley M. Bowen	941/478	0.78
7 37.1	Roberta G. Zwiebel	F104/780	0.98
8 28.1	Patricia A. Collins	1060/1140	1.46
9 27	City of Salem	642/123	1.50
10 28.4	Nancy E. Farr	1439/38	0.18
11 28.3	Nancy E. Farr	1362/580	
12 26	Christine R. Utter	1314/417	19.75
13 40.4	Clifford S. & Laura Clevenger	1406/1196	1.06
14 40.3	Clifford S. & Laura Clevenger	1407/979	0.81
15 40.5	Danny & Tina Martin	1188/1013	0.244
16 40	Danny & Tina Martin	1321/453	0.565

FILE NO: 70-36-U-12  
 DRAWING NO: 70-12 Nellie 1H As-Drilled  
 SCALE: 1" = 1200'  
 MINIMUM DEGREE OF ACCURACY: Submeter  
 PROVEN SOURCE OF ELEVATION: WVDOT, Bridgeport, WV

**STATE OF WEST VIRGINIA**  
 DEPARTMENT OF ENVIRONMENTAL PROTECTION  
**OIL AND GAS DIVISION**

DATE: April 2 2015  
 OPERATOR'S WELL NO. Nellie Unit 1H  
 API WELL NO  
 47 - 033 - 05686  
 STATE COUNTY PERMIT

WELL TYPE:  OIL  GAS  LIQUID INJECTION  WASTE DISPOSAL  
 (IF GAS) PRODUCTION:  STORAGE  DEEP  SHALLOW  
 LOCATION: ELEVATION: Original - 1398' Existing - 1376' WATERSHED: Tenmile Creek QUADRANGLE: Salem & Big Isaac  
 DISTRICT: Tenmile COUNTY: Harrison  
 SURFACE OWNER: Hubert Jr. & Lorena Bland Justin L. Henderson; Thomas Mason, et ux; Tichenal 591 ACREAGE: 28.50 80; 30; 1026.936;  
 ROYALTY OWNER: DEPI, et al; Gideon M. & J.I. Thompson; Richard Roach, et al LEASE NO: DV019191; 044999 ACREAGE: 283; 144; 17.50  
 PROPOSED WORK:  DRILL  CONVERT  DRILL DEEPER  FRACTURE OR STIMULATE  PLUG OFF OLD FORMATION  
 PERFORATE NEW FORMATION  OTHER PHYSICAL CHANGE IN WELL (SPECIFY) As-Drilled TVD 7,392'  
 PLUG AND ABANDON  CLEAN OUT AND REPLUG TARGET FORMATION: Marcellus Shale DEPTH: MD 16,172'

WELL OPERATOR: Antero Resources Corporation DESIGNATED AGENT: Dianna Stamper - CT Corporation System  
 ADDRESS: 1615 Wynkoop Street ADDRESS: 5400 D Big Tyler Road  
 Denver, CO 80202 Charleston, WV 25313