

**Antero Resources
Well No. Bennett Unit 2H
As-Drilled Plat
Antero Resources Corporation**

	Bearing	Dist.
L1	S 86°13' E	2147.4'
L2	S 51°13' E	291.0'
L3	S 57°01' E	865.2'
L4	S 48°58' W	1036.0'

(•) Denotes Location of Well on United States Topographic Maps

A Trustees, Mt. Olive U.B. Church Lease
B M.C. Britton, et al Lease 052891

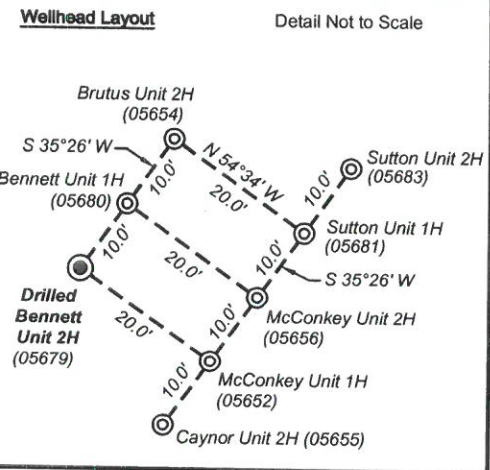

Notes:
West Virginia Coordinate System of 1927, North Zone based upon Differential GPS Measurements.
Well No. Bennett Unit 2H Top Hole coordinates are
N: 257,755.50' Latitude: 39°12'12.88"
E: 1,723,817.27' Longitude: 80°28'28.53"
Bottom Hole coordinates are
N: 266,905.11' Latitude: 39°13'43.04"
E: 1,721,307.27' Longitude: 80°29'01.68"
UTM Zone 17, NAD 1983
Top Hole Coordinates Bottom Hole Coordinates
N: 4,339,509.827m N: 4,342,284.548m
E: 545,381.409m E: 544,570.282m
Plat orientation and corner and well references are based upon the grid north meridian.
Well location references are based upon the magnetic meridian.

Top Hole coordinates verified by survey grade GPS.
As-drilled data and information was provided by Antero Resources Corporation.
Allegheny Surveys, Inc. (ASI) is not certifying the data and information provided. ASI is not responsible for any errors or inaccuracies with the data and information that has been provided.

TOP LATITUDE 39 - 12 - 30
BTM LATITUDE 39 - 15 - 00

TOP LONGITUDE 80 - 27 - 30
BOTT LONGITUDE 80 - 27 - 30

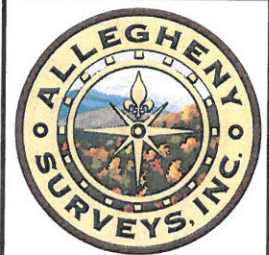

Legend

- ⊙ Proposed gas well
- ⊗ Found corner, as noted
- Creek or Drain
- Existing Road
- Surface boundary (approx.)
- Interior surface tracts (approx.)

FILE NO: 102-36-U-11
DRAWING NO: 102-11 As-Drilled Bennett 2H
SCALE: 1" = 1200'
MINIMUM DEGREE OF ACCURACY: Submeter
PROVEN SOURCE OF ELEVATION: WVDOT, Bridgeport, WV

STATE OF WEST VIRGINIA
DEPARTMENT OF ENVIRONMENTAL PROTECTION
OIL AND GAS DIVISION

DATE: February 9 2015
OPERATOR'S WELL NO. Bennett Unit 2H
API WELL NO
47 - 033 - 05679
STATE COUNTY PERMIT

WELL TYPE: OIL GAS LIQUID INJECTION WASTE DISPOSAL
(IF GAS) PRODUCTION: STORAGE DEEP SHALLOW
LOCATION: ELEVATION: 1235' WATERSHED: Middle West Fork River QUADRANGLE: West Milford
DISTRICT: Union J.L. Stutler, et al; Wilma F. & Harry W. Post; COUNTY: Harrison
SURFACE OWNER: Robert & Patricia Bennett Andrew N. & Etta C. Sutton; Stephen E. & Ella G. Bennett, et al; DV011645; ACREAGE: 79.85 26;
ROYALTY OWNER: Union National Bank of Clarksburg; Irwin Stutler; M.C. Britton, et al LEASE NO: 90433; 044522; 005906 ACREAGE: 100; 124.25; 101.3
PROPOSED WORK: DRILL CONVERT DRILL DEEPER FRACTURE OR STIMULATE PLUG OFF OLD FORMATION
 PERFORATE NEW FORMATION OTHER PHYSICAL CHANGE IN WELL (SPECIFY) As-Drilled
 PLUG AND ABANDON CLEAN OUT AND REPLUG TARGET FORMATION: Marcellus Shale 6,993' TVD
DEPTH: 16,298' MD

WELL OPERATOR: Antero Resources Corporation DESIGNATED AGENT: Dianna Stamper - CT Corporation System
ADDRESS: 1615 Wynkoop Street ADDRESS: 5400 D Big Tyler Road
Denver, CO 80202 Charleston, WV 25313