

Antero Resources
Well No. Ash Unit 3H
Antero Resources Appalachian
Corporation

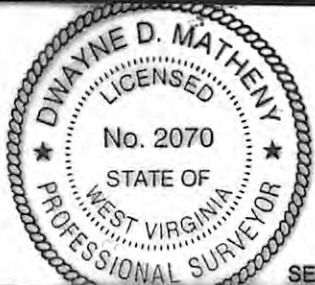

LINE	BEARING	DISTANCE
L1	S 81°29' W	855.1'
L2	S 24°42' W	238.8'
L3	N 83°33' W	811.5'
L4	N 25°48' E	896.4'

GRID NORTH

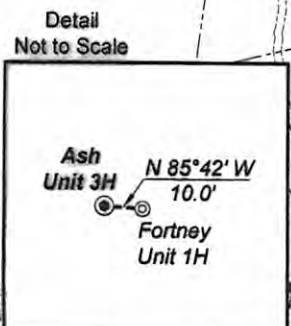

Notes:
 West Virginia Coordinate System of 1927, North Zone based upon Differential GPS Measurements.
 Well No. Ash Unit 3H Top Hole coordinates are
 N: 303862.73 Latitude: 39-19-50.75
 E: 1744761.02 Longitude: 80-24-08.37
 Bottom Hole coordinates are
 N: 308340.53 Latitude: 39-20-34.77
 E: 1742414.14 Longitude: 80-24-38.81
UTM Zone 17, NAD 1983
 Top Hole Coordinates: N: 4,353,663.010m E: 551,528.209m
 Bottom Hole Coordinates: N: 4,355,015.300m E: 550,790.493m
 Plat orientation and corner and well references are based upon the grid north meridian.
 Well location references are based upon the magnetic meridian.

- Legend**
- ⊙ Proposed gas well
 - Found corner, as noted
 - Surface boundary (approx.)
 - - - Interior surface tracts (approx.)
 - - - Creek or Drain
 - Existing Fenceline



FILE NO: 163-36-S-09
 DRAWING NO: 163-09_Ash 3H_Rev.dwg
 SCALE: 1" = 1000'
 MINIMUM DEGREE OF ACCURACY: Submeter
 PROVEN SOURCE OF ELEVATION: CORS Glenville, WV

STATE OF WEST VIRGINIA
DEPARTMENT OF ENVIRONMENTAL PROTECTION
OFFICE OF OIL AND GAS

DATE: July 2 20 12
 OPERATOR'S WELL NO. Ash Unit 3H
 API WELL NO.: _____
47 - 033 - 05672 #
 STATE COUNTY PERMIT
CANCELLED

I, the undersigned, hereby certify that this plat is correct to the best of my knowledge and belief and shows all the information required by law and the regulations issued and prescribed by the Department of Environmental Protection.

Dwayne D. Matheny
Dwayne D. Matheny, P.S. / 2070

WELL TYPE: OIL GAS LIQUID INJECTION WASTE DISPOSAL
 (IF GAS) PRODUCTION: STORAGE DEEP SHALLOW
 LOCATION: ELEVATION: 1222' WATERSHED Gregory Run & Tenmile Creek
 QUADRANGLE: Wolf Summit DISTRICT: Sardis COUNTY: Harrison
 SURFACE OWNER: Jeffrey & William Moss ACREAGE: 87
 OIL AND GAS ROYALTY OWNER: Archie B. Fortney, et al; Esther R. Phillips, et al LEASE NO: p/o 048029; 000726; 016605 ACREAGE: 95; 62.84
 PROPOSED WORK: DRILL CONVERT DRILL DEEPER FRACTURE OR STIMULATE PLUG OFF OLD FORMATION
 PERFORATE NEW FORMATION OTHER PHYSICAL CHANGE IN WELL (SPECIFY) _____
 PLUG AND ABANDON CLEAN OUT AND REPLUG TARGET FORMATION: Marcellus Shale ESTIMATED DEPTH: 7,000' TVD
12,750' MD

WELL OPERATOR: Antero Resources Appalachian Corporation DESIGNATED AGENT: Dianna Stamper - CT Corporation System
 ADDRESS: 1625 17th Street ADDRESS: 5400 D Big Tyler Road
Denver, CO 80202 Charleston, WV 25313 **01/09/2015**

