

Antero Resources  
Well No. Zirk Unit 1H  
Antero Resources  
Appalachian Corporation

	Bearing	Dist.
L1	S 69°48' E	747.0'
L2	S 28°29' E	995.1'
L3	S 58°30' W	507.5'
L4	N 76°58' E	797.3'
L5	N 16°19' W	791.6'

Zirk Unit 1H  
Bottom Hole

47-033-4316  
Wm S. &  
Janie Denoon  
1281/1195  
51.46 Ac.

2,671' to Bottom Hole

TOP HOLE LATITUDE 39 - 20 - 00  
BTM HOLE LATITUDE 39 - 22 - 30

Well Location References

Scale: 1" = 200'

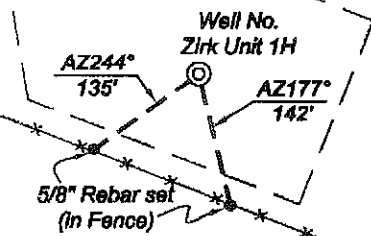

(⊕) Denotes location of well on United States topographic maps

Top Hole  
7.5' Spot

Tax Map 265 Parcels

Par	Owner	Bk/Pg	Acres
1 61	John & Catherine Jones	1321/929	39.75
2 88	James & Iris Wickenhofer	1135/396	54.0
3 54.3	Todd & Donna Smith	1232/823	2.24
4 52.1	A. J. Hustead, et al	160/180	4.02
5 32	Paul Hammond	265/32	4.34
6 25	Destin E. McGinnis, et ux	1150/864	1.07
7 22	Howard Swiger, et al	1383/1093	1.08

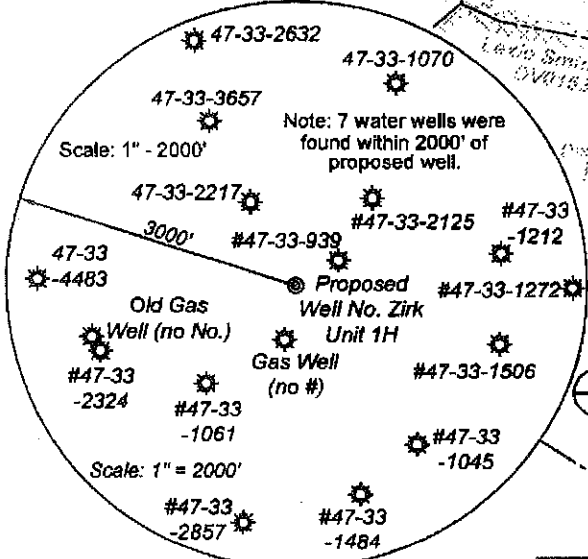
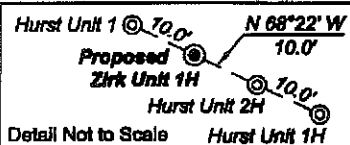

I, the undersigned, hereby certify that this plat is correct to the best of my knowledge and belief and shows all the information required by law and the regulations issued and prescribed by the Department of Environmental Protection.

Dwayne D. Matheny, P.S. 2070



**Notes:**  
West Virginia Coordinate System of 1927, North Zone based upon Differential GPS Measurements.  
Well No. Zirk Unit 1H Top Hole coordinates are  
N: 299,071.03' Latitude: 39°19'02.90"  
E: 1,739,829.77' Longitude: 80°25'10.50"  
Bottom Hole coordinates are  
N: 306,773.25' Latitude: 39°20'18.86"  
E: 1,738,197.31' Longitude: 80°25'32.28"  
UTM Zone 17, NAD 1983  
Top Hole Coordinates Bottom Hole Coordinates  
N: 4,352,178.140m N: 4,354,516.404m  
E: 550,050.152m E: 549,513.738m  
Plat orientation and corner and well references are based upon the grid north meridian.  
Well location references are based upon the magnetic meridian.

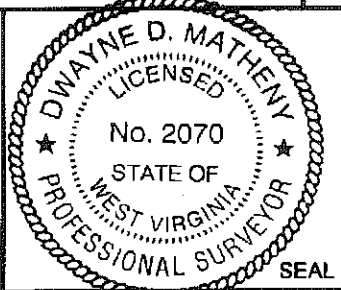

**Legend**  
 ⊕ Proposed gas well  
 ⊙ Found corner, as noted  
 ⊛ Found Well, as noted  
 --- Surface boundary (approx.)  
 - - - Interior surface tracts (approx.)  
 = Existing Road  
 --- Creek or Drain

FILE NO: 261-36-C-11  
 DRAWING NO: 261-11 Zirk Unit 1H  
 SCALE: 1" = 1000'  
 MINIMUM DEGREE OF ACCURACY: Submeter  
 PROVEN SOURCE OF ELEVATION: CORS Glenville, WV

STATE OF WEST VIRGINIA  
 DEPARTMENT OF ENVIRONMENTAL PROTECTION  
 OIL AND GAS DIVISION

DATE: February 24 20 12  
 OPERATOR'S WELL NO. Zirk Unit 1H  
 API WELL NO  
 47 - 033 - 05620  
 STATE COUNTY PERMIT

WELL TYPE:  OIL  GAS  LIQUID INJECTION  WASTE DISPOSAL  
 (IF GAS) PRODUCTION:  STORAGE  DEEP  SHALLOW  
 LOCATION: ELEVATION: 1176' WATERSHED: Katy Lick Run QUADRANGLE: Wolf Summit  
 DISTRICT: Sardis Burman B. Zirkle, et al 3893 & 3894 COUNTY: Harrison  
 CHESTER C. & LORENE M. YEATER AND LYNN LECHNER DV016803  
 SURFACE OWNER: John R. & Catherine W. Jones Taylor Ward, et al; Francis Strother, et al 14-265-22; 002257 ACREAGE: 39.75 48.75  
 HOWARD SWIGER & SANDRA TOOTHMAN 002272 & 078984 133; 124; 79.79  
 OIL & GAS ROYALTY OWNER: John Hurst, et ux & DTI; The Pittson Co., John Hurst, et ux LEASE #: p/o 045303; 002256 ACREAGE: 175; 1.08; 124; 13  
 PROPOSED WORK:  DRILL  CONVERT  DRILL DEEPER  FRACTURE OR STIMULATE  PLUG OFF OLD FORMATION  
 PERFORATE NEW FORMATION  OTHER PHYSICAL CHANGE IN WELL (SPECIFY) 7,500' TVD  
 PLUG AND ABANDON  CLEAN OUT AND REPLUG TARGET FORMATION: Marcellus Shale ESTIMATED DEPTH: 17,500' MD

WELL OPERATOR: Antero Resources Appalachian Corporation DESIGNATED AGENT: Dianna Stamper - CT Corporation System  
 ADDRESS: 1625 17th Street ADDRESS: 5400 D Big Tyler Road  
 Denver, CO 80202 Charleston, WV 25313