

Note: There appears to be 1 water wells within 1,000' of proposed well.

Notes:
Well site coordinates are
N: 301,185.69 Latitude: 39-19-24.64
E: 1,748,265.76 Longitude: 80-23-23.17
West Virginia
Coordinate System of 1927, North Zone
based upon
Differential GPS Measurements.
Plat orientation and corner and well
references are based upon the grid north
meridian.
Well location references are based upon
the magnetic meridian.

- Legend**
- Gas well (Proposed)
 - ⊙ Gas well (Existing)
 - Found corner, as noted
 - Surface boundary (approximate)
- (+) Denotes location of well on United States topographic maps

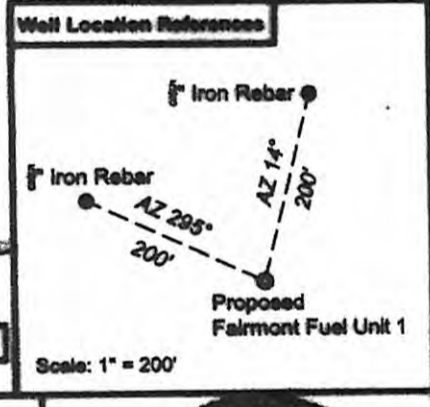

I, the undersigned, hereby certify that this plat is correct to the best of my knowledge and belief and shows all the information required by law and the regulations issued and prescribed by the Department of Environmental Protection.

Dwayne D. Matheny
Dwayne D. Matheny, P.S. 2070



FILE NO: 170-25-C-00
DRAWING NO: 170-25 Fairmont Fuel 1
SCALE: 1" = 500'
MINIMUM DEGREE OF ACCURACY: 1:2000
PROVEN SOURCE OF ELEVATION: HGS CORN GSSP

STATE OF WEST VIRGINIA
DEPARTMENT OF ENVIRONMENTAL PROTECTION
OFFICE OF OIL AND GAS

DATE: February 19 2010
OPERATOR'S WELL NO. Fairmont Fuel Unit 1
API WELL NO.:
47 033 05397
STATE COUNTY PERMIT

WELL TYPE: OIL GAS LIQUID INJECTION WASTE DISPOSAL
(IF GAS) PRODUCTION: STORAGE DEEP SHALLOW
LOCATION: ELEVATION: 1,295' WATERSHED Lambert's Run
QUADRANGLE: Wolf Summit DISTRICT: Coal COUNTY: Harrison
SURFACE OWNER: James & Meva Scarff ACREAGE: 74.15
OIL AND GAS ROYALTY OWNER: Joseph Haymond, et ux LEASE NO: 002136 ACREAGE: 223
PROPOSED WORK: DRILL CONVERT DRILL DEEPER FRACTURE OR STIMULATE PLUG OFF OLD FORMATION
 PERFORATE NEW FORMATION OTHER PHYSICAL CHANGE IN WELL (SPECIFY)
 PLUG AND ABANDON CLEAN OUT AND REPLUG TARGET FORMATION: Marcellus Shale ESTIMATED DEPTH: 7,150'

CANCELLED

WELL OPERATOR: Antero Resources Appalachian Corporation DESIGNATED AGENT: CT Corporation System
ADDRESS: 1625 17th Street ADDRESS: 707 Virginia Street East, 16th Floor
Denver, CO 80202 Charleston, WV 25300 04/11/2014