

Latitude 38° 50'

.825
.16 W

Longitude 80° 55'

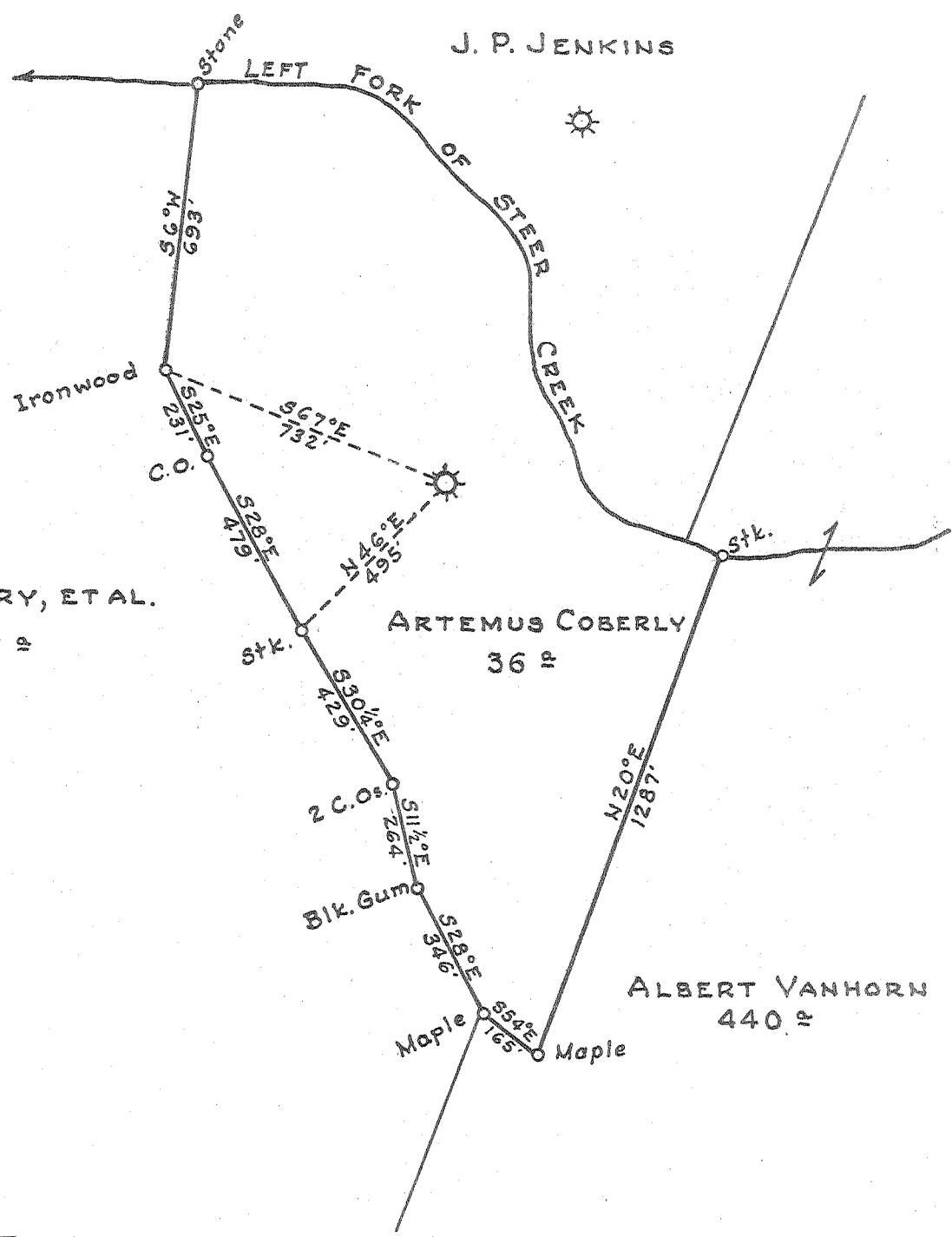

VIOLA CURRY, ETAL.
176 ±

ARTEMUS COBERLY
36 P

ALBERT VANHORN
440 ±

- New Location
- Drill Deeper
- Abandonment

Company BLAND & TOMPKINS
 Address CHARLESTON, W. VA.
 Farm ARTEMUS COBERLY
 Tract _____ Acres 36 Lease No. _____
 Well (Farm) No. 1 Serial No. 3745
 Elevation (Spirit Level) 847
 Quadrangle GLENVILLE
 County GILMER District CENTER
 Engineer P. E. JOACHIM
 Engineer's Registration No. 669
 File No. 100-91 Drawing No. _____
 Date OCT. 2, 1954 Scale 1" = 400'

STATE OF WEST VIRGINIA
DEPARTMENT OF MINES
OIL AND GAS DIVISION
CHARLESTON

WELL LOCATION MAP
FILE NO. GIL-417-A

+ Denotes location of well on United States Topographic Maps, scale 1 to 62,500, latitude and longitude lines being represented by border lines as shown.

- Denotes one inch spaces on border line of original tracing.



STATE OF WEST VIRGINIA
DEPARTMENT OF MINES
OIL AND GAS DIVISION

576

Hamille
Permit No. 4778

WELL RECORD

Oil or Gas Well (KIND)

Company Bland and Tompkins
 Address P. O. Box 1787- Charleston, W. Va.
 Farm Artemus Coberly Acres 36
 Location (waters) Left Fork of Steer Creek
 Well No. 1 (3745) Elev. 847'
 District Center County Gilmer
 The surface of tract is owned in fee by _____
 Address _____
 Mineral rights are owned by _____
 Address _____
 Drilling commenced December 1, 1924
 Drilling completed January 21, 1925
 Date Shot 10/17/27 From 1449' To 1476'
 With _____
 Open Flow _____ /10ths Water in _____ Inch
 _____ /10ths Merc. in _____ Inch
 Volume 53,000 Cu. Ft.
 Rock Pressure _____ lbs. _____ hrs.
 Oil _____ bbls., 1st 24 hrs.
 Fresh water _____ feet _____ feet
 Salt water _____ feet _____ feet

Casing and Tubing	Used in Drilling	Left in Well	Packers
Size			Kind of Packer
16			
13			
10		170'	Size of
8 1/4		915'	
6 5/8		1480'	Depth set
5 3/16			
3			Perf. top
2			Perf. bottom
Liners Used			Perf. top
			Perf. bottom

CASING CEMENTED _____ SIZE _____ No. Ft. _____ Date _____

COAL WAS ENCOUNTERED AT _____ FEET _____ INCHES
 _____ FEET _____ INCHES _____ FEET _____ INCHES
 _____ FEET _____ INCHES _____ FEET _____ INCHES

Formation	Color	Hard or Soft	Top	Bottom	Oil, Gas or Water	Depth Found	Remarks	
Dunkard			500	595	<p>Gas 1451-1476' Gas 1600-1605'</p>			
Dunkard			615	645				
Salt Sand			770	825				
Salt Sand			875	960				
Salt Sand			1150	1295				
Maxon Sand			1449	1482				
Big Lime			1560	1650				
Big Injun			1650	1727				
Total Depth				1788				

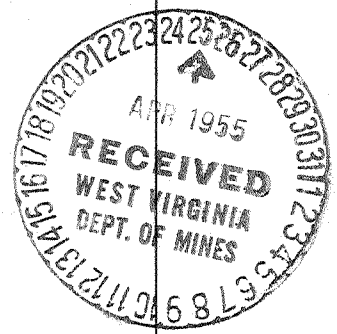

OCT 6 1955