

5.673
.47 W

SILAS B ROGERS
130 1/2 E

F. R. ROGERS

EDWARD LAWRENCE
25 1/2 E

J. A. PICHOLA
24 1/2 E

H. COOPER
46 3/4 E

G. A. COOPER
100 E

G. O. CAMDEN HAS
193 1/2 E

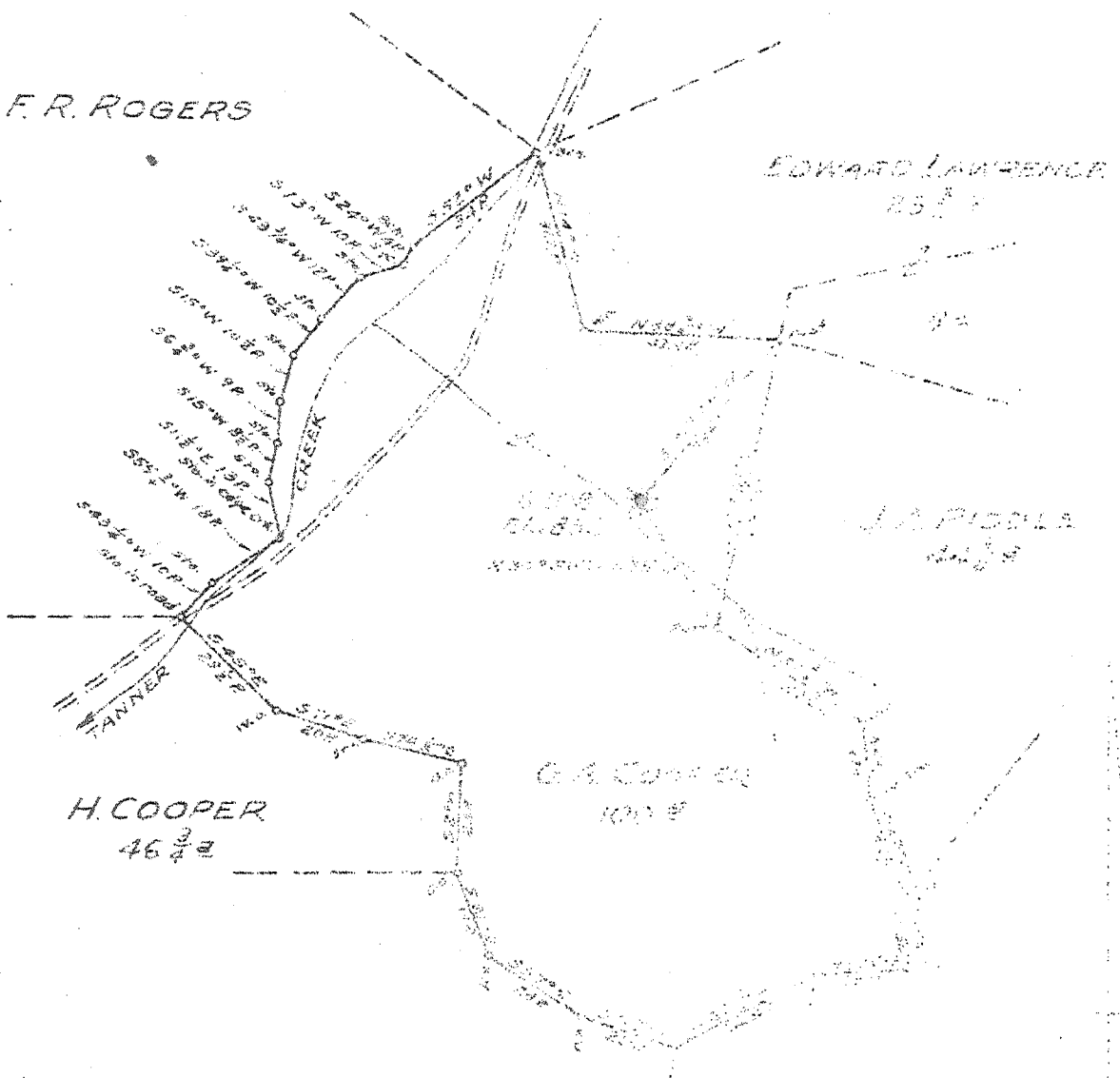

New Location

Drill Deeper

Abandonment

Map Sheet #2 Square 24 S 30 W R 13 759 F 16-17

Company HOPE NATURAL GAS CO.

Address CLARKSBURG, W. VA.

Farm G. A. COOPER

Tract _____ Acres 100 Lease No. 11031

Well (Farm) No. _____ Serial No. 6208

Elevation (Spirit Level) 832

Quadrangle HOLBROOK

County GILMER District DEKALB

Engineer W. M. Rowen

Engineer's Registration No. 900

File No. _____ Drawing No. _____

Date APRIL 29, 1944 Scale 1" = 400'

STATE OF WEST VIRGINIA
DEPARTMENT OF MINES
OIL AND GAS DIVISION
CHARLESTON

WELL LOCATION MAP
FILE NO. 314-201-A

* Denotes location of well on United States Topographic Maps, scale 1 to 62,500, latitude and longitude lines being represented by border lines as shown.

-- Denotes one foot spaces on border line of original tracing.

T. A. COOPER NO. 6208 WELL.
(G. A. - on plat).

Dekalb District, Gilmer County, W. Va.
By Hope Natural Gas Co., 445 W. Main St., Clarksburg, W. Va.
Abandoned under permit Gil-201-A.
On 100 acres.
Elevation, 832' L.
Surface owned by Hayden Ellison, Coxs Mills, W. Va.
Drilling commenced Oct. 13, 1922; completed Nov. 1, 1922.
Shot Nov. 3, 1922, at 1693-1708', with 25 qts. glycerine.
Fresh water at 1477'.
10" casing, 115' (pulled); 8 $\frac{1}{4}$ " , 741'; 6 $\frac{5}{8}$ " , 1644'.
Casing not cemented. No coal was encountered.
Gas well. Abandonment reported to Dept. of Mines April 28, 1944.
Record to RCT from Mrs. Griffith June 9, 1944.

	Top.	Bottom.
Little Dunkard Sand, soft	680	- 718
Big Dunkard Sand, hard	745	- 796
First Salt Sand, close	945	- 1121
Second Salt Sand (fresh water, 1477')	1370	- 1487
Maxton Sand (gas, 1587')	1556	- 1601
Little Lime	1605	- 1621
Pencil Cave	1621	- 1626
Big Lime	1626	- 1681
Big Injun Sand (gas, 1692-1709')	1681	- 1744
Total depth		1745

STATE OF WEST VIRGINIA
DEPARTMENT OF MINES
OIL AND GAS DIVISION

342

WELL RECORD

Permit No. 201-A

Oil or Gas Well Gas
(KIND)

Company Hope Natural Gas Company
Address 445 W. Main St. Clarksburg, W. Va.
Farm T. A. Cooper Acres 100
Location (waters) (GA - Hunt 832)
Well No. 6208 Elev. 832
District DeKalb County Gilmer
The surface of tract is owned in fee by Hayden Ellison
Address Coxs Mills, W. Va.

Mineral rights are owned by _____
Address _____
Drilling commenced 10-13-22
Drilling completed 11-1-22
Date Shot 11/3/22 From 1693 To 1708
With 25 qts. glycerine

Open Flow /10ths Water in _____ Inch
/10ths Merc. in _____ Inch
Volume _____ Cu. Ft.
Rock Pressure _____ lbs. _____ hrs.
Oil _____ bbls., 1st 24 hrs.
Fresh water 1477 feet _____ feet
Salt water _____ feet _____ feet

Casing and Tubing	Used in Drilling	Left in Well	Packers
Size			Kind of Packer
16.			
13.			
10.	<u>115</u>	<u>Pulled</u>	Size of
8 3/4	<u>741</u>	<u>741</u>	Depth set
6 5/8	<u>1644</u>	<u>1644</u>	
5 3/16			Perf. top
3.			Perf. bottom
2.			Perf. top
Liners Used			Perf. bottom

CASING CEMENTED _____ SIZE _____ No. Ft. _____ Date _____
None

COAL WAS ENCOUNTERED AT None FEET _____ INCHES
None FEET _____ INCHES FEET _____ INCHES
_____ FEET _____ INCHES FEET _____ INCHES

Formation	Color	Hard or Soft	Top	Bottom	Oil, Gas or Water	Depth Found	Remarks
Little Dunk.		Soft	680	718			
Big Dunkard		Hard	745	796			
First Salt		Close	945	1121			
Second Salt		Hard	1370	1487	Water	1477 - Fresh	
Maxon			1556	1601	Gas	1587	
Little Lime			1605	1621			
Pencil Cave			1621	1626			
Big Lime			1626	1681			
Big Injun		1681	1744	1744	Gas	1682-1709	
Total depth				1745			

