

LATITUDE 39° 06' 00"

00' 55" 08 LONGITUDE



1.460
1.920

7'5 OGIS topo location

7.5' loc _____ 15' loc _____
(calc.) _____

Company _____

Farm _____

Quad Tanner 7 1/2

County Gilmer

District DeKalb

WELL LOCATION MAP

File No. 021 - 30073

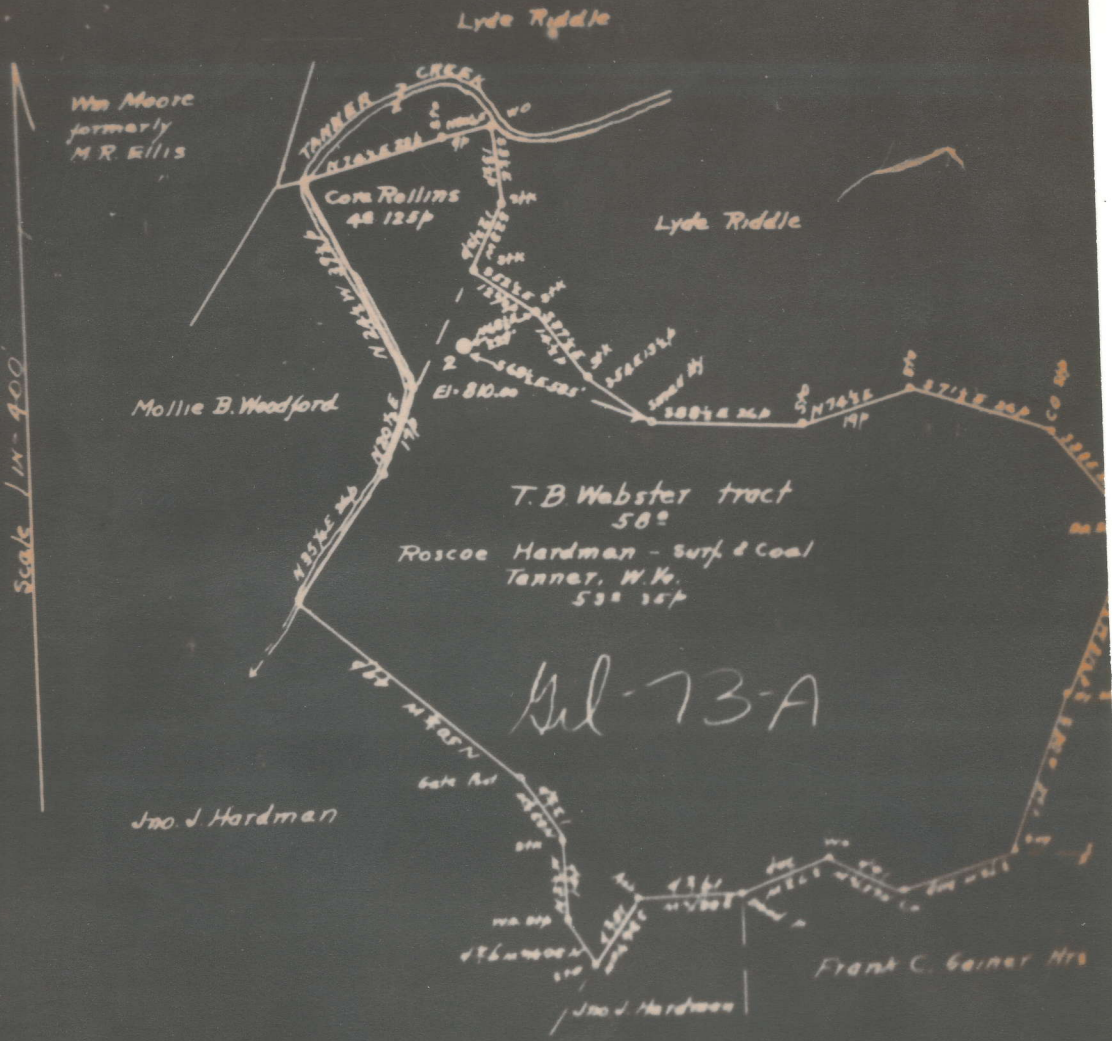

South Penn Oil Co
 Survey for abandonment of Well No. 2 T.B Webster
 DeKalb Dist. Gilmer Co. W.V. 1935

DeKalb District, Gilmer County, W. Va.

South Penn Oil Co., Chamber of Commerce Bldg., Pittsburgh, Pa.

On 60 acres, surface owned by Roscoe Hardman, Tanner, W. Va., and mineral rights by R. C. Webster et al., Tanner, W. Va.

Elevation, 810'.

15' conductor; 10" casing, 315' (pulled); 8 $\frac{1}{4}$ ", 747'; 6-5/8", 1550'.

Abandonment reported to Dept. of Mines May 21, 1935.

Well was shot in Maxton Sand with 80 qts. June 26, 1922; and with bomb shot, March 20, 1935.

Fresh water at 120'.

	Top.	Bottom.
Red rock	0	40
Slate and shells (hole full water, 120')	40	140
Red rock	140	155
White slate (hole full water, 200')	155	274
Sand	274	312
White slate	312	338
Red rock	338	465
White slate	465	495
Red rock	495	515
Slate and shells	515	553
Lime and shells	553	563
Red rock	563	580
Lime and shells (show gas, 585')	580	595
White slate	595	665
Little Dunkard Sand	665	714
Slate	714	742
Big Dunkard Sand	742	760
White slate	760	820
Gas Sand	820	905
White slate	905	970
1st Salt Sand	970	1080
Black slate	1080	1230
2nd Salt Sand	1230	1290
Black slate	1290	1360
Lime and slate	1360	1528
Red rock	1528	1543
Black slate	1543	1548
Maxton Sand (gas, 1572'; oil, 1584-1590')	1548	1596
Slate, to bottom	1596	1598

Well No. 1, T. B. Webster Park.

Name	Color	Character	Oil Gas or Water	Top	Bottom	Thickness	Total Depth	Remarks
Red Rock				0	40			
Slate & Shells				40	140			
Red Rock				140	155			
White Slate				155	274			
		Water			180			Hole full
Sand				274	312			
White Slate				312	338			
Red Rock				338	465			
White Slate				465	495			
Red Rock				495	515			
Slate & Shells				515	553			
Lime & Shells				553	563			
Red Rock				563	580			
Lime & Shells				580	595			
		Show gas			585			
White Slate				595	665			
Little Dunkard Sand				665	714			
Slate				714	742			
Big Dunkard Sand				742	760			
White Slate				760	820			
Gas Sand				820	905			
White Slate				905	970			
1st Salt Sand				970	1080			
Black Slate				1080	1230			
2nd Salt Sand				1230	1290			
Black Slate				1290	1360			
Lime & Slate				1360	1528			
Red Rock				1528	1543			
Black Slate				1543	1548			1550-678
Maxon Sand				1548	1596			
		Gas			1572			
		Oil		1584	1590			
Slate				1596	1598			
Total Depth							1598	

shot
Well was ~~run~~ at MAXON 80 qt. 5-26-22 feet; well was shot at MAXON Bomb shot 3-20-35 feet.

Salt
Fresh water at 120 feet; salt
feet; fresh water at _____ feet.

producing
Well was _____ hole.
SIX

SOUTH PENN. OIL COMPANY,
Pittsburgh, Pa.

PRELIMINARY DATA SHEET NO. 1

File No.

5

SOUTH PENN OIL
Pittsburgh, Pa.

Chamber of Commerce Bldg.
T. B. Webster

containing 60

acres, Location

De Kalb

District, in Gilmer

County, West Virginia

The surface of the above tract is owned in fee by Roscoe Hardum

of Tanner, W. Va.

address, and the mineral rights are owned by

R. C. Webster et al

of Tanner, W. Va.

The oil and gas privileges are held under lease by the above named company, and this well is drilled under permit No. _____ issued by the West Virginia Department of Mines, Oil and Gas Division

193

Elevation of surface at top of well, 810'

Spirit
Barometric.

The number of feet of the different sized casings used in the well.

	15	feet		size.	Wood conductor.
315 (Pulled)	feet	10"	size, csg.	feet	sized csg.
747	feet	8-1/4"	size, csg.	feet	sized csg.
1550	feet	6-5/8"	size, csg.	feet	sized csg.
		packer of		size, set at	
		packer of		size, set at	
		, in casing perforated at		feet to	feet.
		, in casing perforated at		feet to	feet.

Coal was encountered at _____ feet, thickness _____ inches, and at _____ feet; thickness _____ inches; and at _____ feet; thickness _____ inches.

Liners were used as follows: (Give details)

May 21, 1935.

Date

Approved

SOUTH PENN OIL COMPANY, Owner

AFFIDAVIT IN TRIPLICATETO TIME AND MANNER OF PLUGGING AND FILLING WELL

(REQUIRED BY SECTION 8, ARTICLE 4, CHAPTER 22 OF THE CODE)

WEST VIRGINIA DEPARTMENT OF MINES OIL AND GAS DIVISION

(NO COAL)

SOUTH PENN OIL COMPANY

COAL OPERATOR OR OWNER

Chamber of Commerce Bldg. Pittsburgh, Pa.

ADDRESS

COMPLETE ADDRESS

COAL OPERATOR OR OWNER

August 6, 19 35.

WELL AND LOCATION

ADDRESS

DeKalb District

COAL OPERATOR OR OWNER

Gilmer County

ADDRESS

Well No 2

T. B. Fabster Farm

AFFIDAVIT TO BE MADE IN TRIPLICATE ONE COPY TO BE MAILED BY REGISTERED MAIL TO THE DEPARTMENT THIS COPY TO BE RETURNED BY THE MAIL OPERATOR AND THE THIRD COPY (AND EXTRA COPIES IF REQUIRED) TO BE MAILED TO EACH LOCAL OPERATOR UNDER POWER OF THEIR RESPECTIVE JURISDICTIONS

AFFIDAVIT

STATE OF WEST VIRGINIA,

COUNTY OF Roane

W. K. McCray

being first duly sworn according to law depose and say that they are experienced in the work of plugging

and filling oil and gas wells and were employed by South Penn Oil Company and participated in the work of plugging and filling the above well, that said work was commenced on the

17th day of June, 19 35, and that the well was plugged and filled in the following manner:

Manner in which said well was plugged:

Total Depth 1596'. Filled with non-porous material to 1565'. Set 6-5/8" common wood dry hole plug 1565' to 1562'. Set cement plug 1562' to 1207' 6-5/8" casing would not pull. Cut casing at 1367' and pulled. Hole again plugged and filled up to 1207' after pulling 6-5/8" casing. Set 8-1/4" common wood dry hole plug 1207' to 1204'. Set cement plug 1204' to 1194'. Filled with non-porous material to 950'. Set 8-1/4" common wood dry hole plug 950' to 947'. Set cement plug 947' to 937'. Filled with non-porous material to 790'. Set 8-1/4" common wood dry hole plug 790' to 787'. Set cement plug 787' to 784'. Filled with non-porous material to 519'. Set cement plug 519' to 509'. Filled with non-porous material to 330'. Set wood plug 330' to 327'. Set cement plug 327' to 317'. Filled with non-porous material to surface.

Description of monument: Set in hole a piece of 2 1/2" casing for 17 ft. hole 17 ft. and extends above surface 4 ft. Filled inside of casing with and non-porous material within one foot of top. Put in one foot of cement top of marker in which is anchored a brass plate giving date, location, well number, farm name and company. All done in workmanlike manner.

(THE ABOVE DESCRIPTIONS MUST BE IN DETAIL AND IN ACCORDANCE WITH THE PROVISIONS OF SECTION 8, ARTICLE 4, CHAPTER 22 OF THE CODE)

and that the work of plugging and filling said well was completed on the 16th day of July

19 35.

And further deposes with not.

