

(+) DENOTES LOCATION OF WELL ON UNITED STATES TOPOGRAPHIC MAPS

FILE NO. _____
 DRAWING NO. 14-B
 SCALE 1"=500'
 MINIMUM DEGREE OF ACCURACY 1 IN 200
 PROVEN SOURCE OF ELEVATION GPS

I THE UNDERSIGNED, HEREBY CERTIFY THAT THIS PLAT IS CORRECT TO THE BEST OF MY KNOWLEDGE AND BELIEF AND SHOWS ALL THE INFORMATION REQUIRED BY LAW, AND THE REGULATIONS ISSUED AND PRESCRIBED BY THE DEPARTMENT OF ENERGY.

(SIGNED) _____
 R.P.E. _____ L.L.S. 851



STATE OF WEST VIRGINIA
 Division of Environmental Protection
 OFFICE OF OIL AND GAS

DATE 3/7, 2014
 OPERATOR'S WELL NO. TALBOTT #5
 API WELL NO. 47-021-05772
 STATE COUNTY PERMIT

WELL TYPE: OIL GAS LIQUID INJECTION _____ WASTE DISPOSAL _____
 (IF "GAS") PRODUCTION STORAGE _____ DEEP _____ SHALLOW

LOCATION: ELEVATION 773 WATER SHED LEADING CREEK
 DISTRICT DeKALB COUNTY GILMER
 QUADRANGLE GLENVILLE

SURFACE OWNER CHARLES E. TALBOTT ACREAGE 128.75
 OIL & GAS ROYALTY OWNER CHARLES E. TALBOTT & OTHERS LEASE ACREAGE 128.75
 LEASE NO. _____

PROPOSED WORK: DRILL CONVERT _____ DRILL DEEPER _____ REDRILL _____ FRACTURE OR STIMULATE PLUG OFF OLD FORMATION _____ PERFORATE NEW FORMATION _____ OTHER PHYSICAL CHANGE IN WELL (SPECIFY): _____

PLUG AND ABANDON _____ CLEAN OUT AND REPLUG _____

TARGET FORMATION BIG INJUN ESTIMATED DEPTH 1900
 WELL OPERATOR ROY G. HILDRETH & SON DESIGNATED AGENT ROY G. HILDRETH JR.
 ADDRESS PO. BOX 1007 ADDRESS PO. BOX 1007
 SPENCER, WV 25276 SPENCER, WV 25276

Oil Wells

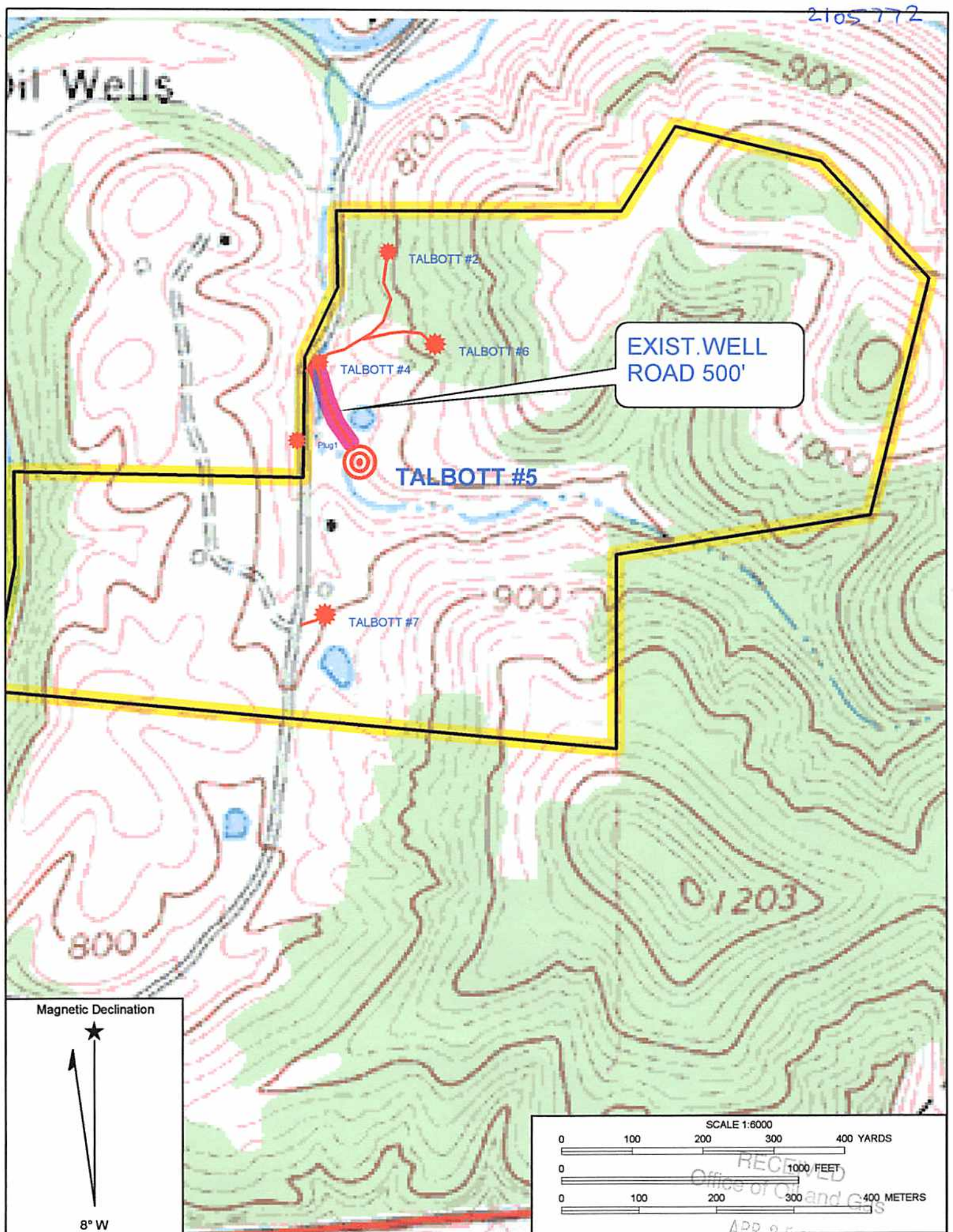

Magnetic Declination

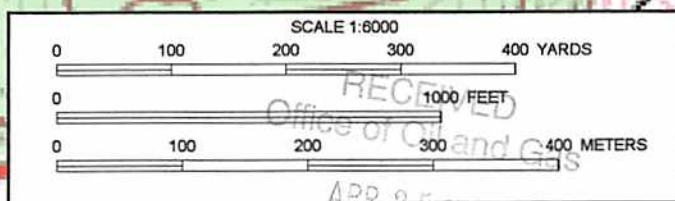

APR 25 2014

WV Department of Energy