





2105107P

Topo Quad: Auburn 7.5' Scale: 1" = 2000'  
 County: Gilmer Date: February 26, 2014  
 District: Troy Project No: 25-19-00-07

47-021-05107 WV 157171 (Keller Well # W 362 R)

Topo

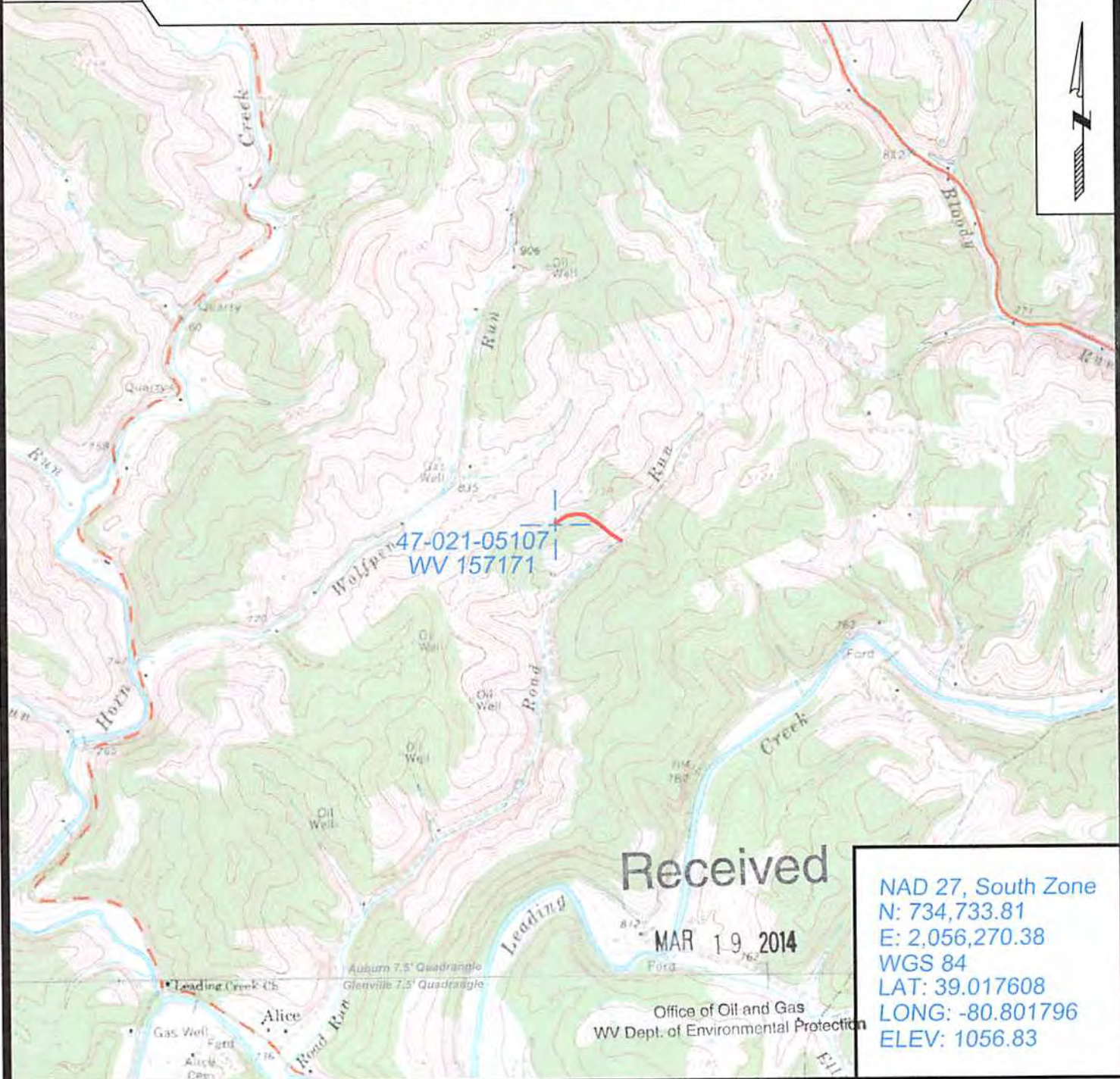

NAD 27, South Zone  
 N: 734,733.81  
 E: 2,056,270.38  
 WGS 84  
 LAT: 39.017608  
 LONG: -80.801796  
 ELEV: 1056.83



SURVEYING AND MAPPING SERVICES PERFORMED BY:  
**ALLEGHENY SURVEYS, INC.**  
 1-800-482-8606  
 P.O. BOX 438  
 BIRCH RIVER, WV 26610  
 PH: (304) 649-8606  
 FAX: (304) 649-8608

PREPARED FOR:  
**EQT Production Company**  
 P.O. Box 280  
 Bridgeport, WV 26330