

Plot Card CSD

LATITUDE 39° 02' 30"

WRIGHT "B" LEASE

WELL NO. WACO-318

PEGGS N 63 E 462' E / C

WRIGHT N 50 E 742.5'

S 35 E 445.5'

WACO-317

N 1-00 W 705.84'

16" SCARLET OAK
BUSH

S 7-40 E 599.57'

1.205
1.000
2.20
1.325

N 66-49 W 1256.95'

24" WHITE OAK

WELL NO. WACO-318 N 31-15 E 130.45'

S 5 W 478.5'

54 ACRES ±

4.085
3.230
3.23 W

68 ACRES ± TOTAL

S 25 W 511.5'

EMERSON

S 77 E 115.5' N 76-30 E 396'

N 22 E 660'

68

14 ACRES ±

S 49 W 462'

BUSH

S 80 W 528'

BUSH

N 70 E 334.1'

E / C
N 44-30 W 255.75'

REFERENCES

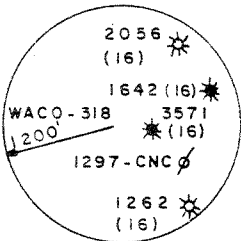
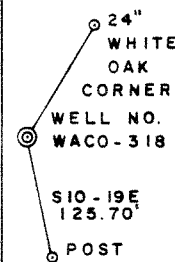

FILE NO. 14 - 27
 DRAWING NO. _____
 SCALE 1" = 400'
 MINIMUM DEGREE OF ACCURACY 1 / 200
 PROVEN SOURCE OF ELEVATION JUNCT. OF ROADS ELEV. 760'

I THE UNDERSIGNED, HEREBY CERTIFY THAT THIS PLAT IS CORRECT TO THE BEST OF MY KNOWLEDGE AND BELIEF AND SHOWS ALL THE INFORMATION REQUIRED BY LAW AND THE REGULATIONS ISSUED AND PRESCRIBED BY THE DEPARTMENT OF MINES.

(SIGNED) Gregory A. Smith
 R.P.E. _____ L.L.S. 677

PLACE SEAL HERE

(+) DENOTES LOCATION OF WELL ON UNITED STATES TOPOGRAPHIC MAPS

FORM IV-6 (8-78)



DATE MAY 17, 19 84
 OPERATOR'S WELL NO. WACO-318
 API WELL NO. _____
47 - 021 - 4203
 STATE COUNTY PERMIT

STATE OF WEST VIRGINIA
 DEPARTMENT OF MINES
 OIL AND GAS DIVISION

WELL TYPE: OIL ___ GAS X LIQUID INJECTION ___ WASTE DISPOSAL ___
 (IF "GAS") PRODUCTION X STORAGE ___ DEEP ___ SHALLOW X

LOCATION: ELEVATION 1140' WATERSHED HORN CREEK

DISTRICT TROY COUNTY GILMER

QUADRANGLE 224 AUBURN 7.5' Nolbrook 151 SEg

SURFACE OWNER DOY WRIGHT, et. ux. ACREAGE 68

OIL & GAS ROYALTY OWNER DOY WRIGHT, et. ux. LEASE ACREAGE 68

LEASE NO. _____

PROPOSED WORK: DRILL X CONVERT ___ DRILL DEEPER ___ REDRILL ___ FRACTURE OR STIMULATE X PLUG OFF OLD FORMATION ___ PERFORATE NEW FORMATION ___ OTHER PHYSICAL CHANGE IN WELL (SPECIFY) _____

PLUG AND ABANDON ___ CLEAN OUT AND REPLUG ___

TARGET FORMATION ELK ESTIMATED DEPTH 5350'

WELL OPERATOR WACO OIL & GAS CO., INC. DESIGNATED AGENT KENNY GREENLIEF

ADDRESS P.O. BOX 4 ADDRESS P.O. BOX 4
GLENVILLE, WV 26351 GLENVILLE, WV 26351

JUL 9 1984

6-6 Conings

(142)

RECEIVED

AUG 14 1984



IV-35
(Rev 8-81)

OIL & GAS DIVISION
DEPT. OF MINES
State of West Virginia
Department of Mines
Oil and Gas Division

Date 8/8/84
Operator's _____
Well No. Waco - 318
Farm Wright
API No. 47 - 021 - 4203

WELL OPERATOR'S REPORT
OF
DRILLING, FRACTURING AND/OR STIMULATING, OR PHYSICAL CHANGE

WELL TYPE: Oil ___ / Gas X / Liquid Injection ___ / Waste Disposal ___ /
(If "Gas," Production X / Underground Storage ___ / Deep ___ / Shallow X /)

LOCATION: Elevation: 1140 Watershed Horn Creek
District: Troy County Gilmer Quadrangle Auburn

COMPANY WACO OIL & GAS CO., INC.
ADDRESS 1297 N. Lewis St., Glenville, WV
DESIGNATED AGENT Kenneth Greenlief
ADDRESS 1297 N. Lewis St., Glenville, WV
SURFACE OWNER D. Wright
ADDRESS Bridgeport, WV 26330
MINERAL RIGHTS OWNER D. Wright
ADDRESS Bridgeport, WV 26330
OIL AND GAS INSPECTOR FOR THIS WORK Deo
Mace ADDRESS Sandridge, WV
PERMIT ISSUED 6/27/84
DRILLING COMMENCED 7/14/84
DRILLING COMPLETED 7/20/84
IF APPLICABLE: PLUGGING OF DRY HOLE ON
CONTINUOUS PROGRESSION FROM DRILLING OR
REWORKING. VERBAL PERMISSION OBTAINED
ON _____

Casing Tubing	Used in Drilling	Left in Well	Cement fill up Cu. ft.
Size 20-16 Cond.			
13-10"			
9 5/8			
8 5/8	824	824	225 sks
7			
5 1/2			
4 1/2		4850	650 sks
3			
2			
Liners used			

GEOLOGICAL TARGET FORMATION Elk Depth 5300 feet
Depth of completed well 4948 feet Rotary X / Cable Tools _____
Water strata depth: Fresh 48 feet; Salt None feet
Coal seam depths: None Is coal being mined in the area? No

OPEN FLOW DATA

Producing formation Benson Pay zone depth See treatment feet
Gas: Initial open flow _____ Mcf/d Oil: Initial open flow _____ Bbl/d
Final open flow 855 Mcf/d Final open flow _____ Bbl/d
Time of open flow between initial and final tests 4 hours
Static rock pressure 1700 psig (surface measurement) after 48 hours shut in
(If applicable due to multiple completion--)
Second producing formation _____ Pay zone depth _____ feet
Gas: Initial open flow _____ Mcf/d Oil: Initial open flow _____ Bbl/d
Final open flow _____ Mcf/d Oil: Final open flow _____ Bbl/d
Time of open flow between initial and final tests _____ hours
Static rock pressure _____ psig (surface measurement) after _____ hours shut in

SEP 24 1984 (Continued on reverse side)

FORM IV-35
(REVERSE)

DETAILS OF PERFORATED INTERVALS, FRACTURING OR STIMULATING, PHYSICAL CHANGE, ETC.

BENSON - 4790 to 4800 - 500 Gal 15% Hcl, (30,000# 20-40) 70 MCF N₂

WELL LOG

FORMATION	COLOR	HARD OR SOFT	TOP FEET	BOTTOM FEET	REMARKS
					Including indication of all fresh and salt water, coal, oil and gas
Clay			0	4	
Sand, Shale, Red Rock			4	1005	½" fresh water @ 48'
Little Lime			1893	1920	
Shale			1920	1940	
Big Lime			1940	2044	
Big Injun			2044	2090	
Sand and Shale			2090	3220	
Speechly Section			3220	3910	
Balltown Section			3910	4390	
Riley Section			4390	4790	Gas @ TD 58/10 - 1" w/w
<u>Benson</u>			4790	4830	
Shale			4830	<u>4948</u>	TD

(Attach separate sheets as necessary)

WACO OIL & GAS CO., INC.

Well Operator

By: Kenneth Greenlief *Kenneth Greenlief*

Date: August 9, 1984

Note: Regulation 2.02(i) provides as follows:
 "The term 'log' or 'well log' shall mean a systematic detailed geological record of all formations, including coal, encountered in the drilling of a well."



1) Date: June 11, 1984, 19__
 2) Operator's Well No. Waco #318
 3) API Well No. 47 - 021 - 4203
 State County Permit

STATE OF WEST VIRGINIA
 DEPARTMENT OF MINES, OIL AND GAS DIVISION
APPLICATION FOR A WELL WORK PERMIT

- 4) WELL TYPE: A Oil / Gas X
 B (If "Gas", Production X / Underground storage / Deep / Shallow X)
- 5) LOCATION: Elevation: 1140' Watershed: Horn Creek (LK 75 F)
 District: Troy County: Gilmer Quadrangle: Auburn 7.5'
- 6) WELL OPERATOR Waco Oil & Gas Co., Inc.
 Address 1297 N. Lewis Street
Glennville, WV 26351
- 7) DESIGNATED AGENT Kenneth Greenlief
 Address 1297 N. Lewis Street
Glennville, WV 26351
- 8) OIL & GAS INSPECTOR TO BE NOTIFIED
 Name Deo Mace
 Address Route 1, Box 5
Sandridge, WV 25274
- 9) DRILLING CONTRACTOR:
 Name T. L. Morris Well Service, Inc.
 Address 1297 N. Lewis Street
Glennville, WV 26351
- 10) PROPOSED WELL WORK: Drill X / Drill deeper / Redrill / Stimulate X
 Plug off old formation / Perforate new formation
 Other physical change in well (specify)
- 11) GEOLOGICAL TARGET FORMATION, Elk
- 12) Estimated depth of completed well, 5500 feet
- 13) Approximate strata depths: Fresh, 125 feet; salt, none feet.
- 14) Approximate coal seam depths: none Is coal being mined in the area? Yes

RECEIVED
 JUN 14 1984
 OIL & GAS DIVISION
 DEPT. OF MINES

15) CASING AND TUBING PROGRAM

CASING OR TUBING TYPE	SPECIFICATIONS					FOOTAGE INTERVALS		CEMENT FILL-UP OR SACKS (Cubic feet)	PACKERS
	Size	Grade	Weight per ft.	New	Used	For drilling	Left in well		
Conductor									Kinds
Fresh water									
Coal									Sizes
Intermediate	8 5/8		20	X		870	870	150 sacks	CTS NEAT
Production	4 1/2		10.5	X			5500	575 sacks	Depths set
Tubing									
Liners									Perforations:
									Top Bottom

OFFICE USE ONLY
 DRILLING PERMIT

Permit number 47-021-4203 Date June 27, 19 84

This permit covering the well operator and well location shown below is evidence of permission granted to drill in accordance with the pertinent legal requirements subject to the conditions contained herein and on the reverse hereof. Notification must be given to the District Oil and Gas Inspector, (Refer to No. 8) Prior to the construction of roads, locations and pits for any permitted work. In addition, the well operator or his contractor shall notify the proper district oil and gas inspector 24 hours before actual permitted work has commenced.)

The permitted work is as described in the Notice and Application, plat, and reclamation plan, subject to any modifications and conditions specified on the reverse hereof.
 Permit expires June 27, 1986 unless well work is commenced prior to that date and prosecuted with due diligence.

Bond: BLANKET	Agent: <u>LS</u>	Plat: <u>MW MW</u>	Casing: <u> </u>	Fee: <u>1087</u>
-------------------------	---------------------	-----------------------	------------------------------	---------------------

T. L. Morris
 Administrator, Office of Oil and Gas

NOTE: Keep one copy of this permit posted at the drilling location.