

LATITUDE 38° 52' 30"

7 1/2
0.410
1173w

LONGITUDE 80° 57' 30"

NORTH

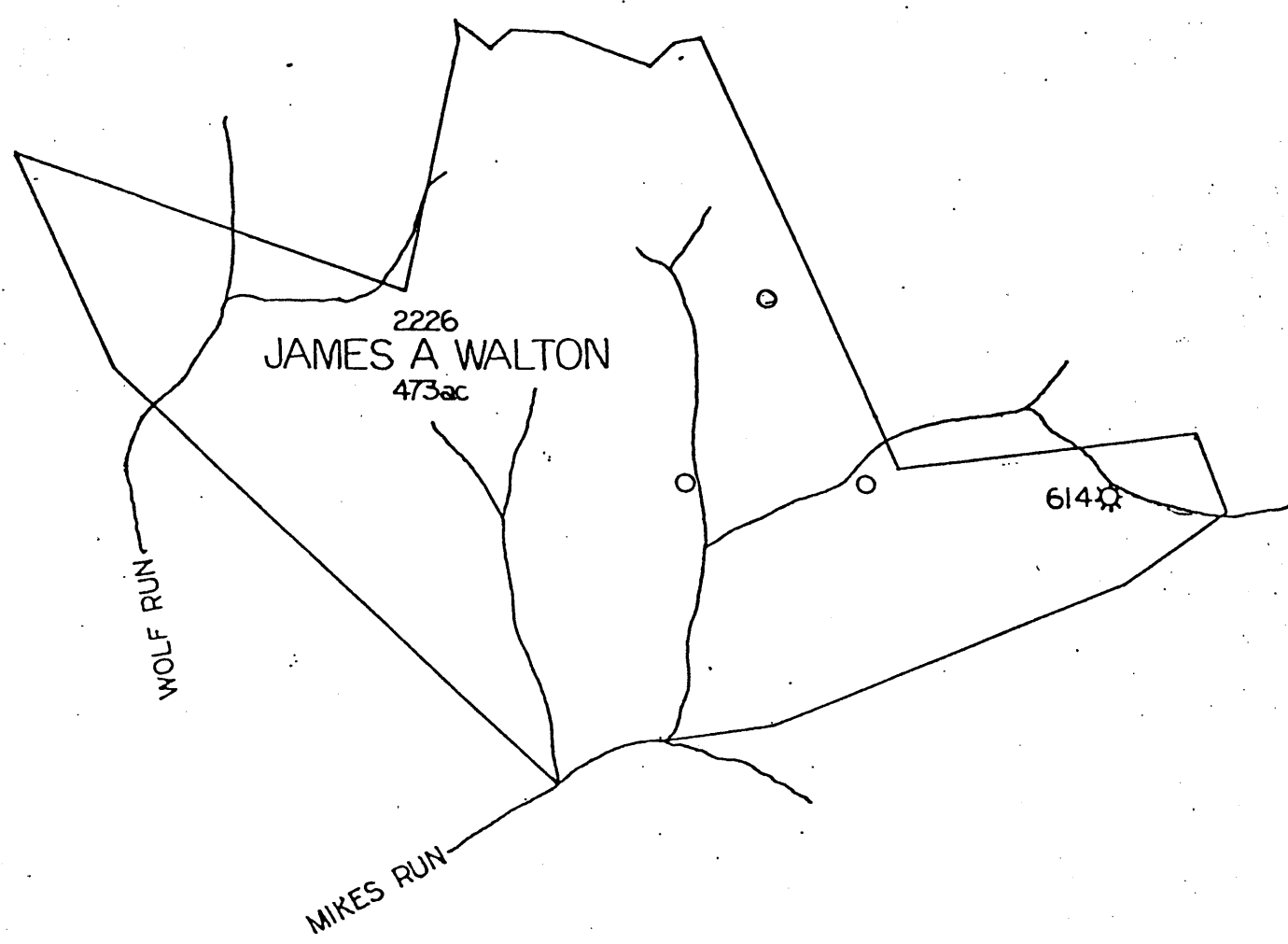

SOUTHEASTERN GAS COMPANY
AND AFFILIATED COMPANIES
P. O. BOX 2347
CHARLESTON, W. VA. 25328

FILE NO. _____
DRAWING NO. _____
SCALE _____
MINIMUM DEGREE OF
ACCURACY _____
PROVEN SOURCE OF
ELEVATION _____

I THE UNDERSIGNED, HEREBY CERTIFY
THAT THIS PLAT IS CORRECT TO THE
BEST OF MY KNOWLEDGE AND BELIEF AND
SHOWS ALL THE INFORMATION REQUIRED
BY LAW AND THE REGULATIONS ISSUED
AND PRESCRIBED BY THE DEPARTMENT OF
MINES.
(SIGNED) _____

R.P.E. _____ L.L.S. _____

PLACE SEAL HERE

(+) DEMOTES LOCATION OF
WELL ON UNITED STATES
TOPOGRAPHIC MAPS

FORM IV-6
(8-78)



DATE _____, 19____
OPERATOR'S WELL NO _____
API WELL NO. _____
47 - 021 - 3581
STATE COUNTY PERMIT

STATE OF WEST VIRGINIA
DEPARTMENT OF MINES
OIL AND GAS DIVISION

WELL TYPE: OIL _____ GAS _____ LIQUID INJECTION _____ WASTE DISPOSAL _____
(IF "GAS", PRODUCTION _____ STORAGE _____ DEEP _____ SHALLOW _____
LOCATION: ELEVATION _____ WATER SHED _____
DISTRICT Center COUNTY _____
QUADRANGLE _____

SURFACE OWNER _____ ACREAGE _____
OIL & GAS ROYALTY OWNER _____ LEASE ACREAGE _____
LEASE NO. _____

PROPOSED WORK: DRILL _____ CONVERT _____ DRILL DEEPER _____ RE-DRILL _____ FRACTURE OR
STIMULATE _____ PLUS OFF OLD FORMATION _____ PERFORATE NEW
FORMATION _____ OTHER PHYSICAL CHANGE IN WELL (SPECIFY) _____

PLUG AND ABANDON _____ CLEAN OUT AND RE-PLUG _____
TARGET FORMATION _____ ESTIMATED DEPTH _____
WELL OPERATOR _____ DESIGNATED AGENT _____
ADDRESS _____ ADDRESS _____

PERMITS TO DRILL AND WELLS COMPLETED, 1980

(SUPPLEMENT SHEET)

PERMIT NUMBER	WELL OPERATOR	FARM	WELL NUMBER	ELEV.	DISTRICT	TOTAL DEPTH	OIL-GAS DRY	DATE ISSUED	DATE COMPLETED	INITIAL OPI FLOW GAS - Cu. Ft. - bbls
3577 -	Bowser Gas & Oil Company	Robert Mitchell	5		Dekalb					
3578 -	Pennzoil Company	F. S. Bennett	1		Center					
3579 -	Bell Oil & Gas	Lillie Wigner	1		Tanner					
3580 -	Southeastern Gas Company	Emma Delong	613		Center					
3581 -	Southeastern Gas Company	Emma Delong	614		Center					
3583 -	William Grambling	Miller - Bassett	1		Dekalb					
3584 -	Bowser Oil & Gas Company	Robert Mitchell	1		Dekalb					
3585 -	Bowser Oil & Gas Company	Robert Mitchell	3		Dekalb					
3587 -	Gilco Gas, Inc.	J. J. & O. W. Gerwig	2		Center					
3588 -	Gilco Gas, Inc.	J. J. & O. W. Gerwig	3		Center					
3589 -	Gilco Gas, Inc.	Archie Roberly	1		Center					
3590 -	Gilco Gas, Inc.	Viola Curry	1		Center					
3591 -	Gilco Gas, Inc.	T. J. & A. B. Smith	5		Center					
3592 -	Southeastern Gas Company	S. E. Minney	618		Center					
3593 -	Southeastern Gas Company	S. A. Hayes	617		Center					
3594 -	Southeastern Gas Company	Emma Delong	616		Center					
3595 -	Southeastern Gas Company	Emma Delong	615		Center					
3596	Slivers Oil & Gas Company	Slivers Oil & Gas Company	1		Dekalb					